

# WeatherTech®

## Easy-On™ Stone & Bug Deflectors

### Important Safety Information



- CAUTION - Before driving, ensure that the hood shield is properly secured to vehicle.
- Do not use automatic "brush-style" car washes.
- Do not use cleaning solvents of any kind.
- Periodically check all components for tightness.

### Contents

**NOTE:** Actual product may vary from illustration.



Hood shield



Fastener  
x4



Bump On  
x4

### Tools Required



Car Wash Supplies



Clean Towel



Phillips  
screwdriver

### Preparation Before Painting / Installation

- A trial fit is recommended to ensure proper positioning and fit.
- Check fit of parts before painting as we will not accept the return of modified or painted parts.
- Wash and dry your vehicle to remove any debris and/or dirt from the installation area.

### Installation Steps

**NOTE:** Actual application may vary slightly from illustrations.

Open hood. Remove the rubber trim piece from the leading edge of hood. Discard rubber trim.

Rubber Trim

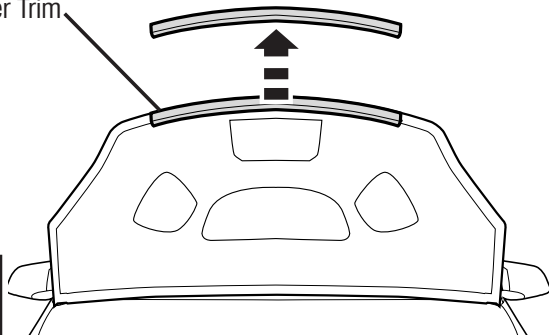

1

Align hood shield holes with holes in hood.

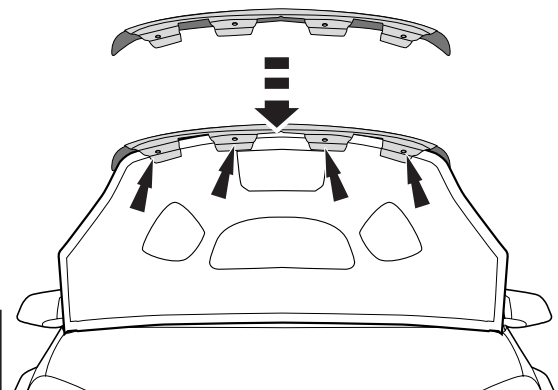

2

## Installation Steps

**NOTE:** Actual application may vary slightly from illustrations.



Assemble faster by threading screw into receptacle. Insert (1) fastener and screw until snug. Repeat for remaining (3) fasteners.

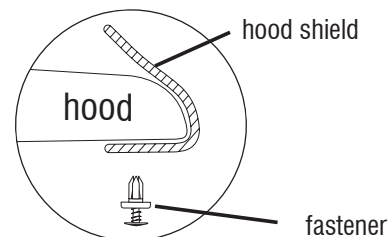
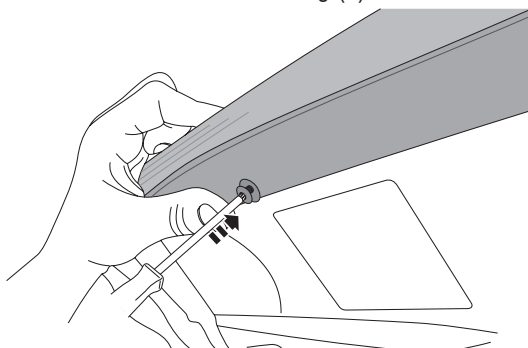
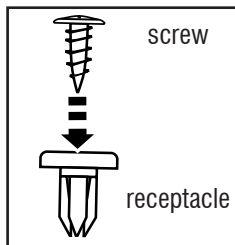

3

**DO NOT OVER TIGHTEN**



Close hood and Install bump ons at pre-cleaned locations on the painted hood/fender surface.

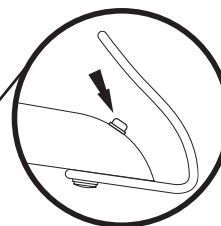
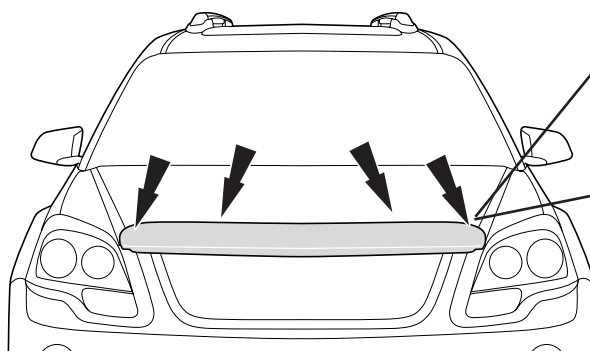

4

## Care and Cleaning

- Wash only with mild soap & dry with a clean cloth.

Looking for dependable stone & bug deflectors?  
Rely on Weathertech for quality and long-lasting products.