

WeatherTech®

Easy-On™ Stone & Bug Deflectors

Important Safety Information



- CAUTION - Before driving, ensure that the hood shield is properly secured to vehicle.
- Do not use automatic "brush-style" car washes.
- Do not use cleaning solvents of any kind.
- Periodically check all components for tightness.

Contents

NOTE: Actual product may vary from illustration.

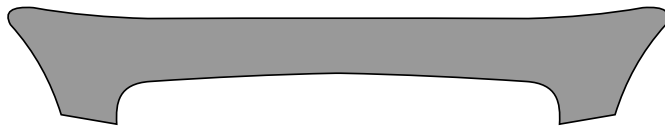

Hood shield



Bump On x4



Insert x2



Screw x2

Tools Required



Car Wash Supplies



Clean Towel

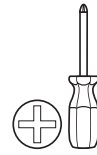

Phillips
screwdriver

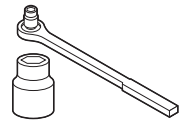

Socket
wrench

Preparation Before Painting / Installation

- A trial fit is recommended to ensure proper positioning and fit.
- Check fit of parts before painting as we will not accept the return of modified or painted parts.
- Wash and dry your vehicle to remove any debris and/or dirt from the installation area.

Installation Steps

NOTE: Actual application may vary slightly from illustrations.

Open hood.

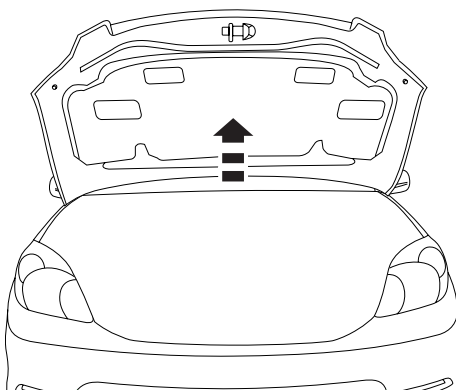

1

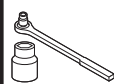

Remove (6) nuts that attach grill to hood. Carefully remove grill and set aside.

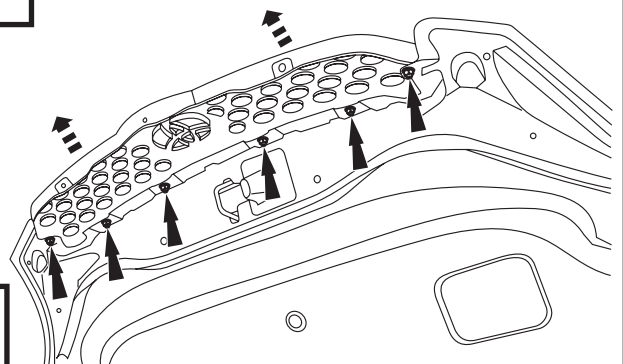

2

Installation Steps

NOTE: Actual application may vary slightly from illustrations.

Position hood shield on hood. Align (2) holes in hood shield with the holes located in the underside of hood.

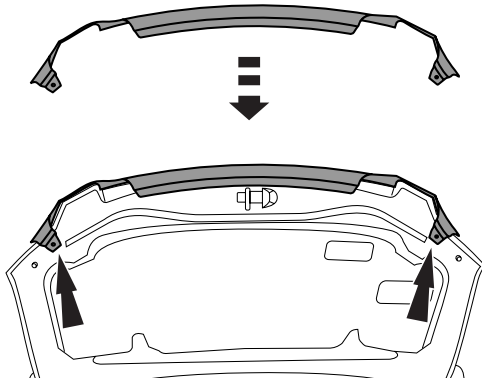

3

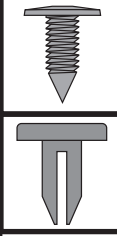

Assemble fasteners.

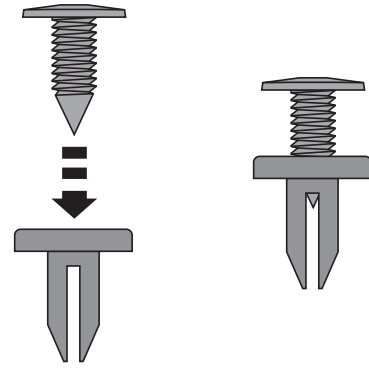

4

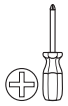

Insert fastener and secure using a phillips head screwdriver. Repeat for opposite side fastener.

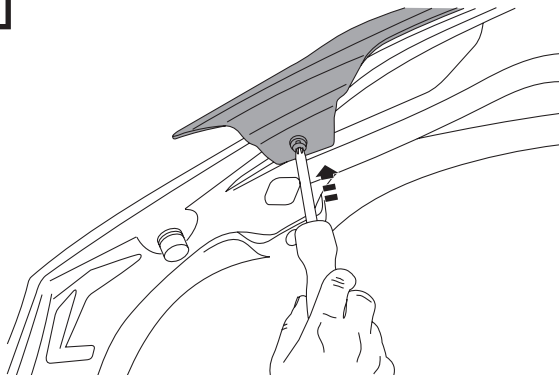

5

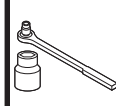

Replace the front grill over the front flange of hood shield and secure with previously removed nuts.

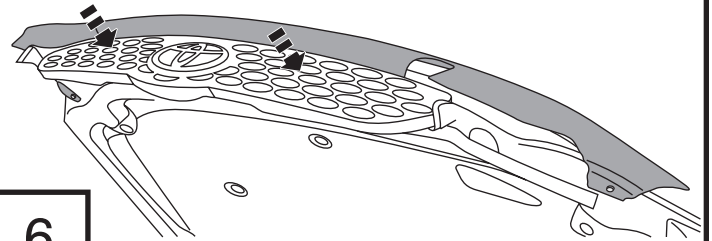

6



Close hood. Adhere bump ons.

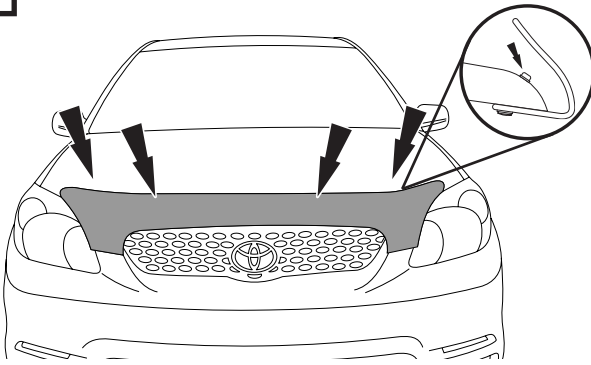

7

Care and Cleaning

- Wash only with mild soap & dry with a clean cloth.