

WeatherTech® No-Drill MudFlap

Installation Instructions

Thank you for purchasing the WeatherTech® No-Drill MudFlap. Please read this installation guide to thoroughly familiarize yourself with the steps to install the MudFlap on your vehicle. When properly installed, the WeatherTech® No-Drill MudFlap will provide you with years of protection.

⚠ WARNING ⚠

The MudFlap is designed to fit vehicles with standard size wheels and tires. Installation of MudFlaps on vehicles with aftermarket wheels or oversize tires may interfere with the MudFlap, will void the warranty and may damage the MudFlap or the vehicle.

	Tools Needed <ul style="list-style-type: none">- Ratchet and Socket Set- Phillips Screwdriver (Stubby Preferred)
	Hardware <p>Parts Kit: 48MF540 (1) T20 Torx bit</p>

1 Start by thoroughly washing your vehicle. Take care to remove all dirt, debris, and stains from each fender in the areas corresponding to where the MudFlaps will be installed.

2 Park the vehicle on level ground with the wheels turned fully to the left. Begin with the driver's side MudFlap installation.

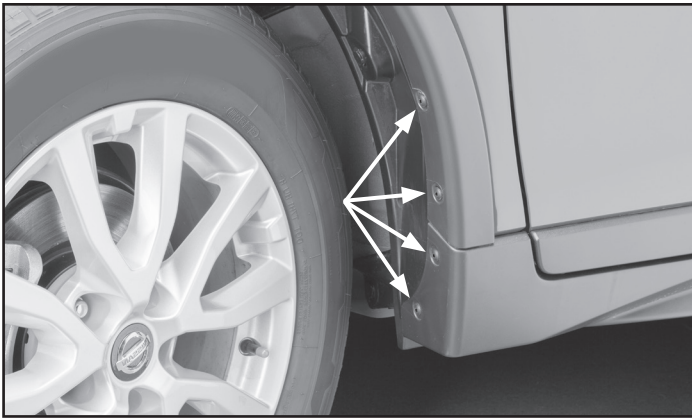

3 Locate the (4) factory Torx head screws as shown. If vehicle has (4) Phillips head screws instead, they will be in the same location as the Torx screws.



4 Using a ratchet, appropriate socket and supplied Torx bit, remove the (4) factory Torx head screws. They will be reused. If vehicle has (4) Phillips head screws, remove with a stubby Phillips screwdriver.



5 Using the MudFlap marked "LH," place it up to fender and align with the corresponding holes.



6 Re-install the (4) previously removed factory Torx head screws with the ratchet, appropriate socket and supplied Torx bit. Start with the top screw and work down while tightening to a snug fit. If vehicle has Phillips head screws, re-install (4) previously removed factory screws with the stubby Phillips screwdriver with the same process shown.



7 With the MudFlap pressed firmly against the fender, fully tighten the (4) factory Torx head screws. If vehicle has Phillips head screws, follow the same process shown.



8 Install the passenger side MudFlap marked "RH," with the wheels turned fully to the right repeating Steps 3-7.



Congratulations!
Your new WeatherTech® No-Drill MudFlaps have been installed!



Made in the USA

WeatherTech® No-Drill MudFlap

Installation Instructions

Thank you for purchasing the WeatherTech® No-Drill MudFlap. Please read this installation guide to thoroughly familiarize yourself with the steps to install the MudFlap on your vehicle. When properly installed, the WeatherTech® No-Drill MudFlap will provide you with years of protection.

⚠ WARNING ⚠

The MudFlap is designed to fit vehicles with standard size wheels and tires. Installation of MudFlaps on vehicles with aftermarket wheels or oversize tires may interfere with the MudFlap, will void the warranty and may damage the MudFlap or the vehicle.

	Tools Needed - Ratchet and Socket Set
	Hardware Parts Kit: 48MF540 (1) T20 Torx Bit

1 Start by thoroughly washing your vehicle. Take care to remove all dirt, debris, and stains from each fender in the areas corresponding to where the MudFlaps will be installed.

2 Park the vehicle on level ground. Begin with the driver's side MudFlap installation.

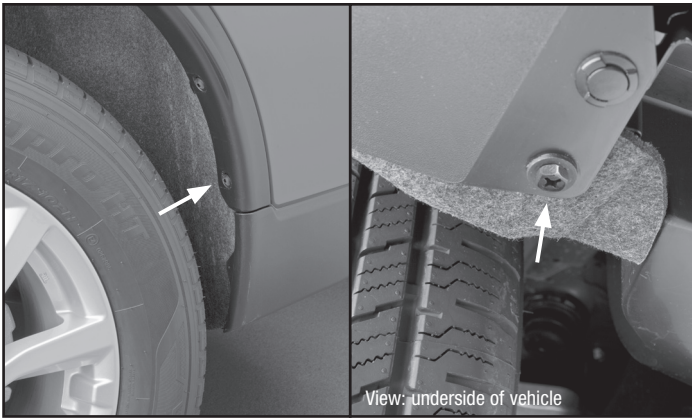

3 Locate the (1) factory Torx head screw and (1) factory hex head screw as indicated. If vehicle has (1) factory Phillips head screw instead, it will be in the same location as the Torx screw.



4 Using a ratchet, appropriate socket and supplied Torx bit, remove the (1) factory Torx head screw. Then, remove the (1) hex head screw at the underside of the fender with the ratchet and appropriate socket. They will be reused. If vehicle has (1) factory Phillips head screw, use a ratchet, appropriate socket and Phillips head bit to remove.

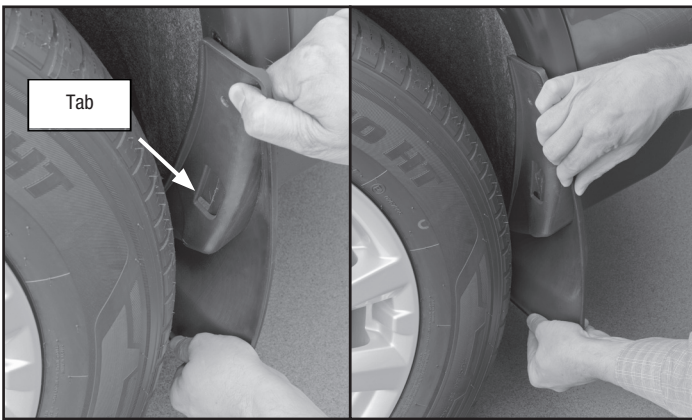

5 Using the MudFlap marked "LH," position the tab between the inner fender liner and lip of the fender. Slide it up the fender and align to the appropriate hole.



6 Once the MudFlap has been moved into place on the fender, re-install the (1) previously removed factory Torx head screw with the ratchet, appropriate socket and supplied Torx bit to a snug fit. If vehicle has a Phillips head screw, re-install (1) previously removed factory screw with the ratchet, appropriate socket and Phillips head bit with the same process shown.

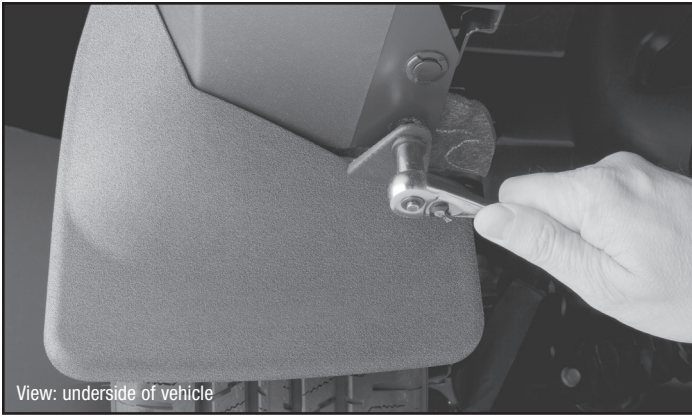

7 At the underside of the fender, re-install the (1) previously removed factory hex head screw with the ratchet and appropriate socket to a snug fit.



8 With the MudFlap pressed firmly against the fender, fully tighten the (1) factory Torx head screw and (1) factory hex head screw. If vehicle has a Phillips head screw, follow the same process shown.



9 Install the passenger side MudFlap marked "RH," repeating Steps 3-8.



Congratulations!
Your new WeatherTech® No-Drill MudFlaps have been installed!



Made in the USA