



VAN STORAGE SOLUTIONS

FOR THE WAY YOU WORK™

INSTALLATION MANUAL

Bulkhead

Model Number 96121-3-01

ATTENTION: PLEASE READ AND UNDERSTAND ALL INSTRUCTIONS AND WARNINGS BEFORE ASSEMBLING, INSTALLING OR USING THIS PRODUCT.

! PLAN YOUR VAN (TIPS FOR FASTER INSTALLATION)

- Installing your Sprinter bulkhead is very clear cut following these instructions. It mounts right to the sheet-metal around the cab. Even though not all of the holes will line up, the self-drilling screws will go in easily and hold securely.
- Before cutting or drilling in the floor, verify the location of you gas tank, fuel lines and electrical cables so you don't accidentally cut something important.
- Make sure that the blind fasteners go into the sheet-metal floor and not the composite floor. A hole saw will give you a nice, clean edge. Always wear eye protection when drilling or cutting.
- Your Sprinter van bulkhead can be up-graded with a swing-door conversion kit, 96901-3-01. If you think you might want to change to it in the future, put an extra nut between the driver's side panel and the center panel to allow enough space.

INSTALLATION TIME

Approximate installation time: 60 minutes per unit depending on van equipment installation experience.

TOOLS REQUIRED

- 7/16 Open or Box end wrench
- Electric Drill
- 1" Hole Saw
- 5/16" Nut Driver Bit
- Pencil or Marker
- Hammer
- Center Punch
- Phillips Head Screwdriver
- Drill Bits: 1/8", 5/16", 3/8", 1/2"
- 3/8" Ratchet Drive
- Sockets: 5/16", 11/32", 3/8", 7/16", 1/2", 9/16"
- Level
- Carpenter's Square
- Open End Wrenches: 5/16", 11/32", 3/8", 7/16", 1/2", 9/16"

BOLT KIT

QTY.	DESCRIPTION
4	5/16" Lock Washers
4	5/16-18 Blind Fasteners
9	8-32 x 1/2" Machine Screws
9	8-32 Nylon Lock Nuts
5	10-24 x 1/2" Hex Head Screws
5	10-24 Serrated Flange Nuts
6	1/4-20 x 5/8" Hex Head Bolts
23	1/4-14 x 3/4" Self-Drilling Screws
4	5/16" Fender Washers
4	5/16-18 Nylon Lock Nuts
8	5/16" Flat Washers
4	5/16-18 x 2" Hex Head Bolts
20	1/4-20 Nylon Lock Nuts
26	1/4" Flat Washers
8	Floor Mounting Spacers
1	Blind Fastener Installation Tool
1	5/16-18 x 2-1/4" Hex Head Black Bolt
14	14-20 x 5/8" Carriage Bolts

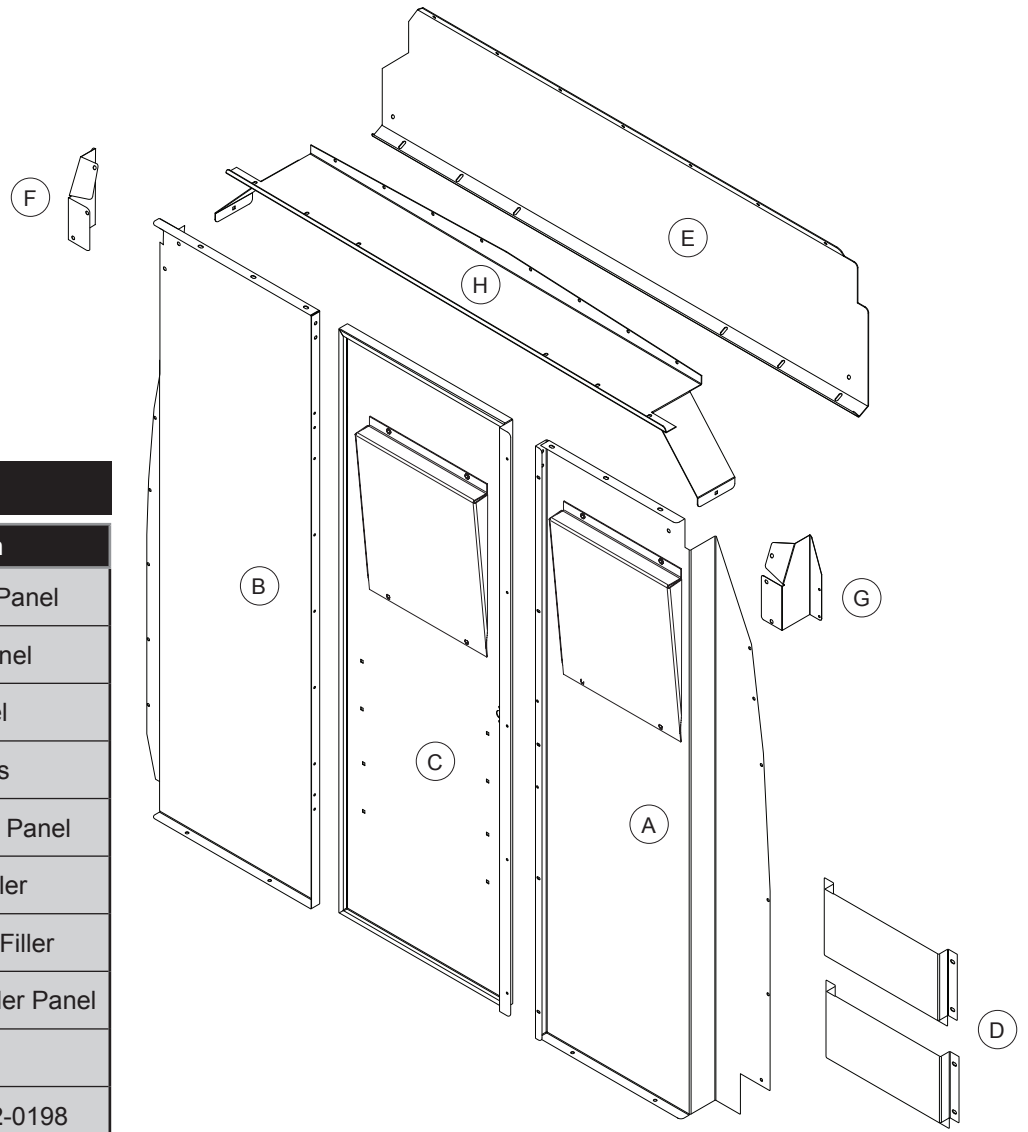

PARTS LIST		
	Qty.	Description
A	1	Passenger Side Panel
B	1	Driver Side Panel
C	1	Center Panel
D	2	Door Pockets
E	1	High Roof Header Panel
F	1	Driver Side Filler
G	1	Passenger Side Filler
H	1	Standard Roof Header Panel
	1	Panel
	1	Bolt Kit – Part #32-0198

INSTALLATION INSTRUCTIONS

STEP 1. If the Sprinter (Standard or High Roof) has Foam Pads in the upper corners behind the B-Pillar they will have to be removed. They are designed to stay in place without fasteners and will have to be broken to be removed. They will not be needed after the Bulkhead is installed.

The Sprinter (Standard or High Roof) will either have the B-Pillar exposed towards the rear of the vehicle or it will be entirely covered by B-Pillar molding.

If the molding covers the entire B-Pillar it will have to be temporarily removed for Bulkhead installation and then cut to fit after the Bulkhead is installed and before the vehicle is placed in service.

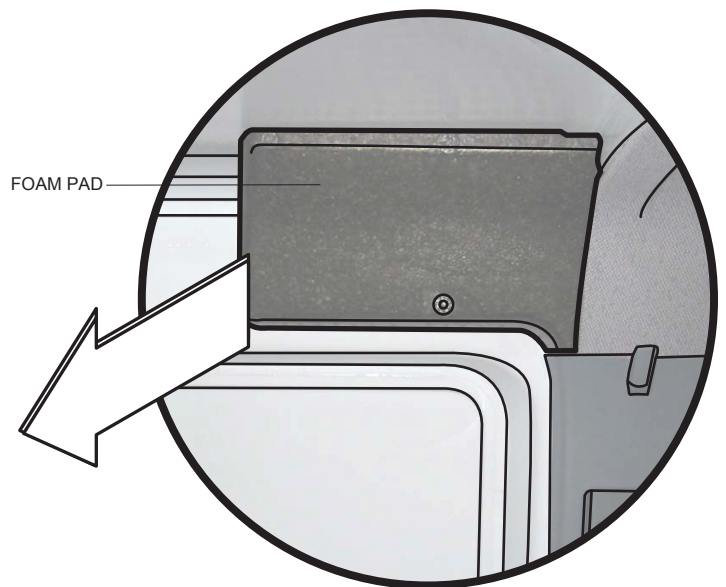

INSTALLATION INSTRUCTIONS

STEP 2. Assemble the Door Pockets to either the driver's side or cargo side of the Center Panel using eight (8) 1/4-20 x 5/8" Carriage Bolts, 1/4-20 Nylon Lock Nuts and 1/4" Flat Washers.

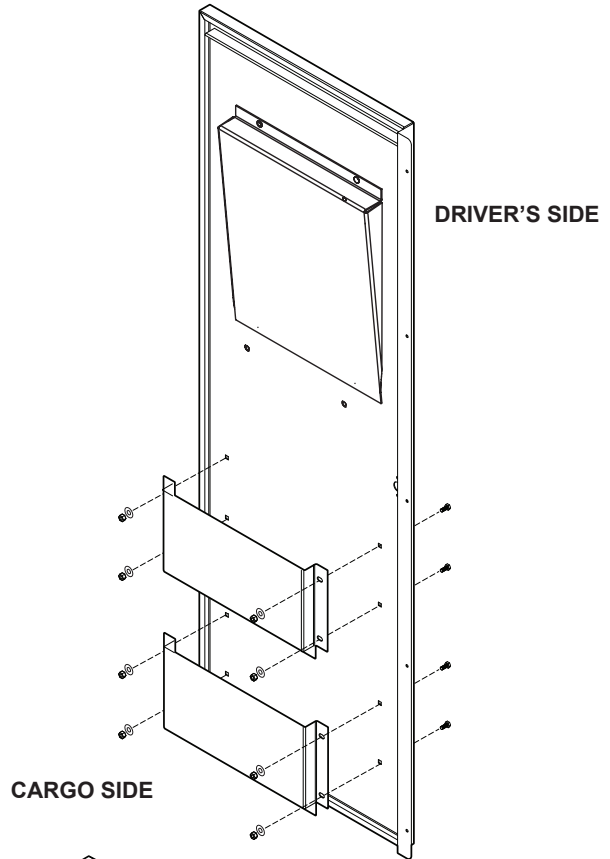

STEP 3. Attach Driver Side Panel to Center Panel with both panels flush to the bottom using nine (9) 8-32 x 1/2" Machine Screws and 8-32 Nylon Lock Nuts. The Bulkhead panels should be assembled inside the van.

NOTE: Not all mounting holes will be used on either of the vertical sides of the Center Panel. Extra mounting holes are for the swing door option available for this Bulkhead.

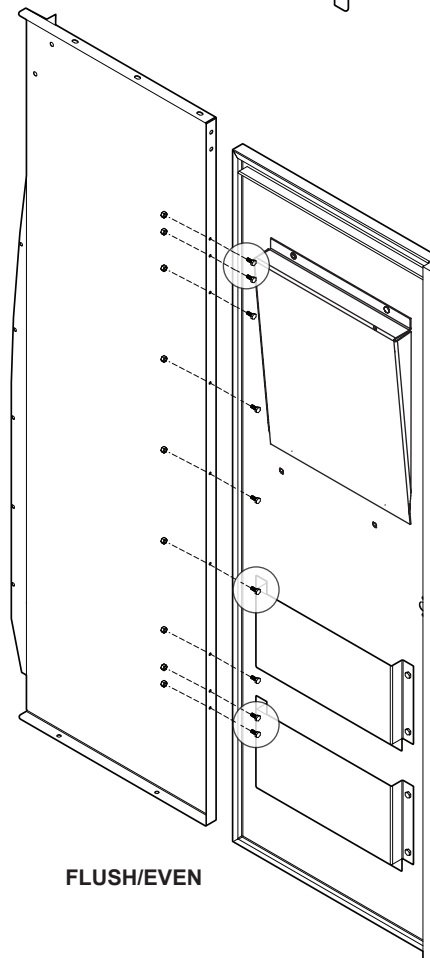

INSTALLATION INSTRUCTIONS

STEP 4. Attach the Passenger Side Panel to Center Panel using five (5) #10-24 x 1/2" Hex Head Screws and Serrated Flange Nuts.

DO NOT FULLY TIGHTEN FASTENERS AT THIS TIME, PARTS MUST STILL MOVE IN SLOTS.

NOTE: Not all mounting holes will be used on either of the vertical sides of the Center Panel. Extra mounting holes are for the swing door option available for this Bulkhead.

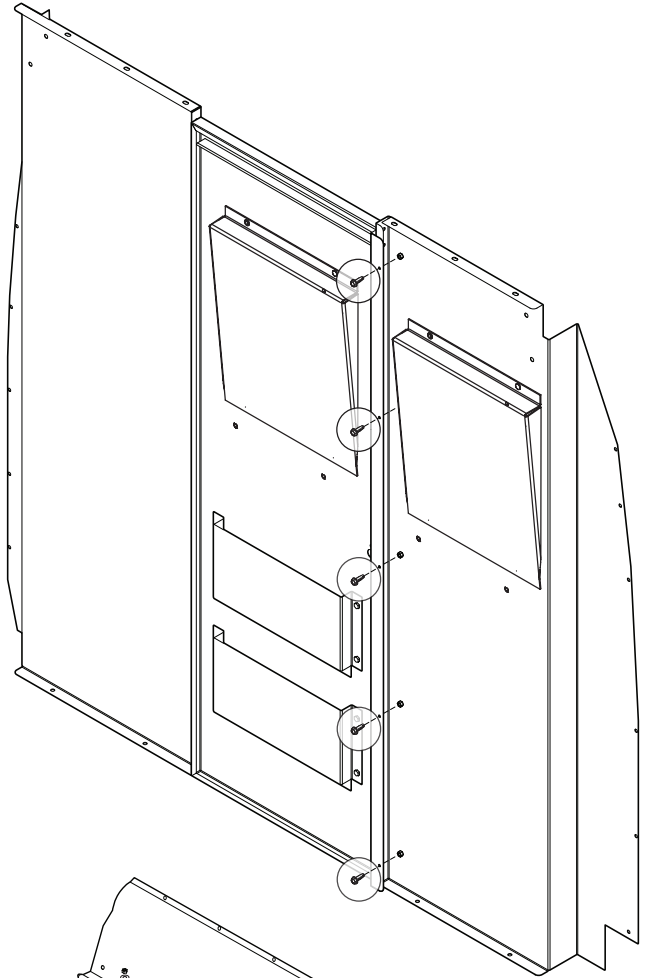

STEP 5. Attach the Header Support (Standard or High Roof) to the Bulkhead using six (6) 1/4-20 x 5/8" Hex Head Bolts, twelve (12) 1/4" Flat Washers and six (6) 1/4-20 Nylon Lock Nuts.

DO NOT FULLY TIGHTEN FASTENERS AT THIS TIME, PARTS MUST STILL MOVE IN SLOTS.

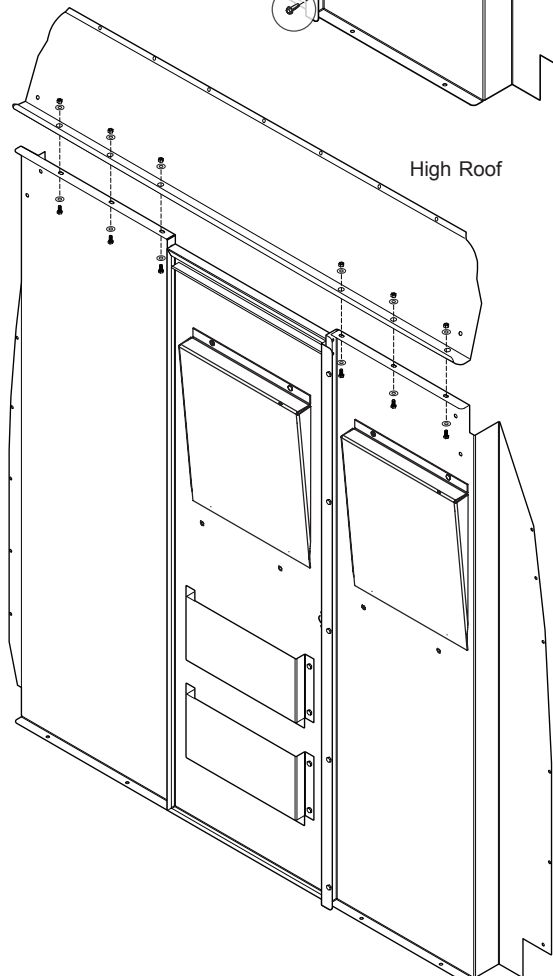
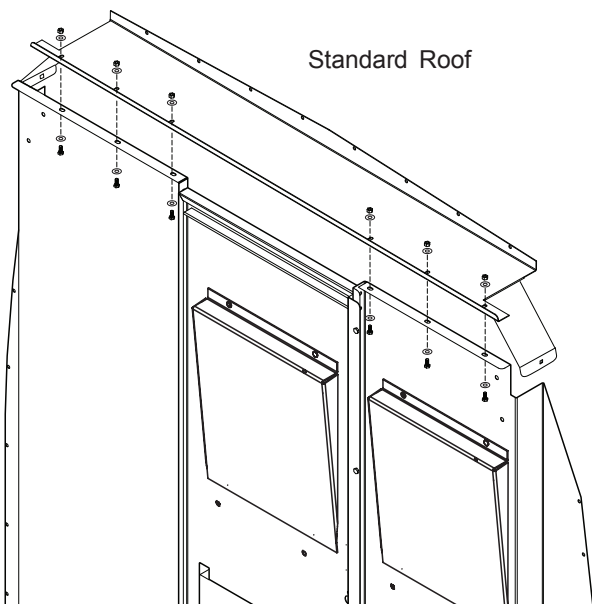

INSTALLATION INSTRUCTIONS

STEP 6. Place the Bulkhead against the B-Pillar making sure there is enough steel material behind all the ROUND holes on the outside edges of the Bulkhead side panels to utilize the Self-Drilling Screws.

Using a center punch, mark the four Bulkhead bottom mounting holes on the floor of the van. Ensure the hole is located on the topline of the floor rib. Move the Bulkhead out of the way. Predrill the floor mounting locations with an 1/8" drill bit, then re-drill the hole with a 3/8" drill bit. If there is a wood floor, then Floor Mounting Spacers are **required**. Cut the wood floor around the 3/8" holes with the 1" hole saw, allowing Floor Mounting Spacers to rest against the metal floor. **DO NOT DRILL THROUGH THE VAN FLOOR WITH THE HOLE SAW.** (See example bolting solutions below).

NOTE: Four (4) Blind Fasteners and 5/16" Lock Washers have been provided in case through-bolting is impossible due to heat shields, floor channels, fuel lines, etc. If Blind Fastener installation is necessary, re-drill the 3/8" mounting holes with 1/2" drill bit. See **INSTALLATION INSTRUCTIONS FOR BLIND FASTENERS** on page 8.

NOTE: The floor bolting solution could be a variation on any of these three examples with or without the floor mat.

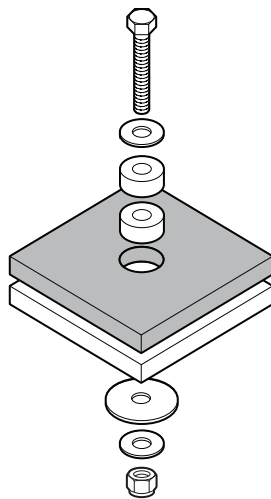

**TOP DOWN INSTALLATION
THROUGH FLOOR MAT
AND VAN FLOOR**

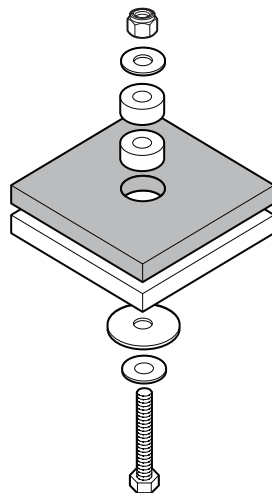

**BOTTOM UP INSTALLATION
THROUGH FLOOR MAT
AND VAN FLOOR**

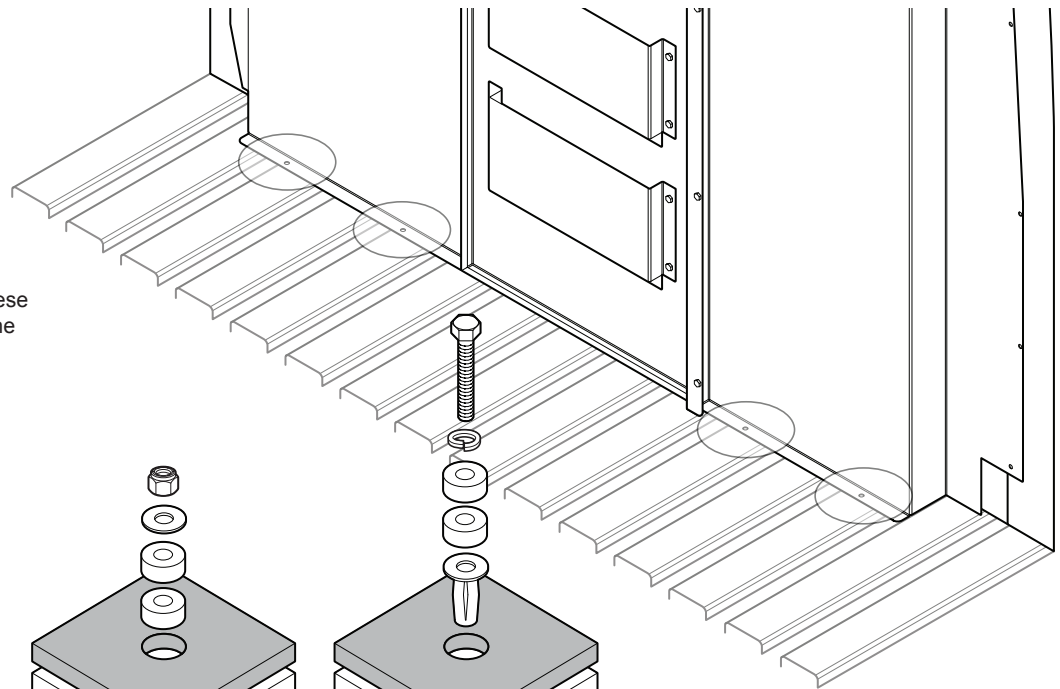

**BLIND FASTENER INSTALLATION
THROUGH FLOOR MAT AND
VAN FLOOR (SEE PAGE)**

WARNING

All floor mounting bolts near the fuel tank area should be installed from the underside of the vehicle, to guard against the fuel tank being punctured in the event of a collision. This would mean not using Blind Fasteners in this area. Holes in this area should be 5/16". Ensure ample space in roof ribs and sidewall ribs for mounting hardware so as not to puncture exterior roof or wall.

INSTALLATION INSTRUCTIONS

STEP 7. Place the Bulkhead against the B-Pillars and install the twelve (12) 1/4-14 x 3/4" Self-Drilling Screws through the ROUND holes in the outside edges of the Bulkhead panels on both the passenger and driver side B-Pillars.

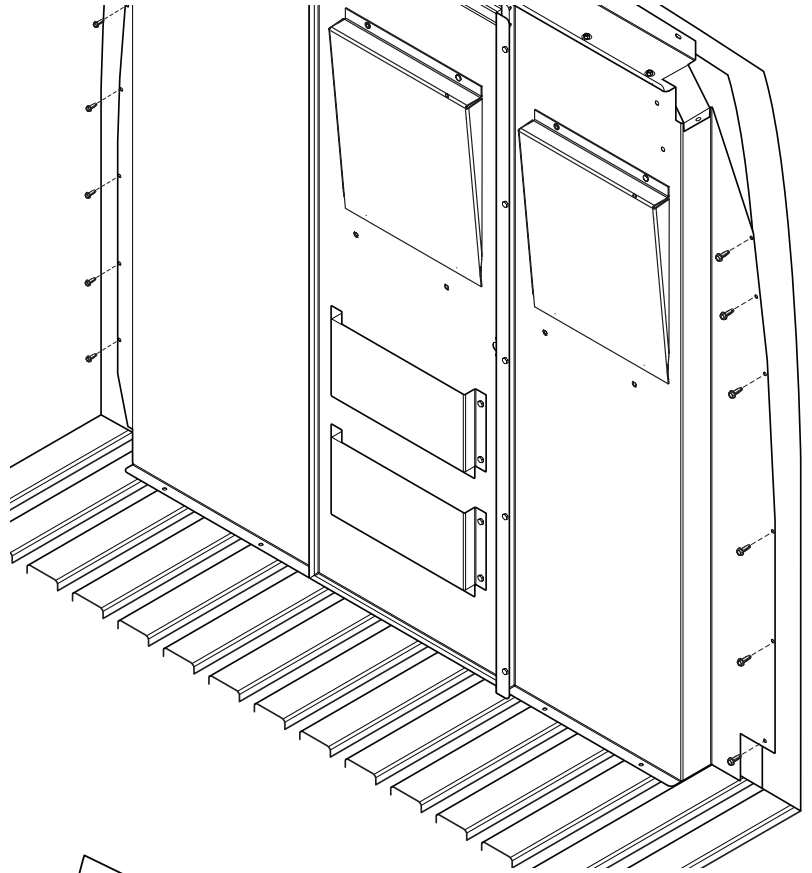

STEP 8. Mount the Bulkhead to the Sprinter roof rib (Standard or High Roof) by installing fasteners to the top edge of the unit through one of the following two methods:

Standard Roof Sprinter: Fasten the Standard Roof Header Panel to the Sprinter roof rib using eight (8) 1/4-14 x 3/4" Self-Drilling Screws through the ROUND holes on the Header Panel.

OR

High Roof Sprinter: Fasten the High Roof Header Panel to the Sprinter roof rib using seven (7) 1/4-14 x 3/4" Self-Drilling Screws through the ROUND holes on the Header Panel.

NOTE: This Bulkhead was engineered to mount in a "Standard Roof Sprinter" or a "High Roof Sprinter". Depending on type of Sprinter, not all the fasteners or parts supplied with this product will be used.

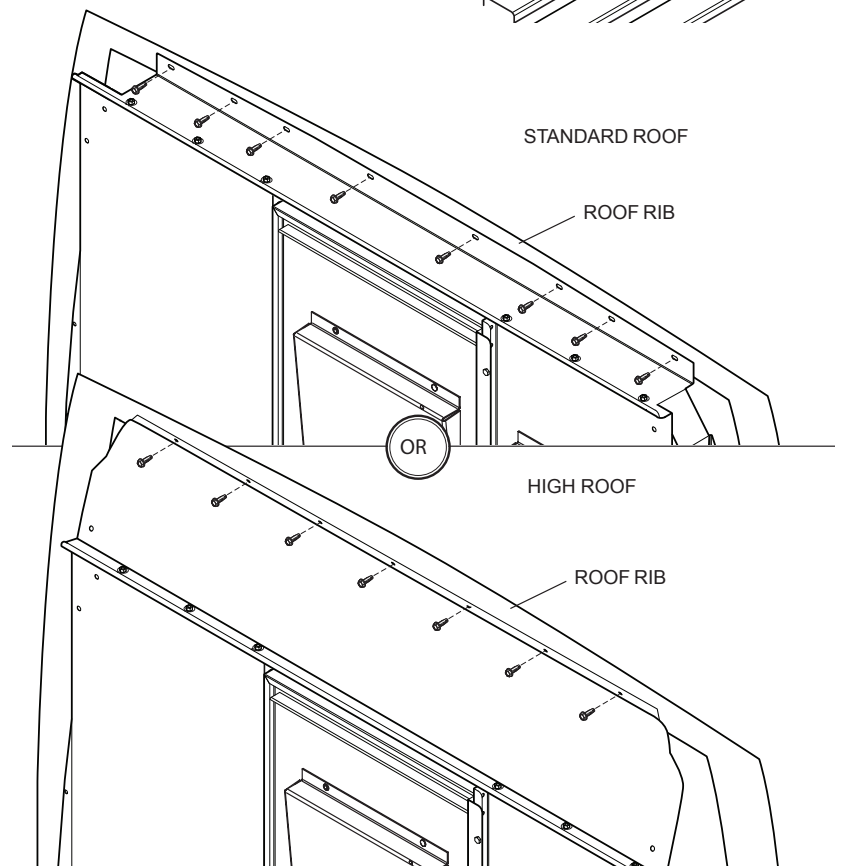

INSTALLATION INSTRUCTIONS

STEP 9. Attach both the Passenger and Driver Side Panels to the Standard Roof Header Panel by drilling a 5/16" hole in the Side Panels through the existing hole of the Header. Fasten the Standard Roof Header Panel to the Side Panels using two (2) 1/4-20 x 5/8" Carriage Bolts, 1/4" Flat Washers, and 1/4-20 Nylon Lock Nuts.

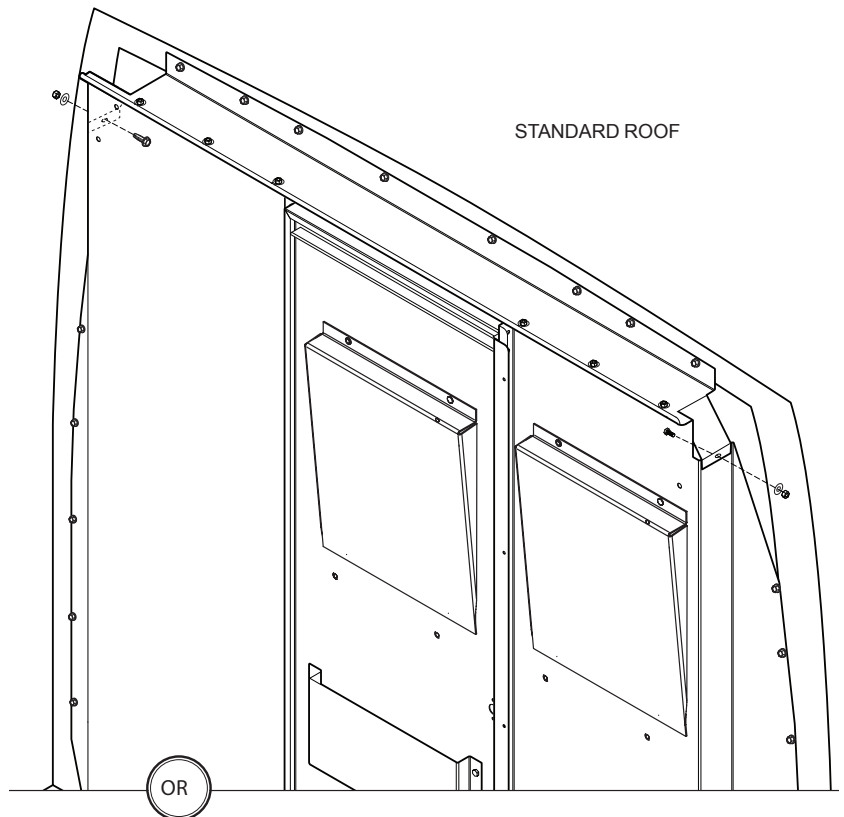

OR

Attach the Passenger Side Filler to the Passenger Side Panel and High Roof Header Panel using three (3) 1/4-20 X 5/8" Carriage Bolts, 1/4-20 Flat Washers and 1/4-20 Nylon Lock Nuts. Fasten the Passenger Side Filler to the B-Pillar using two (2) 1/4-14 x 3/4" Self-Drilling Screws.

Attach the Driver Side Filler to the Driver Side Panel and High Roof Header Panel using (3) 1/4-20 X 5/8" Carriage Bolts, 1/4-20 Flat Washers and 1/4-20 Nylon Lock Nuts. Fasten the Driver Side Filler to the B-Pillar using two (2) 1/4-14 x 3/4" Self-Drilling Screws.

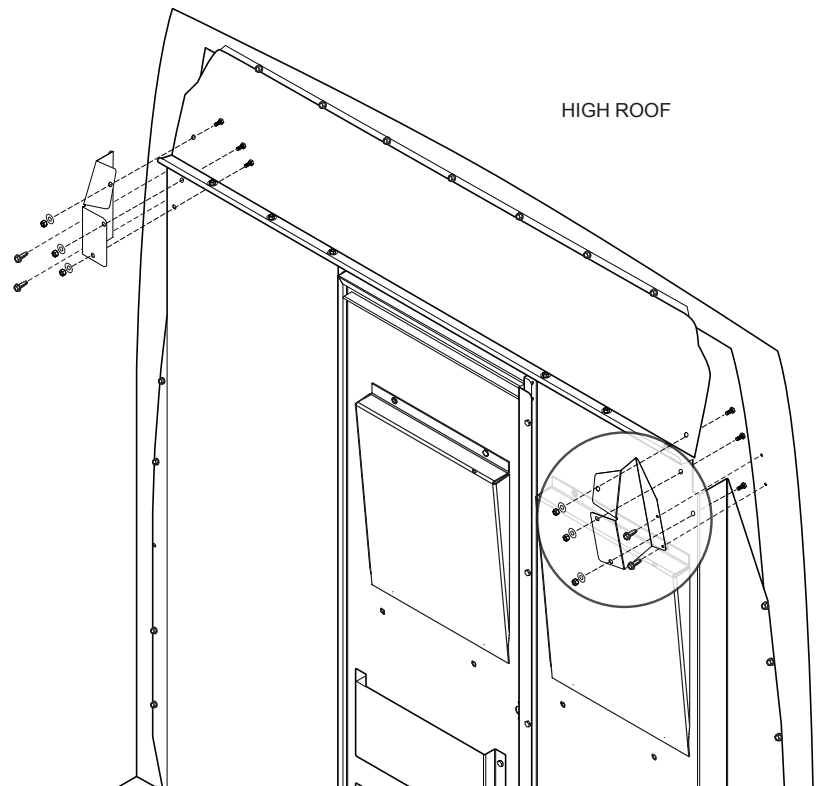

INSTALLATION INSTRUCTIONS

STEP 10. Fasten Bulkhead to van floor using four (4) 5/16-18 x 2" Hex Head Bolts, 5/16" Flat Washers, eight (8) Floor Mounting Spacers (if applicable), add 5/16" Fender Washers, second set of 5/16" Flat Washers and 5/16-20 Nylon Lock Nuts underneath the vehicle.

NOTE: Four (4) Blind Fasteners and 5/16" Lock Washers have been provided in case through-bolting is impossible due to heat shields, floor channels, fuel lines, etc. If Blind Fastener installation is necessary, redrill the 3/8" mounting holes with 1/2" drill bit. See **INSTALLATION INSTRUCTIONS FOR BLIND FASTENERS** below.

NOTE: If the B-Pillar molding was removed in step one, then it must be reinstalled in the driver's compartment side of the Bulkhead before operating the Sprinter. Cutting will be necessary in order to replace the molding and it should fit snug against the Bulkhead. No B-Pillar molding is necessary in the cargo side of the Bulkhead.

NOTE: The B-Pillar molding must be reinstalled in the driver's compartment side of the Bulkhead before operating the Sprinter.

TIGHTEN ALL FASTENERS THAT WERE LEFT LOOSE IN STEPS 4 AND 5.

STEP 4

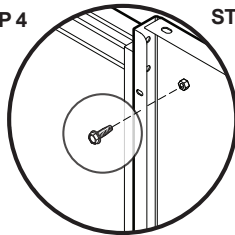

STEP 5

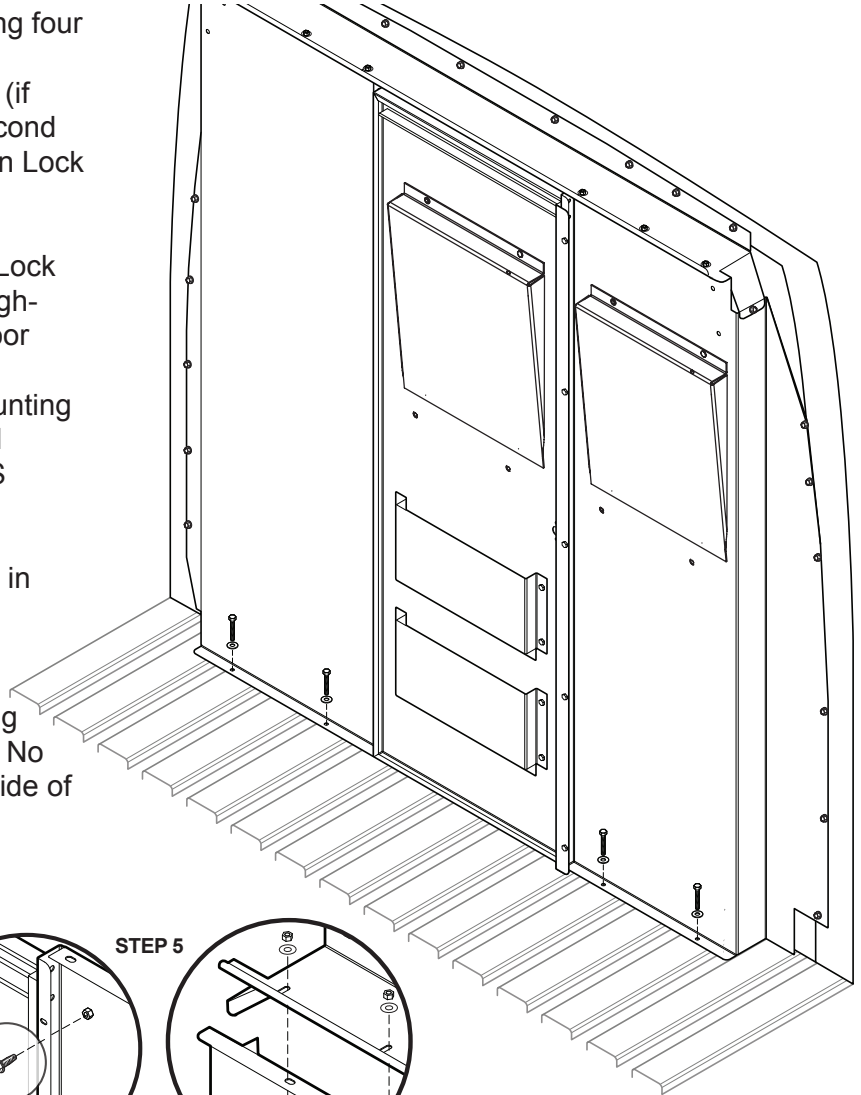
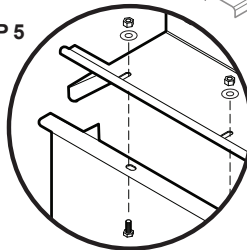

INSTALLATION INSTRUCTIONS FOR BLIND FASTENERS

Place a drop of oil on the black oxide bolt before assembling as shown on right. Place the Blind Fastener in the hole and use a 1/2" wrench to tighten black hex bolt until the Blind Fastener is fully seated. When setting black hex bolt, it will start out hard. As the Blind Fastener "bulbs" out it will get easier, until it bottoms out or sets. Make sure the Blind Fastener and Installation Tool do not turn during installation.

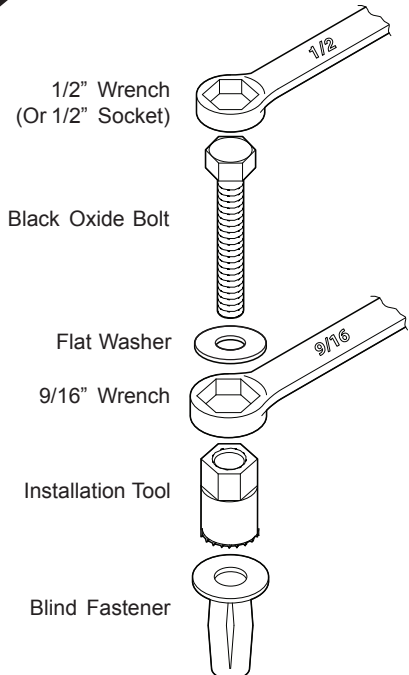

 **WARNING**

This product can reduce the driver's ability to clearly see roadways, vehicular or pedestrian traffic and other objects through the rear and side windows of the vehicle, which can cause an accident. Extra precautions should be taken when driving a vehicle with this product. Make all adjustments necessary to ensure maximum visibility, including but not limited to, changing mirror and seating positions. State and local laws may prohibit obstruction of windows in a moving vehicle.

These instructions are to be followed using the parts and fasteners supplied for proper installation. Any modifications or improper installation of this product will create a hazardous condition that could result in death, serious personal injury and/or property damage.

 **CAUTION**

Prior to drilling, so as not to cut electric wires, fuel lines, brake lines, etc., check behind and underneath drilling and mounting locations. To keep debris out of your eyes when checking the underside of the vehicle, or when drilling, always wear protective eye wear. Failure to heed this warning will result in death or serious injury.

– NOTICE –

Any modification or unintended use of this product shall immediately void all manufacturers warranties. Manufacturer disclaims all liability for injuries to persons or property resulting from any modification to, or unintended use of this product.

