



FORD - RANGER 2019

INSTALLATION MANUAL



**READ CAREFULLY BEFORE
INSTALLATION**

**4X FENDER FLARE SET 2019 RANGER
PART #: 102547**

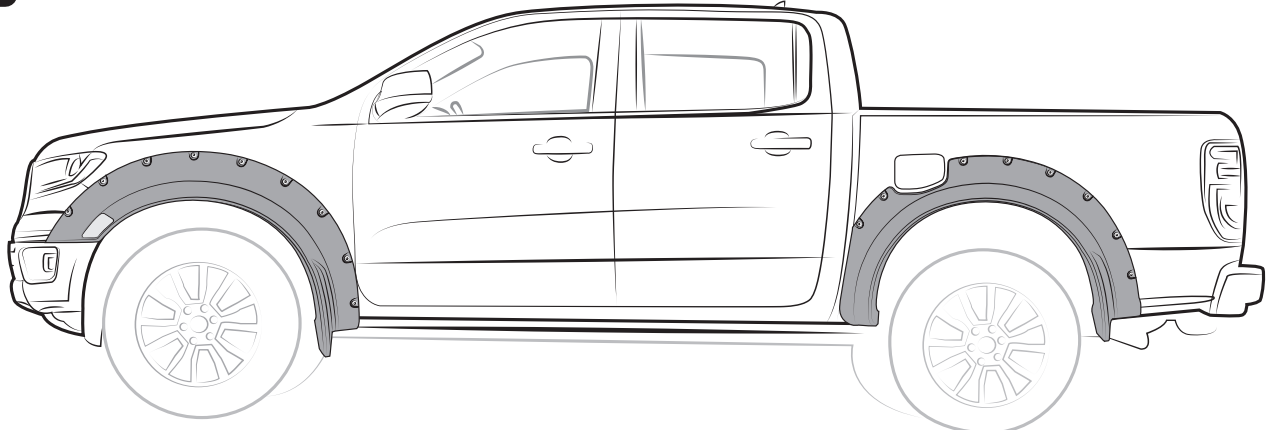

AFTER INSTALLING

**DO NOT
WASH CAR**



**DRIVE SLOWLY
25 mph max**



24 hrs



TOOLS

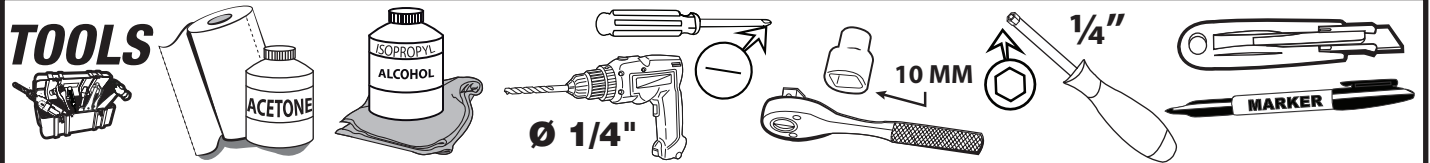

CHECK LIST

*Already installed in the part

| ITEM | DESCRIPTION | DRAWING | AMOUNT |
|------|---|---------|--------|
| A | *SUPER BOLTS RUBBER STUDS | | 33 PCS |
| B | *STAINLESS SUPER BOLT M6 X 14 | | 35 PCS |
| C | *WASHER NICKEL 1/4" | | 2 PCS |
| D | *STAINLESS LOCK NUT 6 mm | | 2 PCS |
| E | NICKEL HEX. TIN SCREW M6 X 40 mm | | 2 PCS |
| F | WASHER NICKEL 1/4" | | 2 PCS |
| G | SPACER 14 mm | | 2 PCS |
| H | AUTOMOTIVE ADHESION PROMOTER TESA # 60153 | | 1 PC |
| I | APPLICATION SPONGE | | 1 PC |
| J | GREASE PENCIL | | 1 PC |
| K | *PVC PROFILE | | 29 FT |
| L | PUSH PINS WÜRTH #387 | | 24 PCS |
| M | U-CLIP H60 | | 4 PCS |
| N | U-CLIP | | 2 PCS |
| O | THREADLOCKER 3222 | | 1 PC |
| P | BONE FOLDER | | 1 PC |



Vehicle and part must be at 16°C or 60°F or more before installation.

Keep the vehicle and parts in an environment that is within the recommended installation temperature range for 4 hours.

FRONT RIGHT & LEFT FLARE

1 REMOVE LIGHTS

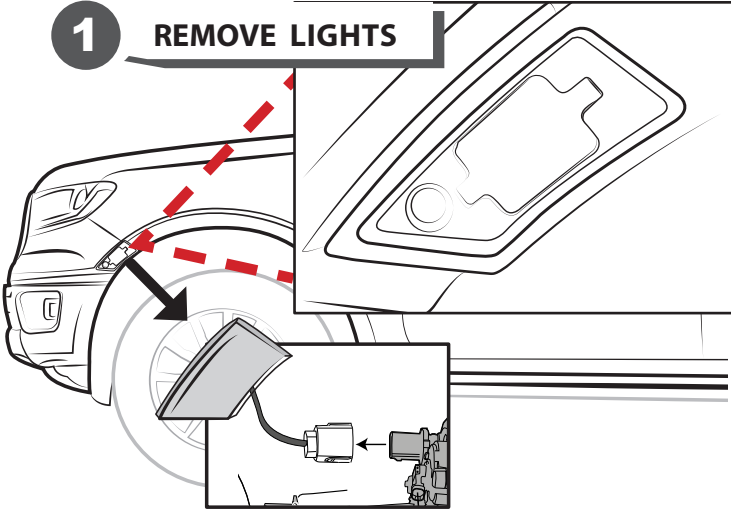

2 REMOVE FACTORY FASTENERS

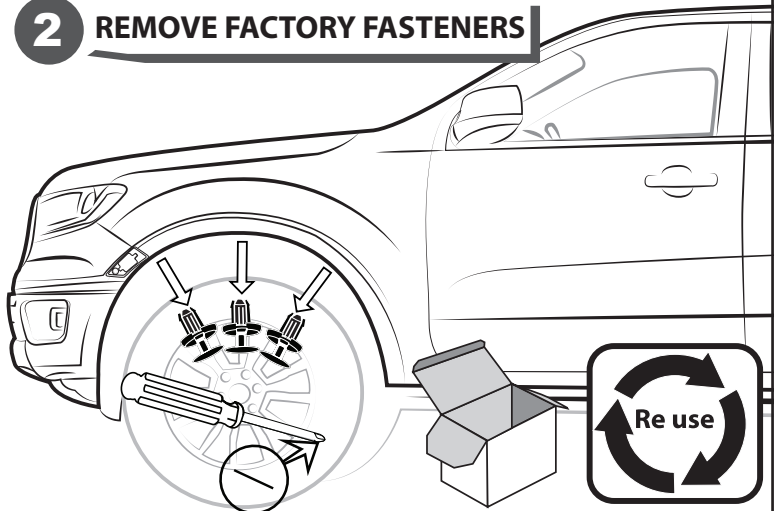

3 CLEAN

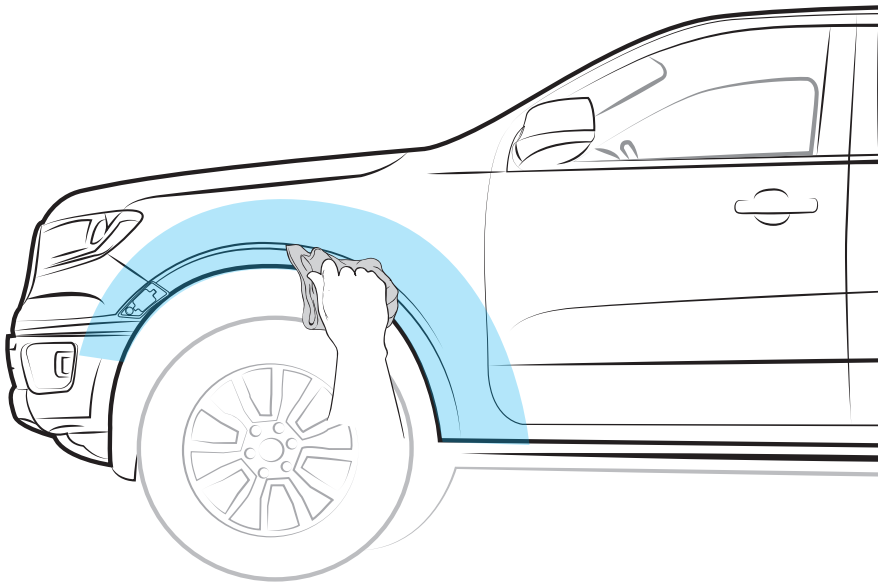

4 PRE-INSTALL

APPLY PRESSURE TO THE WHEEL ARCH

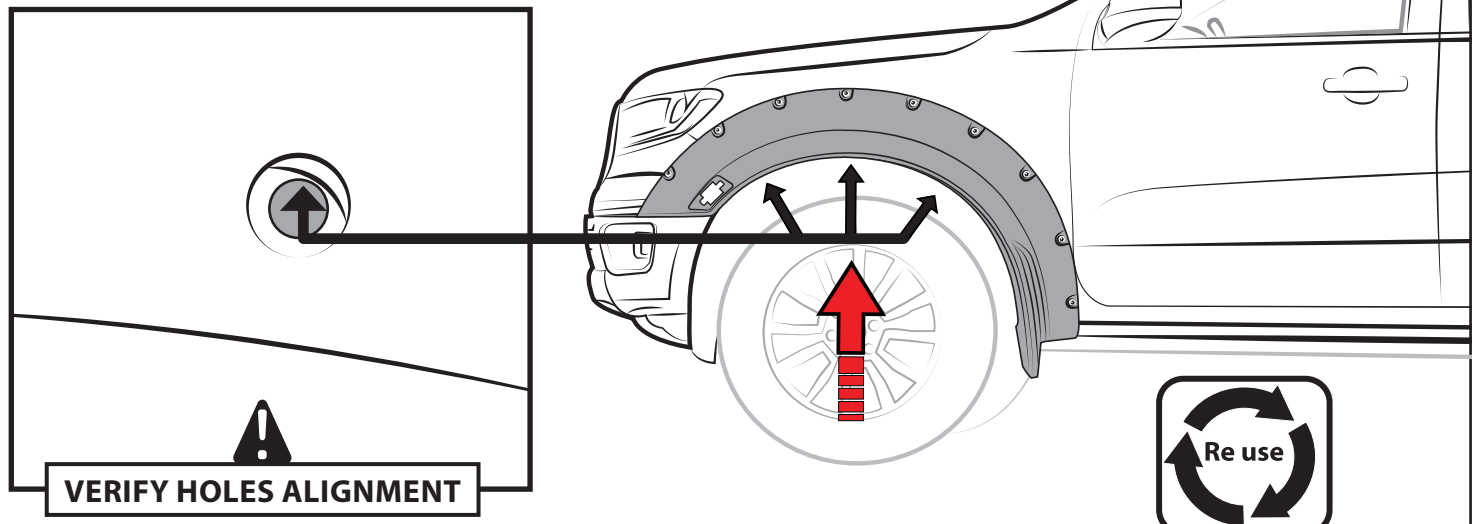



5 MARK SILHOUTTE & SUPER BOLTS POSITION

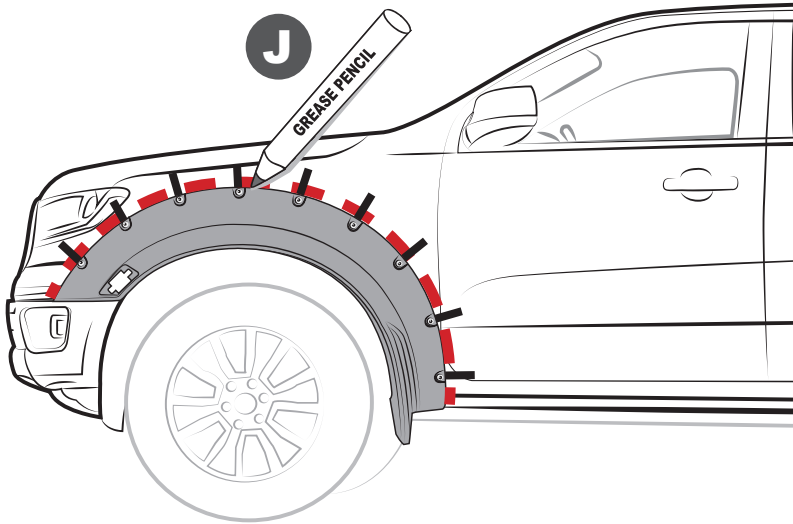

DRAW CENTER HASH MARK WITH GREASE PENCIL AT CENTER, BOTH SIDES, ON EACH SUPER BOLT AND SHEET METAL. THIS WILL ENSURE FENDER FLARE WILL BE CENTERED TO GREASE PENCIL OUTLINE.

6 REMOVE

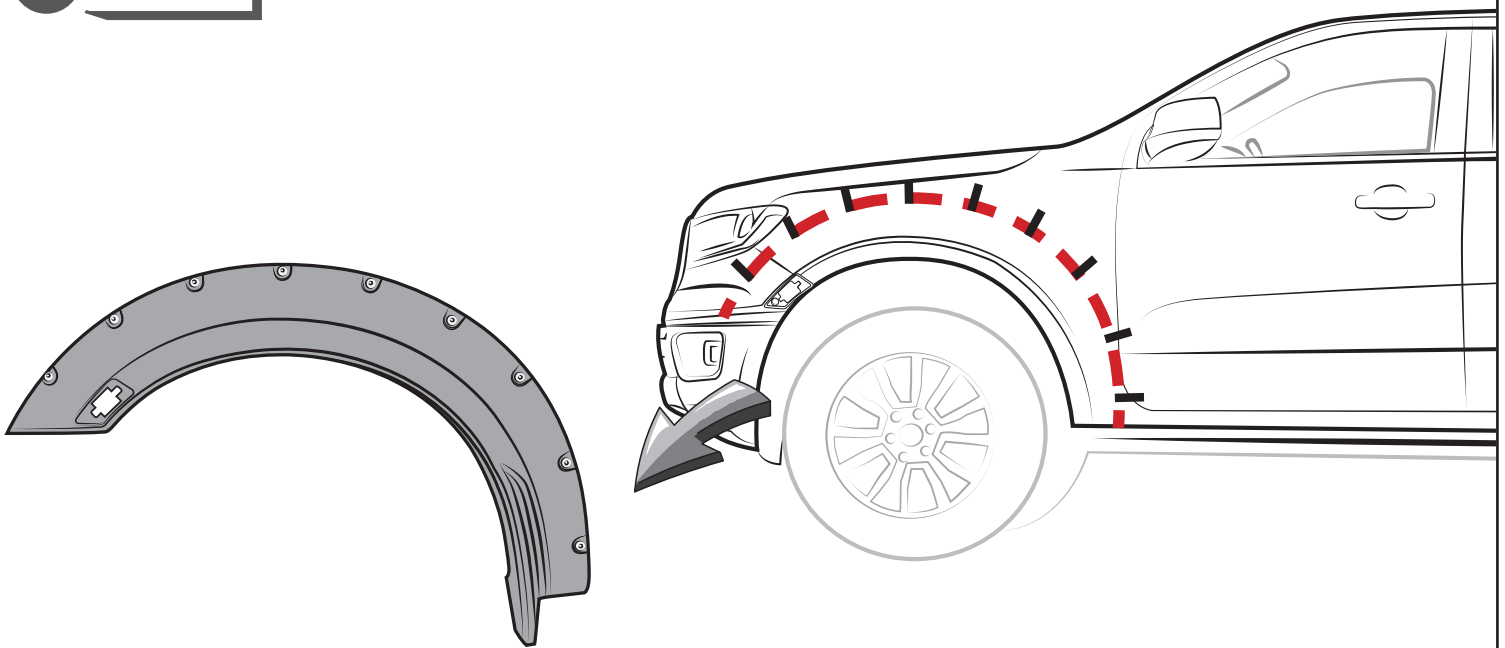

7 ADHESION PROMOTER

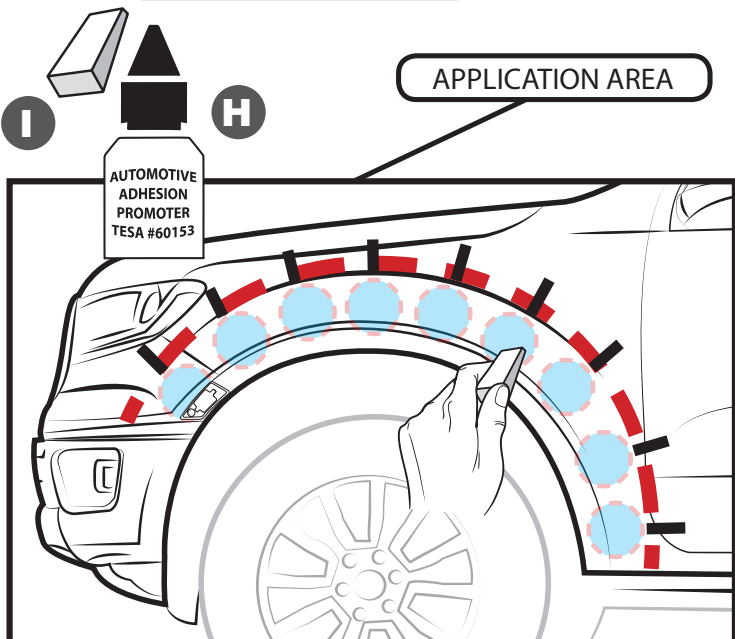

8 REMOVE LINER

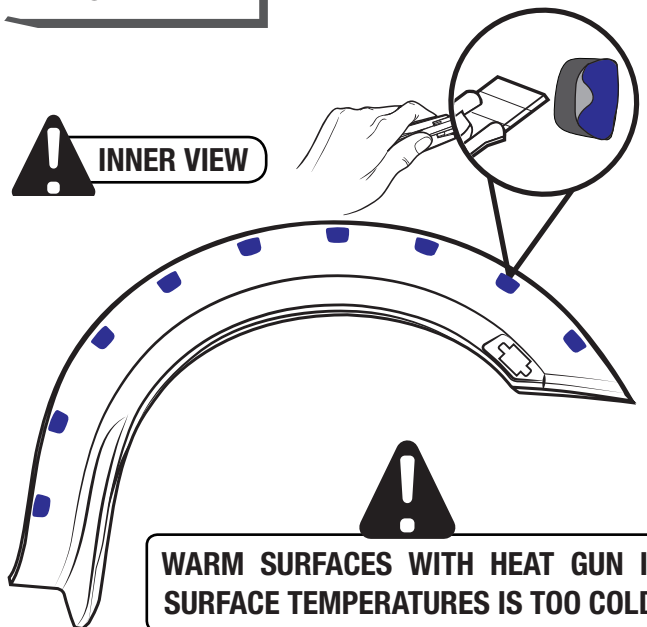



9 SECURE THE PART

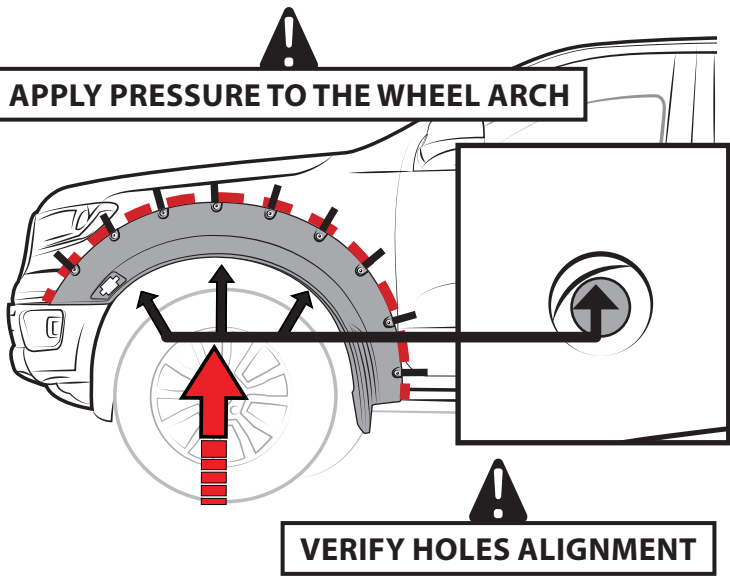

10 APPLY PRESSURE ON EACH SUPERBOLT

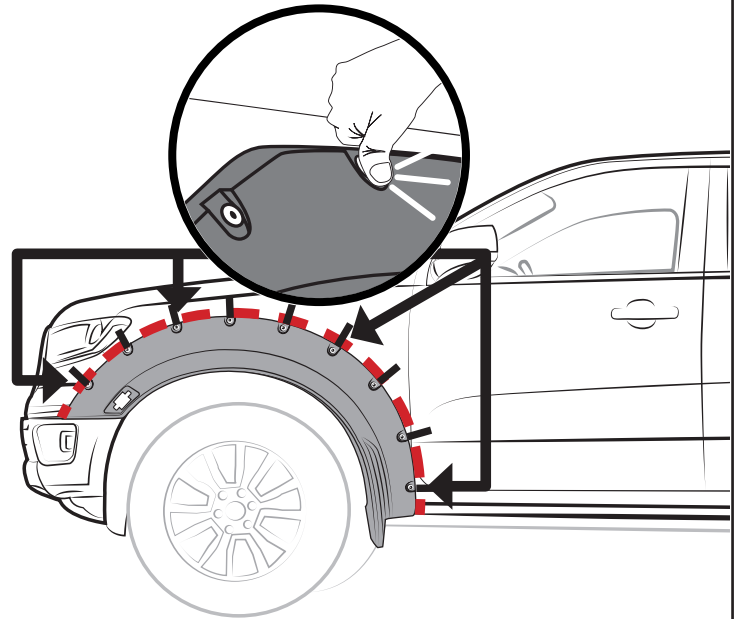

11 REMOVE SUPER BOLTS

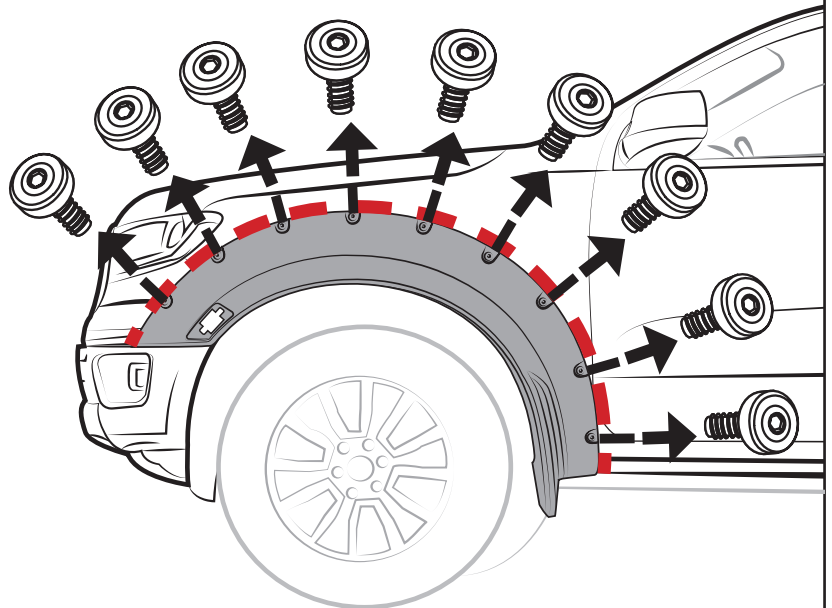
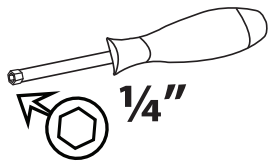

12 REMOVE

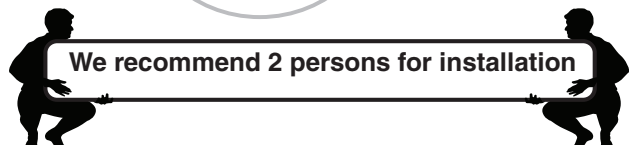
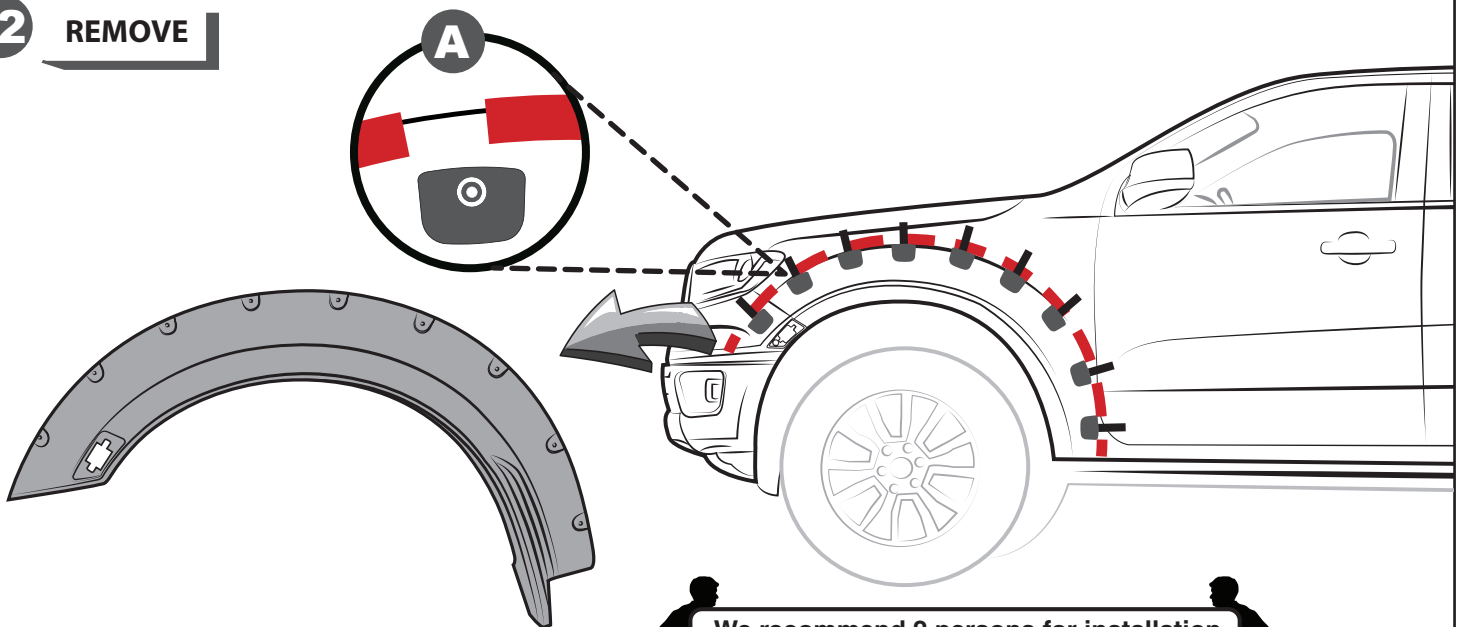



SUPER BOLT INSTALLATION

13 PRESS SUPER BOLTS STUDS

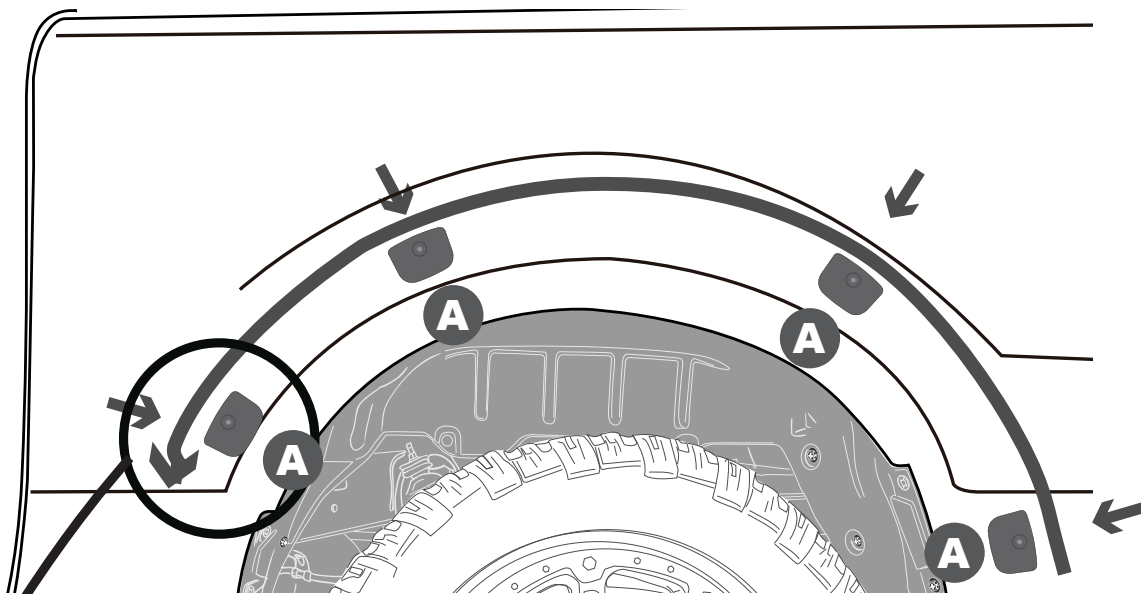

ATTENTION

FOR GOOD ADHESION IT IS NECESSARY TO APPLY AS MUCH PRESSURE AS POSSIBLE ALL OVER THE EDGE AND CENTER OF THE SUPER BOLTS STUDS.

SUPER BOLT STUDS

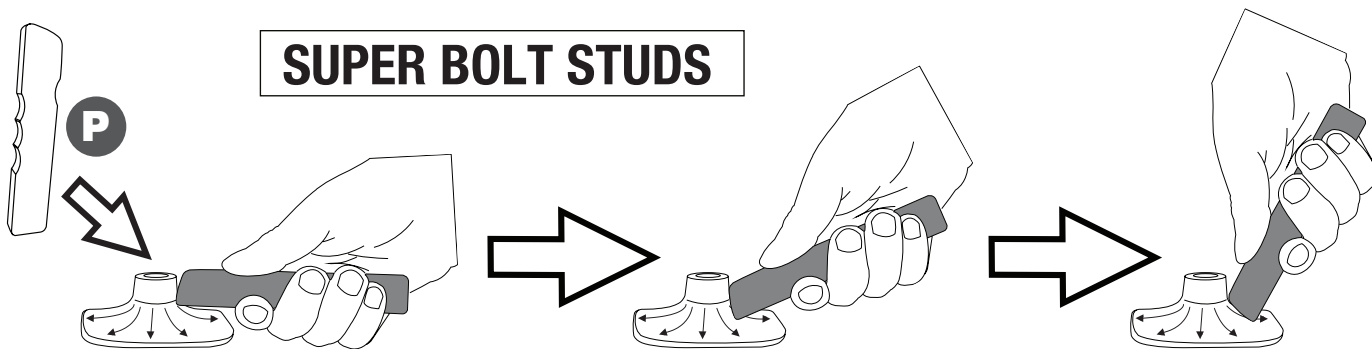

PRESSURE POINTS



40-50 N/cm



**A full surface contact between tape and substrate is decisive for good adhesion performance.
Contact is achieved by applying pressure.
In practice a pressure between 40 and 50 N/cm² is usually needed and an application temperature between 25 and 45 °C or 77 and 113 °F is also necessary.
During application, add-on parts and tapes must have the similar temperature.**



14 PLACE PVC TRIM

! IF IT IS NECESSARY

! REMOVE LINER

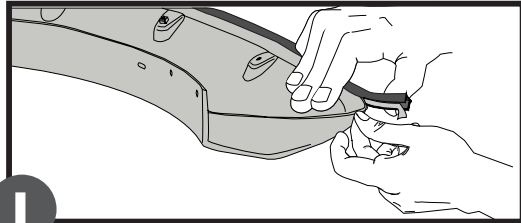
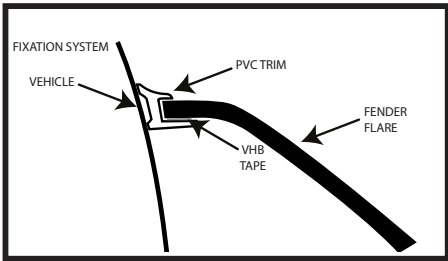

↑
END

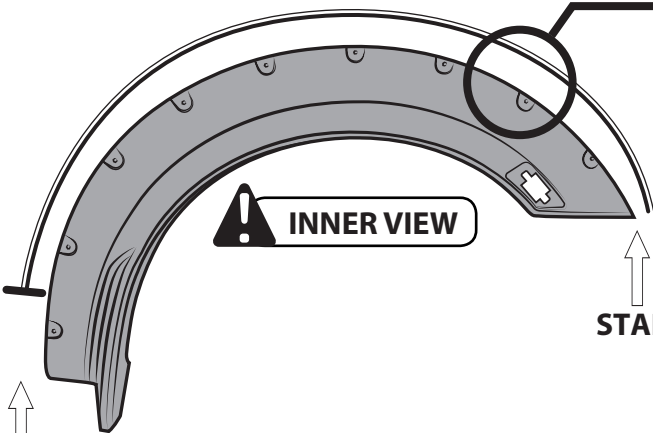

! INNER VIEW

START

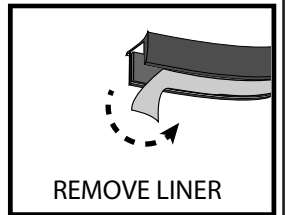
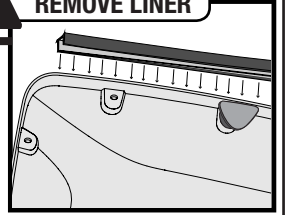

REMOVE LINER

15 PLACE LIGHT TO FENDER

16 CONNECT

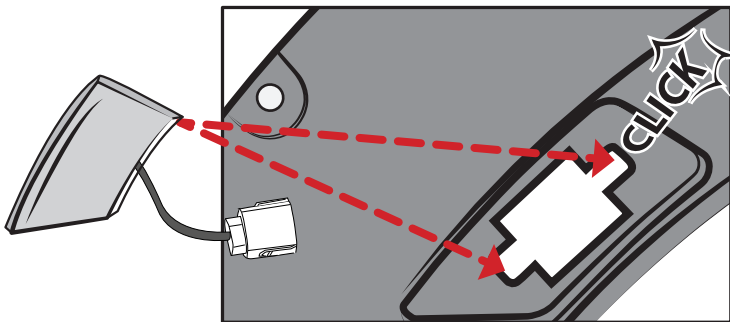

! ALIGN FENDER FLARE TOP EDGE WITH THE GREASE PENCIL HASH MARKS AND PLACE.

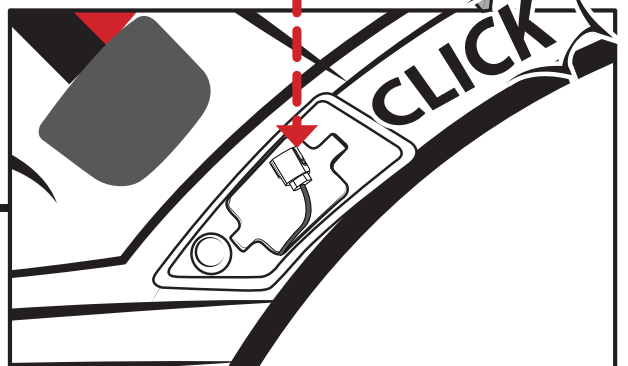
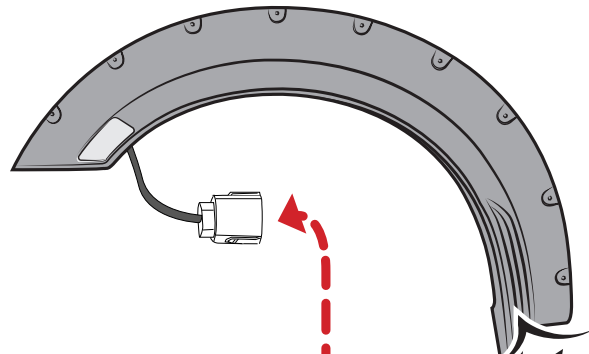

17 APPLY LOCTITE THREADLOCKER TO SUPER BOLTS THREAD

! ATTENTION

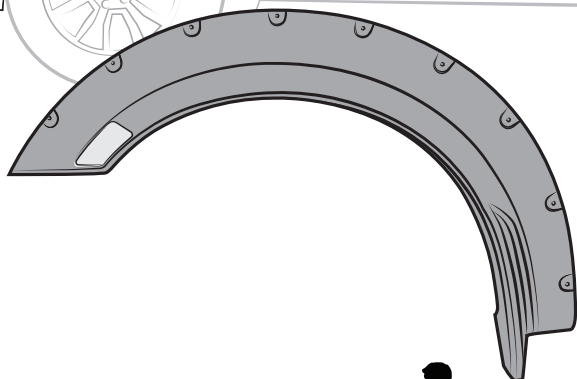
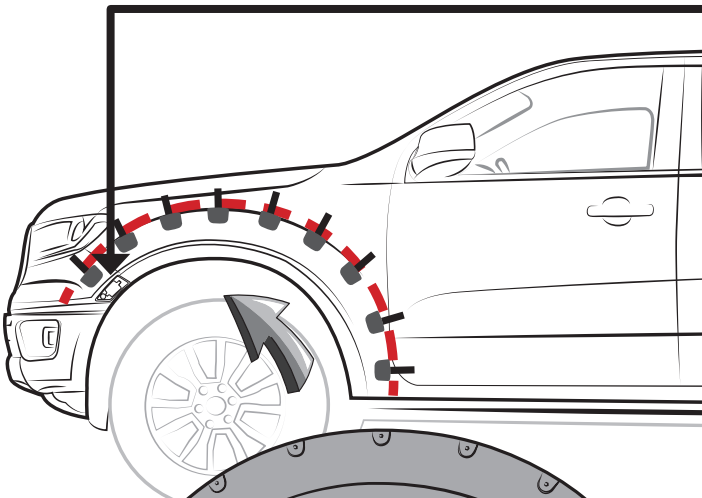
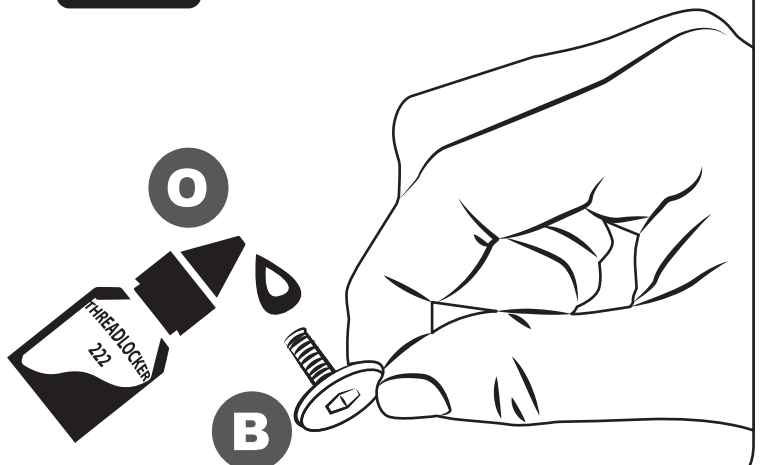

We recommend 2 persons for installation



18 SCREW SUPER BOLTS

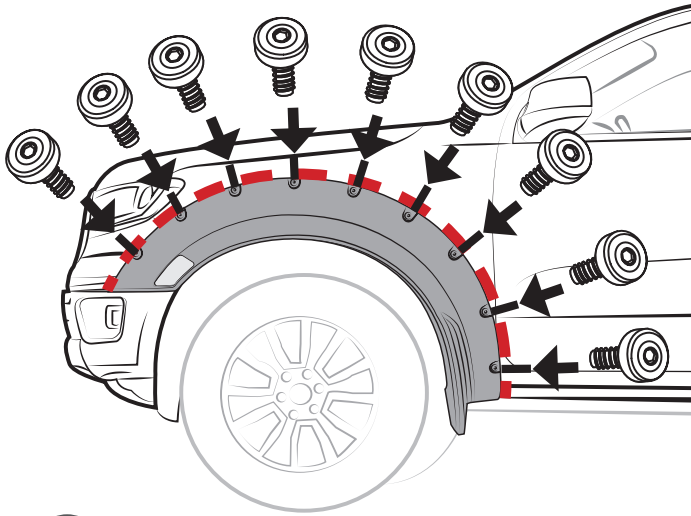

! HAND TIGHT

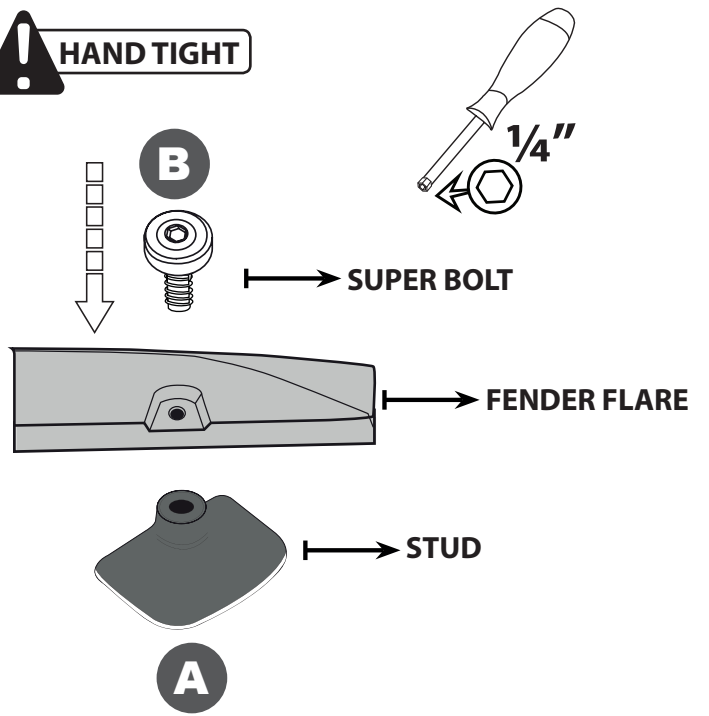

19 SECURE THE PART

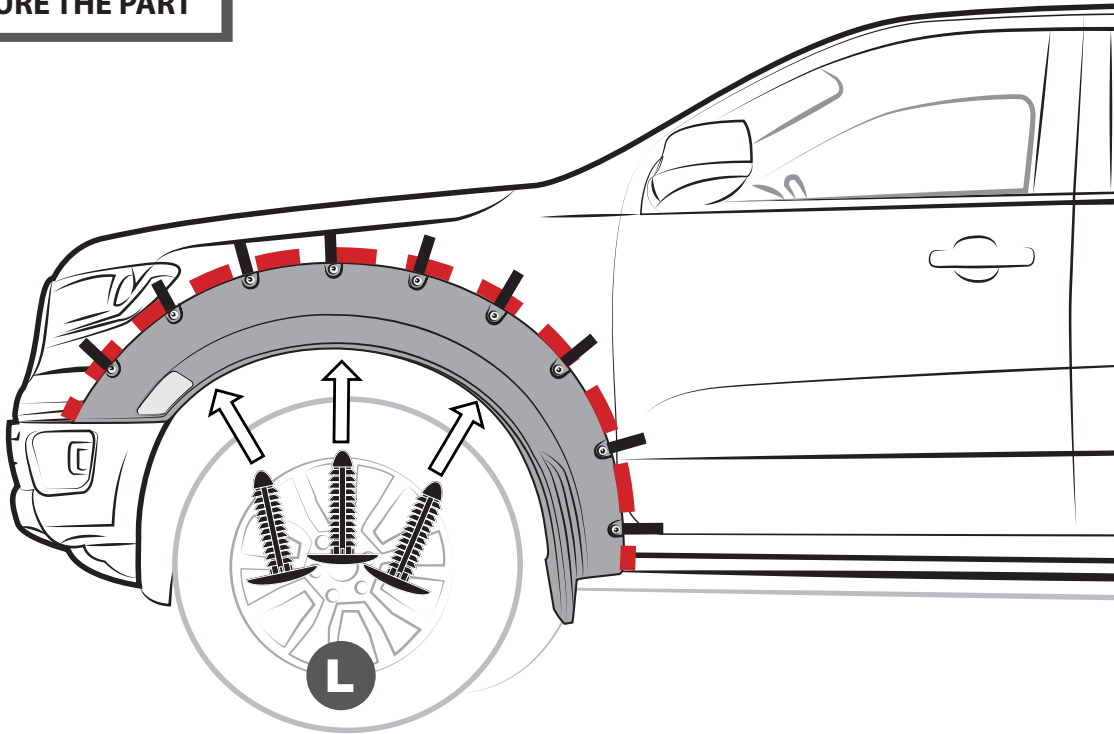

20 DRILL

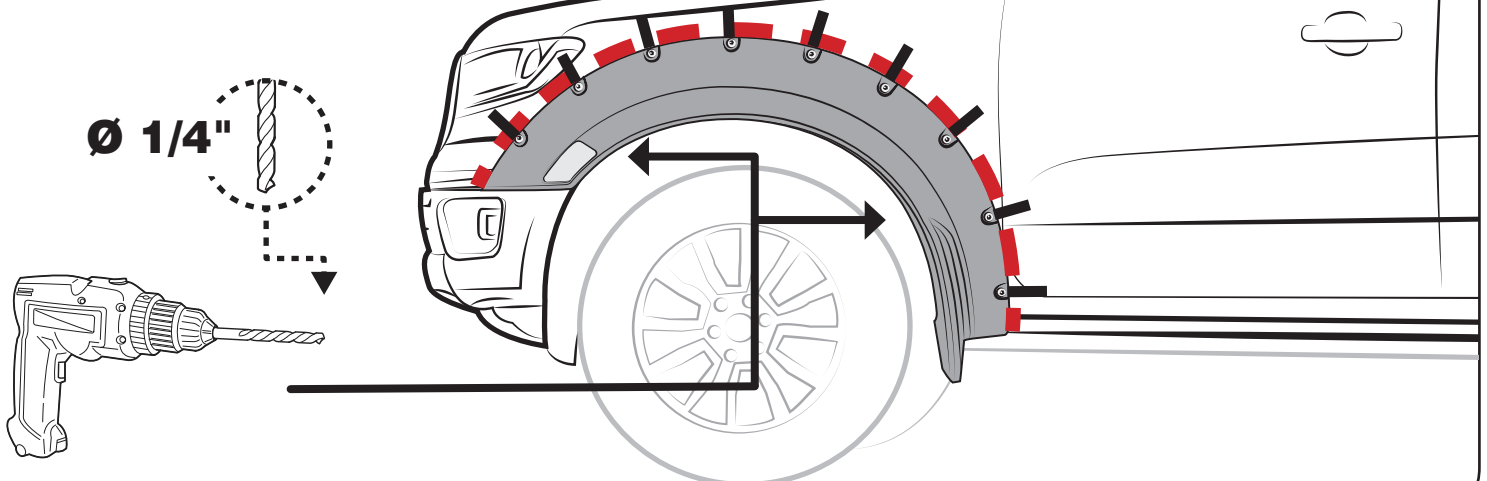



21 PLACE PUSH PINS

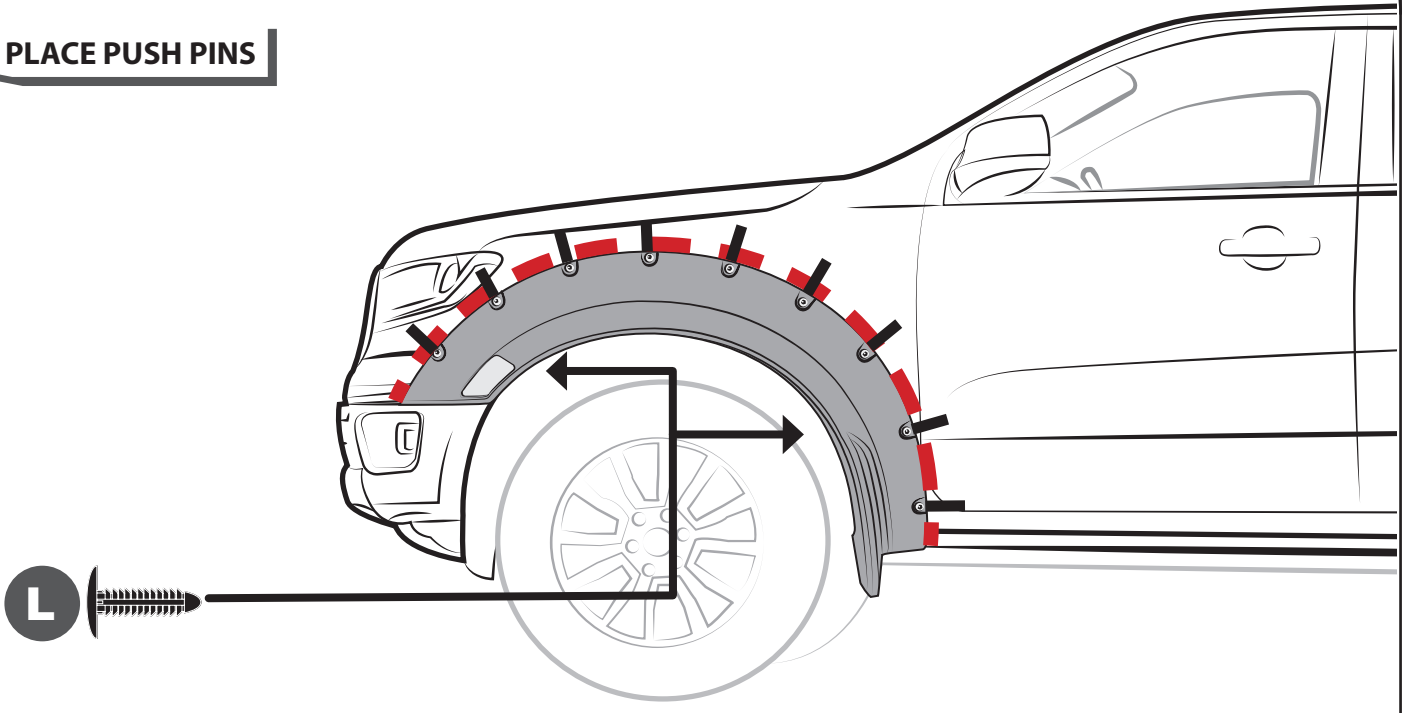

22 PLACE U-CLIP

! BOTTOM VIEW

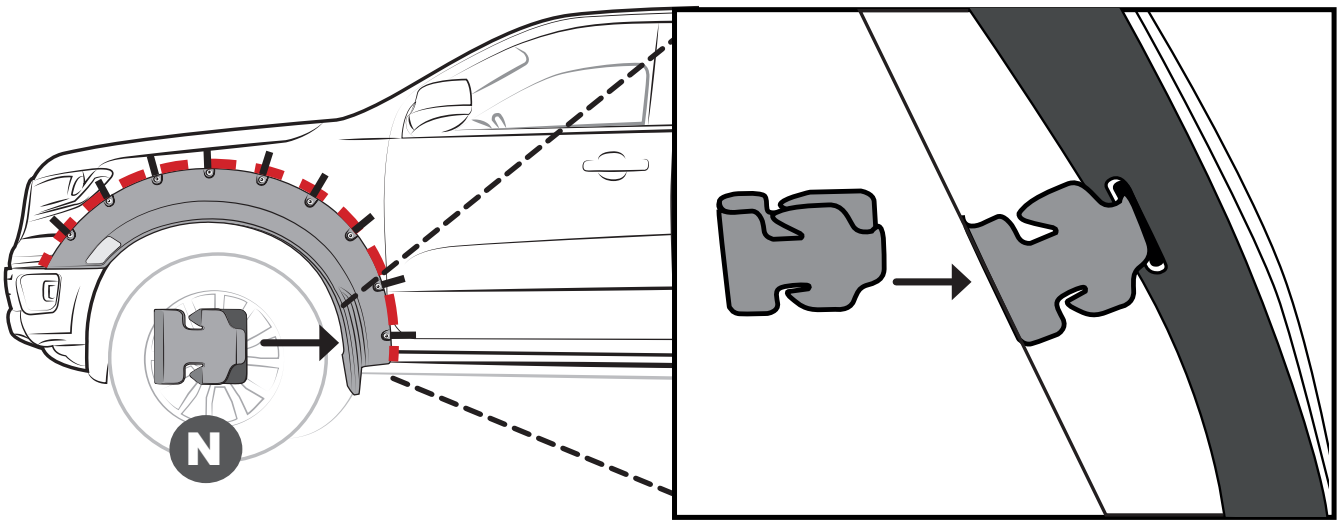

23 PLACE U-CLIP

! BOTTOM VIEW

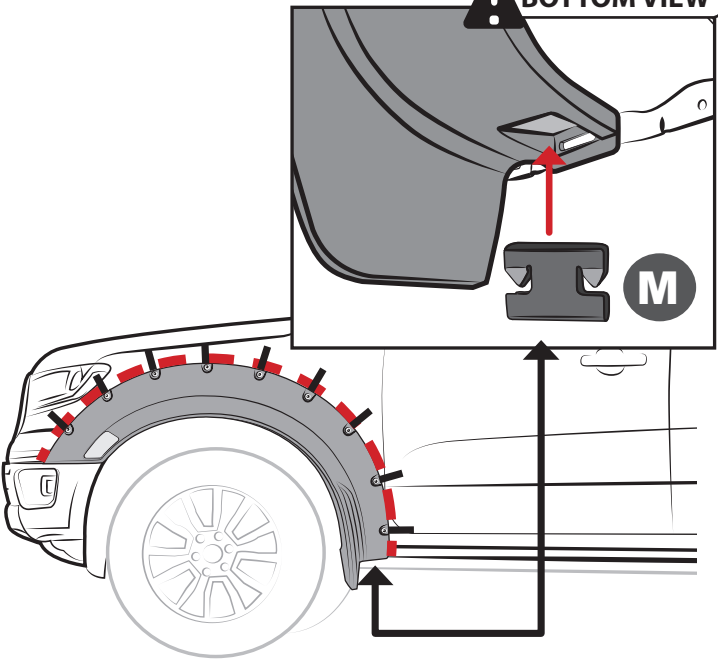

24 CLEAN OFF GREASE PENCIL MARK

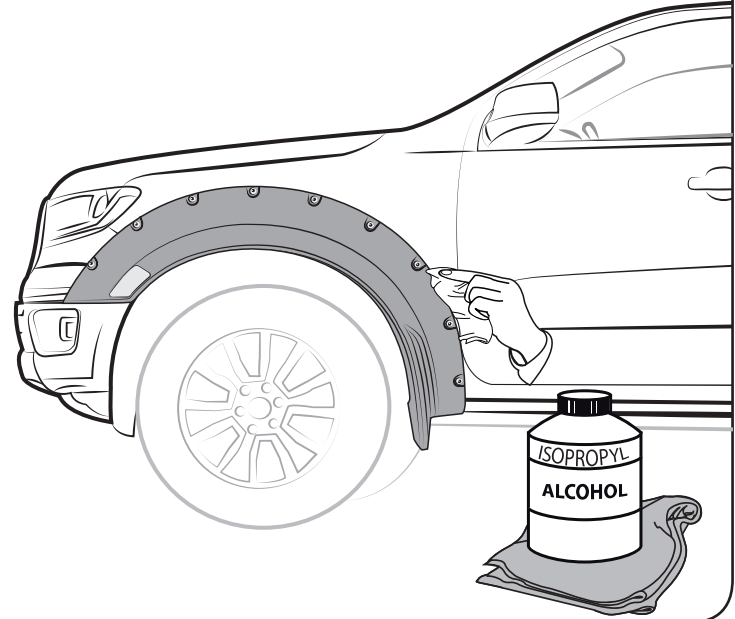



REAR RIGHT & LEFT FLARE

! WASH WITH WATER, DETERGENT AND SOFT CLOTH OR SPONGE

25 REMOVE FACTORY FASTENERS

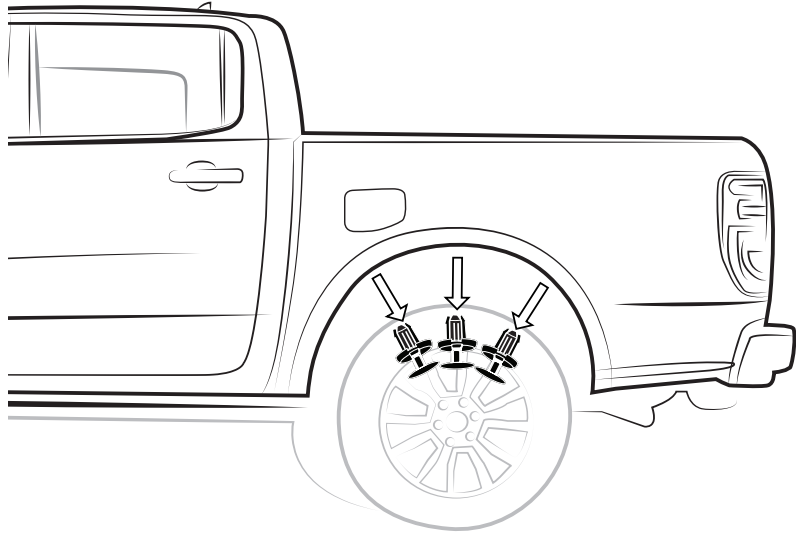
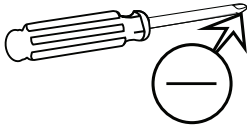
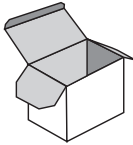

26 CLEAN

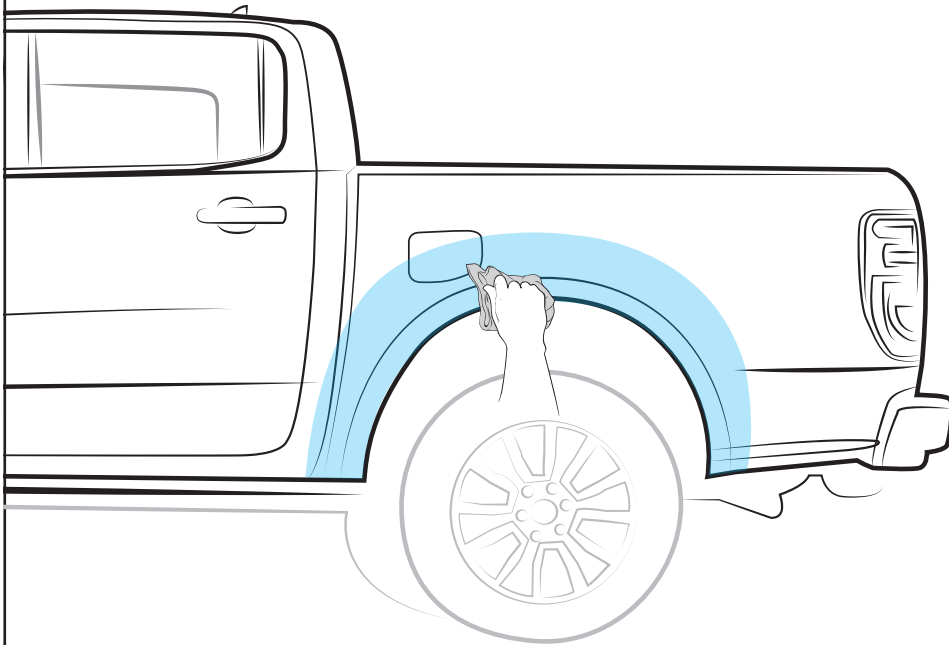

27 PRE-INSTALL

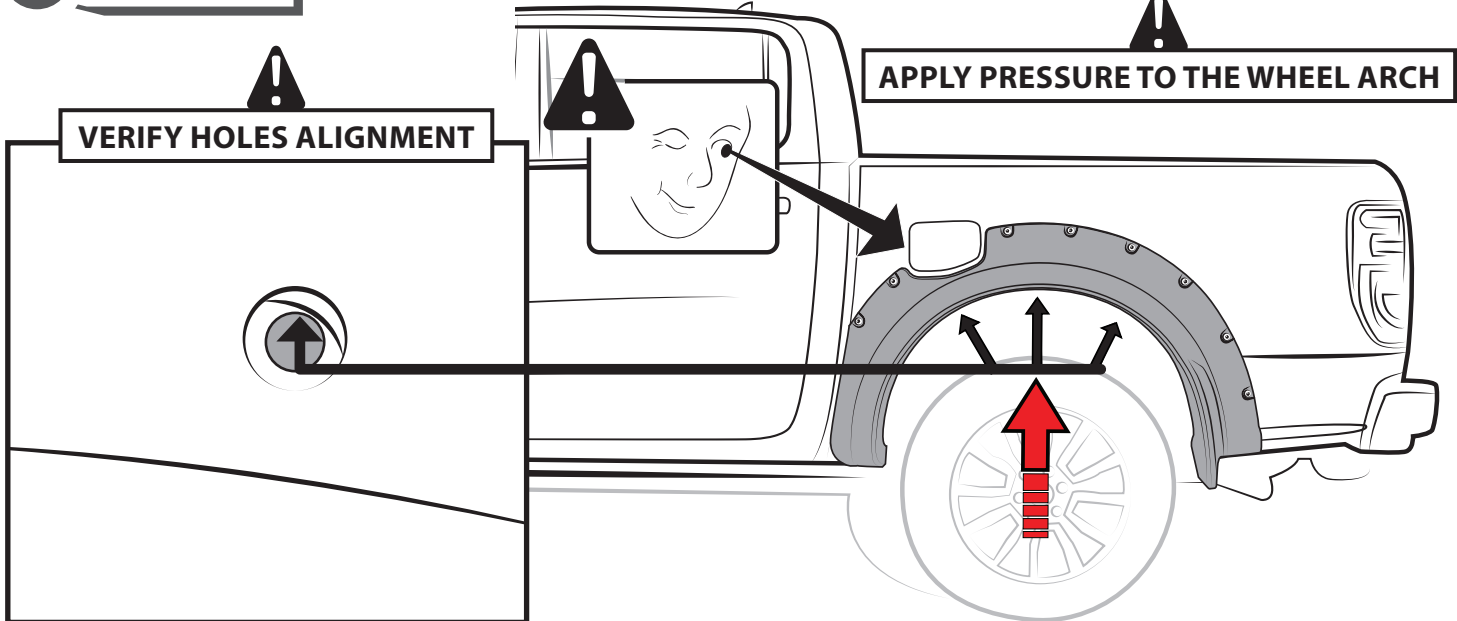



28 MARK SILHOUTTE & SUPER BOLTS POSITION

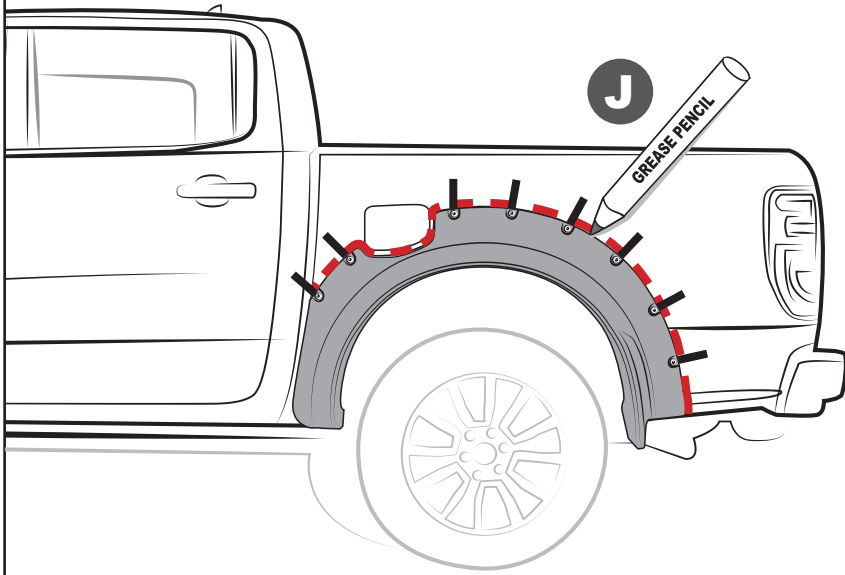

! HASH MARKS

DRAW CENTER HASH MARK WITH GREASE PENCIL AT CENTER, BOTH SIDES, ON EACH SUPER BOLT AND SHEET METAL. THIS WILL ENSURE FENDER FLARE WILL BE CENTERED TO GREASE PENCIL OUTLINE.

29 REMOVE

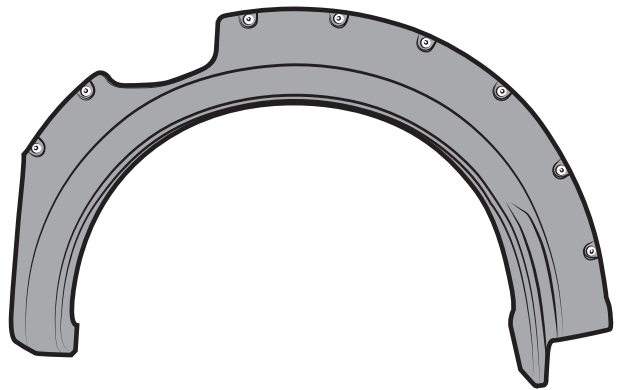
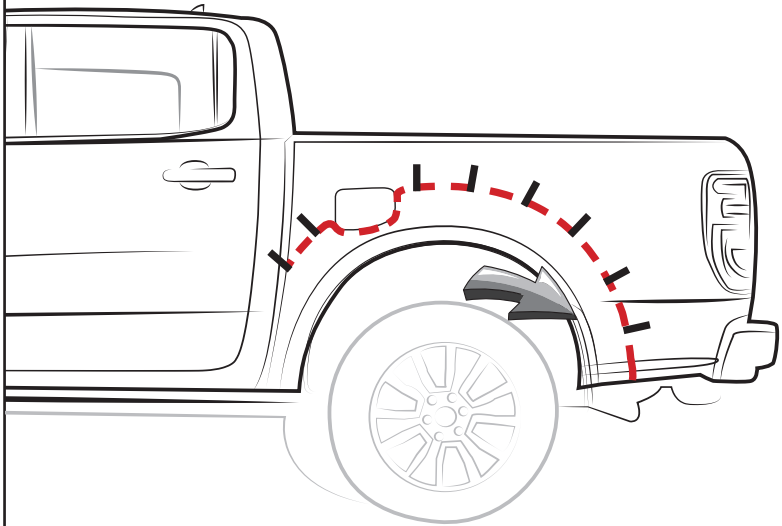

30 ADHESION PROMOTER

APPLICATION AREA

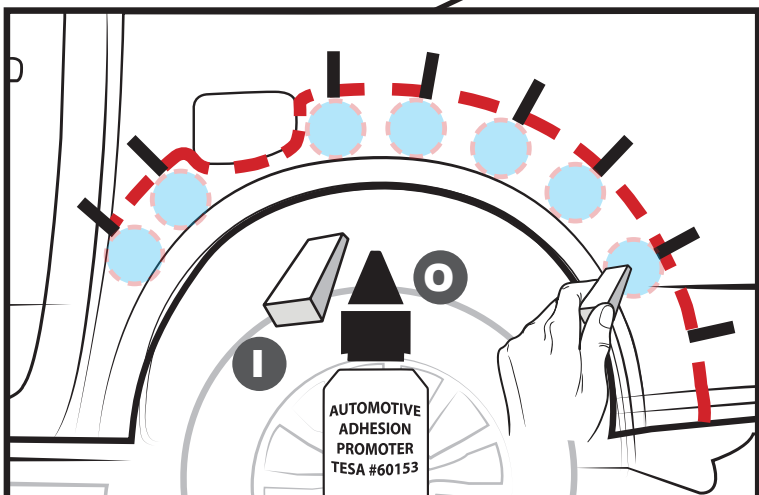

31 REMOVE LINER

! INNER VIEW

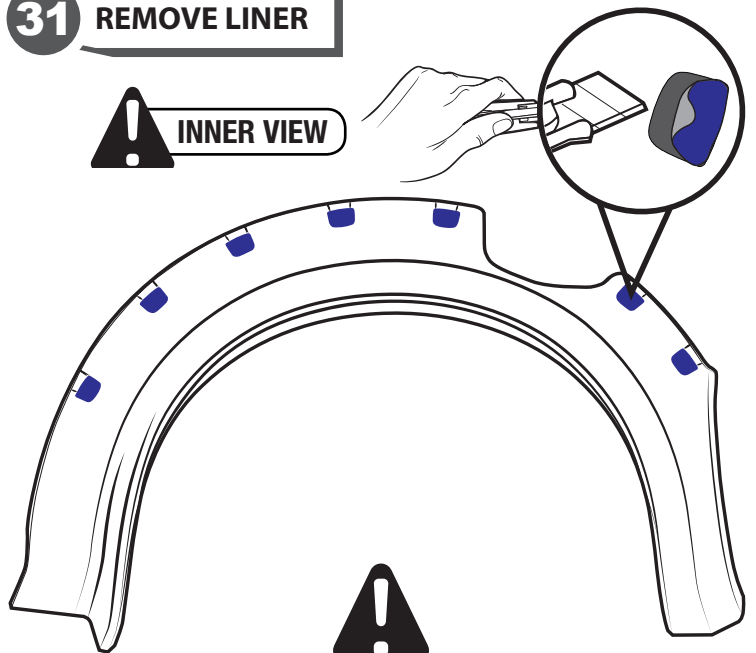

WARM SURFACES WITH HEAT GUN IF SURFACE TEMPERATURES IS TOO COLD.



32 PLACE

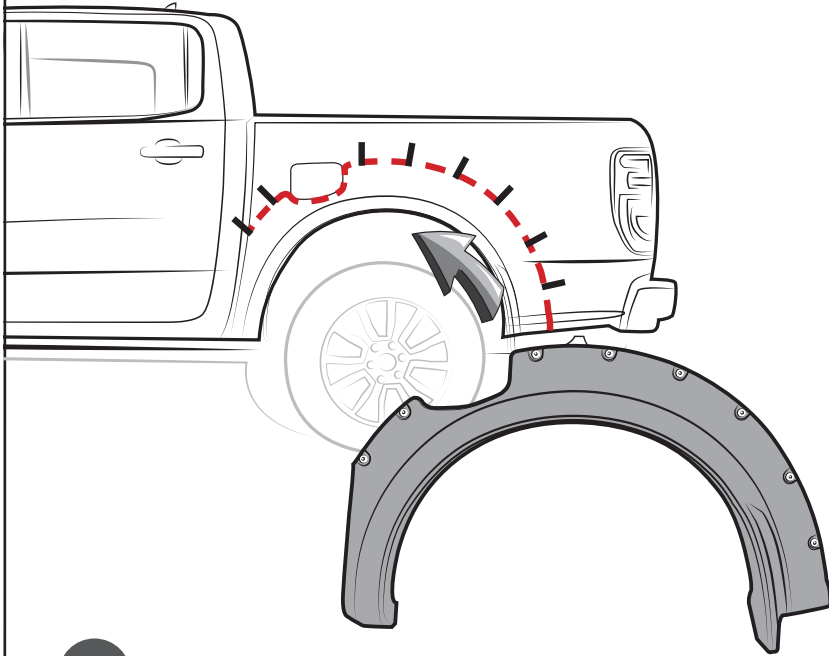

ALIGN FENDER FLARE TOP EDGE WITH THE GREASE PENCIL HASH MARKS AND PLACE.

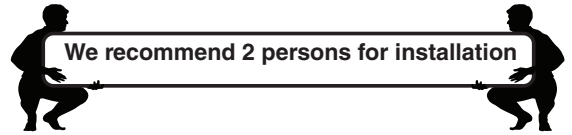

We recommend 2 persons for installation

33 SECURE THE PART

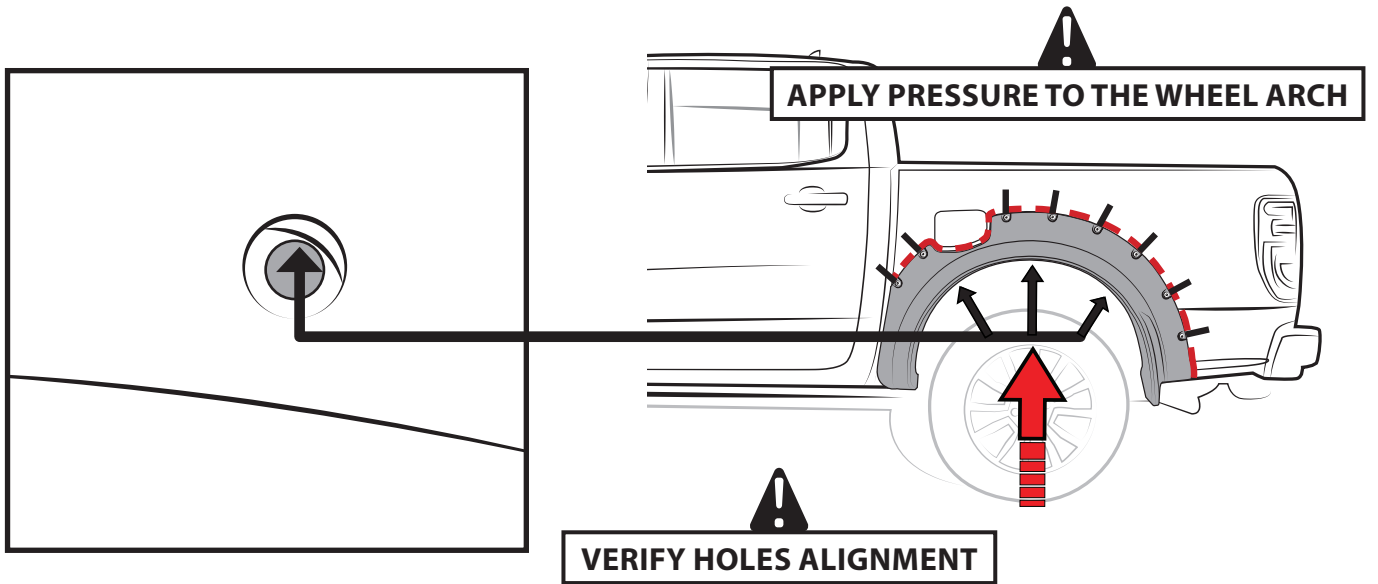

APPLY PRESSURE TO THE WHEEL ARCH

VERIFY HOLES ALIGNMENT

34 APPLY PRESSURE ON EACH SUPERBOLT

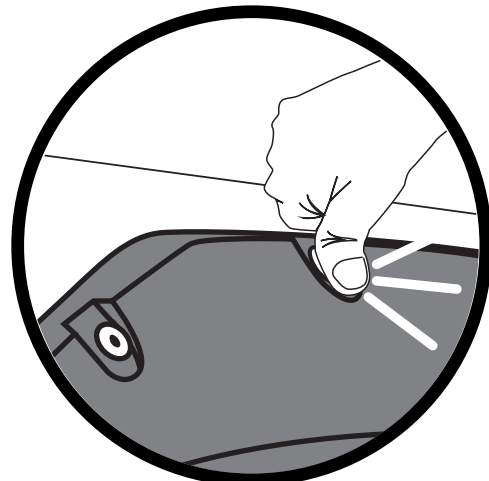
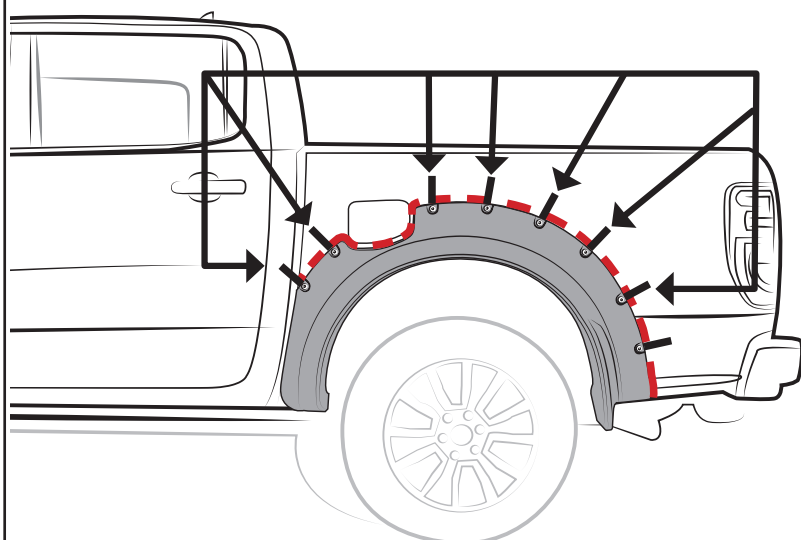



35 REMOVE SUPER BOLTS

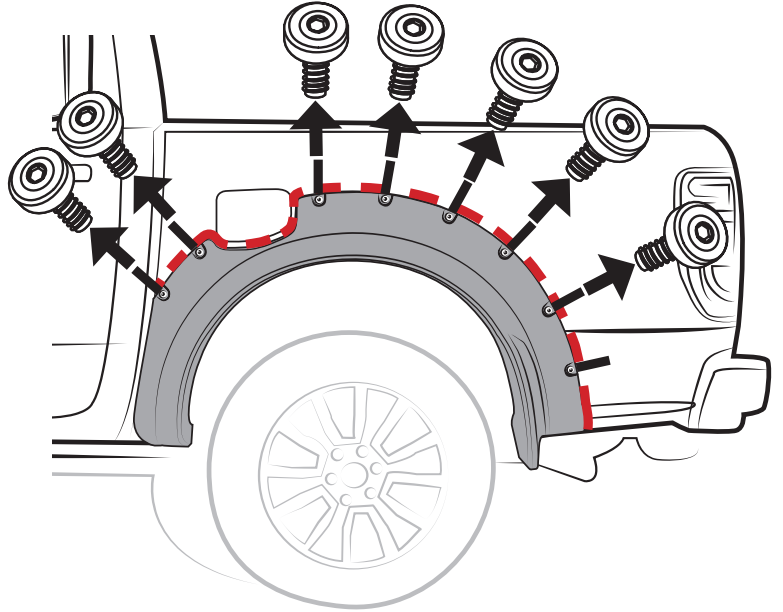
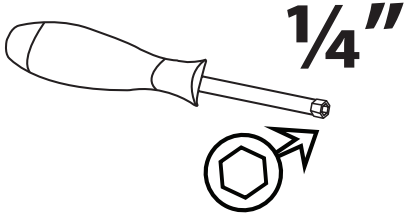

36 REMOVE

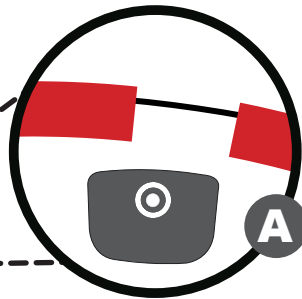
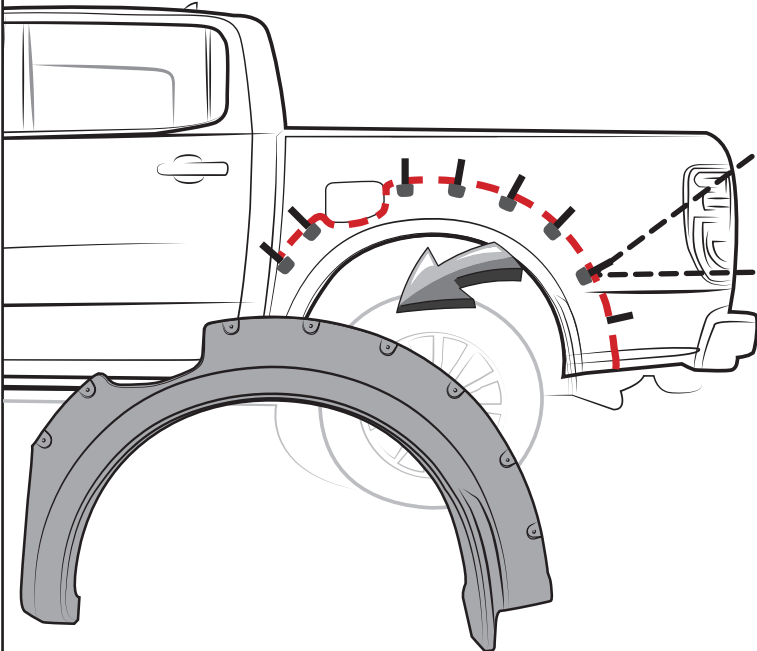



SUPER BOLT INSTALLATION

37 PRESS SUPER BOLTS STUDS

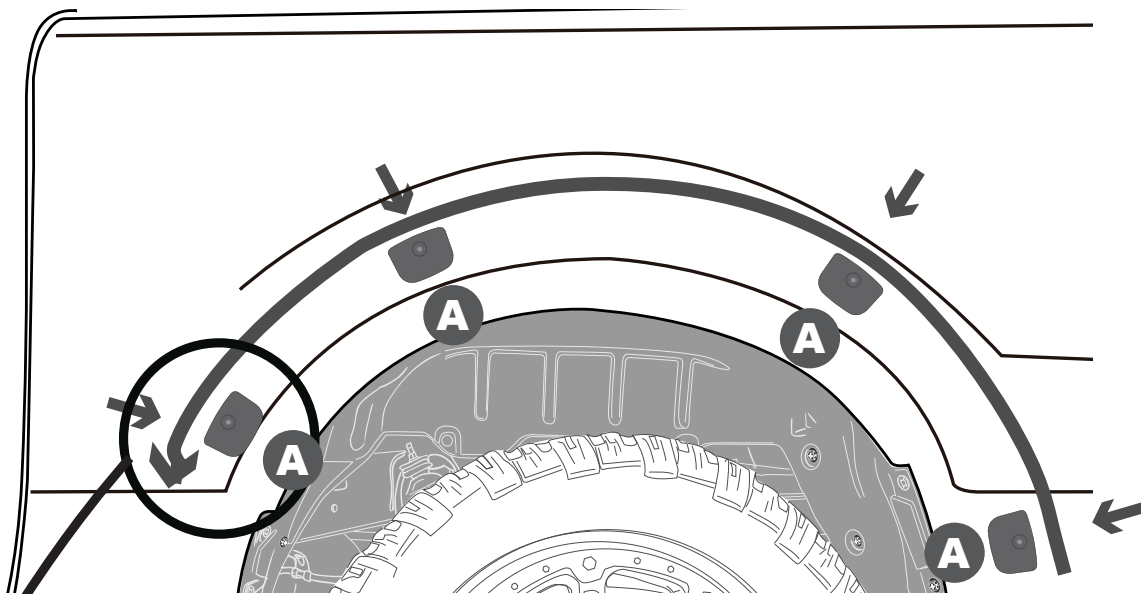

ATTENTION

FOR GOOD ADHESION IT IS NECESSARY TO APPLY AS MUCH PRESSURE AS POSSIBLE ALL OVER THE EDGE AND CENTER OF THE SUPER BOLTS STUDS.

SUPER BOLT STUDS

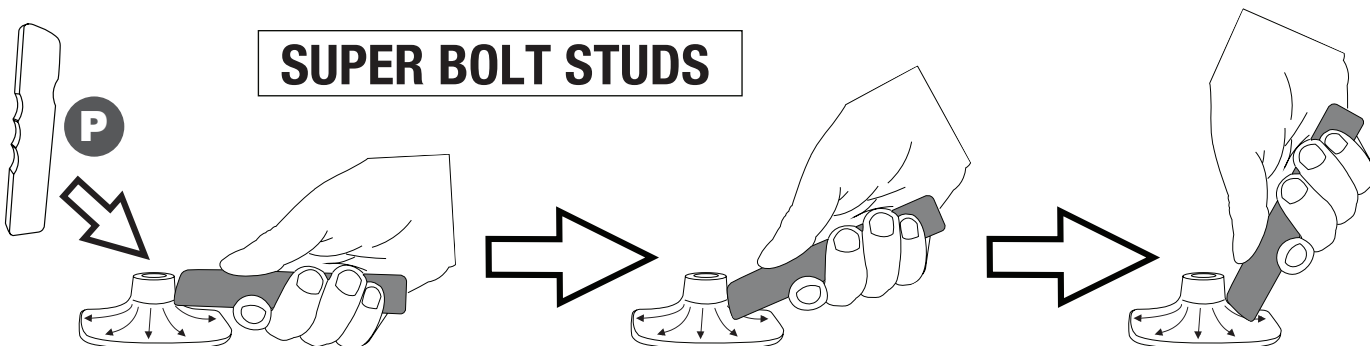

PRESSURE POINTS



40-50 N/cm



**A full surface contact between tape and substrate is decisive for good adhesion performance.
Contact is achieved by applying pressure.
In practice a pressure between 40 and 50 N/cm² is usually needed and an application temperature between 25 and 45 °C or 77 and 113 °F is also necessary.
During application, add-on parts and tapes must have the similar temperature.**



38 PLACE PVC TRIM

IF IT IS NECESSARY

REMOVE LINER

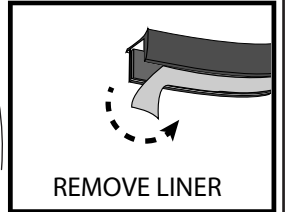
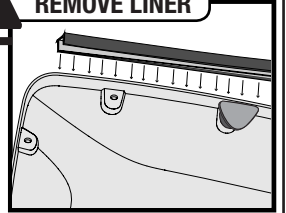
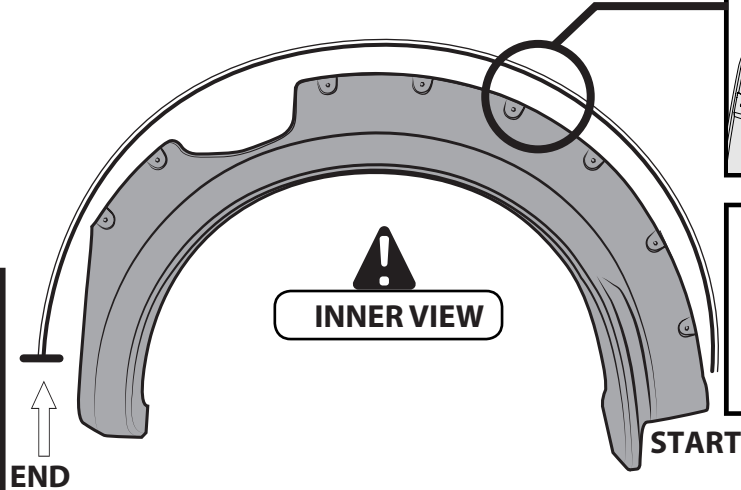
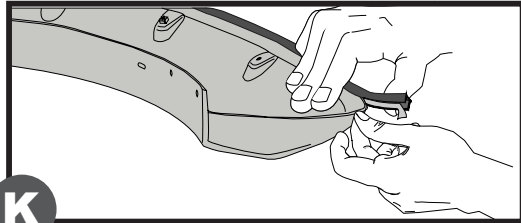
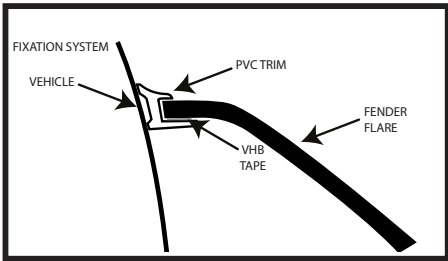

39 PLACE

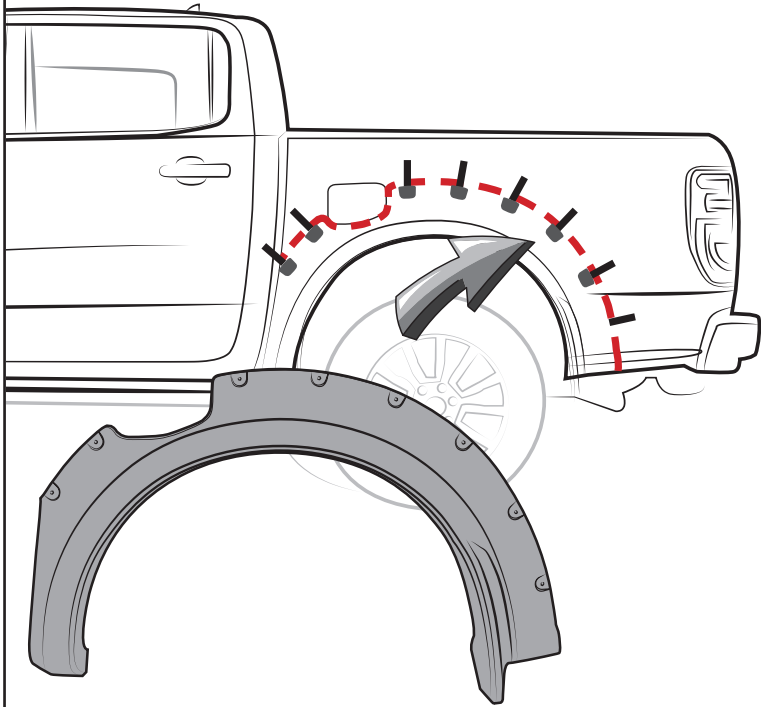

ALIGN FENDER FLARE TOP EDGE WITH THE GREASE PENCIL HASH MARKS AND PLACE.

We recommend 2 persons for installation

40 SECURE THE PART

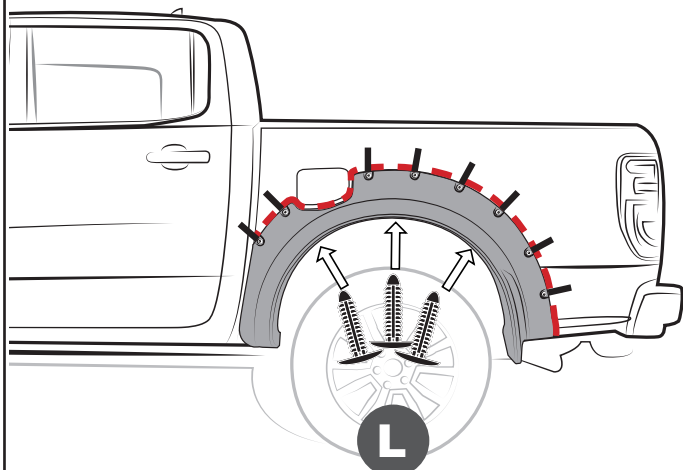

41 APPLY LOCTITE THREADLOCKER TO SUPER BOLTS THREAD

ATTENTION





42 SCREW SUPER BOLTS

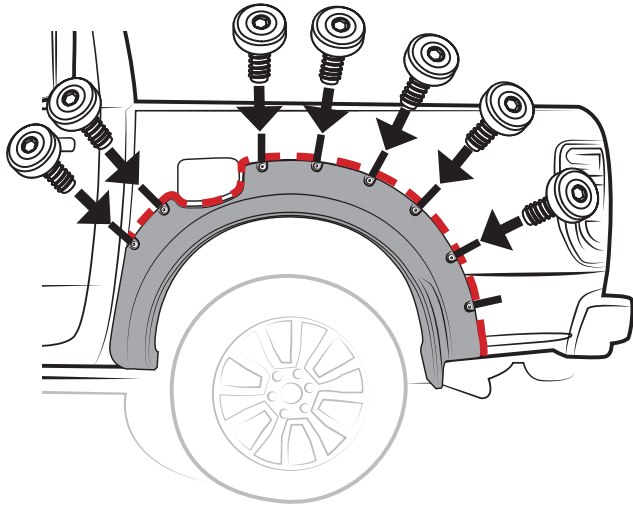

! HAND TIGHT

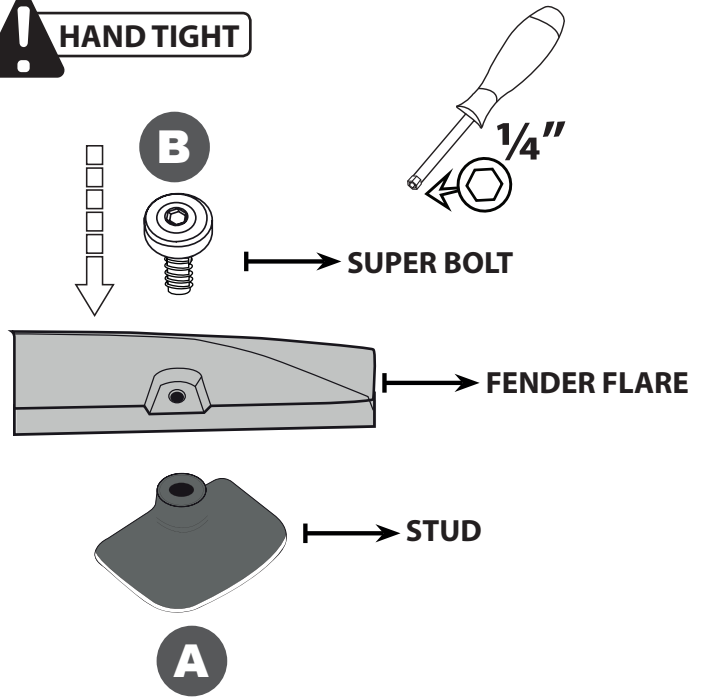

43 DRILL

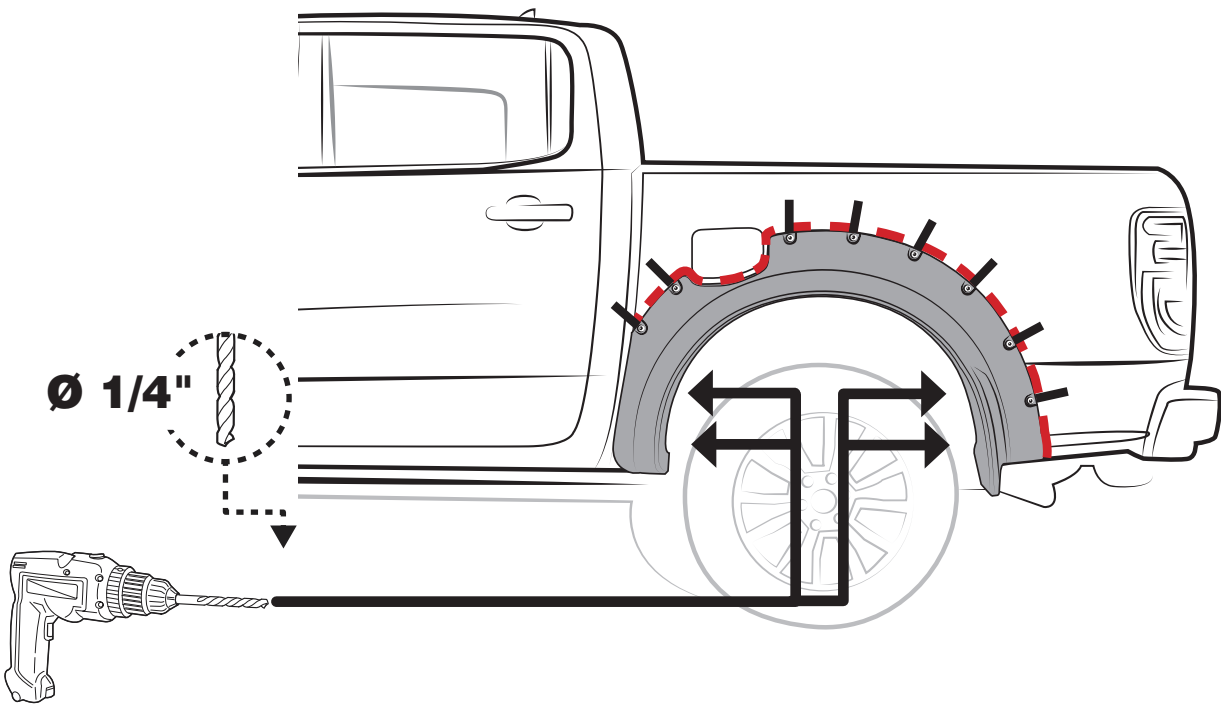

44 PLACE PUSH PINS

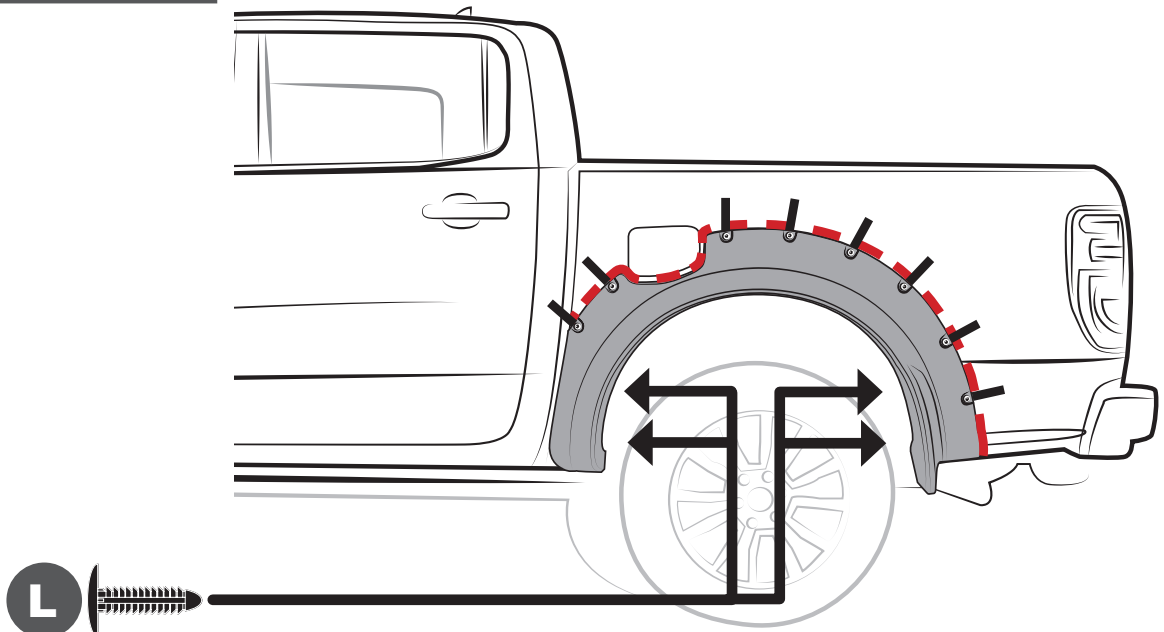



45 PLACE U-CLIPS

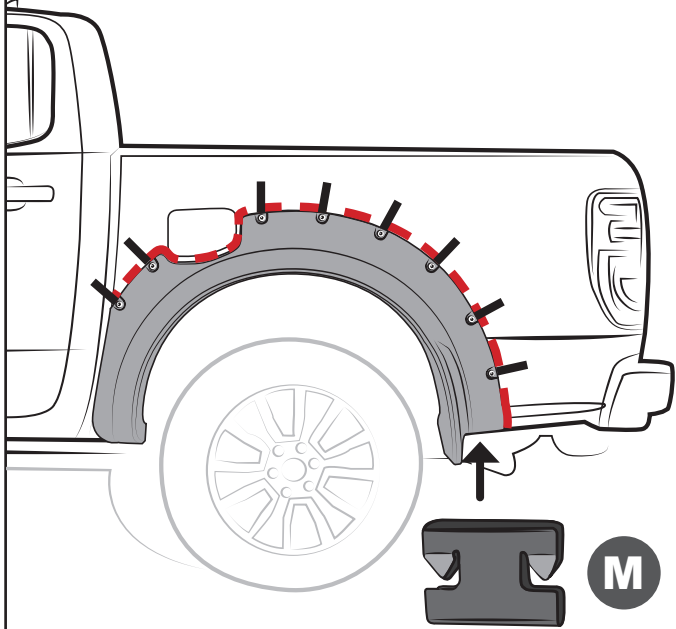

! BOTTOM VIEW

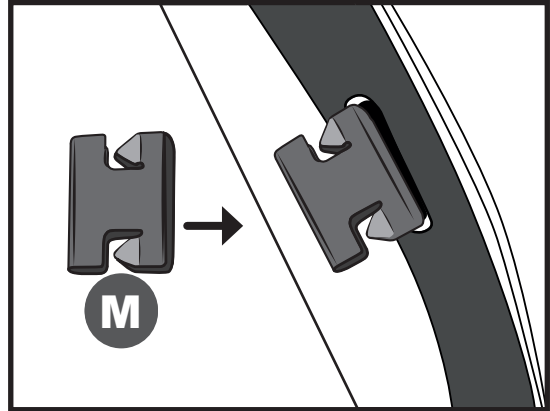

46 PLACE SCREW

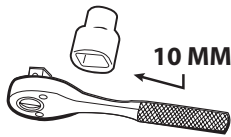
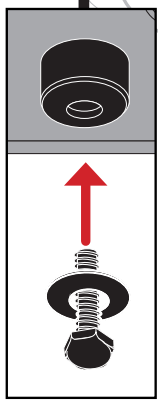
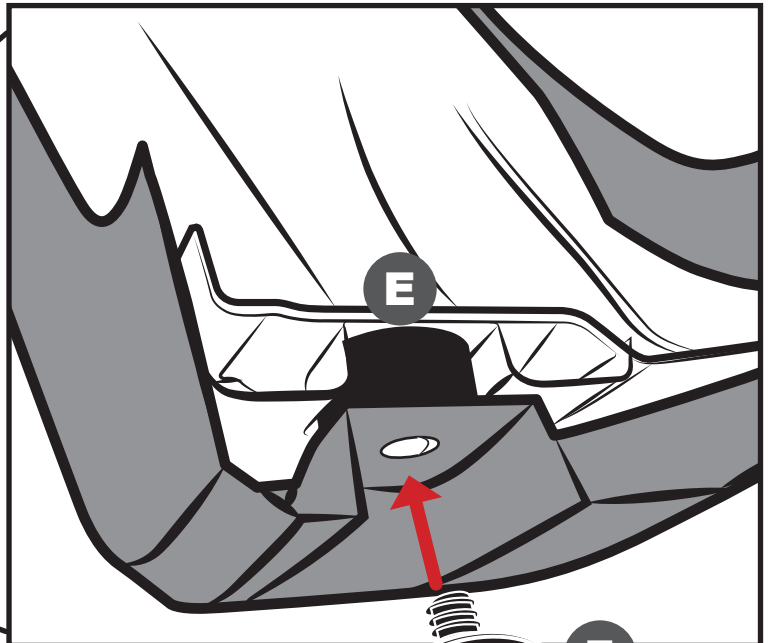
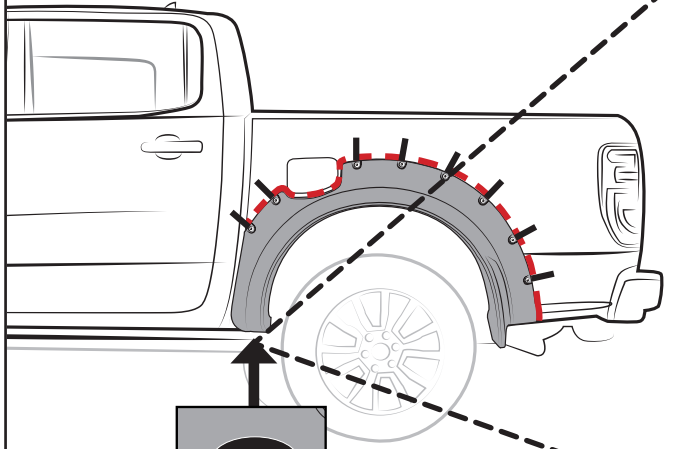

CLEAN OFF GREASE PENCIL MARK

REPEAT ALL STEPS FOR RH SIDE

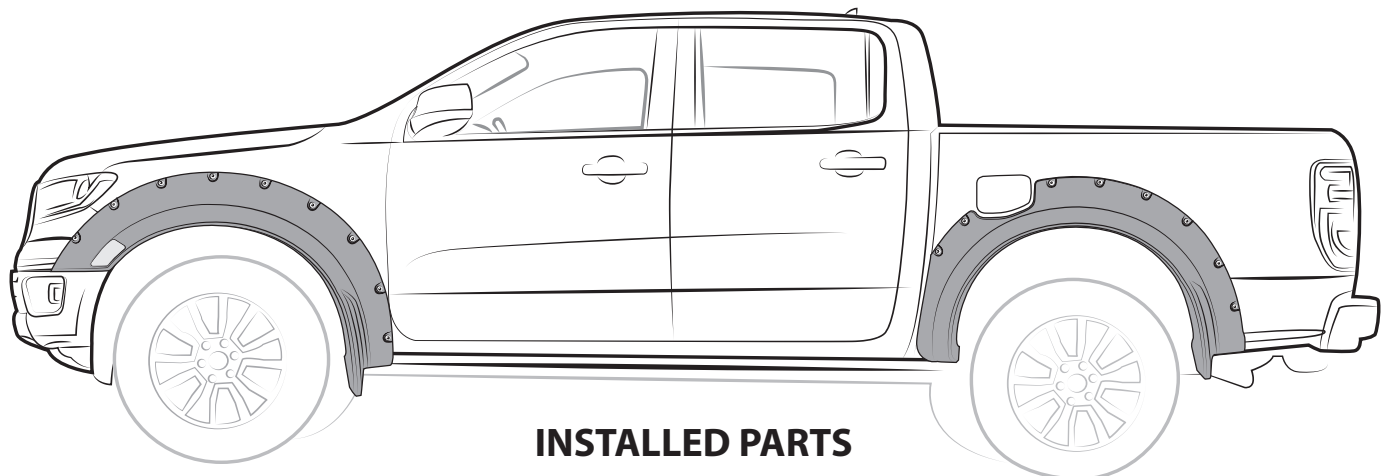

INSTALLED PARTS