



GM - SILVERADO 2019

INSTALLATION MANUAL



**READ CAREFULLY BEFORE
INSTALLATION**

4X FENDER FLARE SET 2019 SILVERADO PART #: 102542

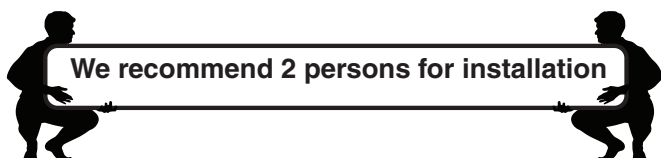
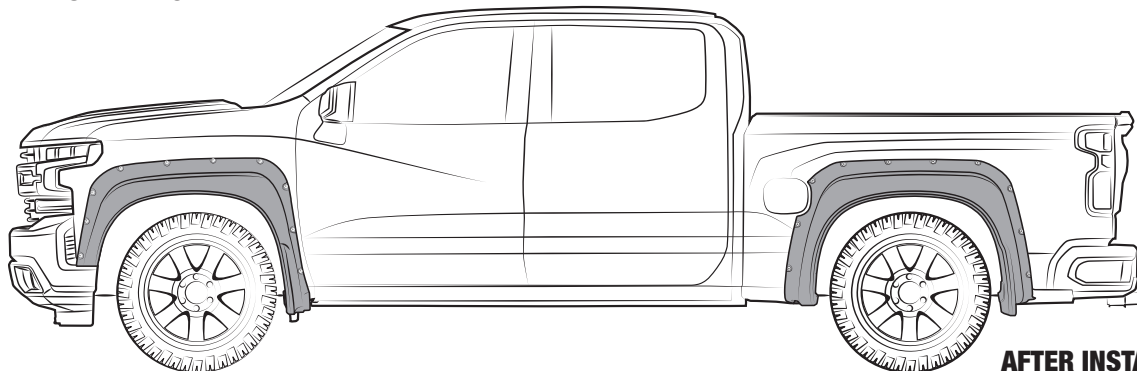

AFTER INSTALLING

**DO NOT
WASH CAR**



**DRIVE SLOWLY
25 mph max**



24 hrs

TOOLS



CHECK LIST

*Already installed in the part

ITEM	DESCRIPTION	DRAWING	AMOUNT
A	*SUPER BOLTS RUBBER STUDS		40 PCS
B	*STAINLESS SUPER BOLT M6 X 14		40 PCS
C	AUTOMOTIVE ADHESION PROMOTER TESA # 60153		1 PC
D	APPLICATION SPONGE		1 PC
E	GREASE PENCIL		1 PC
F	*PVC PROFILE		29 FT
G	S-CLIP S03		4 PCS
H	U-CLIP U04		8 PCS
I	THREADLOCKER 3222		1 PC
J	BONE FOLDER		1 PC
K	SPACER 14 mm		4 PCS
L	NICKEL SCREW 3.9 X 32 mm		4 PCS
M	NICKEL HEX. TIN SCREW 6 X 20 mm		2 PCS
N	WASHER NICKEL. 1/4"		4 PCS
O	SAFETY NUT 6 mm INOX.		2 PCS
P	WASHER NICKEL. 3/16"		4 PCS
Q	SUPPORT Z 29		2 PCS
R	U-NUT 4.2 x 14 mm		2 PCS
S	WÜRTH SCREW 4.8 x 19 mm		2 PCS



Vehicle and part must be at 16°C or 60°F or more before installation.

Keep the vehicle and parts in an environment that is within the recommended installation temperature range for 4 hours.

FRONT FENDER FLARE

1 REMOVE FACTORY FASTENERS

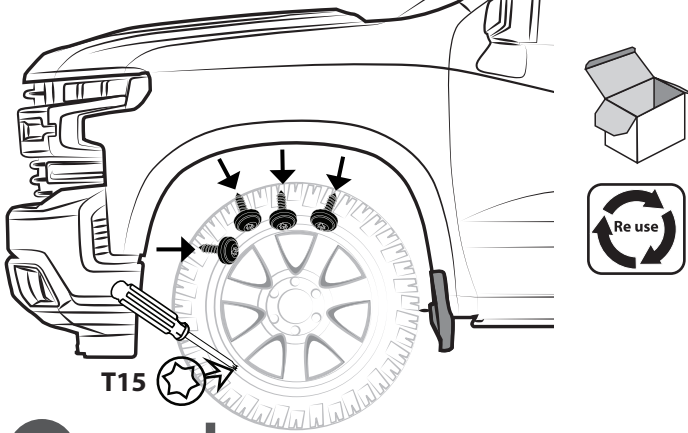

2 REMOVE MUD GUARD

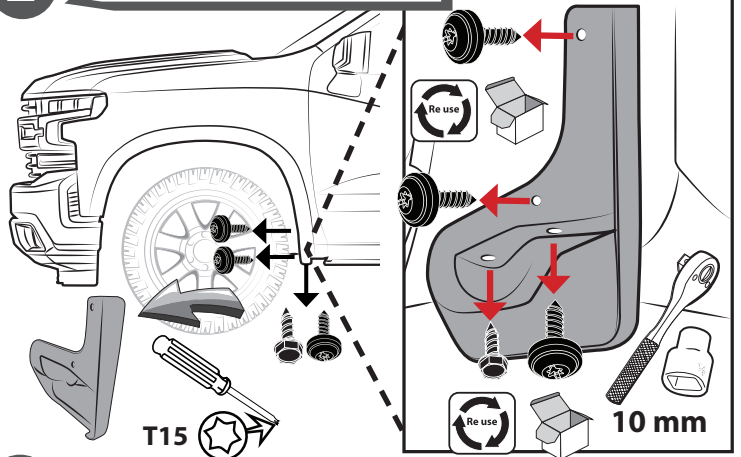

3 CLEAN

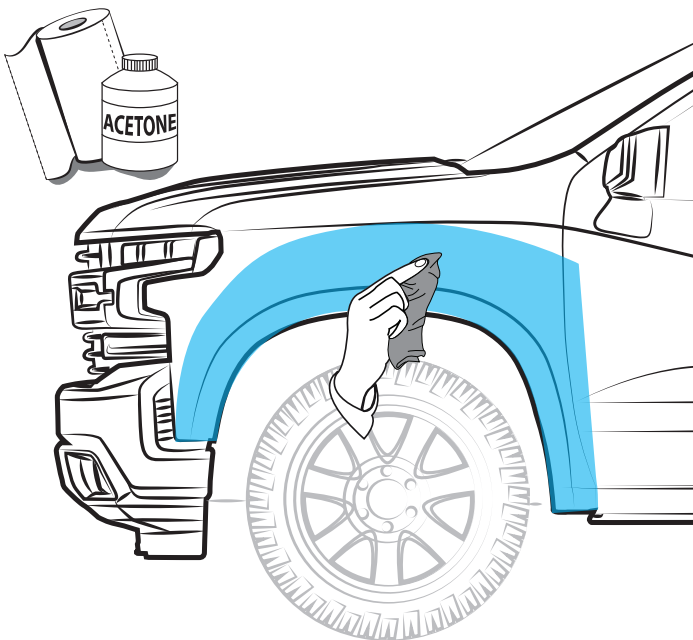

4 PRE-INSTALL & SCREW

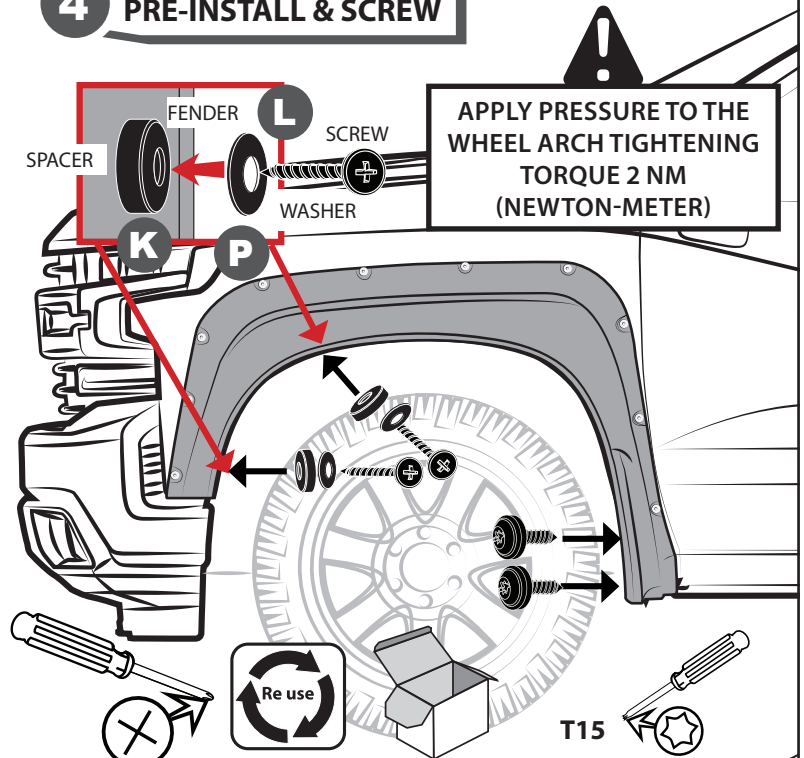

5 MARK

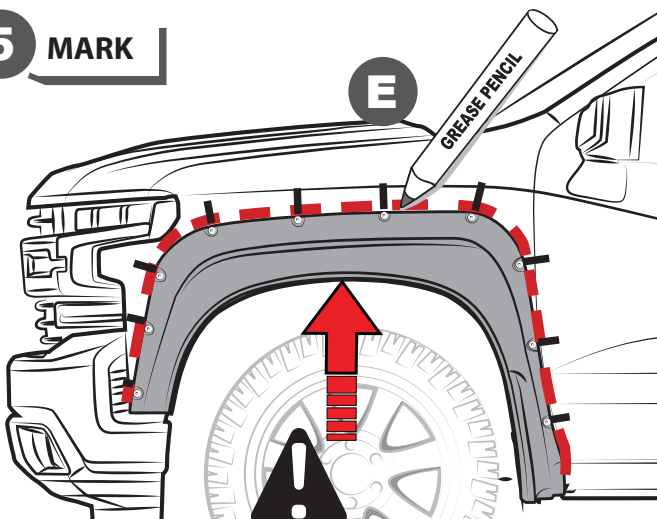

6 UNSCREW & REMOVE

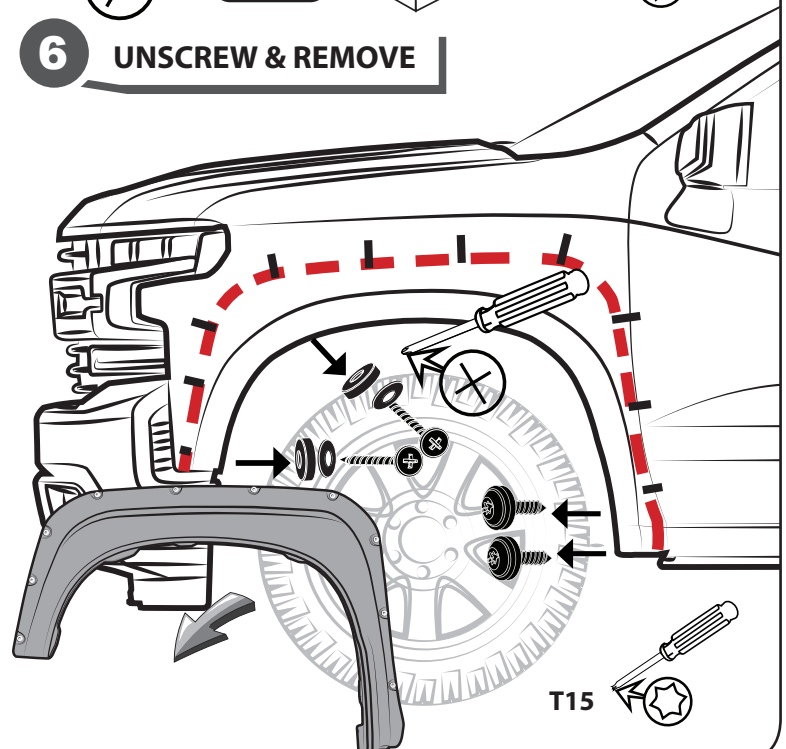

DRAW CENTER HASH MARK WITH GREASE PENCIL AT CENTER, BOTH SIDES, ON EACH SUPER BOLT AND SHEET METAL. THIS WILL ENSURE FENDER FLARE WILL BE CENTERED TO GREASE PENCIL OUTLINE.



INSTALLATION MANUAL

7 ADHESION PROMOTER

APPLICATION AREA

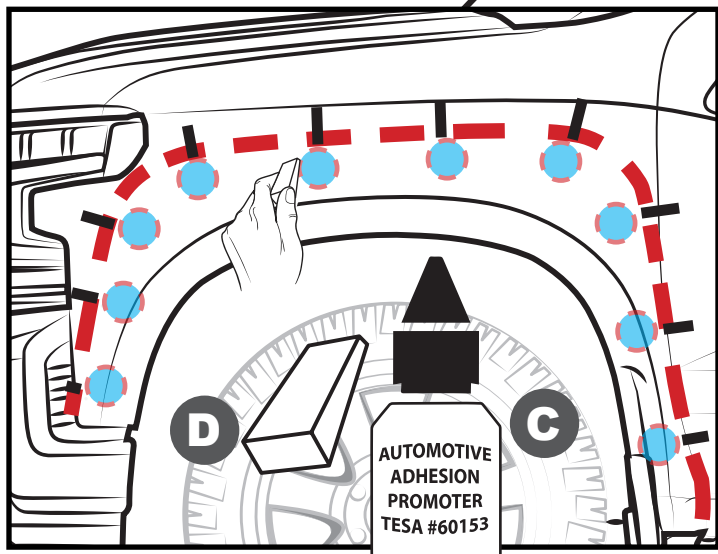

8 REMOVE LINER

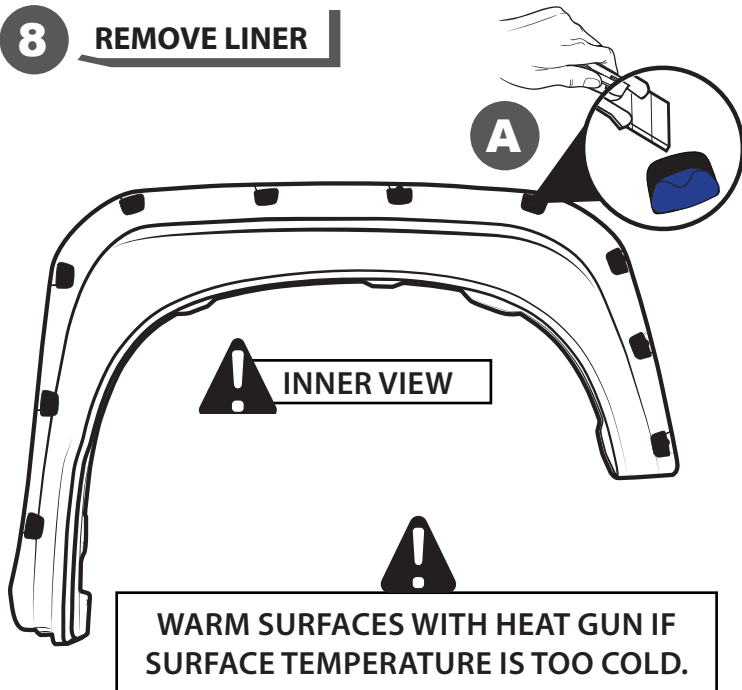

9 PLACE & SCREW

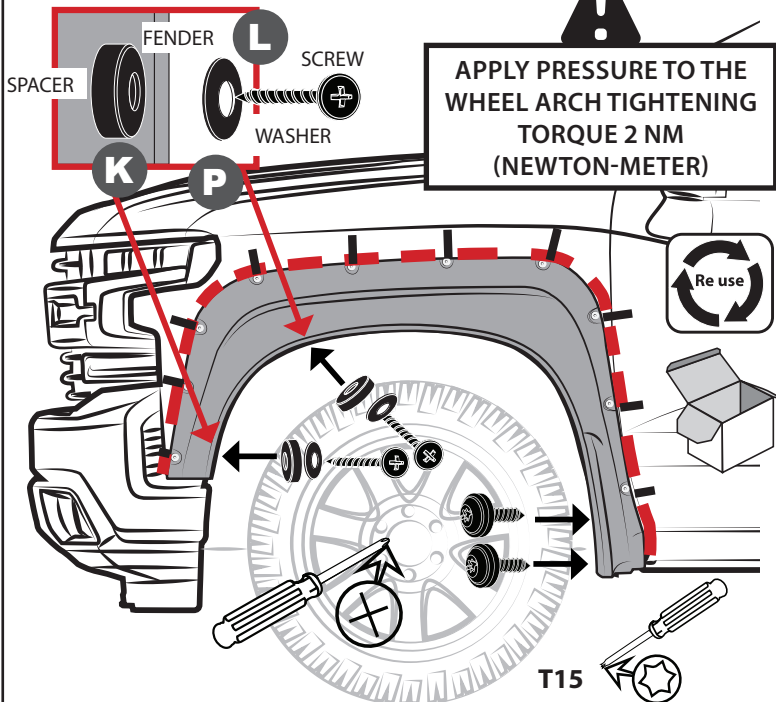

10 APPLY PRESSURE ON EACH SUPER BOLT

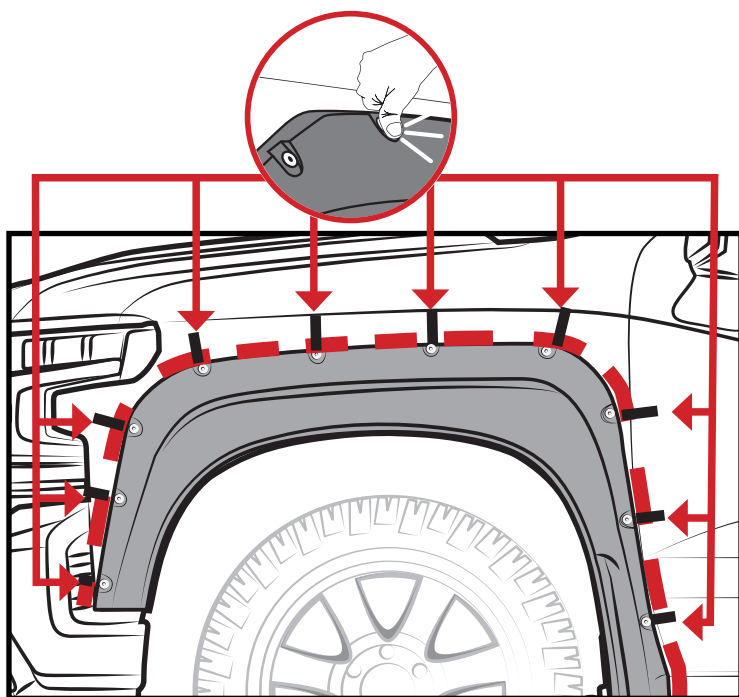

11 REMOVE THE SUPER BOLTS SCREWS

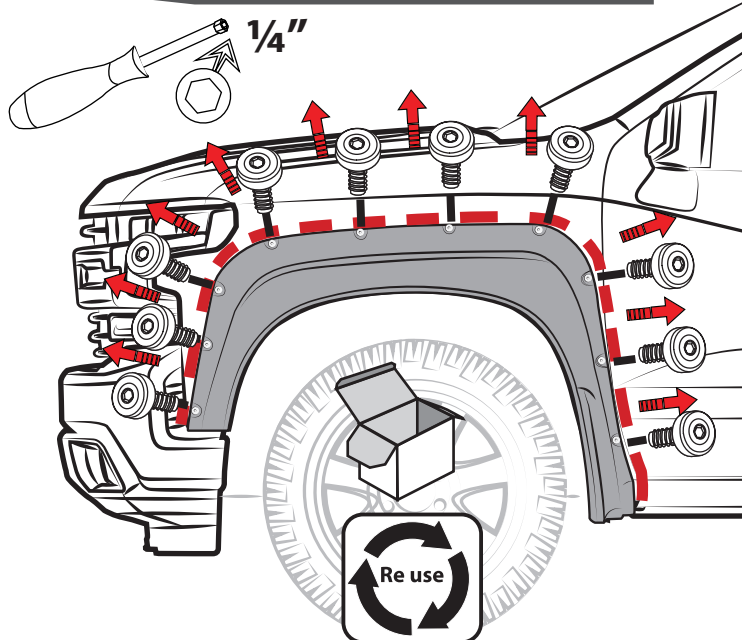

12 UNSCREW & REMOVE

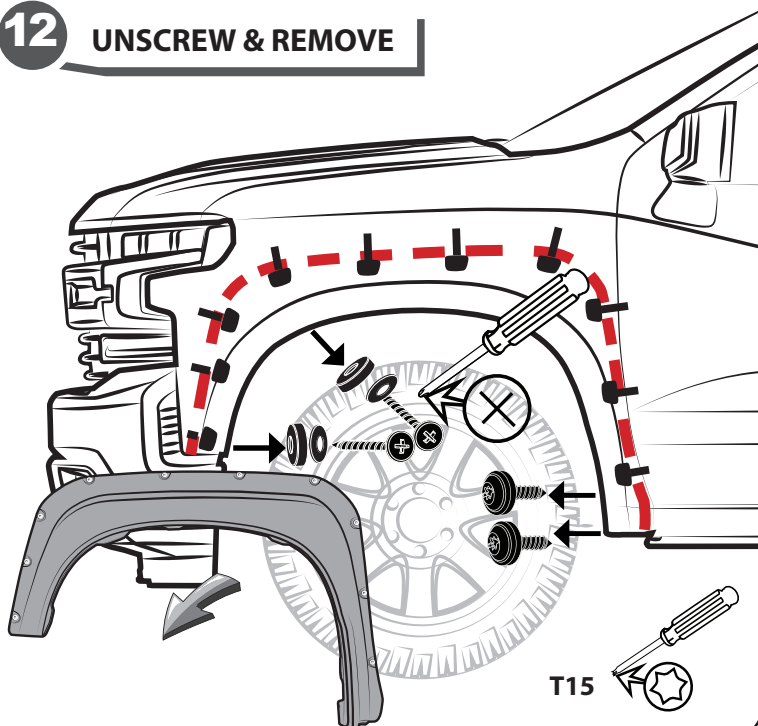



INSTALLATION SUPER BOLT

13 PRESS SUPER BOLTS STUDS

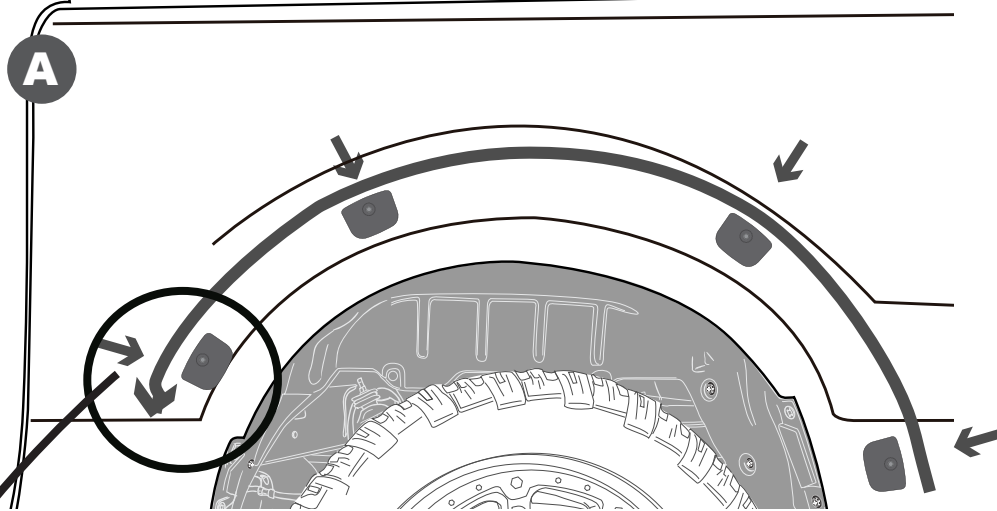

ATTENTION

FULL SURFACE CONTACT IS CRITICAL FOR GOOD ADHESION PERFORMANCE. ALWAYS APPLY FIRM PRESSURE WHEN MOUNTING ADD ON PARTS AND TAPES.

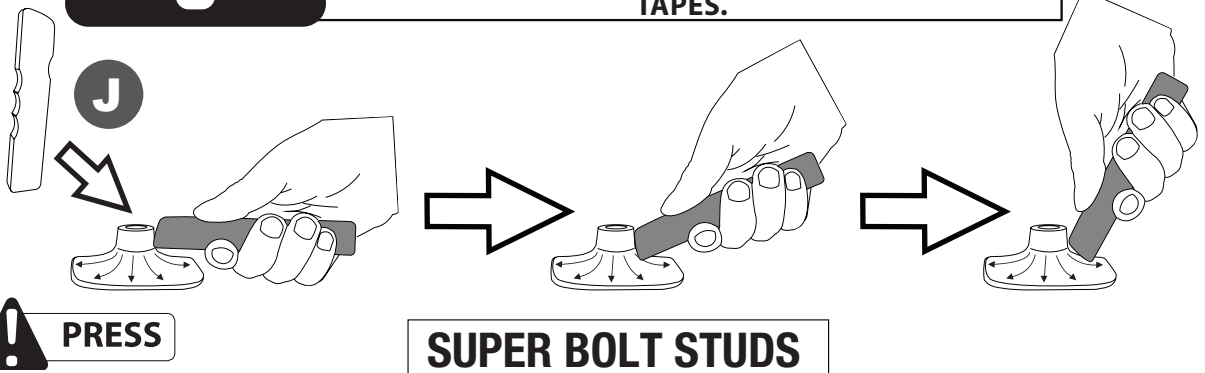

A full surface contact between tape and substrate is important for good adhesion performance. Contact is achieved by applying pressure. In practice a pressure between 40 and 50 N/cm² is usually needed and an application temperature between 25 and 45 °C or 77 and 113 °F is also necessary. During application, add-on parts and tapes must have the similar temperature.

14 PLACE BRACKET Z29

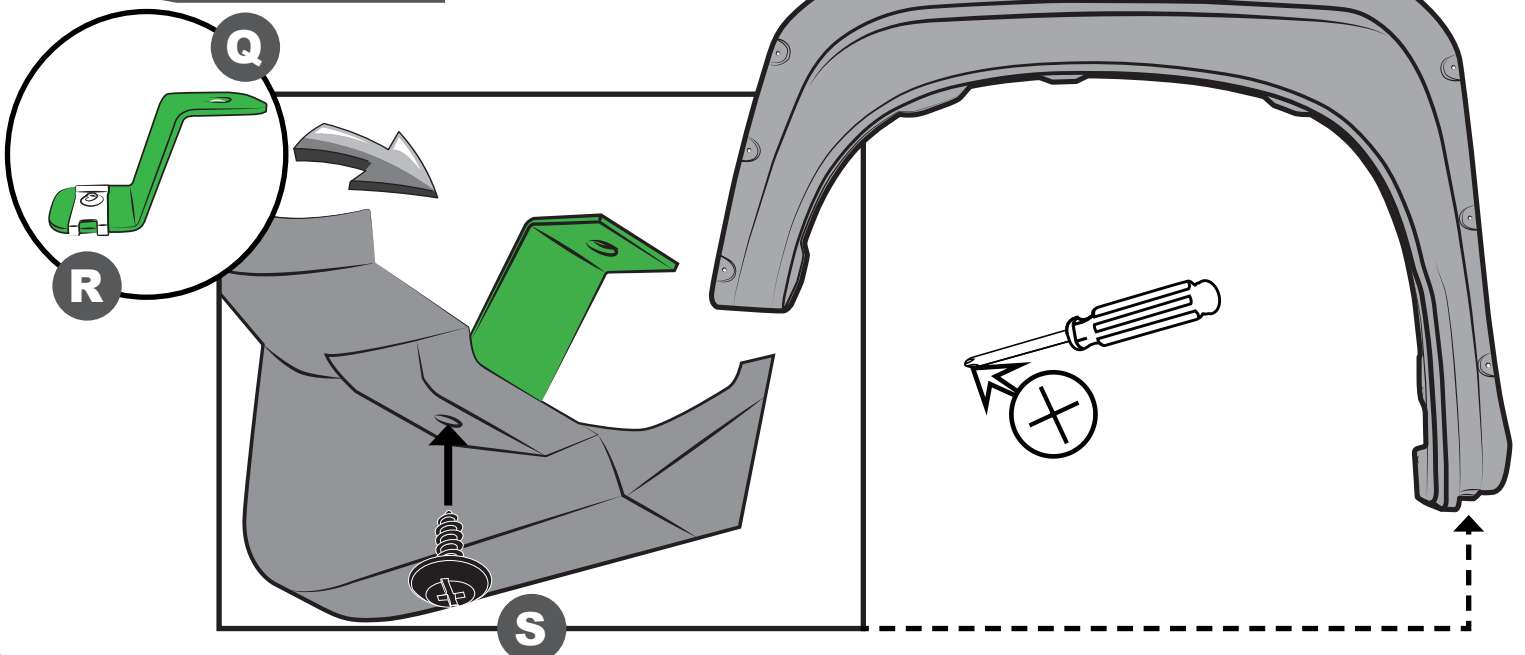



INSTALLATION MANUAL

15 PLACE

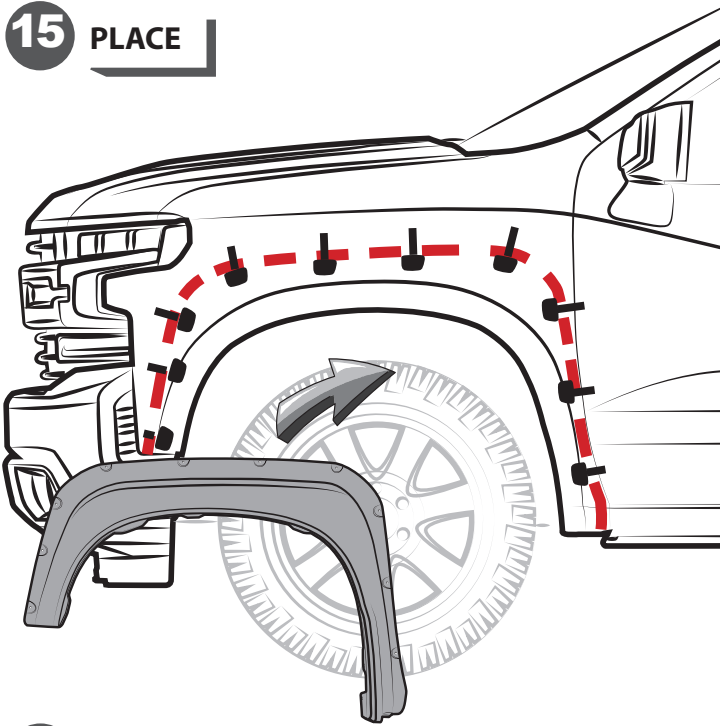

16 APPLY LOCTITE THREADLOCKER TO SUPER BOLT'S THREAD

ATTENTION

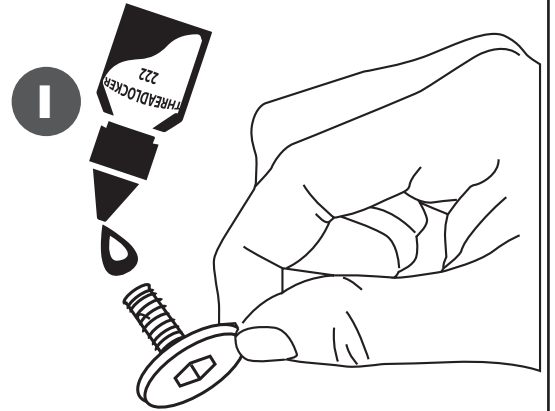

17 PLACE SUPER BOLTS

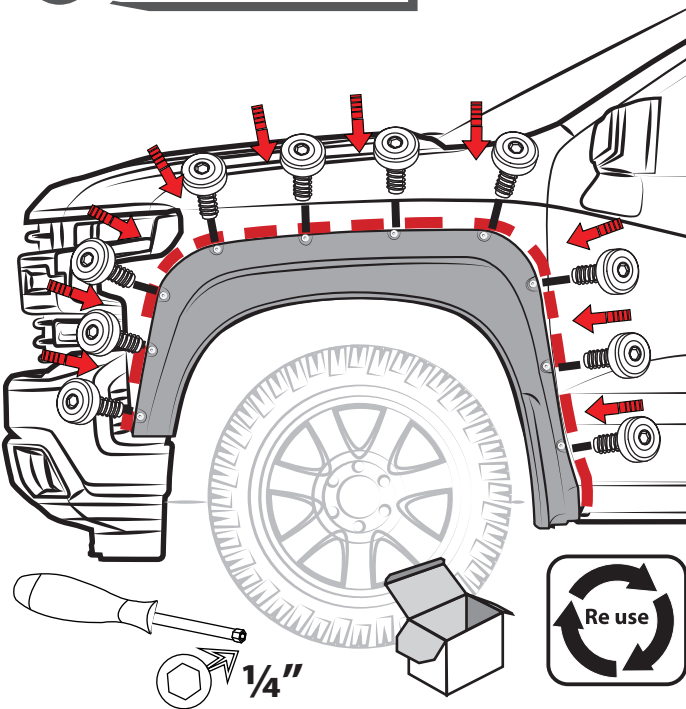

18 SECURE THE PART

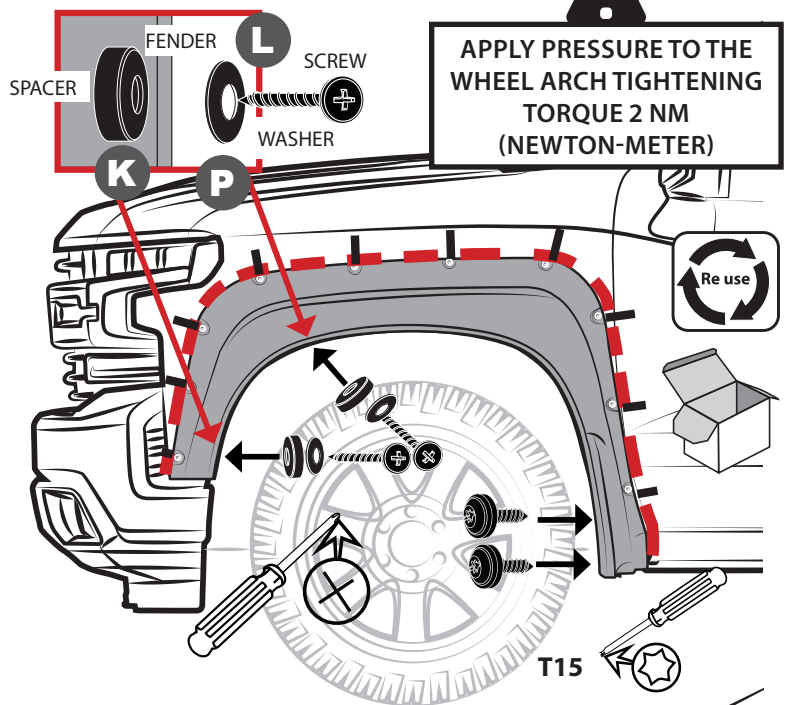

19 PLACE S-CLIPS

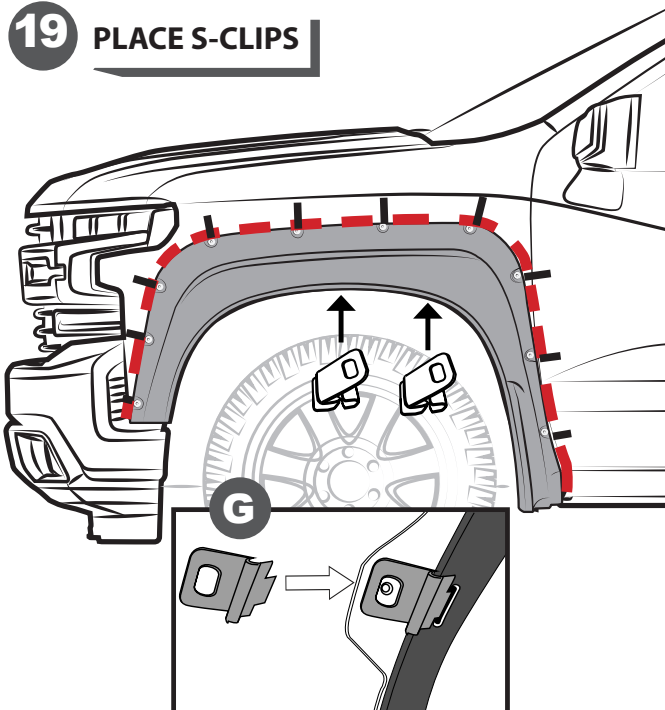

20 SCREW

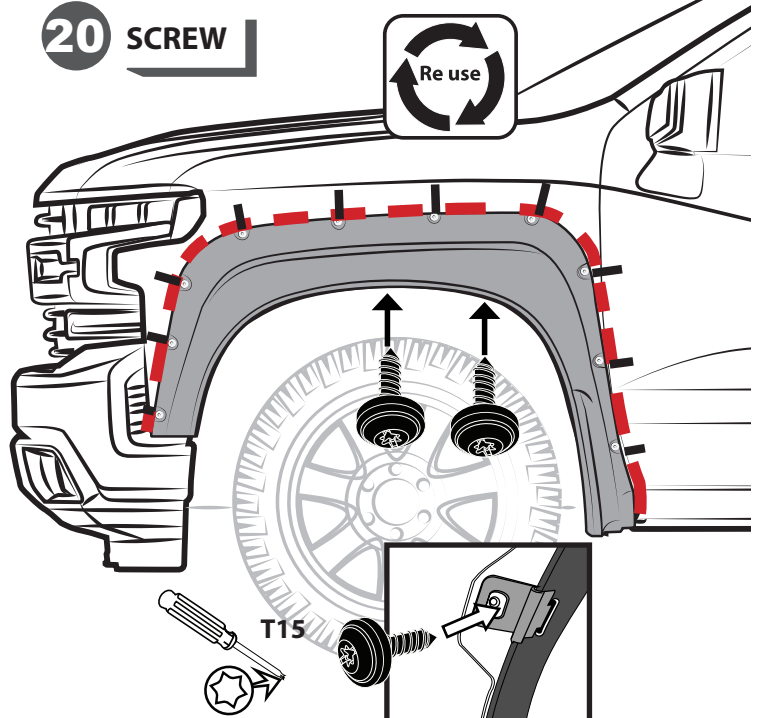



21 SECURE BRACKET Z29

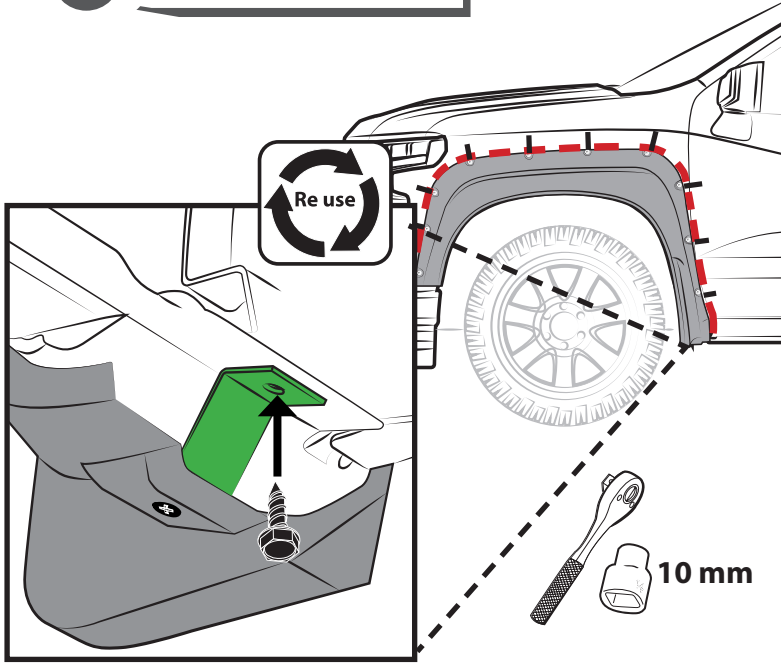

22 CLEAN OFF GREASE PENCIL MARK

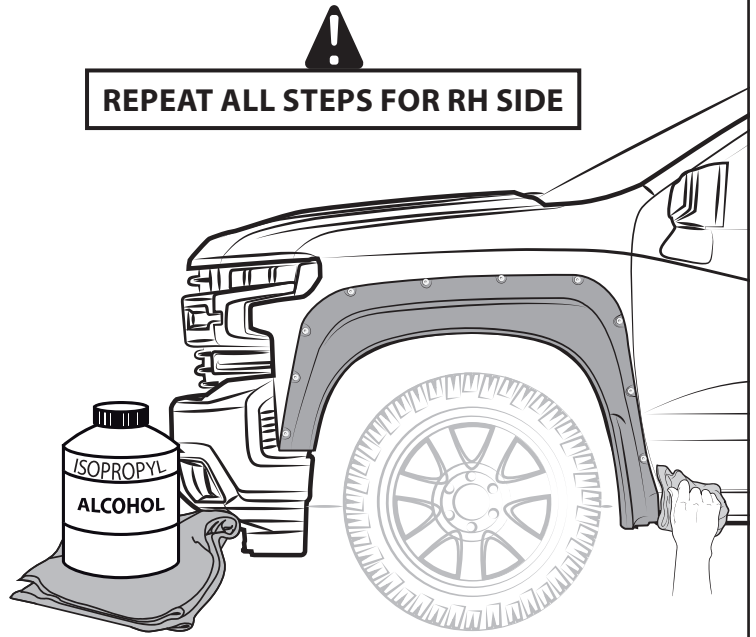

REAR FENDER FLARE

23 REMOVE FACTORY FASTENERS & MUD GUARD

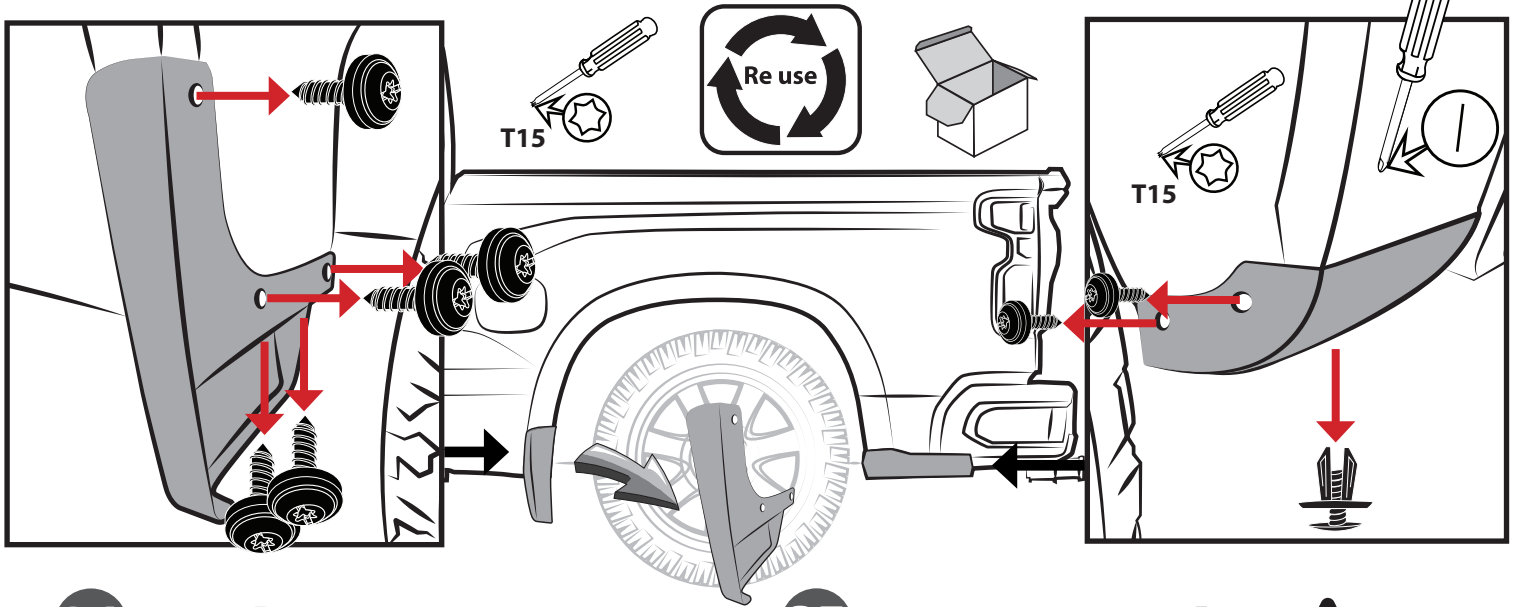

24 CLEAN

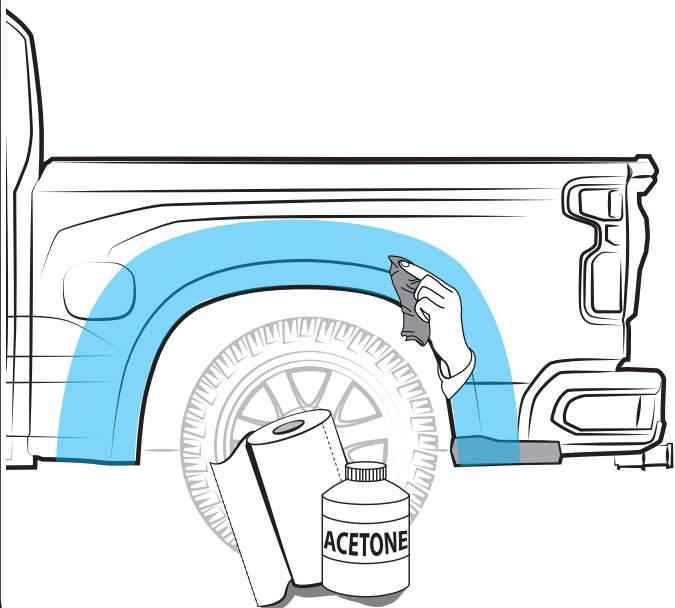

25 PRE-INSTALL & SCREW

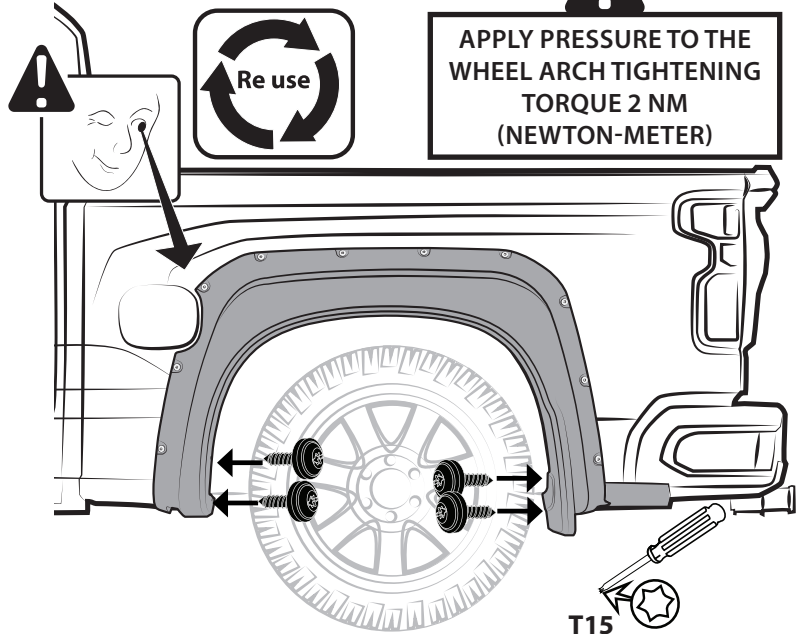



INSTALLATION MANUAL

26 MARK

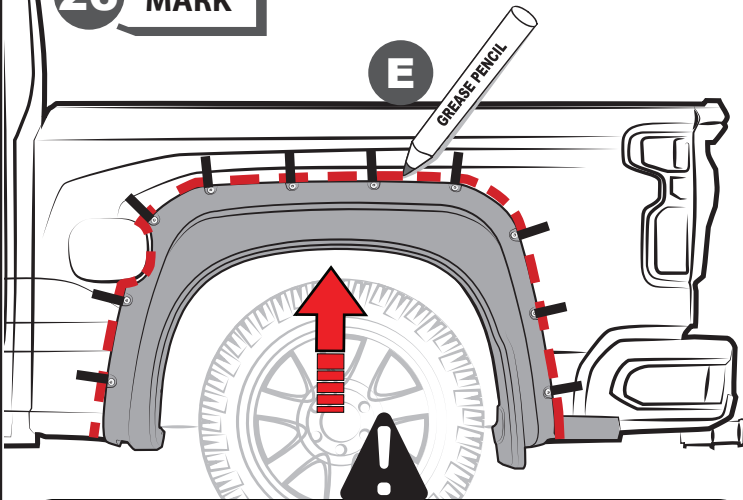

DRAW CENTER HASH MARK WITH GREASE PENCIL AT CENTER, BOTH SIDES, ON EACH SUPER BOLT AND SHEET METAL. THIS WILL ENSURE FENDER FLARE WILL BE CENTERED TO GREASE PENCIL OUTLINE.

28 ADHESION PROMOTER

APPLICATION AREA

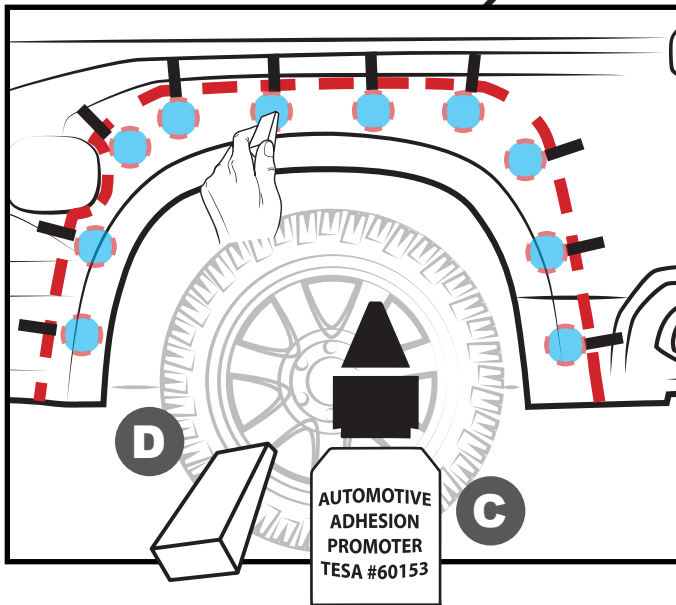

AUTOMOTIVE ADHESION PROMOTER TESA #60153

30 PLACE & SCREW



APPLY PRESSURE TO THE WHEEL ARCH TIGHTENING TORQUE 2 NM (NEWTON-METER)

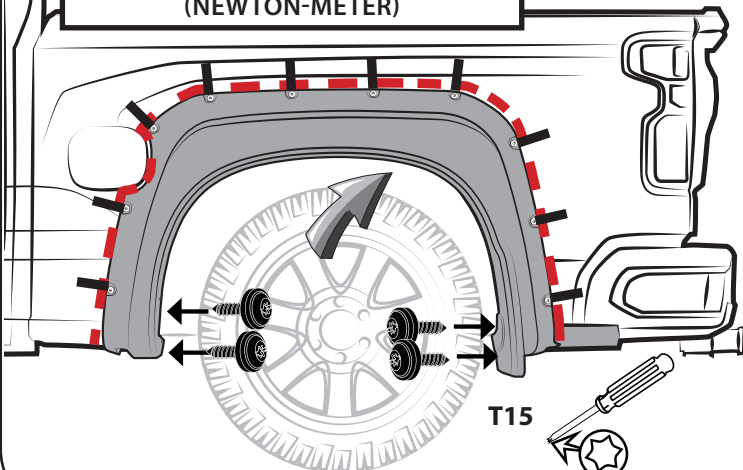

27 UNSCREW & REMOVE

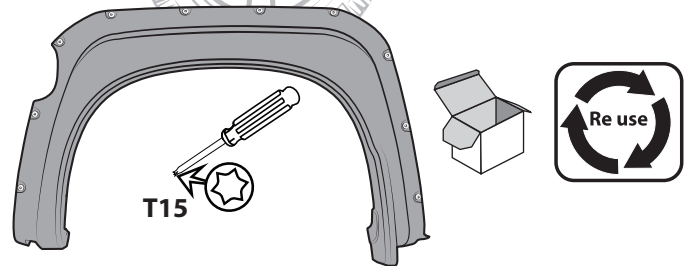
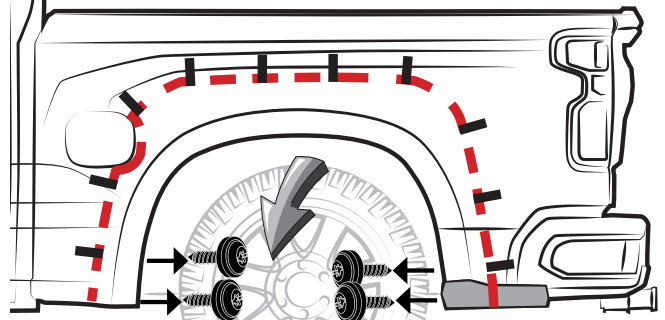

29 REMOVE LINER

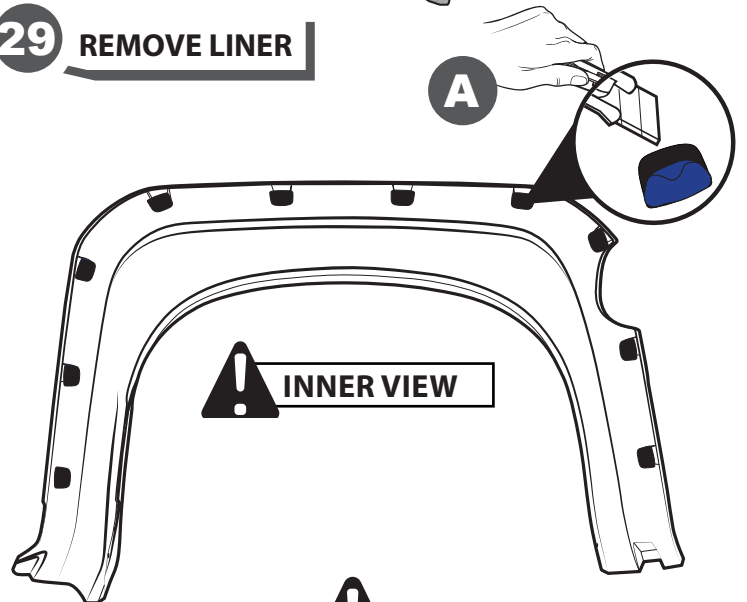

WARM SURFACES WITH HEAT GUN IF SURFACE TEMPERATURE IS TOO COLD.

31 APPLY PRESSURE ON EACH SUPER BOLT

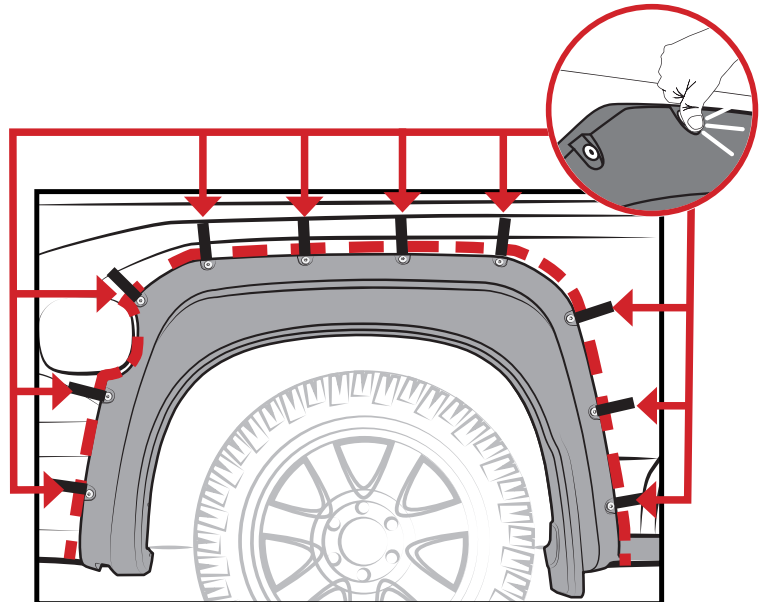



32 REMOVE THE SUPER BOLTS SCREWS

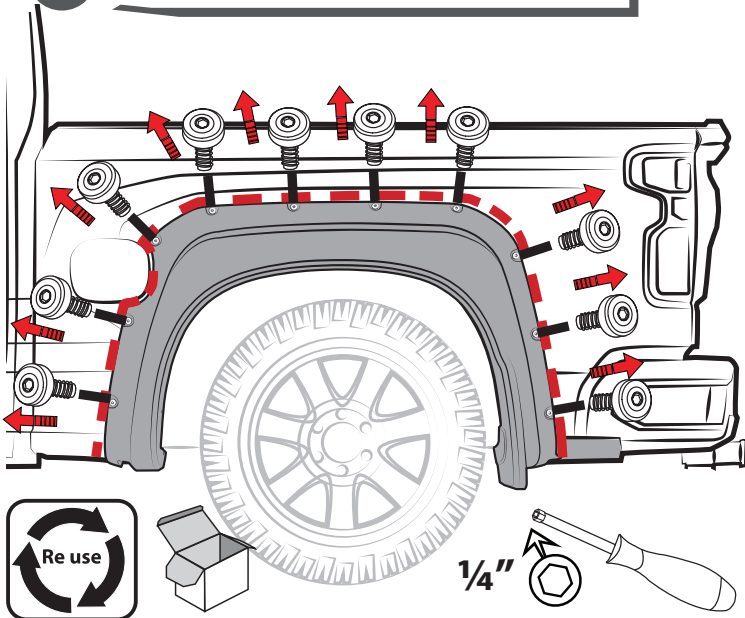

33 UNSCREW & REMOVE

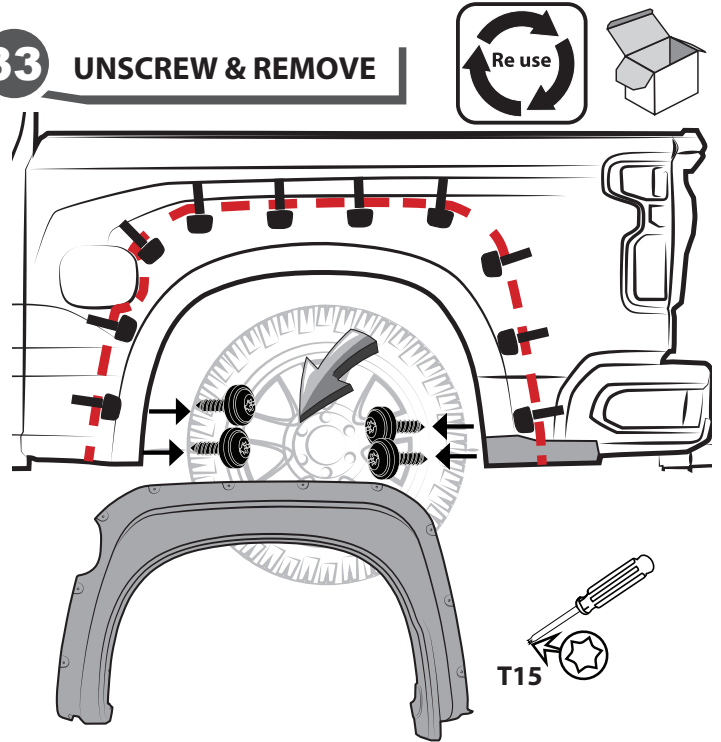

INSTALLATION SUPER BOLT

34 PRESS SUPER BOLTS STUDS

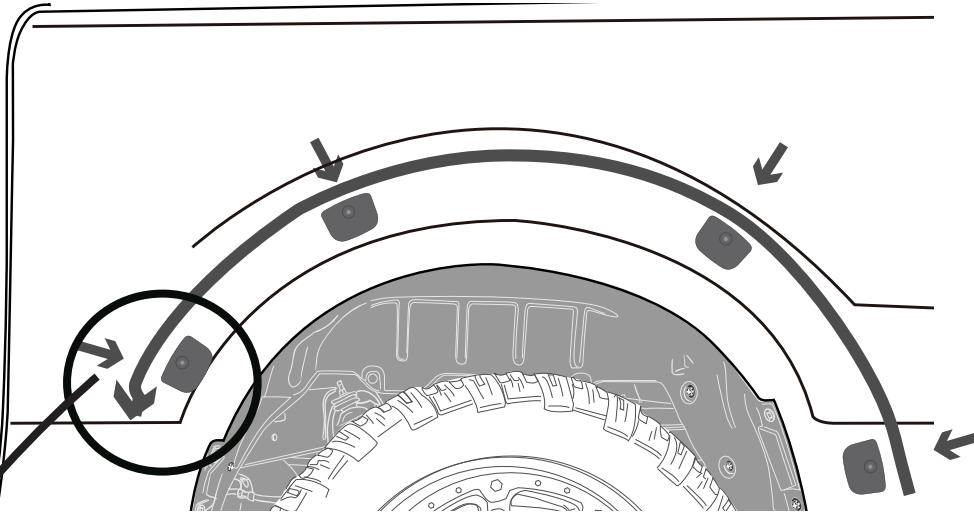

ATTENTION

FULL SURFACE CONTACT IS CRITICAL FOR GOOD ADHESION PERFORMANCE. ALWAYS APPLY FIRM PRESSURE WHEN MOUNTING ADD ON PARTS AND TAPES.

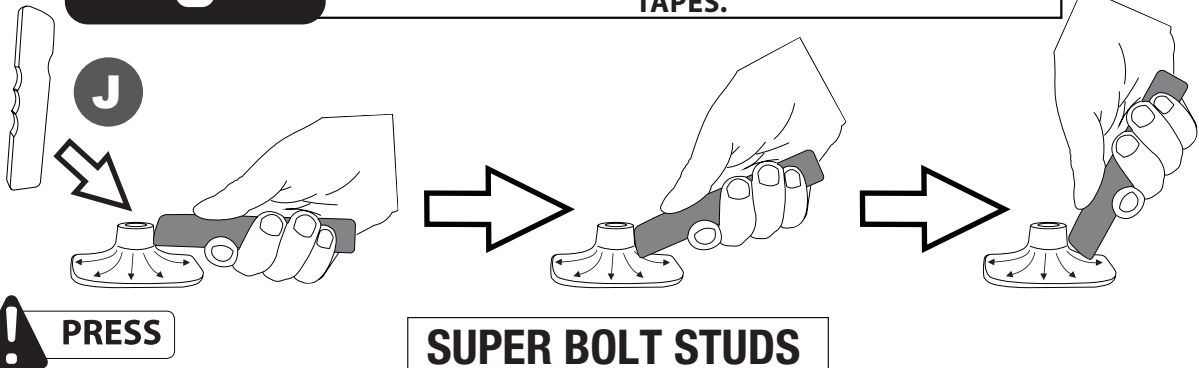

A full surface contact between tape and substrate is important for good adhesion performance. Contact is achieved by applying pressure. In practice a pressure between 40 and 50 N/cm² is usually needed and an application temperature between 25 and 45 °C or 77 and 113 °F is also necessary. During application, add-on parts and tapes must have the similar temperature.



INSTALLATION MANUAL

35 PRE-INSTALL & SCREW



APPLY PRESSURE TO THE WHEEL ARCH TIGHTENING TORQUE 2 NM (NEWTON-METER)

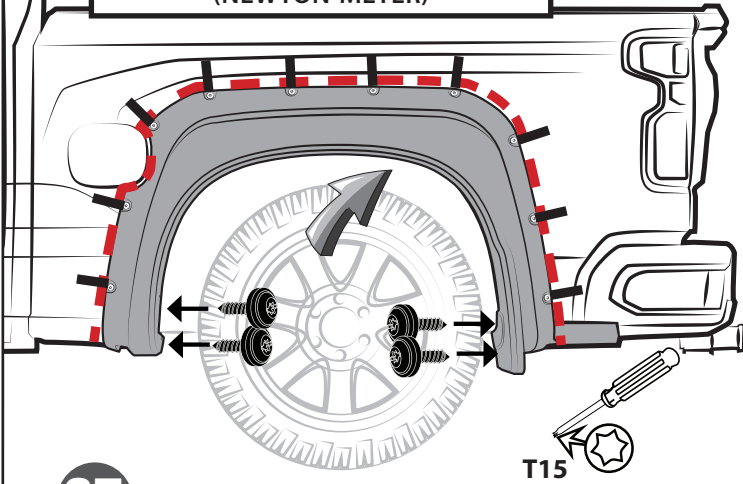

37 PLACE SUPER BOLTS

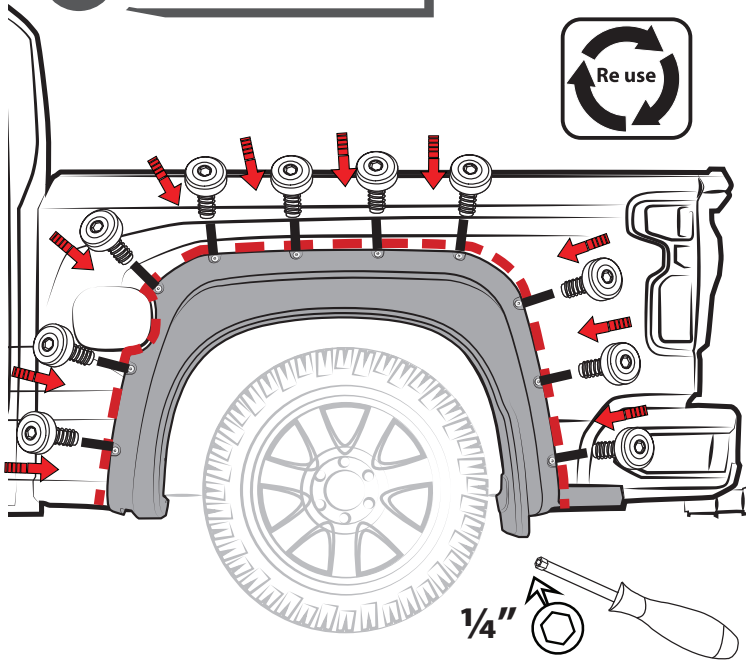

38 PLACE U-CLIPS

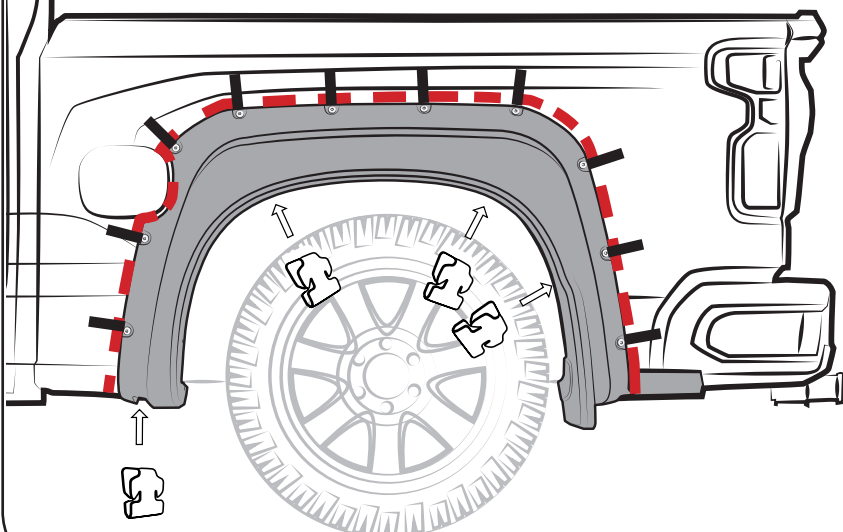

36 APPLY LOCTITE THREADLOCKER TO SUPER BOLT'S THREAD

ATTENTION

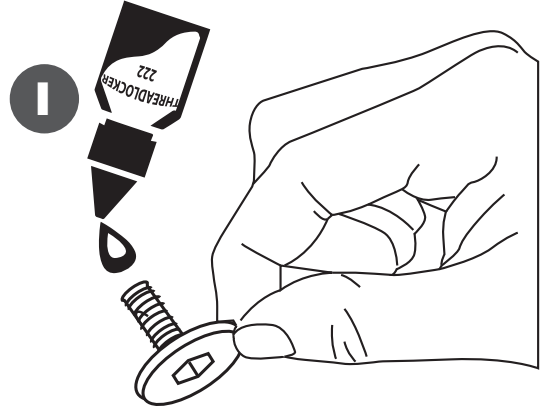

HAND TIGHT

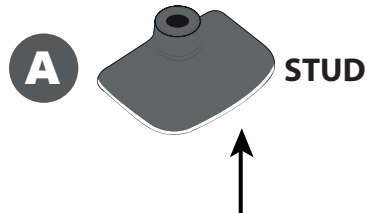
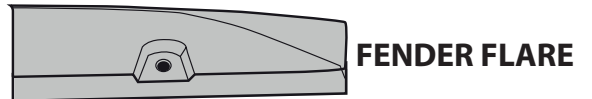



39 PLACE SCREW

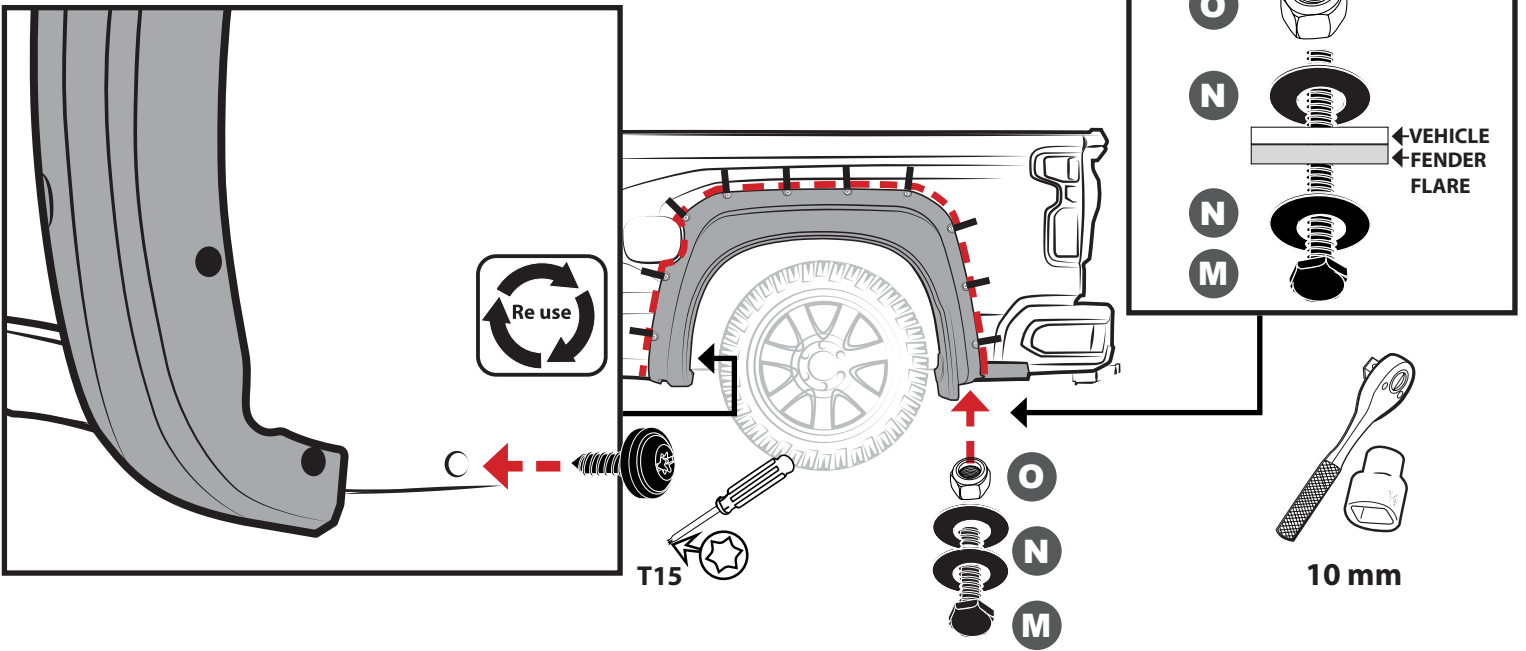

40 CLEAN OFF GRASE PENCIL MARK

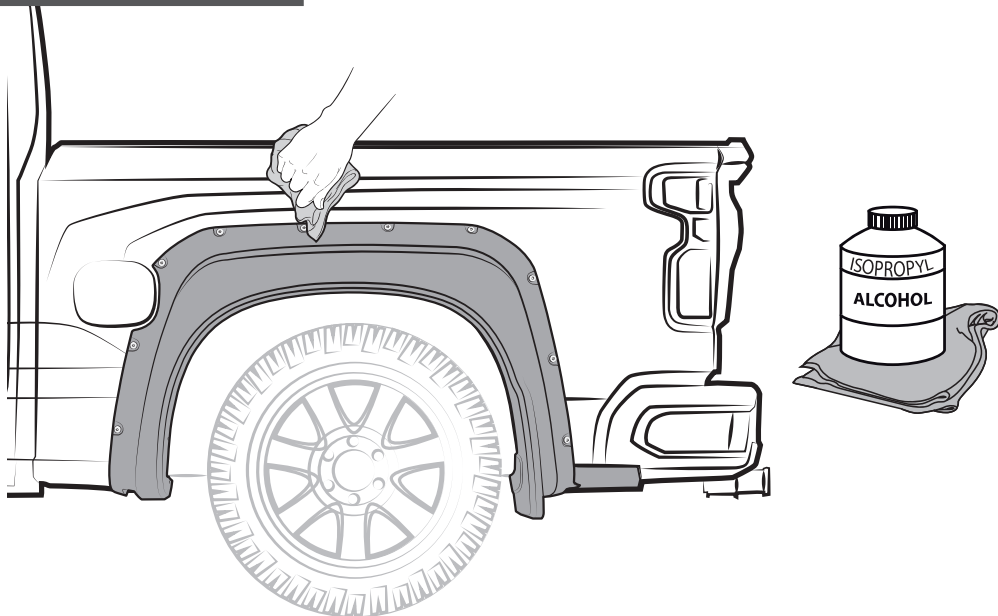

⚠
REPEAT ALL STEPS FOR RH SIDE

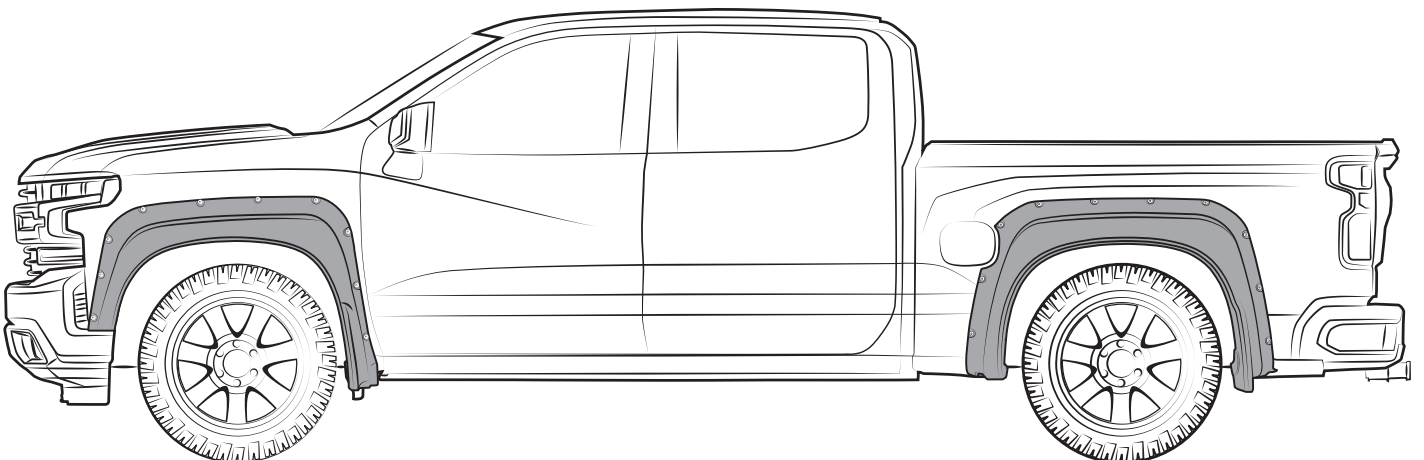

INSTALLED PART