

DIMENSIONS - MM

Part Number	A	B	C	D	E	F	G	H	I	J
48040	277.0	106.0	168.0	216.0	84.0	650.0	3/8" (M)	630.0	7.0	8.4

* All measurements in millimeters, unless otherwise noted.

** All fittings are NPT, unless otherwise noted.

DIMENSIONS - IN

Part Number	A	B	C	D	E	F	G	H	I	J
48040	10.91	4.17	6.61	8.50	3.31	25.59	3/8" (M)	24.80	0.28	0.33

* All measurements in inches, unless otherwise noted.

** All fittings are NPT, unless otherwise noted.

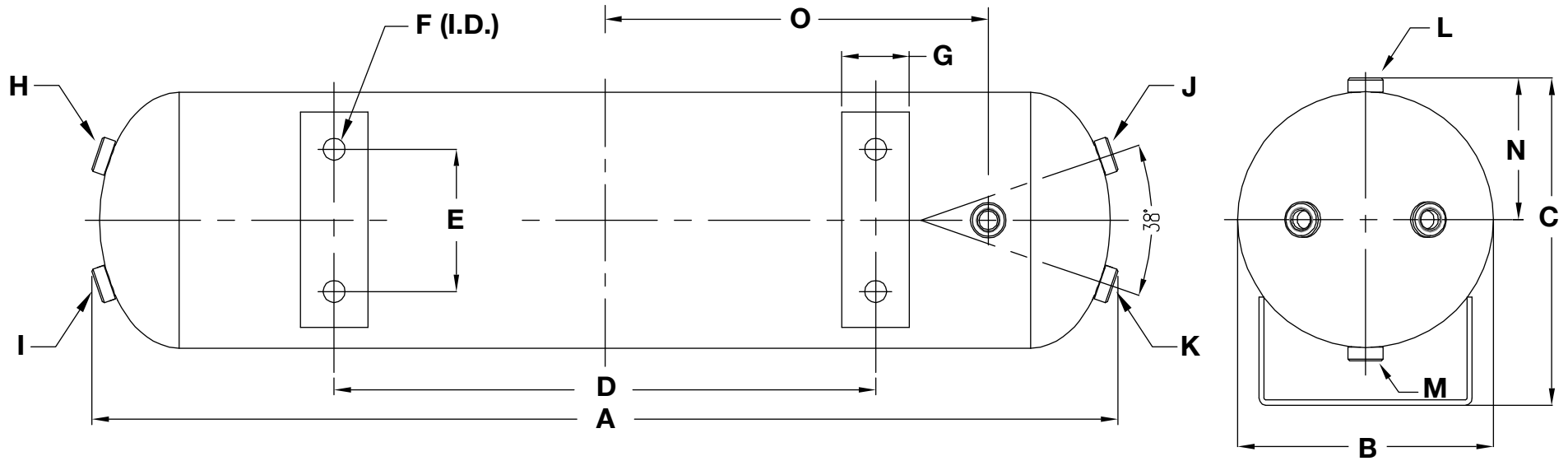

DIMENSIONS - MM

Part Number	A	B	C	D	E	F	G	
91028	607.0	151.0	193.5	320.0	84.0	5.1	40.0	
	H	I	J	K	L	M	N	O
91028	1/4" (F)	1/4" (F)	1/4" (F)	1/4" (F)	1/4" (F)	1/4" (F)	83.5	226.5

* All measurements in millimeters, unless otherwise noted.

** All fittings are NPT, unless otherwise noted.

DIMENSIONS - IN

Part Number	A	B	C	D	E	F	G	
91028	23.90	5.94	7.62	12.60	3.31	0.20	1.57	
	H	I	J	K	L	M	N	O
91028	1/4" (F)	1/4" (F)	1/4" (F)	1/4" (F)	1/4" (F)	1/4" (F)	3.29	8.92

* All measurements in inches, unless otherwise noted.

** All fittings are NPT, unless otherwise noted.



P/N 10003, 10005, 10007, 20001 COMPRESSOR WIRING DIAGRAM

(with combination pressure switch / relay)

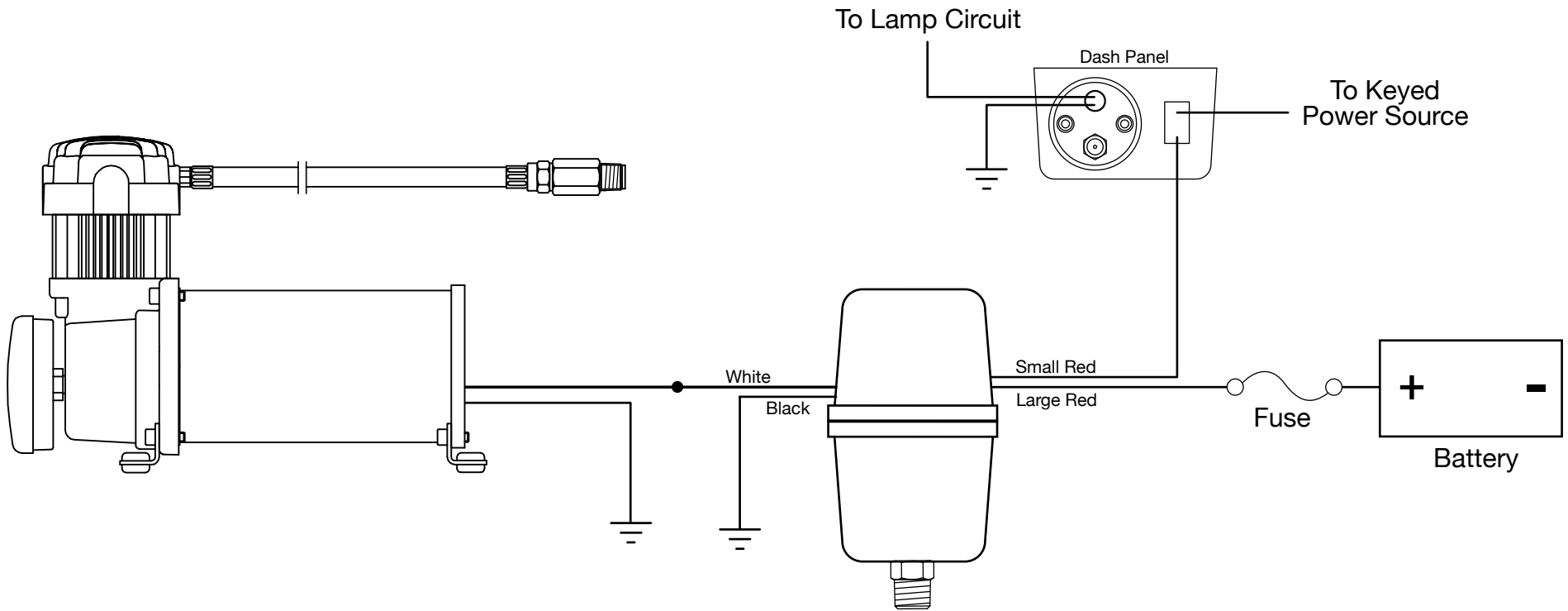

P/N 20001
OBA PLUMBING DIAGRAM
Typical System Configuration, May Vary Depending on Installation

