

**DIMENSIONS - MM**

Part Number	A	B	C	D	E	F	G	H	I	J
40040	225.0	100.0	172.0	170.0	84.0	470.0	1/4" (M)	630.0	7.0	8.40

\* All measurements in millimeters, unless otherwise noted.

\*\* All fittings are NPT, unless otherwise noted.

**DIMENSIONS - IN**

Part Number	A	B	C	D	E	F	G	H	I	J
40040	8.86	3.94	6.77	6.69	3.31	18.50	1/4" (M)	24.80	0.28	0.33

\* All measurements in inches, unless otherwise noted.

\*\* All fittings are NPT, unless otherwise noted.

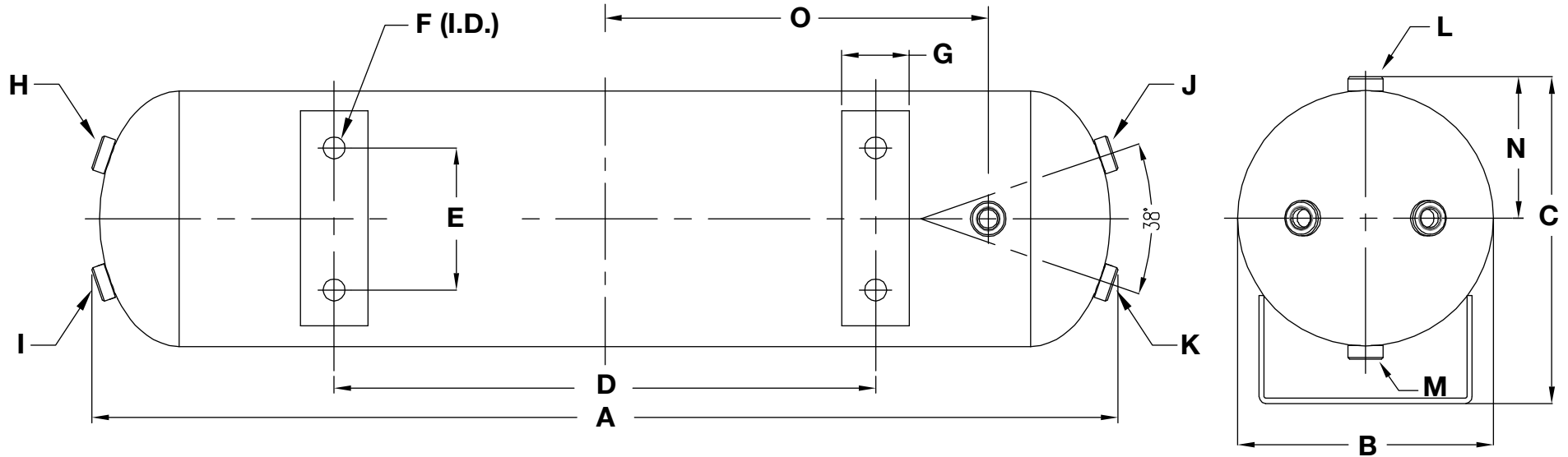

**DIMENSIONS - MM**

Part Number	A	B	C	D	E	F	G	
91025	607.0	151.0	193.5	320.0	84.0	5.1	40.0	
	H	I	J	K	L	M	N	O
91025	1/4" (F)	1/4" (F)	1/4" (F)	1/4" (F)	1/4" (F)	1/4" (F)	83.5	224.0

\* All measurements in millimeters, unless otherwise noted.

\*\* All fittings are NPT, unless otherwise noted.

**DIMENSIONS - IN**

Part Number	A	B	C	D	E	F	G	
91025	23.90	5.94	7.62	12.60	84.0	0.20	1.57	
	H	I	J	K	L	M	N	O
91025	1/4" (F)	1/4" (F)	1/4" (F)	1/4" (F)	1/4" (F)	1/4" (F)	3.29	8.82

\* All measurements in inches, unless otherwise noted.

\*\* All fittings are NPT, unless otherwise noted.



# P/N 10003, 10005, 10007, 20001 COMPRESSOR WIRING DIAGRAM

(with combination pressure switch / relay)

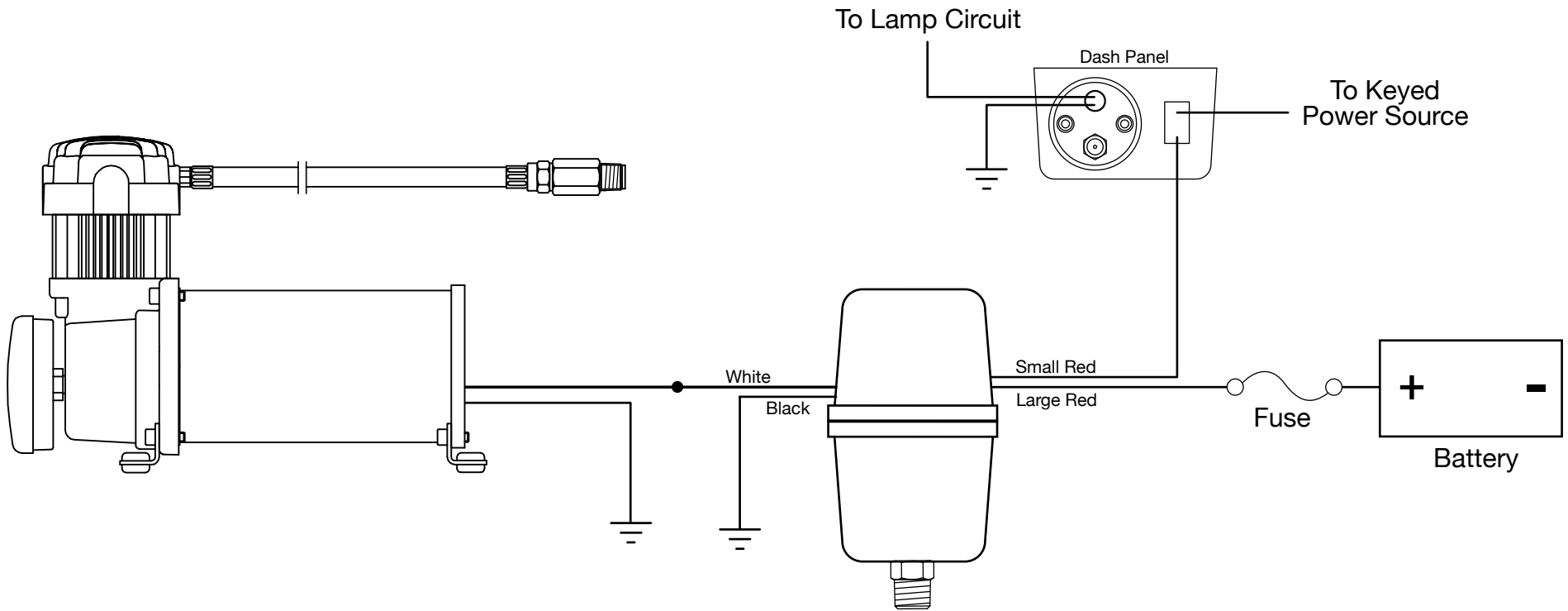

P/N 10005, 10007  
**OBA PLUMBING DIAGRAM**  
Typical System Configuration, May Vary Depending on Installation

