

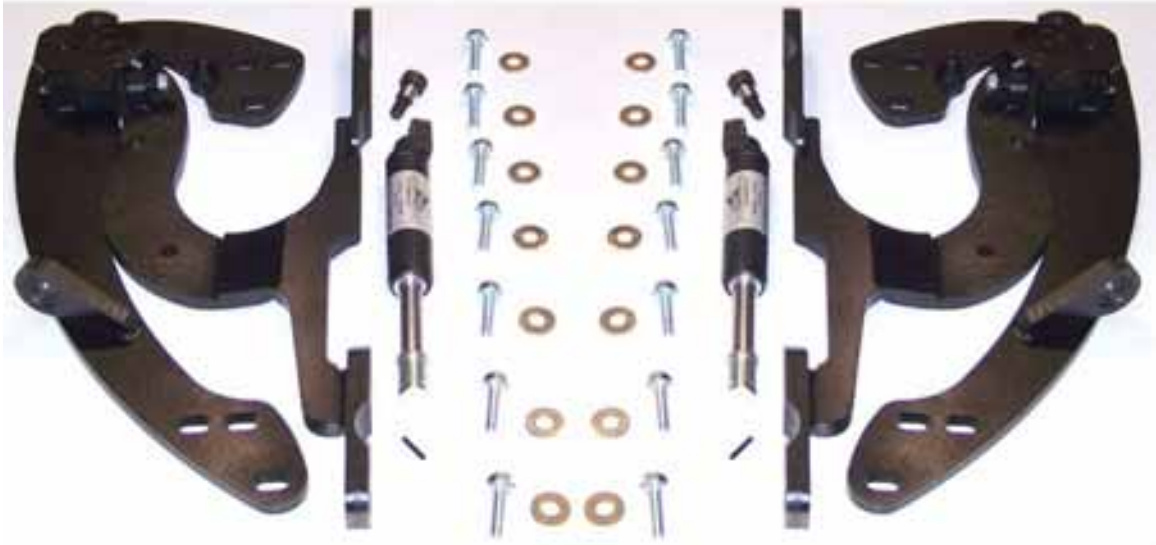

1996-2000

US PATENT #6,808,223 & #6,845,547



THIS KIT INCLUDES:

- 16 M8-1.25X30MM BOLTS WITH WASHERS
- 2 SHOULDER BOLTS WITH WASHERS
- WIRE LOOM
- RIGHT AND LEFT HINGE ASSEMBLY
- 2 SHOCKS 565 PSI
- 2 PINS

TOOLS REQUIRED FOR INSTALLATION:

	<ul style="list-style-type: none"> ➤ AIR RACHET, GRINDER AND CUTTER.
	<ul style="list-style-type: none"> ➤ 7MM, 8MM, 10MM, 11MM, 13MM, SOCKETS AND EXTENSION.
	<ul style="list-style-type: none"> ➤ FORK AND PHILLIP'S SCREW DRIVERS
	<ul style="list-style-type: none"> ➤ SPACERS FOR THE DOOR GAP.
	<ul style="list-style-type: none"> ➤ 3/16 ALLEN WRENCH
	<ul style="list-style-type: none"> ➤ 1/4 TORX BIT
	<ul style="list-style-type: none"> ➤ 9/16 WRENCH
	<ul style="list-style-type: none"> ➤ LOCKTITE RED

OTHER TOOLS MAY BE NEEDED DEPENDING ON YOUR VEHICLE.

1) Disconnect the battery.

2) Remove fender:

Remove all Phillip's screws from the wheel well.



Remove (1) 12mm bolt to loosen the bumper.

Once the 12mm bolt has been removed pull on the bumper and remove (2) 8mm bolts from behind the bumper.



Remove (3) 8mm bolts from the top of the fender.



Remove (2) 8mm bolts from the bottom of the fender by the door.

Remove (1) 8mm bolt holding the fender.
At this point you should be able to remove the fender.



3) Remove the door catch:
Open the door and remove (1) 10mm bolt from the body and (2) 10mm from the door. Push the door catch inside the door.

You will need to remove the door panel to retrieve the door catch.



4) Gaining wire slack:
Remove foot trim, under it you will find (2) wire harness use the fork to undo the wire harness and pull about 6" of wire. This will give you the necessary wire slack to fully open the new Vertical Doors Inc. system.



5) Close door and use painter's tape to secure the door in preparation for factory hinge removal.



Use a 13mm socket to remove the factory hinges.

Hint (You can make your spacer out of paint sticks and about 8-10 turns of blue painters tape)*

6) Install new Vertical Doors Inc. system:

In order for the vertical hinge to sit flat against the apron you must flatten 3 "hump" shaped parts that are on the apron once done the vertical hinge should sit flat against apron.

Hint Tighten the bolts on the door first and then install the bolts on the body.*



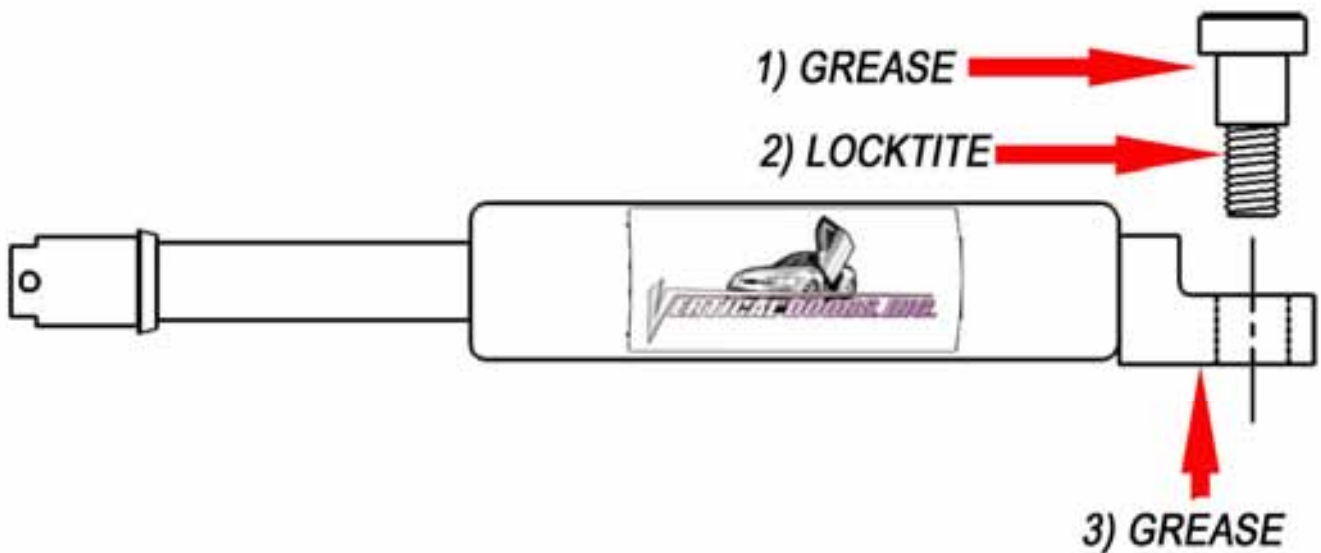

***IMPORTANT STEP: DO NOT SKIP THIS STEP. THIS STEP IS CRUCIAL IN YOUR INSTALLATION PROCESS, IF THIS STEP IS NOT COMPLETED WHEN INSTALLING THE VERTICAL DOOR KIT; ALL WARRANTIES ARE VOIDED, AND MAY CAUSE FUTURE PROBLEMS WITH YOUR VERTICAL DOOR SYSTEM.**

1ST, make sure you put grease on the body of shoulder bolt where the arrow is pointing.

2ND, make sure you put red Locktite, where the arrow is pointing, on thread of shoulder bolt.

3RD, make sure you put grease on the bottom side of the shock end.



WARNING! THE USE OF ANY TYPE PLYERS, PAINT OR FOREING MATERIALS ON THE SHOCK'S BODY OR SHAFT WILL VOID THE WARRANTY.

7) Once hinge is locked in place, break nut #1 then turn Allen set screw #2 on fig until it hits the block then open the door and continue to adjust until the door matches with the striker, open and close door making sure it closes like factory.

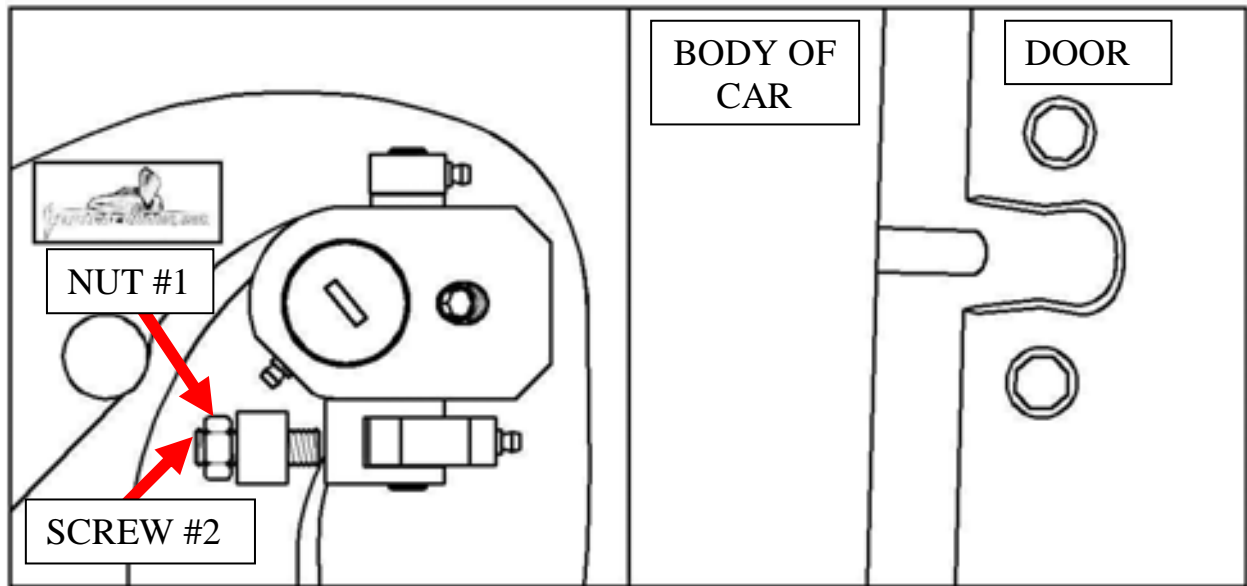

Hint(leave #1 nut loose until shock is installed Allen set screw will have to be re-adjusted after shock is installed.*

8) Install the shock.

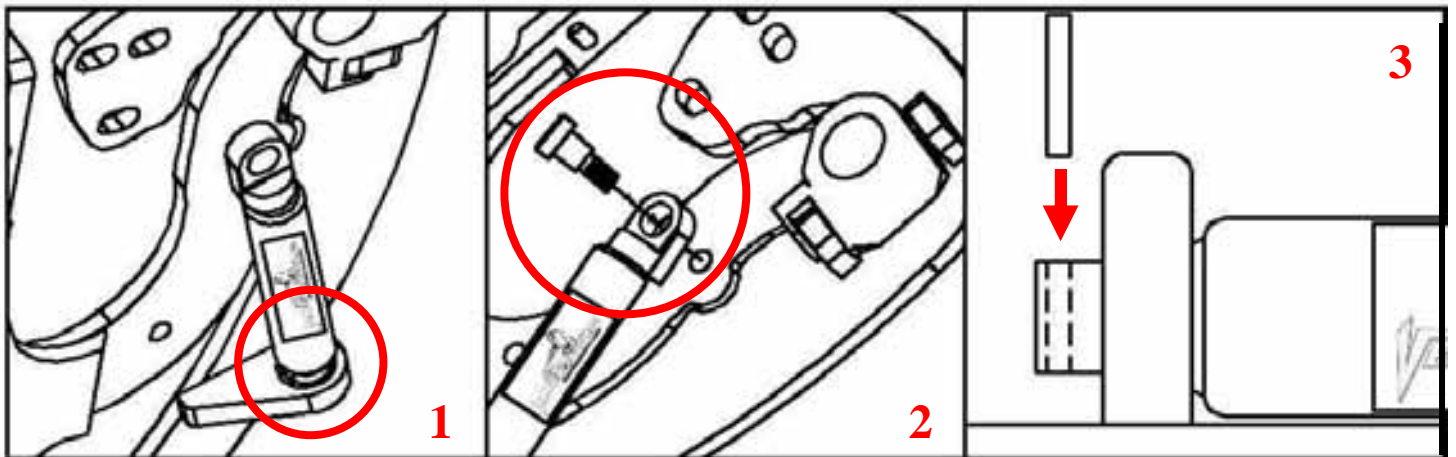

Hint (You will need a helper to raise the door). (Slip the spherical rod mount into the spherical ball bearing (1). Using a 1/4 Allen wrench, tighten the screw into the swing arm (2). After the shock is installed secure it by installing the pin in the bottom shock end (3).*

9) After shock is installed re-install door panel and lift the door. Adjust door opening screw #3 clockwise until distance between nub and swing arm is enough so that the swing arm moves up and down freely.

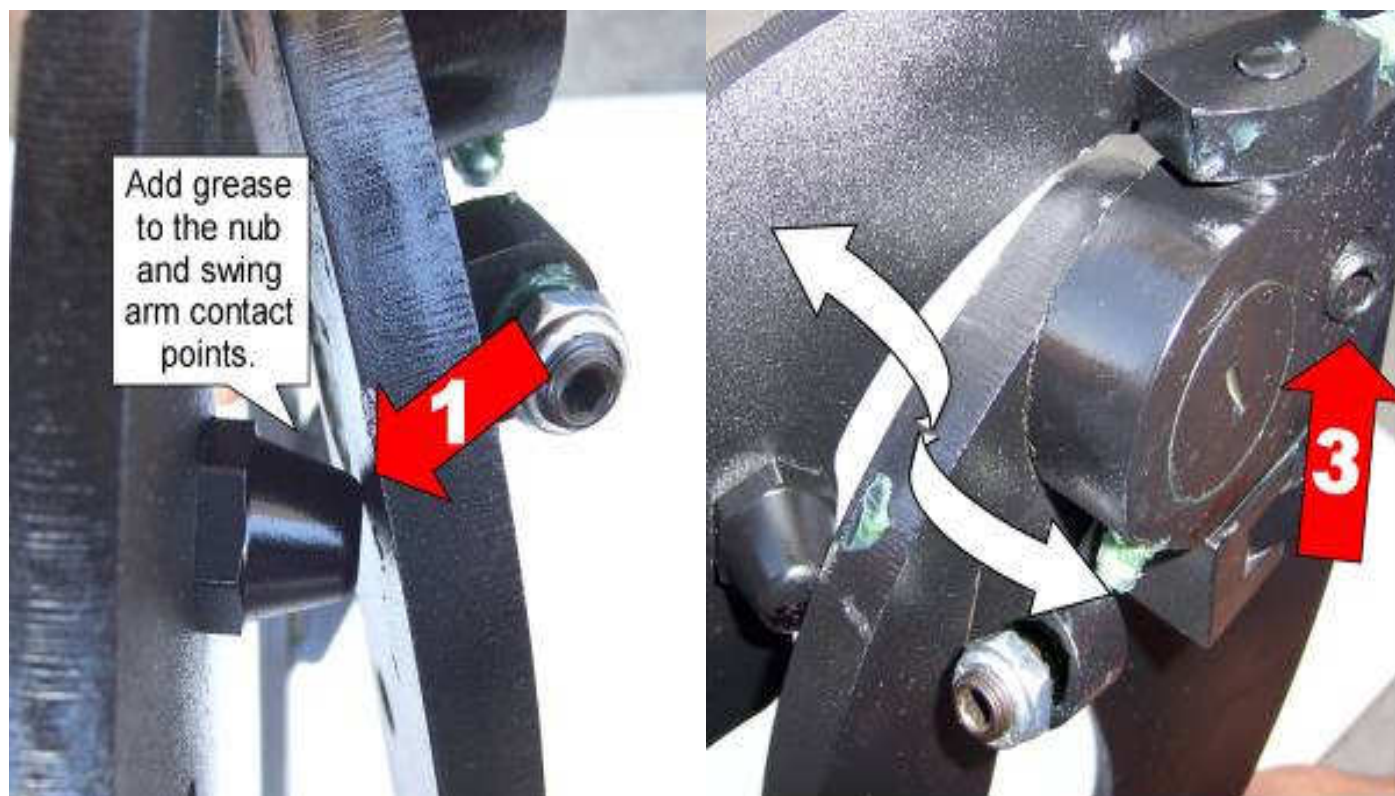

Hint (Fine tune the Allen set screw (#2) to realigned striker with door. After the door is aligned, test door by opening and closing, lifting and lowering door several times.*

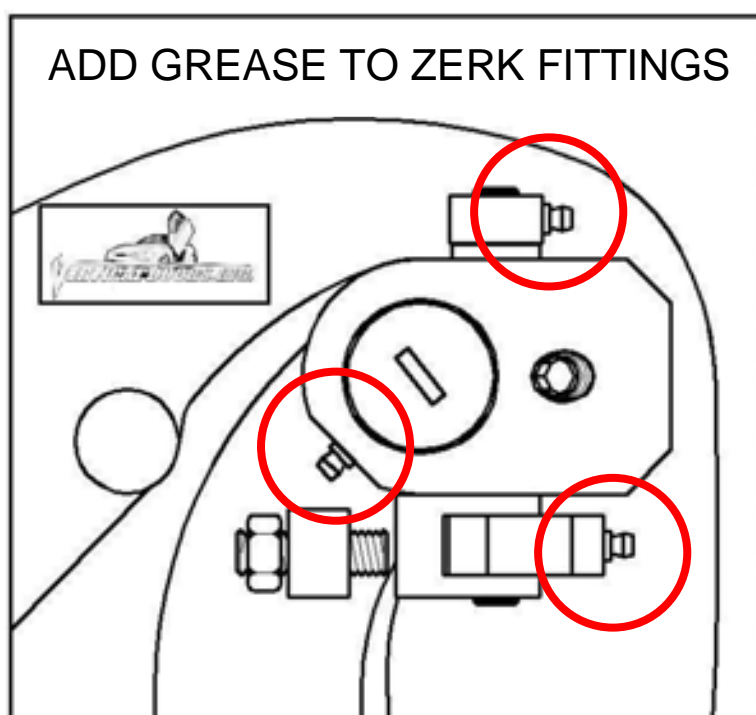

Note: Do not install fender until the adjustment of the door is accurate, and the set screw is tightly secure. Also make sure everything is tight, adjustment is set and everything is Locktite.

10) Modify factory wire loom:

In order to be able to open and raise the door, cut the factory wire loom in half and add included wire loom to protect exposed wires.



11) Cut the inner lip of your fender to make room for the new Vertical Doors hinge. Note: After you have cut the fender use a sander or grinder and make sure the surface is completely flat.



The fender should look like the picture above when you are done cutting it.

12) Close the door and replace the fender by reversing step 2.

Hint(Make sure the electrical wires don't get pinched enough to damage wires)*

13) For the other side just follow steps 2-12.