



**VENCO  
VENTURO**

**INDUSTRIES LLC**



**ESV-1000  
ENCLOSED SERVICE VAN  
VKE\*AA  
INSTALLATION & OWNER'S MANUAL**

**TABLE OF CONTENTS**  
**ESV-1000 SERIES CRANES**

ESV001	LEAD PAGE
<u>SECTION 100</u>	<u>INSTALLATION</u>
ESV101	PACKAGE CONTENTS
ESV102	MINIMUM HARDWARE SPECIFICATIONS
ESV103	INSTALLATION INSTRUCTIONS, PG. 1
ESV104	INSTALLATION INSTRUCTIONS, PG. 2
ESV105	ELECTRICAL INSTALLATION INSTRUCTIONS
CEV223	BATTERY CABLE INSTALLATION
ESV106	WIRING DIAGRAM
<u>SECTION 200</u>	<u>USER GUIDE</u>
CE-044	CRANE SAFETY AND HAZARDS
ESV107	OPERATING INSTRUCTIONS & MAINTENANCE
ESV108	USER INSTRUCTIONS
<u>SECTION 300</u>	<u>SPECIFICATIONS</u>
ESV109	DIMENSIONS & CAPACITY
CEV162	WIRE ROPE & HOOK SPECIFICATIONS
<u>SECTION 400</u>	<u>REPLACEMENT PARTS</u>
ESV110	REPLACEMENT PARTS DRAWING
ESV111	REPLACEMENT PARTS LIST
ESV112	REPLACEMENT HARDWARE DRAWING
ESV113	REPLACEMENT HARDWARE LIST
CE-055	REPLACEMENT PARTS DRAWING & LIST; WINCH
CEV224	REPLACEMENT PARTS DIAGRAM; CE-008 CONTACTOR BOX
CEV170	SAFETY DECALS
CEV171	SAFETY DECALS
ESV114	DECAL DRAWINGS & LIST
ESV115	DECAL LOCATIONS
ESV116	KIT; ESV117 FIELD SERVICE LABELS



TITLE	DATE	SECTION
TABLE OF CONTENTS	02-16-17	TOC
ESV-1000 SERIES CRNS	SUPERSEDES	ESV100
	-	



# SECTION 100

# INSTALLATION

PACKAGE CONTENTS  
ESV-1000 SERIES CRANES

The ESV-1000 Series Crane will ship with some sections pre-assembled from the factory. Below are illustrations to help identify the Van Crane and Installation Kit components.

ESV - 1000 VAN CRANE

Locate and identify the following crane sections:

1. ESV-1000 Crane frame with winch

NOTE: Some fasteners are located in the installation kit.

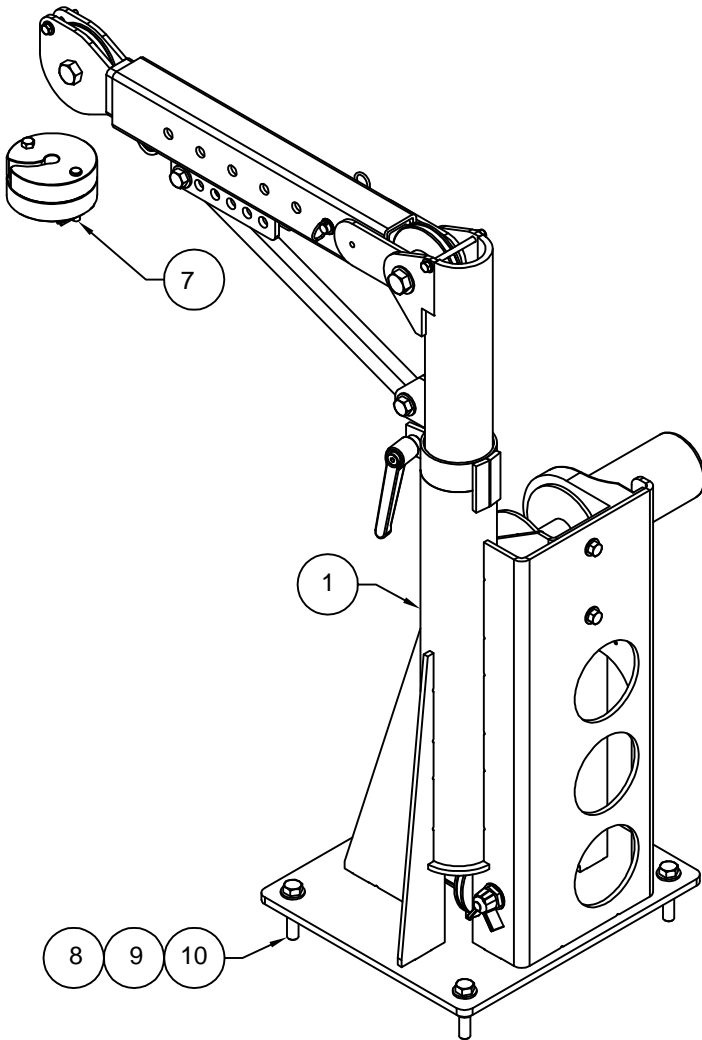

ESV118 INSTALLATION KIT

Locate and identify the following components:

- † 2. [1] Installation Kit Box (#BOX24\*12\*8)
3. [1] Red Battery Cable (#01025-4\*29FT)
4. [1] Black Battery Cable (#01025-4\*28FT)
5. [2] 5/16 Terminal Ring (!TERM4G313RG)
6. [2] 3/8 Terminal Ring (!TERM4G375RG)
7. [1] Headache Ball Assembly (#16735)

FASTENERS

8. [4] 1/2-13 X 2-1/2" Hex Head Cap Screws (!HHCS05013150)
9. [8] 1/2" SAE Flat Washers (!FWSH-050SAE)
10. [4] 1/2-13 Lock Nuts, Nylon (!LNUT-05013)

OPTIONAL EQUIPMENT

11. [1] 150A CIRCUIT BREAKER (#22946-150)

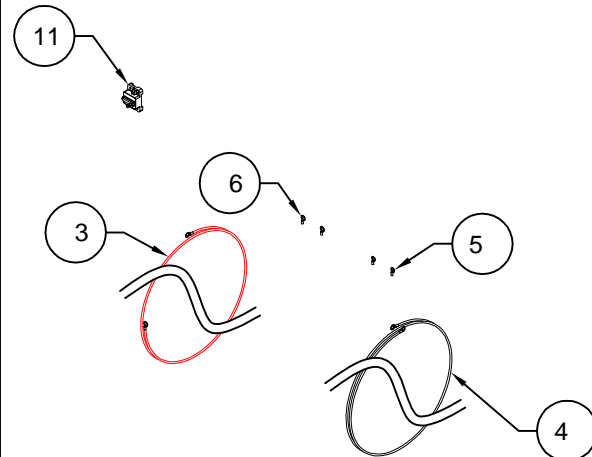

† NOT SHOWN



TITLE  
PACKAGE CONTENTS

DATE  
02-16-17

SECTION  
C100

ESV-1000 SERIES CRANES

SUPERSEDES  
-

ESV101

INSTALLATION INSTRUCTIONS / MINIMUM HARDWARE SPECIFICATIONS  
 ESV-1000 SERIES CRANES

THE ESV-1000 VAN CRANE IS DESIGNED TO BE INSTALLED IN EITHER THE RIGHT REAR CORNER OF THE VEHICLE (PRIMARY LOCATION) OR THE LEFT REAR CORNER OF THE VEHICLE (SECONDARY LOCATION).

**!! MINIMUM HARDWARE SPECIFICATIONS !!**

**Reinforcement plates**

It is the installer's responsibility to ensure the van's floor structure is able to withstand the stresses applied when lifting and maneuvering loads into and out of the van. Additional sub-floor plating may be required.

**Bolts**

The ESV-1000 mounting bolts should be 1/2" in diameter with 13 threads per inch (1/2-13), grade 5 steel zinc plated. Lengths may vary depending on crane location, vehicle structure, and / or additional reinforcement requirements.

**Washers**

Use 1/2" flat washers. One [1] flat washer per bolt head (where applicable) and one [1] flat washer for the Nylon lock (nyloc) nut. Washers must be at grade 5 steel and zinc plated.

**Nyloc Nuts**

Four [4] 1/2-13 nyloc nuts must be properly torqued to 75 ft. lbs. to secure the crane to the van floor.

**! C A U T I O N**

- THE ESV-1000 (1000 LBS.) CAPACITY IS BASED UPON VAN'S STRUCTURAL LIMITATIONS OF THE FLOOR, NOT WINCH CAPACITY. IT IS THE INSTALLER'S RESPONSIBILITY TO ENSURE PROPER REINFORCEMENT OF VAN'S STRUCTURE TO SUPPORT THE CRANE AND ITS LOAD.

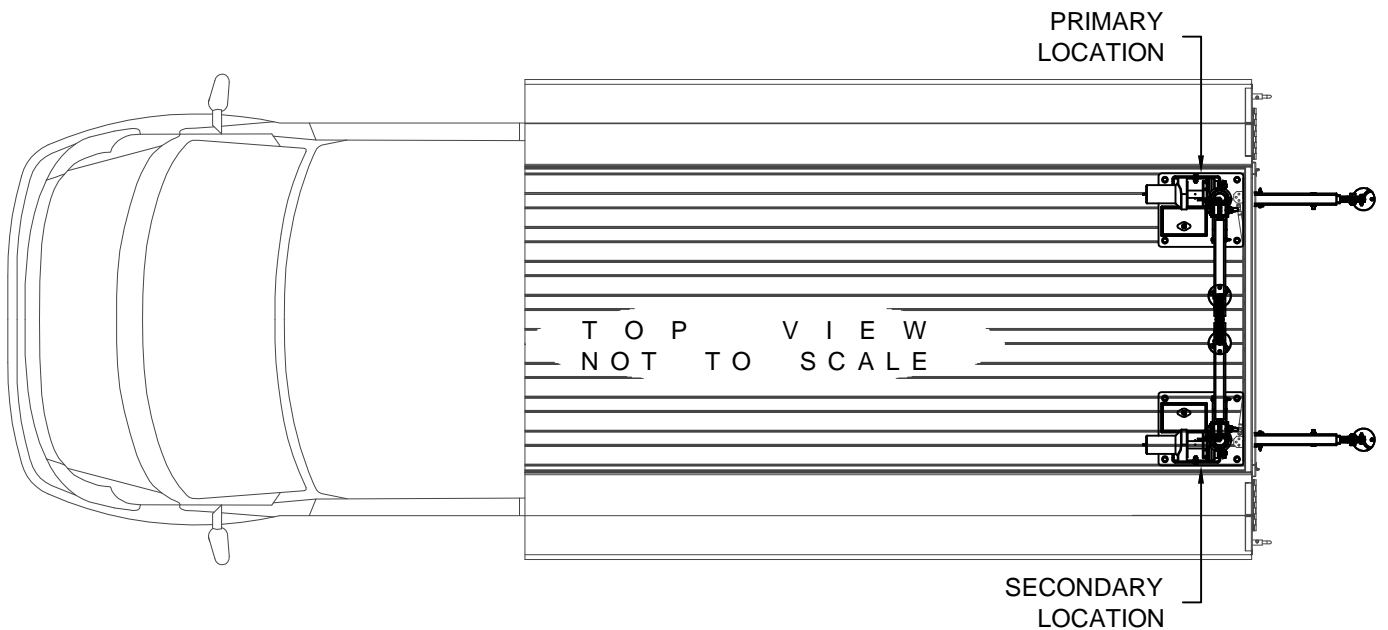

THE ILLUSTRATION ABOVE SHOWS THE GENERAL PLACEMENT OPTIONS FOR THE ESV-1000 VAN CRANE, AND IS TO BE USED FOR REFERENCE ONLY. SPECIFIC LOCATIONS WILL BE LIMITED BY VEHICLE STRUCTURES AND / OR INSTALLER PREFERENCE(S).



TITLE	DATE	SECTION
INSTALL. INSTRUCTIONS	02-16-17	C100
ESV-1000 SERIES CRANES	SUPERSEDES	ESV102
	-	



**READ ALL INSTRUCTIONS FIRST BEFORE PERFORMING INSTALLATION**

**! C A U T I O N**

NOTE ALL SHARP EDGES AND/OR COMPONENTS THAT POSE A POTENTIAL HAZARD WHEN EXAMINING THE VEHICLE. ALWAYS CHECK FOR PROPER CLEARANCE AND ACCESSIBILITY. IT IS THE INSTALLER'S RESPONSIBILITY TO ENSURE PROPER REINFORCEMENT OF THE VEHICLE'S STRUCTURE TO SUPPORT THE CRANE AND ITS LOAD.

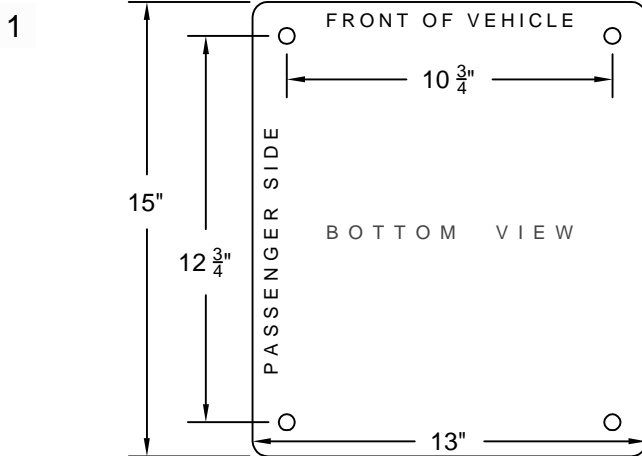

Using the above dimensions, carefully measure and check the undercarriage of the vehicle in the area where you plan to place the crane.

Avoid obstacles that may interfere with the placement of the crane and its mounting components (i.e. brake lines, fuel lines, wiring harnesses, etc.).

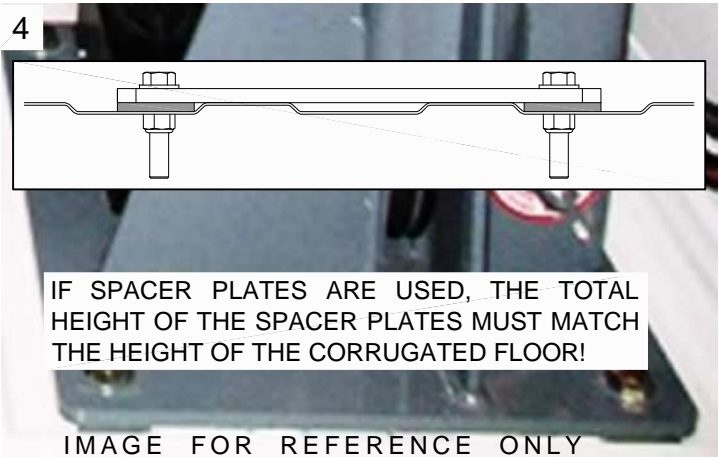
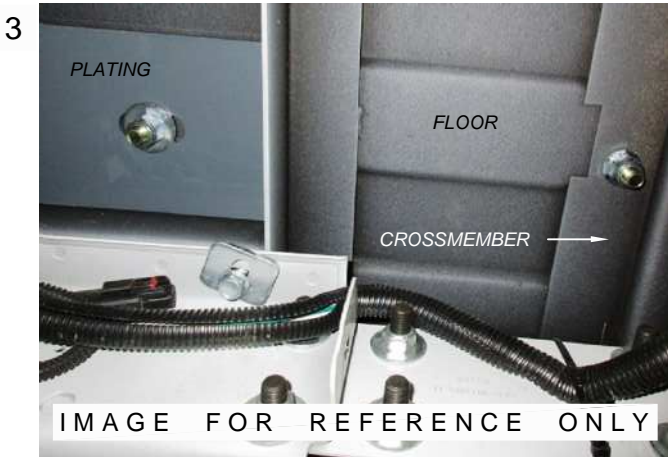

It is the installer's responsibility to ensure the vehicle's floor structure is able to withstand the stresses applied when lifting and maneuvering loads into and out of the vehicle. Additional sub-floor plating may be required.

Mark the hole locations and drill [4] clearance holes for 1/2" bolts. If vehicle's floor is corrugated, spacer plates may be required and may need holes drilled to match the crane's mounting holes (ref. caption #1 above left).



TITLE	DATE	SECTION
INSTALL. INSTRUCTIONS	02-16-17	C100
ESV-1000 SERIES CRANES	SUPERSEDES	ESV103
	-	

**READ ALL INSTRUCTIONS FIRST BEFORE PERFORMING INSTALLATION**

**! D A N G E R**

THE WEIGHT OF THE ESV-1000 CRANE IS APPROXIMATELY 145 LBS.  
 ADDITIONAL HELP MAY BE REQUIRED TO PERFORM THE NEXT STEPS .

1

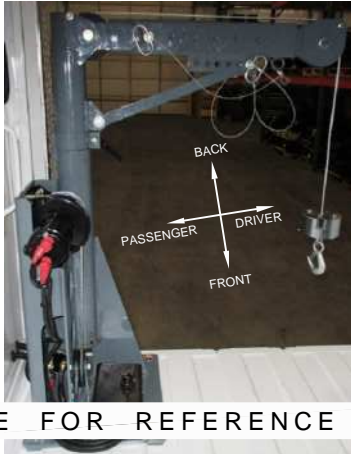

IMAGE FOR REFERENCE ONLY

After holes are drilled, carefully lift the crane into the vehicle. Gently place the crane on top of the floor/spacers, and align the holes.

2

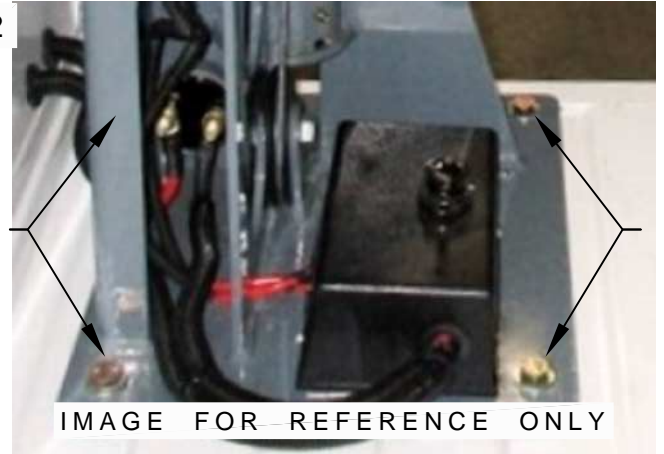

IMAGE FOR REFERENCE ONLY

Feed [1] 1/2-13 X 2-1/2" bolt with [1] 1/2" SAE Flat Washer (supplied) down through each of the crane's mounting holes.

3

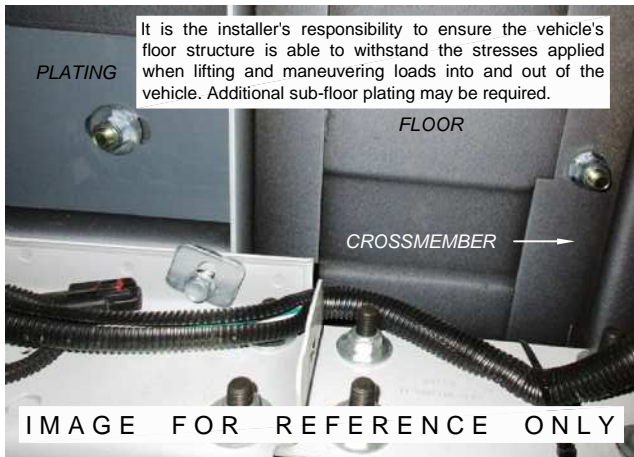

IMAGE FOR REFERENCE ONLY

Insert [1] 1/2" SAE Flat Washer and [1] 1/2-13 Nylon Lock Nut onto each of the mounting bolts (supplied).

4

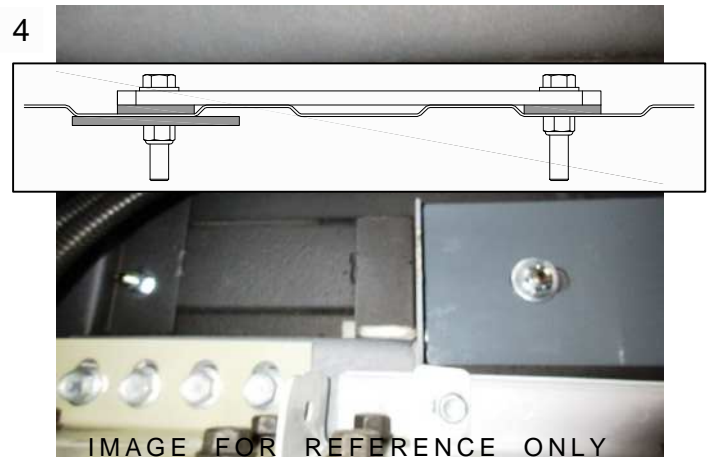

IMAGE FOR REFERENCE ONLY

Before applying torque to fasteners, inspect for pinch points and remove any obstacles from interfering with mounting components. Torque bolts to 75 LBS.



TITLE  
 INSTALL. INSTRUCTIONS

DATE  
 02-17-17

SECTION  
 C100

ESV-1000 SERIES CRANES

SUPERSEDES  
 -

ESV104

**INSTALLATION INSTRUCTIONS (ELECTRICAL)  
ESV-1000 SERIES CRANES**

Using the [2] battery cables in the kit (provided), install the ground (black) and 12V (red) to the crane's contactor box per drawing CEV223.

Install the master disconnect switch close to the crane and within reach of the operator. Using the red battery cable, route the cable to the disconnect switch. The cable will need to be cut to length. Strip both ends of cable, install the heat shrink tube and the battery terminal (provided). Crimp or solder the terminals on each end and slide the heat shrink insulator up onto the terminal. Use a heat gun or equivalent to seal the tube to the cable.

Connect the crane side of the cable to the master disconnect switch and the other cable's end to the second terminal on the switch.

**NOTE:** Both ground and 12v cables must be routed directly to the battery (not included).

Route cables using the vehicles current harness path. Secure both cables to the battery, while protecting them from sharp edges, heat or anything that could damage the cables. Install the black cable to the negative (-) post and red cable to the positive (+) post.

**NOTE:** If you purchased the optional 12v 150 amp circuit breaker, install the circuit breaker as close to the battery as possible. The red 12v cable will need to be cut and the heat shrink & terminals installed in the same manner as the master disconnect switch.

Plug the pendant into the contactor box and turn the master disconnect switch 'ON'. Crane is ready for use. When crane is not in use, the master disconnect switch must be 'OFF' and the pendant removed.

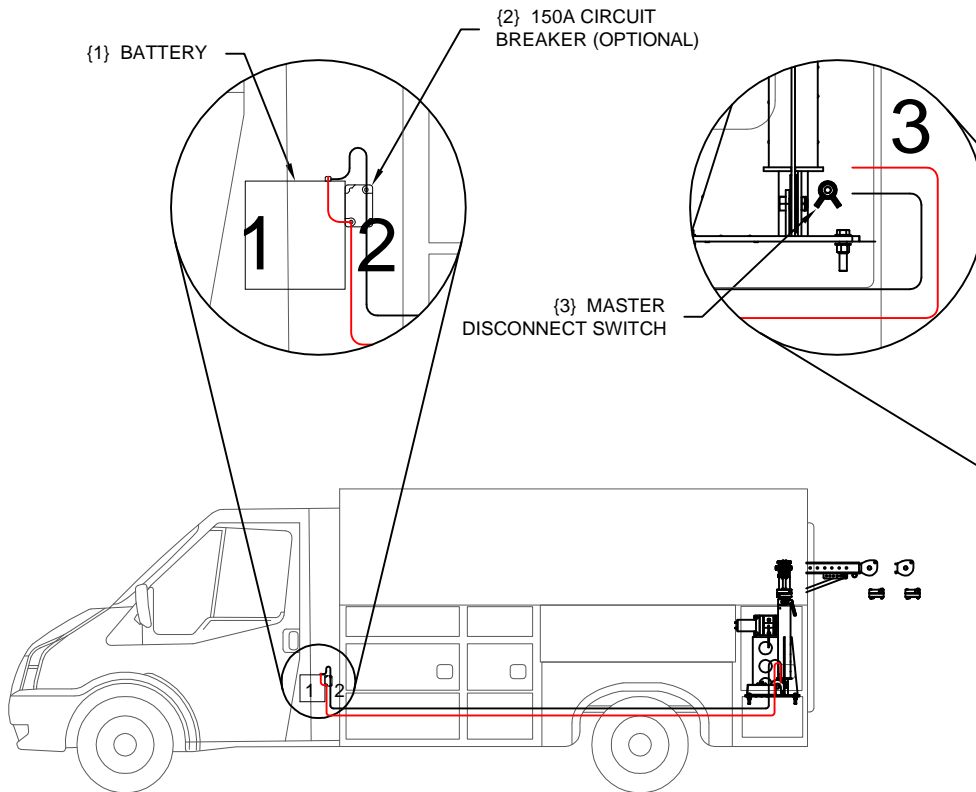
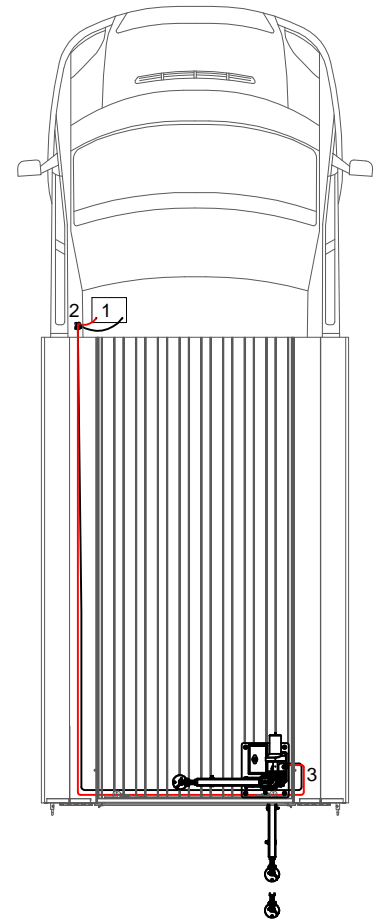

*ILLUSTRATIONS ARE FOR REFERENCE ONLY.  
CABLE PATHS MAY VARY FROM VEHICLE TO VEHICLE.*

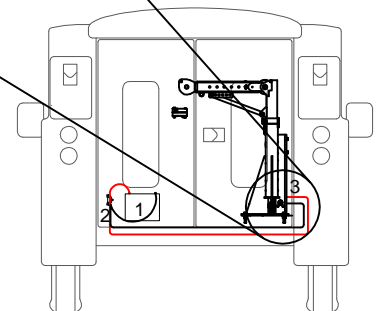

TITLE	ELEC. INSTALL. INSTRCTNS
ESV-1000 SERIES CRANES	

DATE	02-20-17
SUPERSEDES	-

SECTION	C100
ESV105	



RED 12V

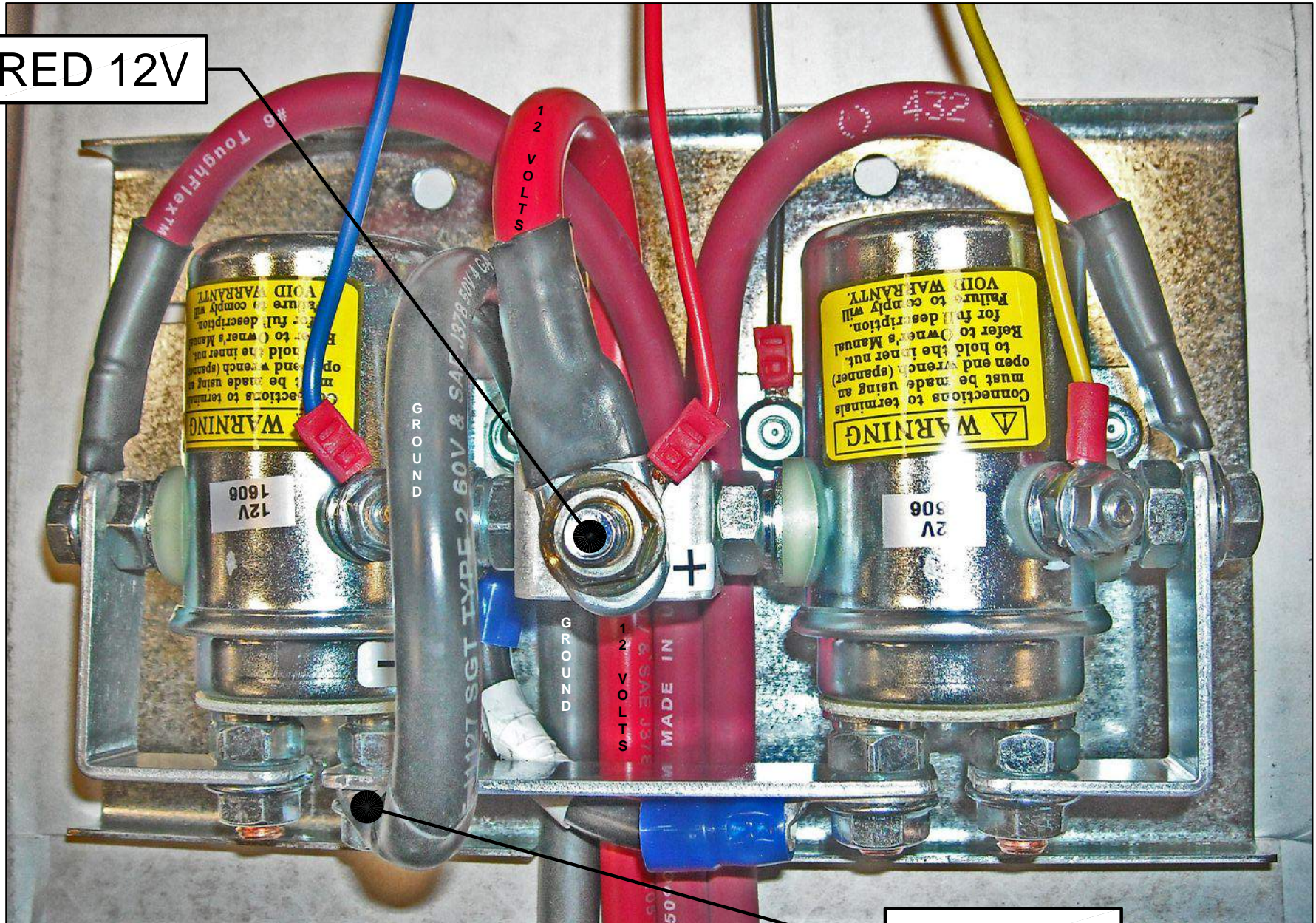

GROUND



TITLE  
BATTERY CABLE INSTALLATION  
CE-008 CONTACTOR BOX

DATE  
08-30-16  
SUPERSEDES  
-

SECTION  
C100  
CEV223



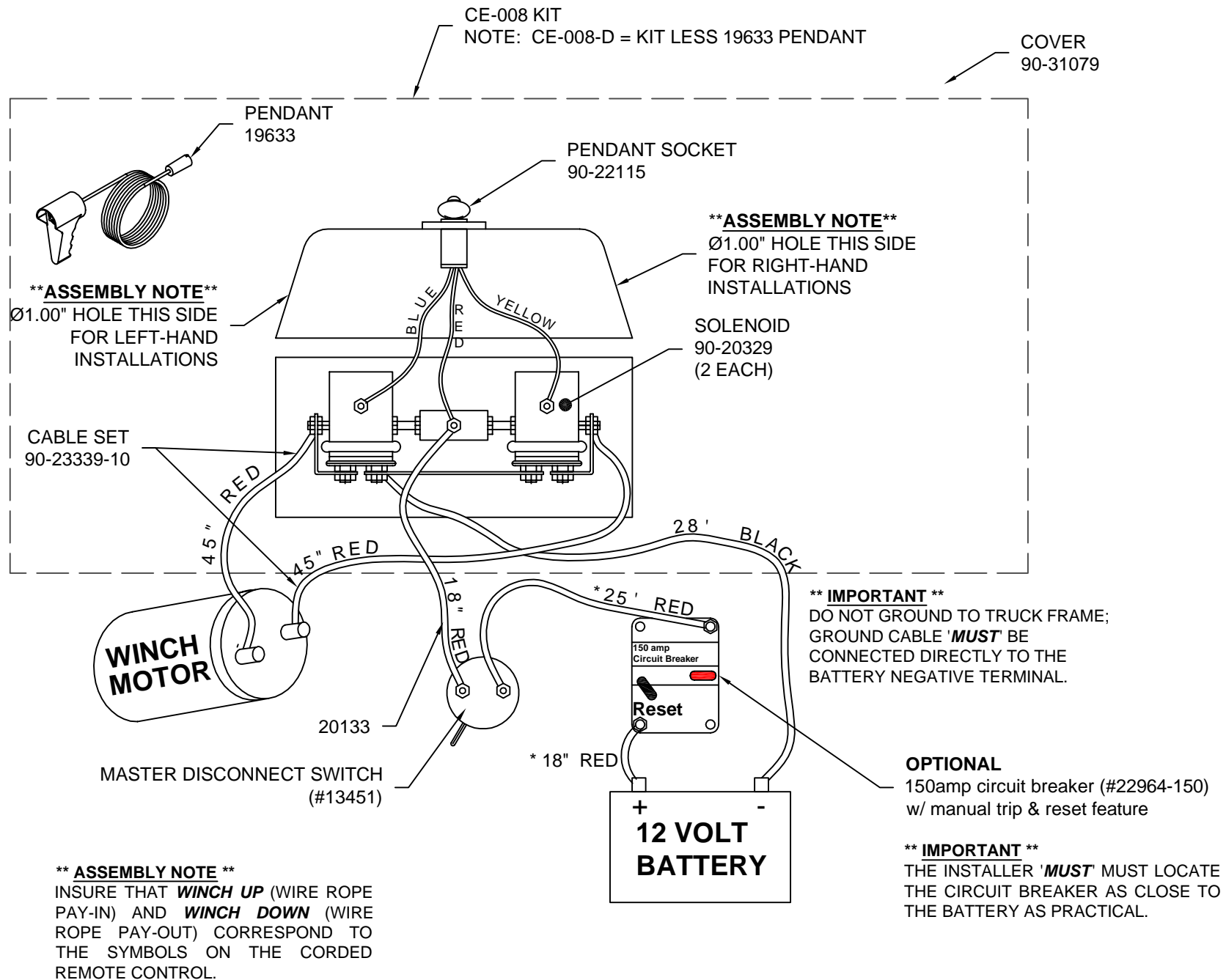

TITLE  
WIRING DIAGRAM

ESV-1000 SERIES CRANES

DATE  
04-19-18A

SUPERSEDES  
02-20-17

SECTION  
C100

ESV106



# SECTION 200

# USER GUIDE

**CAUTIONS**

1. INSPECT VEHICLE AND CRANE, INCLUDING OPERATION, PRIOR TO USE DAILY.
2. DO NOT USE THIS EQUIPMENT EXCEPT ON SOLID, LEVEL SURFACE WITH CRANE MOUNTED ON FACTORY RECOMMENDED TRUCK.
3. BEFORE OPERATING THE CRANE, REFER TO MAXIMUM LOAD (CAPACITY) CHART ON CRANE FOR OPERATING (LOAD) LIMITATIONS.
4. DO NOT OPERATE, WALK, OR STAND BENEATH BOOM OR A SUSPENDED LOAD.
5. UNPLUG PENDANT (AND OPTIONAL ELECTRIC QUICK DISCONNECT, IF ON MODEL) WHEN NOT IN USE.
6. FOR TRAVEL, BOOM MUST BE TIED DOWN IN THE STOWED POSITION.

**DANGER**

- THIS CRANE IS NOT A PASSENGER LIFT
- IT IS NOT DESIGNED OR INTENDED TO BE USED TO LIFT, SUPPORT, OR OTHERWISE TRANSPORT PERSONNEL.

**YOU MUST NOT OPERATE THIS CRANE UNLESS :**

1. YOU HAVE BEEN TRAINED IN THE SAFE OPERATION OF THIS CRANE, **AND**
2. YOU KNOW AND FOLLOW THE SAFETY AND OPERATION RECOMMENDATIONS CONTAINED IN THE MANUFACTURER'S MANUALS, YOUR EMPLOYER'S WORK RULES, AND APPLICABLE GOVERNMENT REGULATIONS. AN UNTRAINED OPERATOR SUBJECTS THEMSELVES AND OTHERS TO DEATH OR SERIOUS INJURY.

REFERENCE SAFETY MANUAL INST-23233



TITLE	DATE	SECTION
CRANE SAFETY & HZRDS	02-20-17E	C200
▲ CE-/CEV/ESV SERIES CRANES	SUPERSEDES 09-08-16D	CE-044

# OPERATING INSTRUCTIONS

## ELECTRIC WINCH

The winch is operated by a control switch in a plug-in remote pendant. Unplug the pendant and store it in the vehicle when the crane is not in use. For optional 110 volt AC winch, the pendant is non-removable.



# C A U T I O N

- BOOM MUST BE SECURED (STOWED POSITION) AND BRAKE SET BEFORE DRIVING VEHICLE. DO NOT DRIVE WITH BOOM EXTENDED OUT.

## MASTER DISCONNECT SWITCH

The Master Disconnect Switch isolates electrical power from the crane and should be switched OFF anytime the crane is NOT in use.

## OPTIONAL CIRCUIT BREAKER

An optional 150amp circuit breaker (#22964-150) is available. The circuit breaker should be placed between the lead-acid battery supply and the crane; ***as close as practical to the lead-acid battery.***

# MAINTENANCE

## WINCH

The winch is permanently lubricated. There may be grease leakage out of the winch, especially during the first few operations. This is normal and it is not necessary to grease or oil any part of the winch at any time.

## WIRE ROPE

Inspect wire rope periodically. If any wear or fraying exists, replace wire rope.



TITLE	DATE	SECTION
OPER. INSTR. & MNTNCE	02-20-17	C200
ESV-1000 SERIES CRNS	SUPERSEDES -	ESV107



**USER GUIDE**  
**ESV-1000 SERIES CRANES**

- Prior to using crane, read all operator instructions and Safety Manual
- Make sure you are familiar with all of the controls, functions, and locking mechanisms
- Read and adhere to all safety placards that are installed on the crane and the vehicle
- Since the manufacturer has no direct control over the crane application and operation, conformance with good safety practices is the responsibility of the operator
- The vehicle and crane are to be positioned on firm level surfaces with the chassis brake engaged
- Whenever possible, always rotate the crane or boom by 'pushing' away from you
- Always use proper rigging hardware and slings

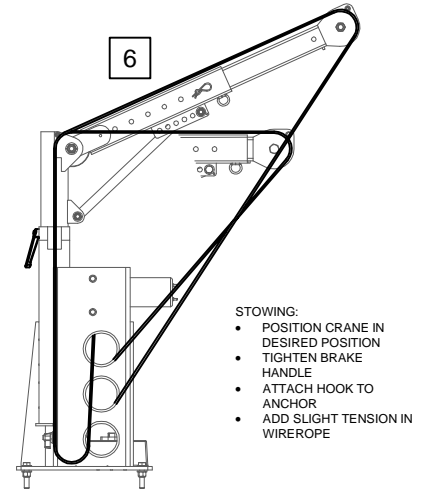

1. Plug control pendant into socket located on the crane
2. Turn Master Disconnect Switch to the 'ON' position
3. Loosen Brake Handle to rotate the crane and center the wire rope hook over the load
4. Using the pendant, lower hook to the load and attach to the proper rigging hardware / sling(s)
5. Carefully raise the load so it will clear the van floor and move load to desired location
6. Unhook the load and stow the hook. Reposition the crane into the stowed position for travel, and secure the load.

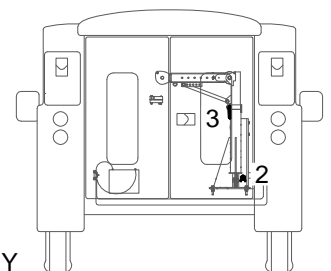
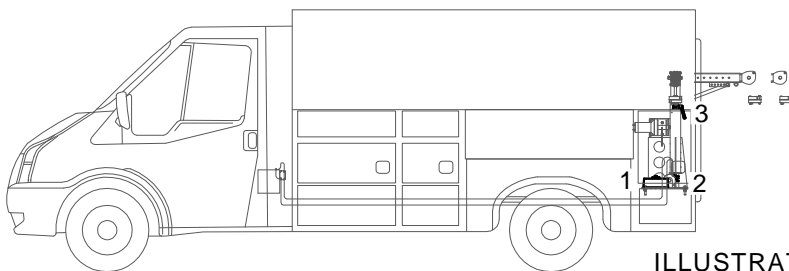
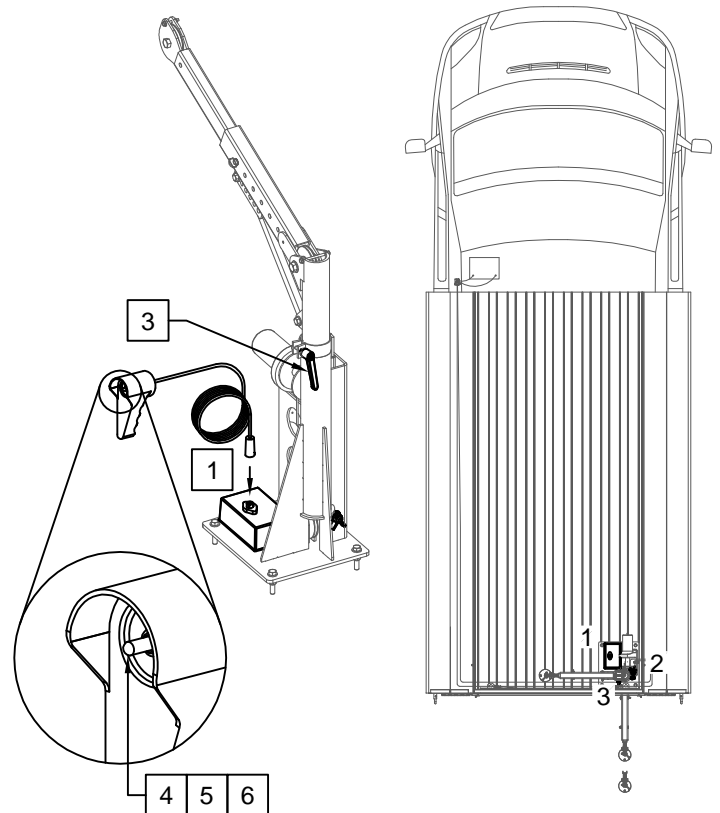

ILLUSTRATIONS FOR REFERENCE ONLY



TITLE	DATE	SECTION
USER INSTRUCTIONS	02-20-17	C200
ESV-1000 SERIES CRANES	SUPERSEDES	ESV108
	-	



# SECTION 300

# SPECIFICATIONS



# CAUTION

- 1 1000 LBS MAXIMUM CAPACITY IS BASED UPON TYPICAL VAN FLOOR STRUCTURE LIMITATIONS, NOT WINCH CAPACITY. IT IS THE SOLE RESPONSIBILITY OF THE INSTALLER TO DETERMINE IF ADDITIONAL FLOOR REINFORCEMENT IS NECESSARY.



# WARNING

- THESE PRODUCTS ARE NOT PASSENGER LIFTS. THEY ARE NOT DESIGNED OR INTENDED TO BE USED TO LIFT, SUPPORT OR OTHERWISE TRANSPORT PERSONNEL.

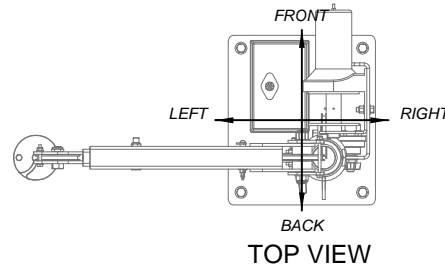

TOP VIEW

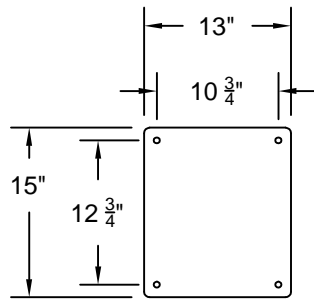

BOTTOM

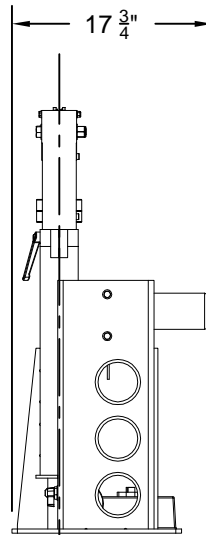

RIGHT

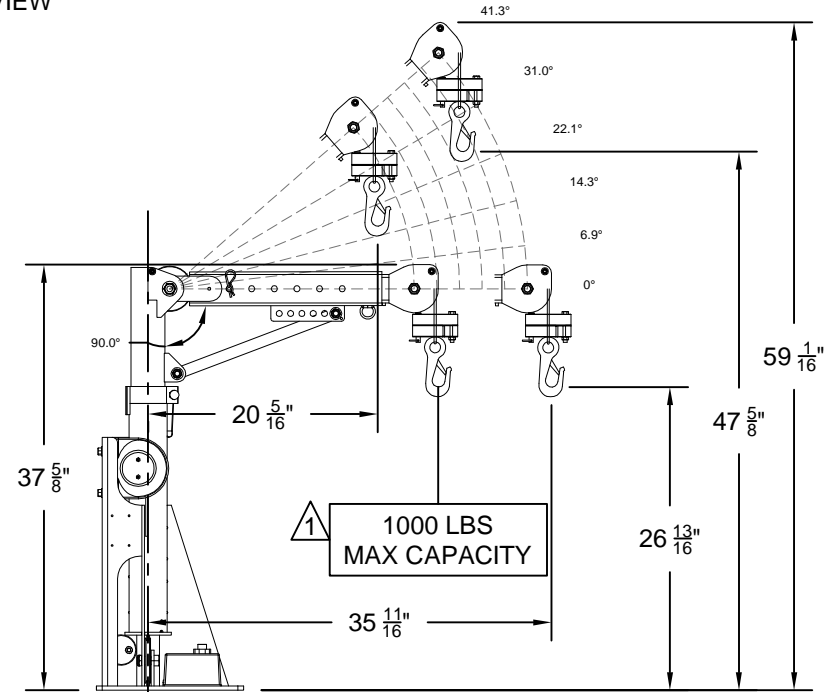

FRONT



TITLE  
DIMENSIONS & CAPACITY

ESV-1000 SERIES CRANES

DATE  
02-21-17

SUPERSEDES  
-

SECTION  
C300

ESV109

# 15810-3/16-25 WIREROPE ASSEMBLY

TYPE: 3/16" DIAMETER  
 7 x 19, GALVANIZED  
 (GAC 7X19 LHRL-IWRC, SB 4200)  
 LENGTH: 25'

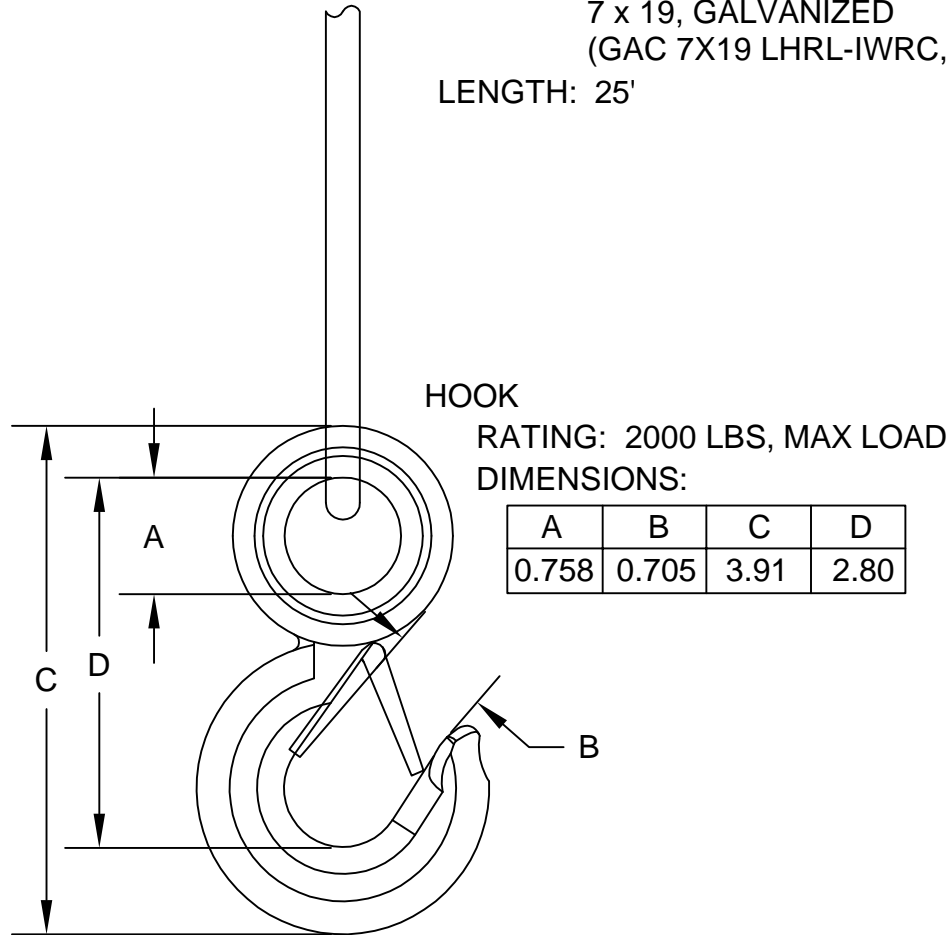

TITLE  
 WIREROPE & HOOK SPECIFICATIONS

DATE  
 02-22-17G

SECTION  
 C300

VC750FB/1000 & ESV-1000 SERIES CRANES ▲

SUPERSEDES  
 01-30-17F

CEV162



# SECTION 400

# PARTS



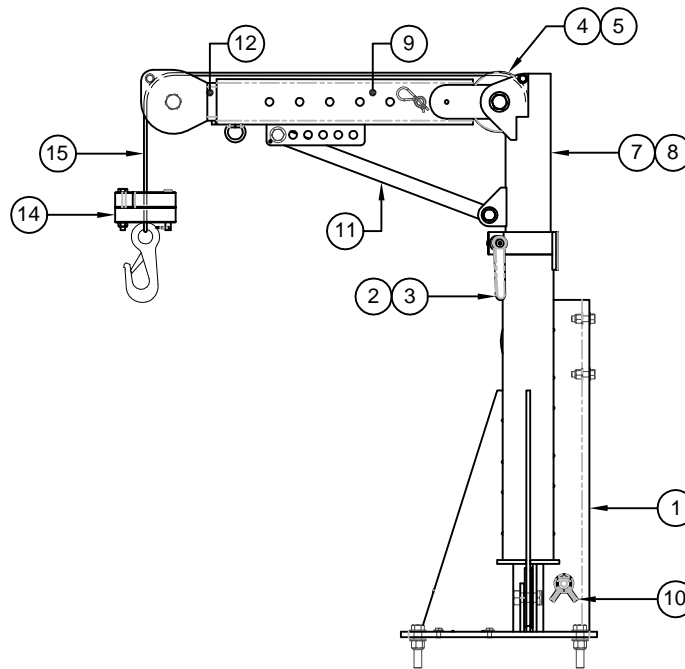
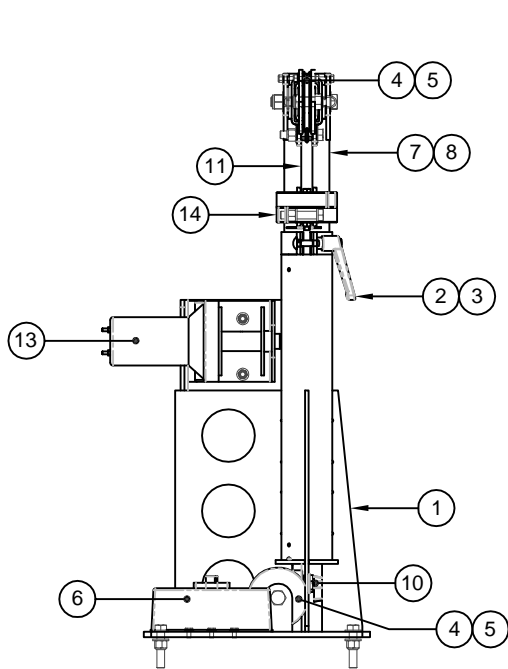
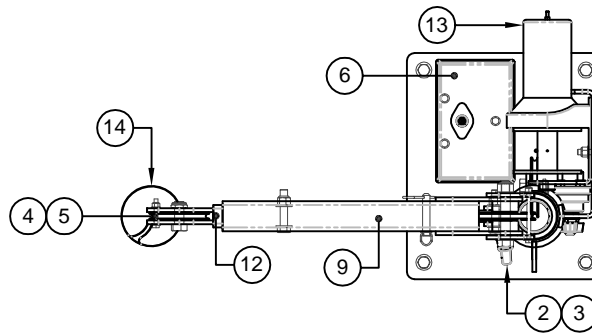

REFERENCE REPLACEMENT PARTS LIST ESV111

REAR RIGHT INSTALLATION (#23380-2) SHOWN



TITLE  
REPLACEMENT PARTS DRAWING  
ESV-1000 SERIES CRANES

DATE  
02-23-17  
SUPERSEDES  
-

SECTION  
C400  
ESV110

REPLACEMENT PARTS LIST  
 ESV-1000 SERIES CRANES

ITEM	PART NUMBER	QTY	DESCRIPTION
1	23381-2	1	BASE WELDMENT; ESVC
2	CE-017	1	BRAKE HANDLE
3	!CHCS03816150	1	CARRIAGE BOLT; 3/8-16 X 1-1/2" LG., GR. 5
4	13168-7	3	SHEAVE BUSHING
5	19646	3	SHEAVE W/ BUSHING
6	CE-008	1	CE-009 WINCH CONTACTOR BOX
7	23382	1	MAST WELDMENT; ESVC
8	23371	1	THRUST BEARING; BRONZE, 3" O.D. X 2" I.D. X 0.12" THICK
9	23383	1	PRIMARY BOOM WELDMENT; ESVC
10	13451	1	MASTER DISCONNECT SWITCH
11	23370	1	BOOM STRUT
12	23384	1	SECONDARY BOOM WELDMENT; ESVC
13	CE-009	1	WINCH W/ CABLE & TENSION KIT
14	16735	1	ASSEMBLY; HEADACHE BALL
15	-	-	-
16	-	-	-
17	-	-	-
18	-	-	-
19	-	-	-
20	-	-	-
21	-	-	-
22	-	-	-
23	-	-	-
24	-	-	-
25	-	-	-
26	-	-	-
27	-	-	-
28	-	-	-
29	-	-	-
30	-	-	-

SEE REPLACEMENT PARTS DWG #ESV110



TITLE	DATE	SECTION
REPLCMNT PART LIST	02-24-17	C400
ESV-1000 SERIES CRNS	SUPERSEDES	ESV111
	-	

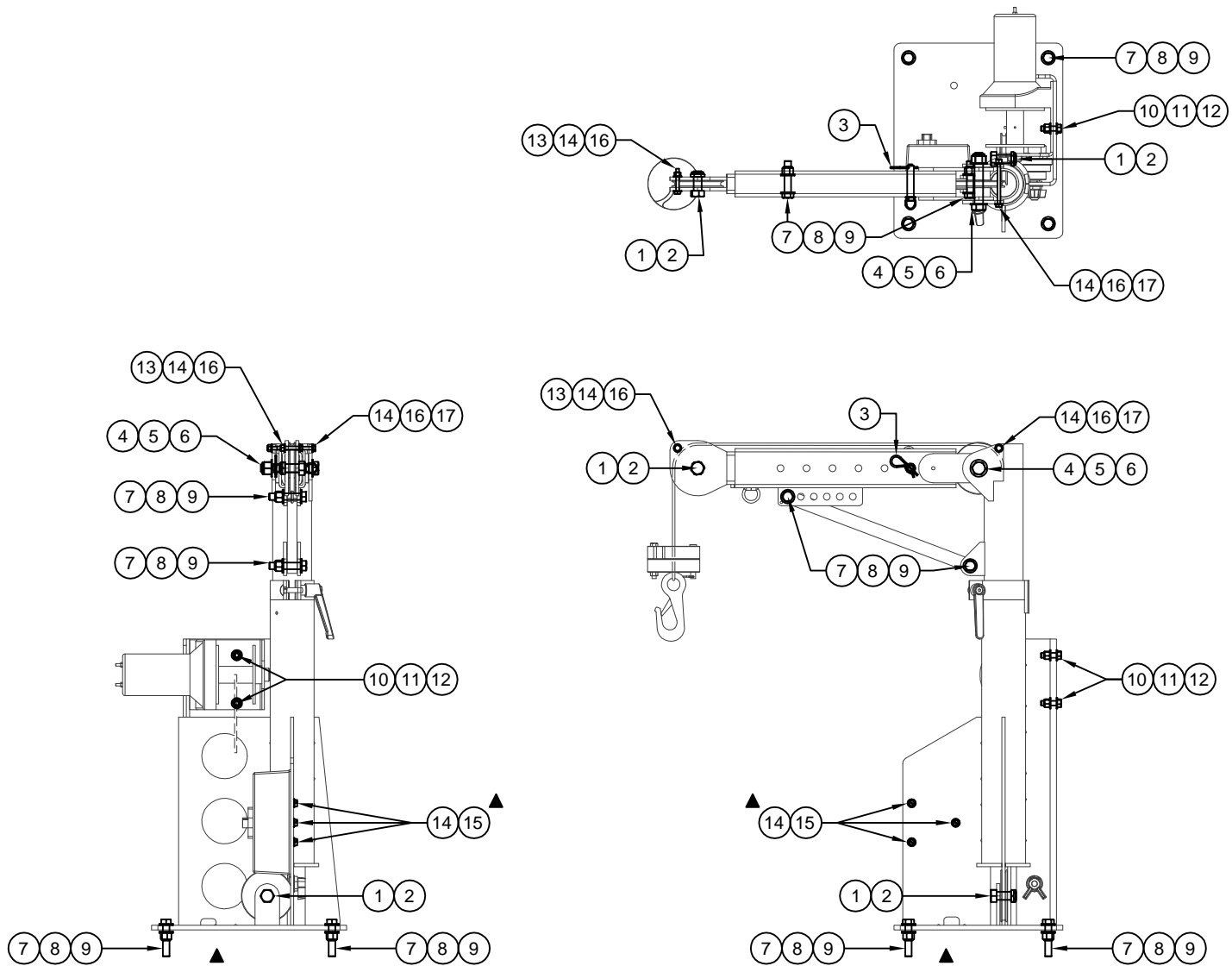

REFERENCE REPLACEMENT HARDWARE LIST ESV113

REAR RIGHT INSTALLATION (#23380-2) SHOWN



TITLE	REPLACEMENT HARDWARE DRAWING
ESV-1000 SERIES CRANES	

DATE	01-05-18A	SECTION	C400
SUPERSEDES	02-24-17		ESV112

REPLACEMENT HARDWARE LIST  
 ESV-1000 SERIES CRANES

ITEM	PART NUMBER	QTY	DESCRIPTION
1	!JNUT-06311N	2	JAM NUT; 5/8-11, NYLON LOCK
2	!HHCS06311150-8	2	HEX HEAD CAP SCREW; 5/8-11 X 1-1/2" LG., GR. 8
3	CE-070	1	PIN ASSEMBLY
4	!HHCS06311400	1	HEX HEAD CAP SCREW; 5/8-11 X 4" LG.
5	!FWSH-063SAE	2	FLAT WASHER; 5/8", SAE
6	!LNUT-06311-8	1	LOCK NUT; 5/8-11, GR. 8
7	!HHCS05013250	6	HEX HEAD CAP SCREW; 1/2-13 X 2-1/2" LG.
8	!FWSH-050SAE	12	FLAT WASHER; 1/2", SAE
9	!LNUT-05013	6	LOCK NUT; 1/2-13
10	!FWSH-038SAE	4	FLAT WASHER; 3/8", SAE
11	!LNUT-03816	2	LOCK NUT; 3/8-16
12	!HHCS03816125	2	HEX HEAD CAP SCREW; 3/8-16 X 1-1/4" LG.
13	!HHCS02520125	1	HEX HEAD CAP SCREW; 1/4-20 X 1-1/4" LG.
14	!FWSH-025	7	FLAT WASHER; 1/4"
15	!HHCS02520050	3	HEX HEAD CAP SCREW; 1/4-20 X 1/2" LG.
16	!LNUT-02520	2	LOCK NUT; 1/4-20
17	!HHCS02520350	1	HEX HEAD CAP SCREW; 1/4-20 X 3-1/2" LG.
18	-	-	-
19	-	-	-
20	-	-	-
21	-	-	-
22	-	-	-
23	-	-	-
24	-	-	-
25	-	-	-
26	-	-	-
27	-	-	-
28	-	-	-
29	-	-	-
30	-	-	-

SEE REPLACEMENT PARTS DWG #ESV112

	TITLE	DATE	SECTION
	REPLCMNT HRDWR LIST	02-24-17	C400
	ESV-1000 SERIES CRNS	SUPERSEDES	ESV113
		-	

# REPLACEMENT PARTS LIST

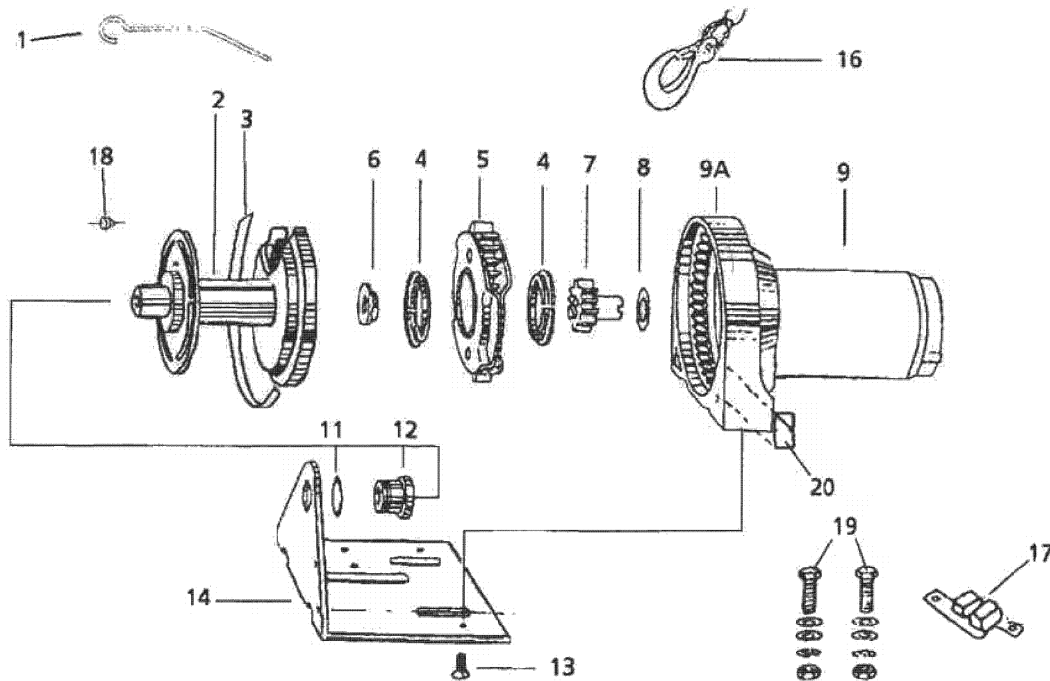

Reference Number	Description	Part Number	Qty
1	Handsaver	89-32300	1
2	Rotating Gear Drum	90-32038	1
3	Perimeter Bearing	90-23137	1
4	Carrier Bearing	90-23140	2
5	Planetary Gearing Assembly	90-23138	1
6	Nylon Step Washer	90-12418	1
7	10-Tooth Sun Gear	90-22865	1
8	Flat Thrust Washer	90-23120-08	1
9A	Stationary Ring Gear w/ Needle Bearing	90-12629	1
9	12 Volt Motor w/Ring Gear & Needle Bearing	90-32425	1
	12 Volt Motor (external mtg bolt applications only)	90-33293	1
11	Shim Washer	90-23120-05	AR
12	Bushing	90-12174	1
13	5/16" Socket Head Cap Screw	90-23056-02	2
14	Main Frame Base Plate	90-41019	1
16	3/16" x 25' Cable & Hook Assembly	1511	1
17	12V Circuit Breaker Assembly	90-22873	1
18	Rope Retainer	90-12419	1
19	Pair of 3/8" Bolts & Nuts, 4 Flat Washers & 2 Locking Washers	90-22892	1
20	Handsaver Label	90-12417	1
NS	Pulley Block	2227	1

AR denotes "As Required"



TITLE  
WINCH RPLCMNT PARTS

DATE  
02-24-17E

SECTION  
C400

▲  
CE-1500-FB/CEV/ESV SERIES

SUPERSEDES  
08-18-16D

CE-055



ITEM	QTY	DESCRIPTION	PART #
1	1	COVER; CONTACTOR BOX, PENDANT SOCKET	90-31079
2	1	PENDANT SOCKET, CONTACTOR BOX COVER	90-22115
3	2	SOLENOID; CONTACTOR BOX, WINCH	90-20329

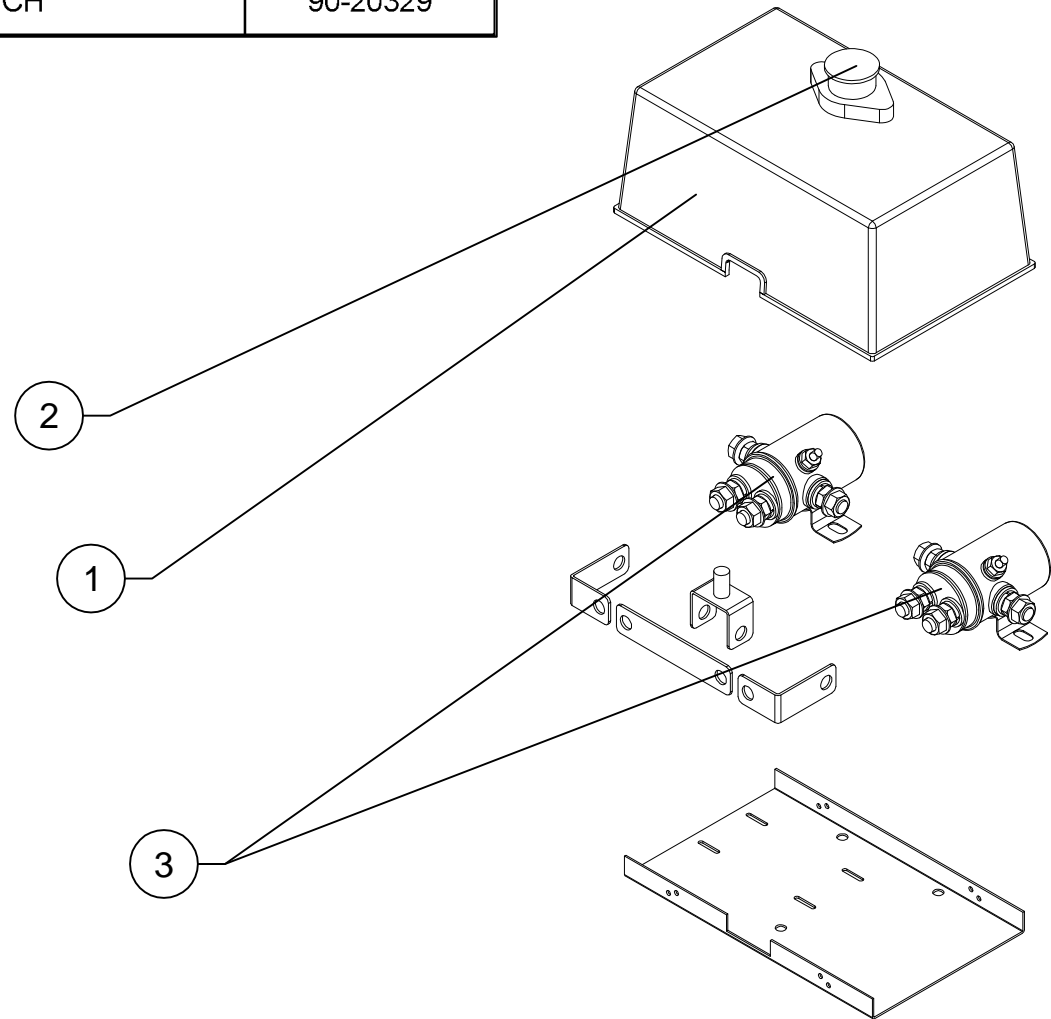

TITLE  
REPLACEMENT PARTS DIAGRAM

CE-008 CONTACTOR BOX

DATE  
08-30-16

SUPERSEDES  
-

SECTION  
C400

CEV224

DECAL #: 15390  
 DESCRIPTION: CAUTION, INSPECT VEHICLE & CRANE...  
 PURPOSE: TO INFORM THE OPERATOR OF KEY OPERATING REQUIREMENTS.  
 QUANTITY: 1  
 PLACEMENT: UPPER MAST ON SIDE, OPPOSITE PRIMARY BOOM

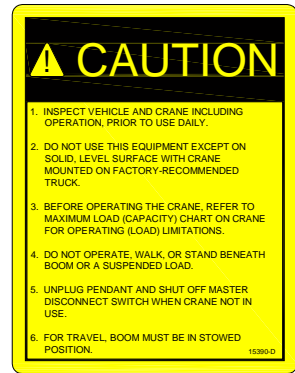

DECAL #: 15391  
 DESCRIPTION: DANGER, NOT A PASSENGER LIFT  
 PURPOSE: TO INFORM OPERATOR NOT TO LIFT, SUPPORT, OR TRANSPORT PERSONNEL, AND TO ENSURE OPERATOR IS ADEQUATELY TRAINED.  
 QUANTITY: 1  
 PLACEMENT: UPPER MAST ON SIDE, OPPOSITE PRIMARY BOOM



DECAL #: 15392  
 DESCRIPTION: DANGER, ELECTROCUTION HAZARD, MACHINE (CRANE)  
 PURPOSE: TO INFORM OPERATOR THAT MACHINE (CRANE) REPRESENTS AN ELECTROCUTION HAZARD SHOULD IT COME CLOSE TO OR IN CONTACT WITH AN ELECTRICAL VOLTAGE SOURCE.  
 QUANTITY: 1  
 PLACEMENT: UPPER MAST ON SIDE, OPPOSITE PRIMARY BOOM

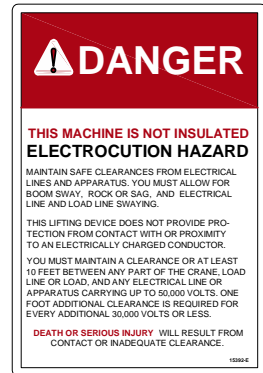

DECAL #: 15393  
 DESCRIPTION: DANGER, ELECTROCUTION HAZARD, VEHICLE (TRUCK)  
 PURPOSE: WARNS OF DANGER FROM ELECTRICALLY CHARGED VEHICLE, CRANE, OR LOAD.  
 QUANTITY: 4  
 PLACEMENT: EACH SIDE & EACH END OF VEHICLE

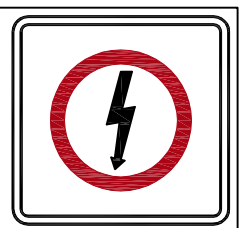
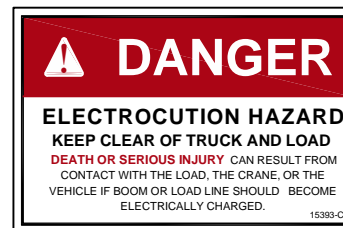

TITLE	DATE	SECTION
SAFETY DECALS	09-29-16A	C400 ▲
VENTURO VAN CRANES	SUPERSEDES 08-02-16	CEV170

DECAL #: 15513  
 DESCRIPTION: MASTER DISCONNECT SWITCH  
 PURPOSE: TO INFORM THE OPERATOR OF LOCATION AND OPERATION OF MASTER DISCONNECT SWITCH  
 QUANTITY: 1  
 PLACEMENT: ON MASTER DISCONNECT SWITCH BRACKET



DECAL #: 15398  
 DESCRIPTION: UNPLUG REMOTE CONTROL  
 PURPOSE: TO INFORM OPERATOR TO UNPLUG REMOTE CONTROL WHEN NOT IN USE  
 QUANTITY: 1  
 PLACEMENT: NEAR PENDANT SOCKET



DECAL #: 573403  
 DESCRIPTION: WARNING - STOWING  
 PURPOSE: TO INFORM OPERATOR TO STAY AWAY FROM THE BOOM WHEN STOWING  
 QUANTITY: 1  
 PLACEMENT: UPPER MAST ON SIDE, OPPOSITE PRIMARY BOOM



TITLE	DATE	SECTION
SAFETY DECALS	09-29-16A	C400 ▲
VENTURO VAN CRANES	SUPERSEDES 08-02-16	CEV171

DECAL DRAWING & LIST  
ESV-1000 SERIES CRANES

PART NO.: 15672-1000  
 DECAL: CAPACITY 1000 LBS  
 FUNCTION: TO INFORM OPERATOR OF MAXIMUM LIFTING CAPACITY  
 QUANTITY: 2  
 PLACEMENT: SECONDARY BOOM PLATE, BOTH SIDES



PART NO.: CEV326  
 DECAL: MODEL NAME  
 FUNCTION: TO SHOW THE MODEL OF THE CRANE  
 QUANTITY: 1  
 PLACEMENT: ONE ON BACK SIDE OF WINCH MOUNTING PLATE



PART NO.: ▲ 17389-4  
 DECAL: VENTURO  
 FUNCTION: MANUFACTURER'S LOGO  
 QUANTITY: 1  
 PLACEMENT: ▲ GUSSET FACING REAR



PART NO.: 24964 (MAY NOT APPLY TO ALL MODELS)  
 DECAL: DANGER, STABILIZERS, STAND CLEAR  
 FUNCTION: TO INFORM OPERATOR TO STAND CLEAR OF STABILIZER JACK LEG  
 QUANTITY: 2  
 PLACEMENT: JACK LEG, NEAR TOP ON SAME SIDE AS HAND CRANK



TITLE DECAL DRAWING & LIST	DATE 01-05-18A	SECTION C400
	SUPERSEDES 02-24-17	ESV114

\*\* ALL VIEWS ARE REFERENCED FROM AN INSTALLATION ON THE REAR PASSENGER SIDE OF VEHICLE \*\*

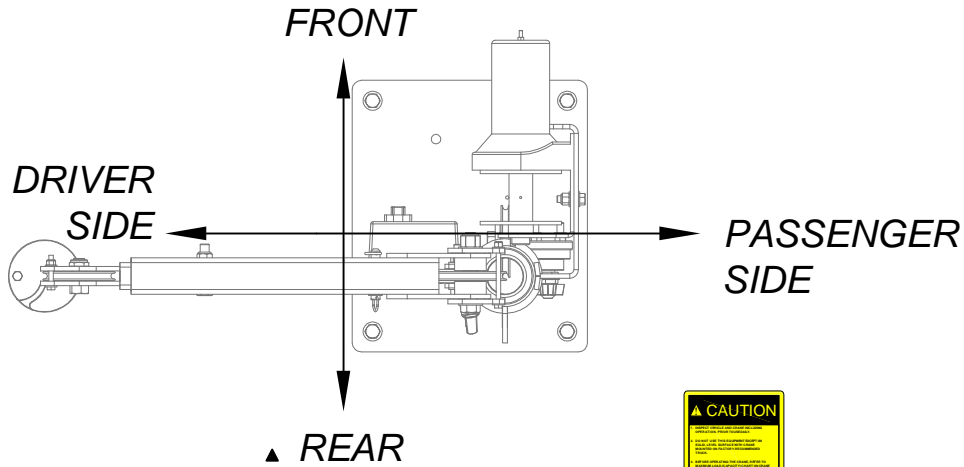

▲ 23380-2 SHOWN FOR REFERENCE

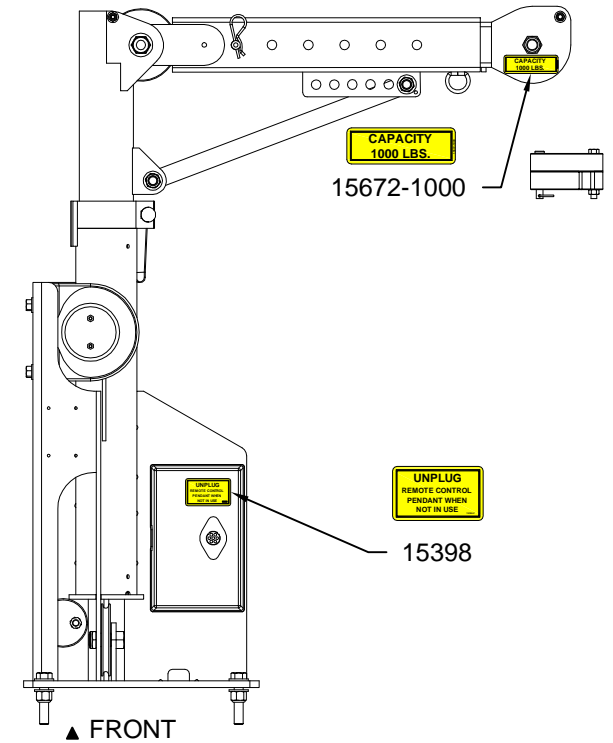
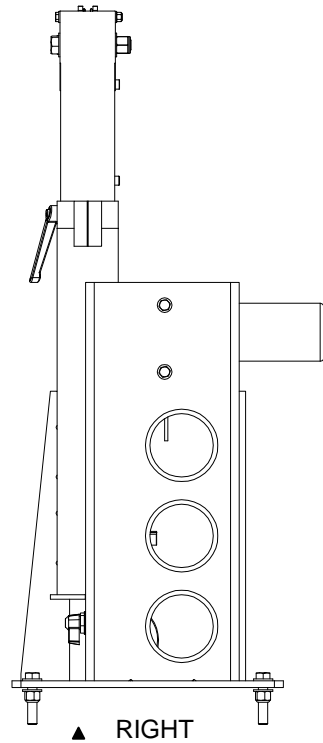
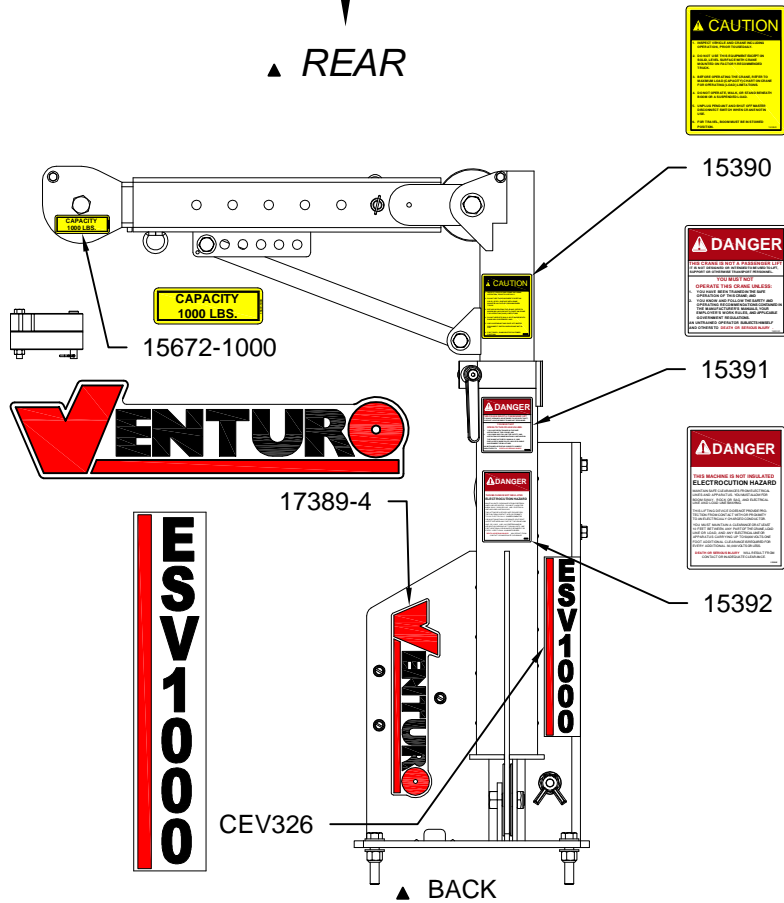

TITLE  
DECAL LOCATIONS

ESV-1000 SERIES CRANES

DATE  
01-08-18A

SUPERSEDES  
02-27-17

SECTION  
C400

ESV115

ESV117 FIELD SERVICE LABEL KIT  
 ESV-1000 SERIES CRANES

ITEM NO.	PART NO.	QTY	DESCRIPTION
1	15397	1	BOM; ACCIDENT PREVENTION SIGNS
2	17389-4	1	DECAL; VENTURO (SMALL)
3	15672-1000	2	DECAL; CAPACITY, 1000 LBS
4	CEV326	1	DECAL; MODEL, ESV1000
5	ESV117	1	IDWG: FIELD SERVICE LABEL KIT

15397 ACCIDENT PREVENTION SIGNS		
PART NO.	QTY.	DESCRIPTION
15390	1	DECAL; CAUTION, OPERATIONS
15391	1	DECAL; DANGER, NOT PASSENGER LIFT
15392	1	DECAL; DANGER, ELECTRICAL HAZARD SIGN
15393	4	DECAL; DANGER, ELECTRICAL HAZARD
15394	1	APPLICATION INSTRUCTIONS
15398	1	DECAL; UNPLUG PENDANT
15401	1	DECAL; UNLAWFUL TO OPERATE
15513	1	DECAL; MASTER DISCONNECT
22317	1	DECAL SHEET; VENTURO, COMPLEMENTARY
20927	1	DECAL; CRANE STABILITY



TITLE	DATE	SECTION
FIELD SERVICE LABEL KIT	02-27-17	C400
ESV-1000 SERIES CRANES	SUPERSEDES	ESV116
	-	