

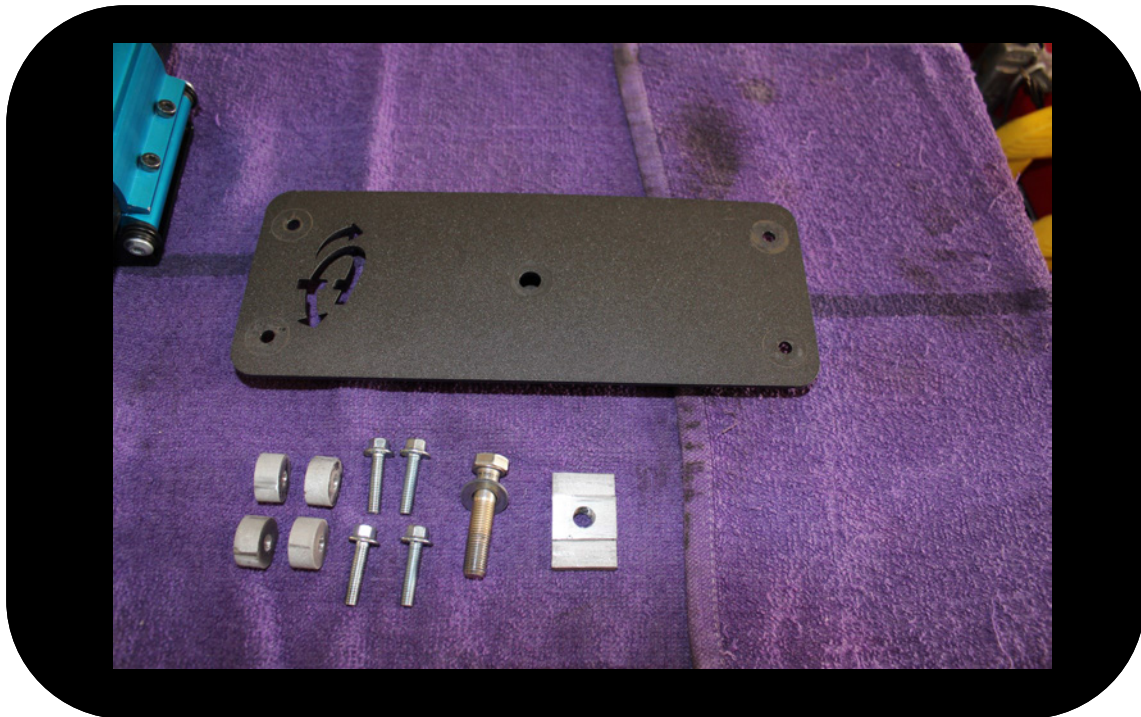

# INSTALLATION INSTRUCTIONS

**Part# 22-0318**

**22-0318 - Bed Cleat Mounting kit for ARB Compressor (Compressor Not Included)**



***Air It Up!***



PLEASE TAKE A MINUTE TO READ THIS ENTIRE INSTRUCTION MANUAL BEFORE YOU START.  
WE WANT YOU TO HAVE A FUN AND EASY INSTALLATION WITHOUT HURTING YOURSELF OR YOUR Raptor.

**SAFETY PRECAUTIONS**

If you are working on the ground always use jack stands and chalk any tires touching the ground. Wear safety glasses and gloves as you will be using power tools for this installation. We recommend disconnecting the battery any time you are working on your Raptor.

**NEVER DRIVE WITH THE WHIPS CONNECTED TO YOUR Raptor, DAMAGE CAN OCCUR.**

**TOOLS NEEDED**

- Thread Sealer (*Loctite 577—We do not recommend using Teflon tape*)
- Spray Bottle with Mild Soapy Water
- Medium Flathead Screw Driver
- Tube Cutter or Sharp Utility Knife

**WRENCHES**

- Crescent
- 9/16", 5/8"
- T-30 Torx
- 1/4" Allen Wrench

**1/4" Drive**

- Ratchet
- 10mm Socket
- 11mm Socket
- 1/4" Allen Socket

## Secure Raptor and Prep for Installation

This entire install can be done on the ground but jack stands or a lift will make it even easier.

1. Park your Raptor and set the parking brake.
2. Raise your Hood for access to the engine compartment.
3. Disconnect the negative (-) battery terminal.
4. Read and refer to your ARB instructions for all issues directly related to your ARB compressors. UpDownAir warranty does not cover any ARB Compressors or parts.
5. Have your Raptors Owner Manual Handy for wiring the ARB Compressor to the Auxiliary/ Up fitter Switches.



**Always:**

Use a tube cutter or sharp utility knife.

**Do Not:**

Fold or kink the Air Line Tube. Cut the Air Line Tube at an angle. Do not use pliers, scissors, snips, saws, or side cutters.

**PROPER AND IMPROPER CUTS IN THE AIR LINE TUBE**

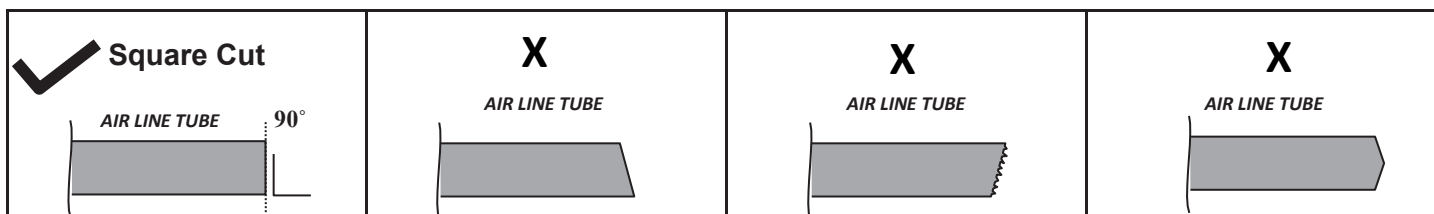

Insert end of Air Line Tube into Air Fitting.

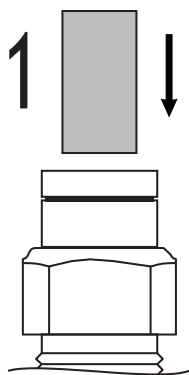

Push Air Line Tube into Air Fitting as far as possible.

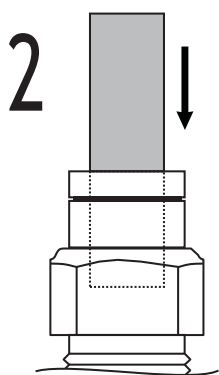

Gently pull on the Air Line Tube to check for a secure fit.

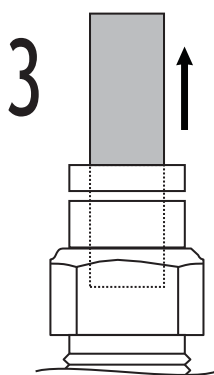

To remove, push down collar and gently pull Air Line Tube away.

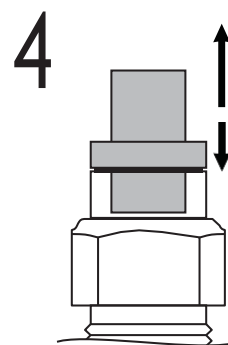

**Removal Tip:** Use a small open-ended wrench to push the collar down .

**Always:**

Select routes protected from heat, debris, and sharp edges. Use Nylon Ties to secure the Air Line Tube.

**Do Not:**

Bend or sharply curve Air Line Tubes. Leave Air Line Tube exposed to sharp edges. Use unnecessary lengths of Air Line Tube. Route Air Line Tube near moving parts. Let Air Line tube hang unsecured from vehicle. Scar Air Line Tube while routing.



IMPORTANT INFORMATION- BILL OF MATERIALS

0

Instructional BOM		<b>22-0318</b>
<b>Part #</b>	<b>QTY</b>	<b>Description</b>
<b>22-0318</b>		<b>Complete Install kit</b>
01-112	2	3/8 X 1/4 NPT 90 degrees Swivel for ADS
03-525	1	Raptor ARB Bed Mount
04-110	1	ARB Wiring Extension
05-120	4	Spacers for ARB Mount
05-126	1	3/8 Flat Washer
05-132	4	M6-1.2 X 25 MM Bolt
05-135	1	3/8 -24X1.75" Hex Head Bolt
02-113-620	1	3/8 Black High Temp Tubing 620 CM

**Start here for Kit Number— 20-0318, 20-0218, 22-0219**

**For Kit Number— 20-118 Go to Section #2 Pg 9.**

Using the Bill of Materials identify and lay out all your kit components confirming that you have all the correct parts and quantity.

1. Locate ARB Compressor Assembly and Bracketry.



2. Install T Nut (03-525-1) and 3/8-24 Bolt with washer into ARB Compressor Bed Mount (03-525). Leave Bolt and Nut loose to allow room to slide into bed Cleat with compressor assembly.

3. Locate The M6 Hardware and Spacers (05-120) to attach the Bed Mount (03-525) to the ARB compressor. Use a Thread Locker to prevent the hardware from vibrating loose during use.

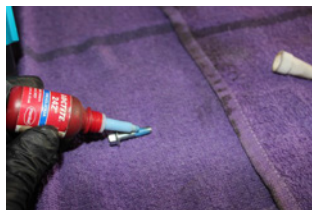

4. Install 90 Degree fitting into The ARB compressor assembly.



5. Locate the wiring harness for the ARB Compressor and Harness Extension. Connect the wires together to create one long loom.

6. Locate the High Temp 3/8 OD Air line. (02-113-620) 244 inches long. Set line aside with wiring loom for install.

7. Locate the Bed Cleat on the Passenger Side of the bed closest to the cab.

8. Remove the Bed Cleat and rotate it 180 degrees so the large opening is on the top  
Reinstall bed Cleat.

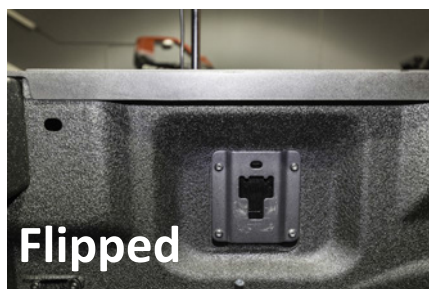



1. With the bed Cleat reinstalled we can slip the Compressor assembly into the cleat. Make sure the T Nut (03-525-1) has enough room to side into the cleat.



2. Tighten the 3/8 bolt for the Compressor Mount. It may be necessary to slightly rotate the compressor assembly to fit the wrench under the bed rail. The compressor should be level to the bed rail when fully tightened.
3. Remove the Oval Dust Cap in the lower Corner of the Bed on the passenger side. There are several tabs on the back of the dust cover that need to be compressed to release the Dust cover.

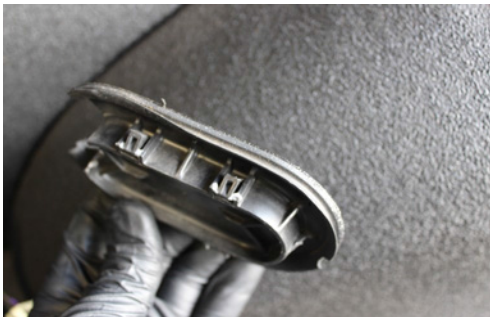

4. Notch the Dust Cover to allow the Power Cables and Feed Line for the compressor to pass through the Dust Cover.
5. Run the Power cables and 3/8 High Temp Air Line (02-113-620) (244 inches Long) through the bed. The lines should extend approx. 24".
6. Re install Dust Cover.
7. Connect the power cables to the Compressor Assembly.

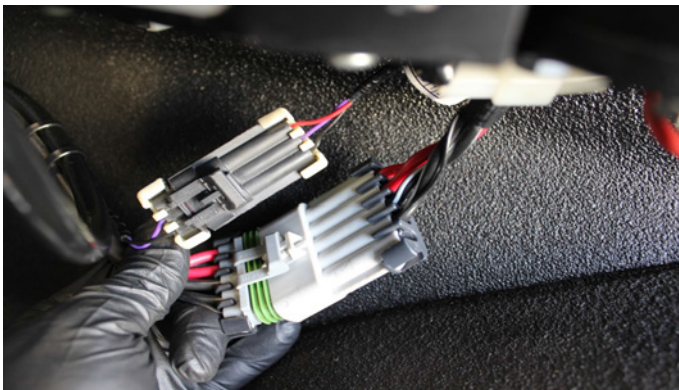

8. Connect the Hi Temp 3/8 Airline to the 90 Degree fitting on the Compressor.

9. We recommend using zip ties to loom the Power cables and High Temp 3/8 Airline together.

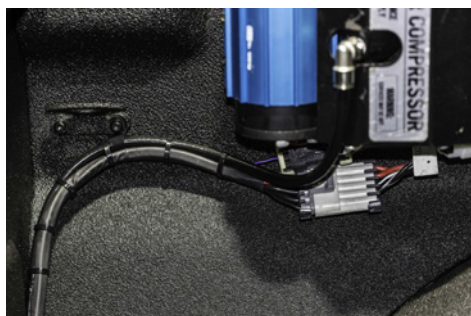

10. With the Compressor assembly and Lines bundled in the bed we can move on to routing the power cables. Feed them along the frame rail above the Body Mounts.



11. Once they reach the Passenger Fender well they will run up the back side of the fender to the engine compartment near the battery and ECU.



12. The 3/8 Airline will continue along the windshield cowling until it reaches the Master cylinder. Then it will be ran to the front corner of the engine compartment near the driver side head light where it will connect to the ADS Controller assembly.





13. The Main power (Red) wires for the ARB compressor will attach to the Positive terminal on the Battery.



14. The Negative (Black) wires for the Compressor and Relay will attach to the existing ground just below the Gas shock for the Hood. Use supplied Negative wire extension ( Spade to Eyelet) for the On/ Off Relay.



15. Locate the Wire Loom for the Raptor Up fitter/ Axillary Switches located just below the ECU on the firewall. (Depending on your current accessories you will need to choose an AUX Switch to Power your ARB Compressor.) We recommend referencing your Raptors owners manual for more detailed information on the Auxiliary/ Up fitter Switches. Once you have chosen the switch and corresponding wire for that switch you can connect it to the **Purple** Relay wire. This will turn the compressor on/off with the AUX Switch you have chosen. The Green and Yellow wires are not used at this time.

16. With the power Relay/ Switch connected the installation of the ARB Compressor is Complete. We recommend using zip ties to secure any and all power cables/ hose's to prevent damage.





**Congratulations** you have now completed the install of your new ARB Compressor Kit for your ADS System.

Please preform the following tests.

1. Turn compressor on to pressurize the ADS unit and set your pressure regulator to your factory recommended tire setting.
2. The compressor should stop when the ADS is fully pressurized. When the compressor stops listen and inspect all connections for leaks.
3. If you think you have a leak spray mild soapy water at the fitting and look for bubbles.

Let your system sit for two minutes and note the tire pressure and compare it to your starting pressure.

If you have had no pressure drop you are good to go.

### PROPER AND IMPROPER CUTS IN THE AIR LINE TUBE

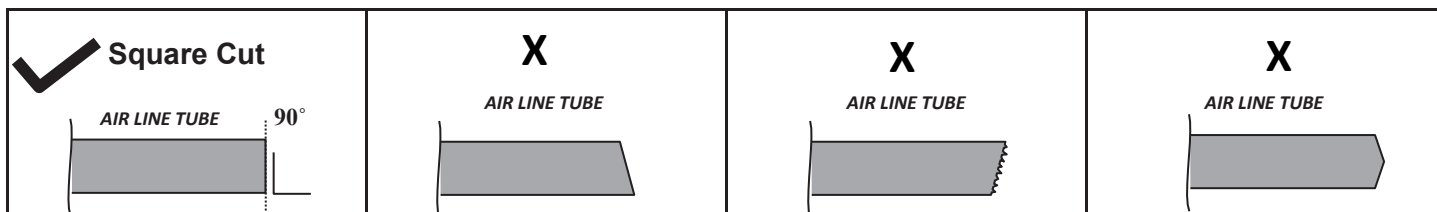

Insert end of Air Line Tube into Air Fitting.

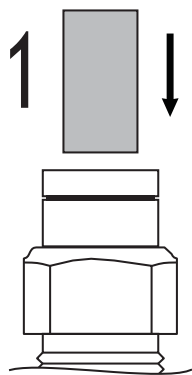

Push Air Line Tube into Air Fitting as far as possible.

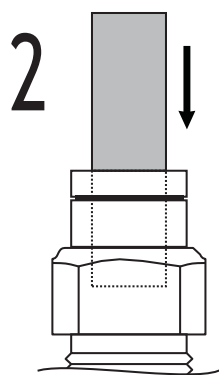

Gently pull on the Air Line Tube to check for a secure fit.

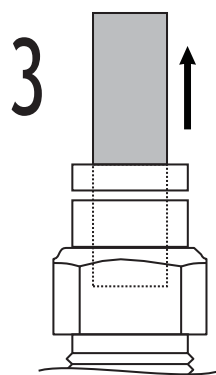

To remove, push down collar and gently pull Air Line Tube away.

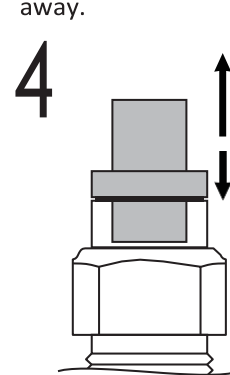

**Removal Tip:** Use a small open-ended wrench to push the collar down .