

# MINI LIGHTHEAD Manual

## Surface Mount

To + VDC (fuse @ 2A): .....**RED**

To Chassis Ground: .....**BLACK**

For Synchronization: .....**YELLOW**

Connect **YELLOW** wires of all heads together for synchronization  
(All heads must be set at the same pattern)

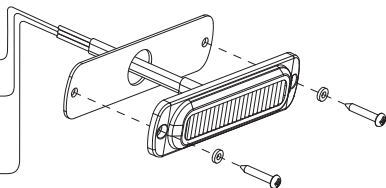

### For Simultaneous or Alternating Flash:

1. Apply +VDC to **RED** and **YELLOW** wires simultaneously to enter Grouping mode; lighthead will display short (single or double) flashes:
  - Single flash = Group1
  - Double flash = Group2
2. Remove **YELLOW** wire from +VDC and momentarily apply to +VDC to change Groups:
  - Heads in the same Group flash together.
  - Group1 Heads alternate with Group2 Heads.

For Flash Pattern, momentarily apply +VDC to **YELLOW** wire:

- once for next pattern
- quickly three times for reset (see flash pattern chart)

**NOTE:** This unit may not be factory set at Flash Pattern 1.

FP#	Flash Patterns		
1	Random	11	Double (all)
2	Single (split)	12	Quad (all)
3	Double (split)	13	Quint (all)
4	Quad (split)	14	Mega (all)
5	Quint (split)	15	Ultra (all)
6	Mega (split)	16	Single-Quad (all)
7	Ultra (split)	17	Single H/L (all)
8	Single-Quad (split)	18	Steady (half)
9	Single H/L (split)	19	Steady (all)
10	Single (all)		

\*split = Left alternate Right    \*all = Simultaneous