

# WHY TYGER?

## THE QUALITY YOU CAN TRUST.

To ensure the perfect finish of our black bars and for better rust resistance, we focus every procedure during production including E-Coat and the Pre-treatment before the Black Powder coating. Meanwhile, some similar products in the market reduce their costs by ignoring our first two key procedures.

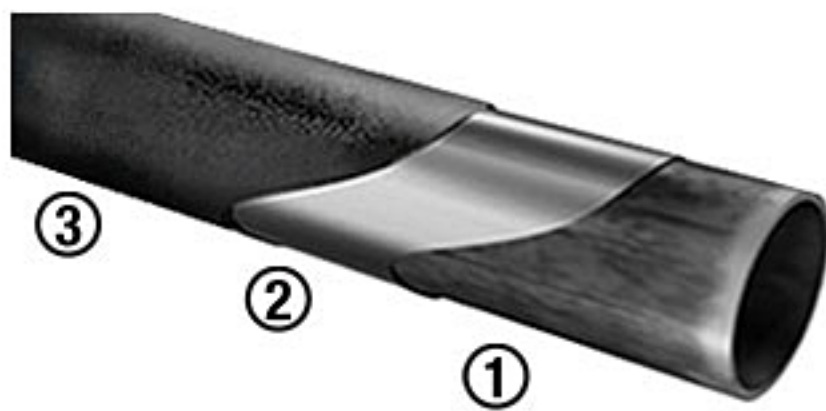

### HOW WE DO IT

- ① Pre-treatment to remove impurities
- ② Special "E-Coat" Inside & Out
- ③ Dual-Stage Matte Black Powder

### E-COAT

**Consistency** - uniform density  
**Durability** - 1000Hrs+ of salt spray resistance  
**Electrodeposition** - uses electrical current to deposit the paint

### PRE-TREATMENT

**Phosphate**- a smoother & stable surface  
**Acid Washing** - removes rust  
**Oil Degreasing** - rust and corrosion resistance.

## RESULTS WITHOUT PRE-TREATMENT AND E-COAT



Paint bubbles



Rust dust



**Only fit on Extended Cab / Double Cab  
as the circled one!**

**Chevy/GMC truck Cab Details**

**Regular Cab**



*(2 Doors only)*

**Important: Before ordering, please check with your dealer  
to make sure your truck is with Extended Cab or Double Cab,  
NOT Crew Cab.**

**On/Before 2013  
Extended Cab**



*(2 Full-Size Front Doors & 2 Suicided Rear Doors)*

**2014 - Up  
Double Cab**



*(2 Full-Size Front Doors & 2 Narrower Rear Doors)*

**Crew Cab**



*(4 Full-Size Doors)*



# For 2017 Diesel Model w/ DEF Tank only

—TRIMMING REQUIRED—



1 Remove the DEF tank cover by taking out 4 of the Hex bolts.



2 Hold the DEF cover in place and mark the passenger side 2nd bracket mounting location onto the cover.

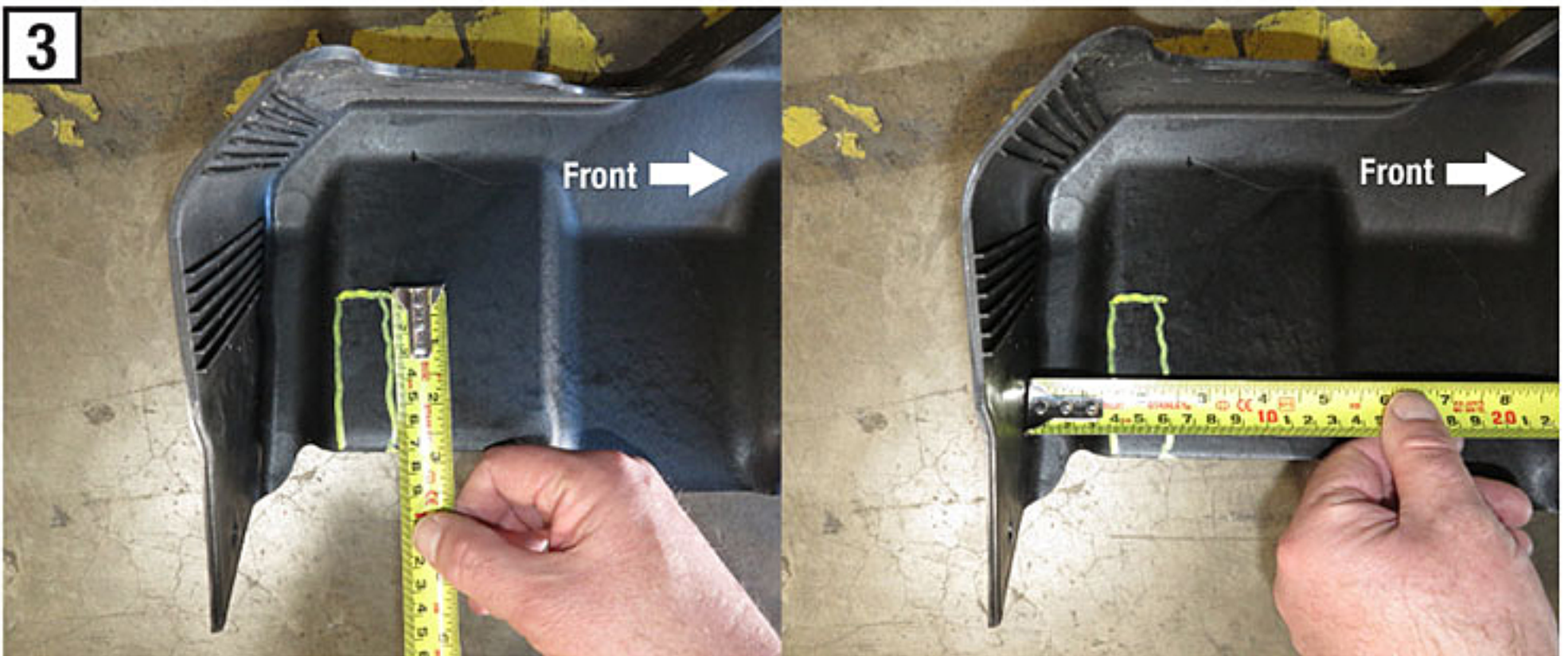

3 Use a sharp knife to trim a slot along the marking as little plastic as possible. Re-install the DEF tank cover and install the bracket.