

WHY TYGER?

THE QUALITY YOU CAN TRUST.

To ensure perfect quality for our stainless steel bars, we only use marine grade #304 stainless steel for the highest standard of rust and corrosion resistance. Meanwhile, some similar products in the market reduce their costs by using lower grade “stainless” materials like #201.

RESULTS AFTER SALT SPRAY ANTI-RUST TESTING



96 Hours on #304



64 Hours on #201

RESULTS AFTER 3 MONTHS OF DRIVING IN SNOW CONDITIONS



Marine Grade



Cheaper “Stainless”

**Only fit on Extended Cab / Double Cab
as the circled one!**

Chevy/GMC truck Cab Details

Regular Cab



(2 Doors only)

Important: Before ordering, please check with your dealer to make sure your truck is with Extended Cab or Double Cab, NOT Crew Cab.

**On/Before 2013
Extended Cab**



(2 Full-Size Front Doors & 2 Suicided Rear Doors)

**2014 - Up
Double Cab**



(2 Full-Size Front Doors & 2 Narrower Rear Doors)

Crew Cab



(4 Full-Size Doors)

For 2017 Diesel Model w/ DEF Tank only

—TRIMMING REQUIRED—



1 Remove the DEF tank cover by taking out 4 of the Hex bolts.



2 Hold the DEF cover in place and mark the passenger side 2nd bracket mounting location onto the cover.

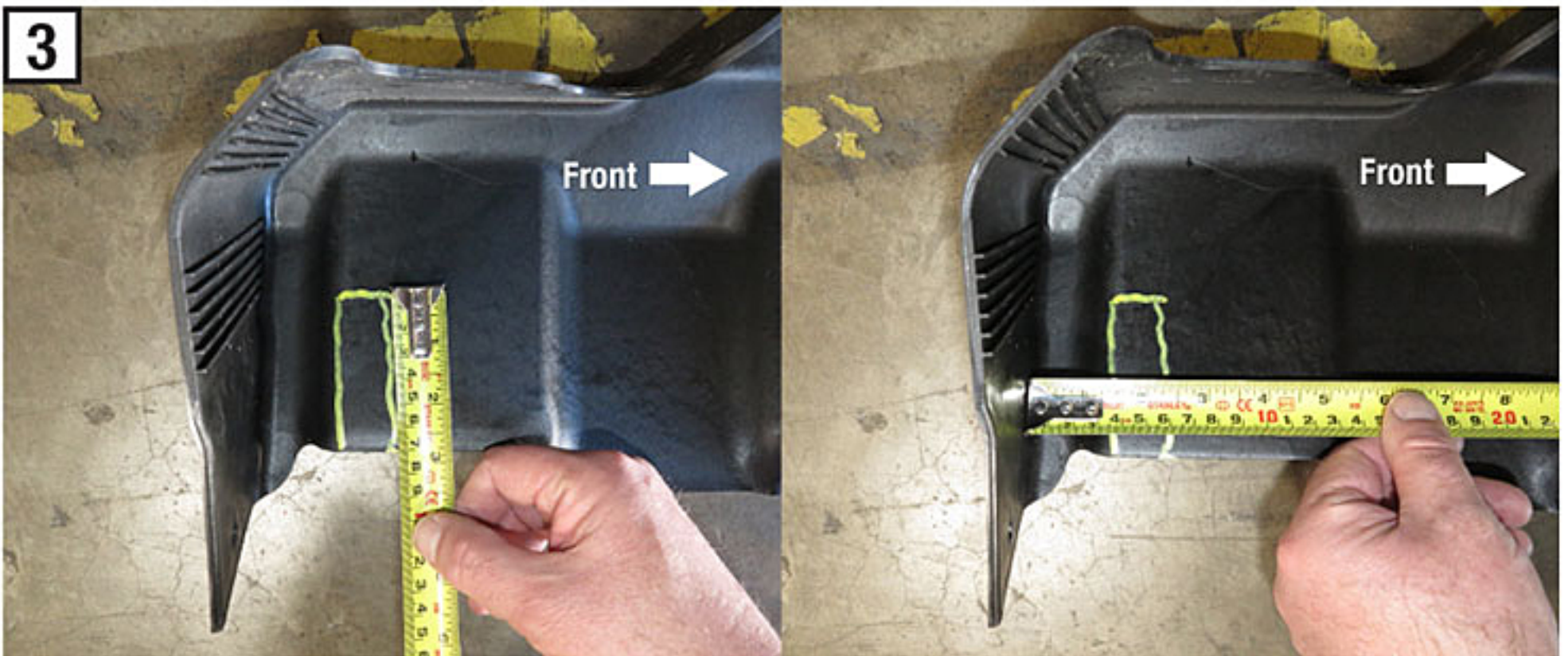

3 Use a sharp knife to trim a slot along the marking as little plastic as possible. Re-install the DEF tank cover and install the bracket.