



TYGER LANDER®

TG-LD2T60148

BEFORE INSTALLATION

READ INSTRUCTIONS CAREFULLY BEFORE STARTING INSTALLATION. REMOVE CONTENTS FROM BOX AND VERIFY ALL PARTS ARE PRESENT. FAILURE TO IDENTIFY DAMAGE BEFORE INSTALLATION COULD LEAD TO A REJECTION OF ANY CLAIM. IF MISSING PARTS OR ANY DAMAGE FOUND, PLEASE TAKE A PICTURE FOR THE CLAIM PURPOSE.

TORQUE VALUES

Fastener Size	Class 8.8 Torque (ft-lbs)	Class 10.9 Torque (ft-lbs)
6mm	6-7	6-7
8mm	15-16	22-23
10mm	31-32	44-45
12mm	54-55	78-79
14mm	87-88	125-126

Parts List

- x1** Driver/Left Tyger Lander
- x1** Passenger/Right Tyger Lander
- x1** Driver/Left Front Mounting Bracket
- x1** Passenger/Right Front mounting Bracket
- x1** Driver/Left Center Mounting Bracket
- x1** Passenger/Right Center Mounting Bracket
- x1** Driver/Left Rear Mounting Bracket
- x1** Passenger/Right Rear Mounting Bracket
- x12** 10-1.5mm x 35mm Hex Bolts
- x24** 10mm x 27mm OD x 3mm Flat Washers
- x12** 10mm Nylon Lock Nuts
- x12** 8-1.25mm x 30mm Hex Bolts
- x12** 8mm Lock Washers
- x12** 8mm x 24mm OD x 2mm Flat Washers

Passenger/Right Rear Mounting Bracket

Passenger/Right Center Mounting Bracket

Driver/Left Rear Mounting Bracket

Driver/Left Rear Mounting Bracket

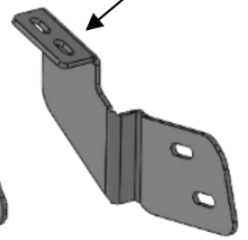
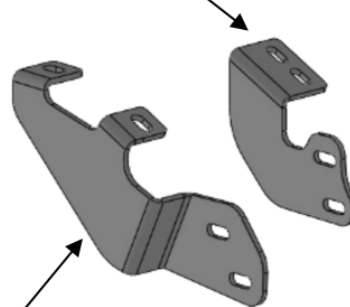
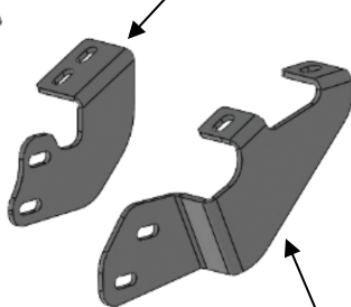
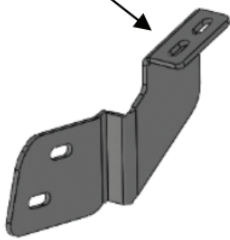

Passenger/Right Tyger Lander

Passenger/Right Driver/Left Front Front Mounting Mounting Brackets Bracket

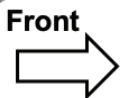
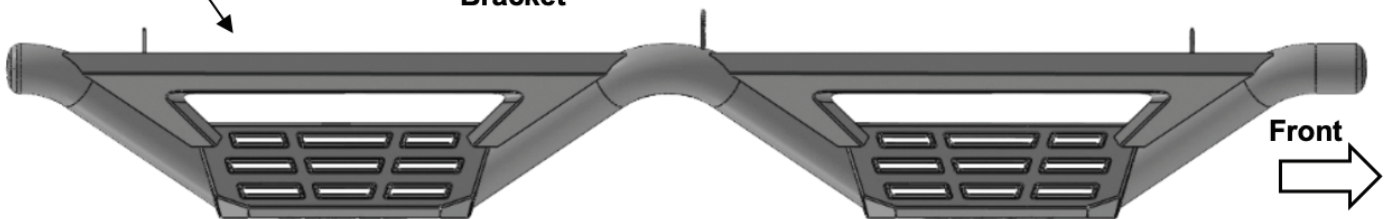



STEP 1

REMOVE CONTENTS FROM BOX. VERIFY ALL PARTS ARE PRESENT. READ INSTRUCTIONS CAREFULLY. ASSISTANCE IS HIGHLY RECOMMENDED.

STEP 2

Starting on the Passenger/Right side of the vehicle, remove the plastic plugs or hex bolts from the factory mounting locations along the bottom of the body (Figs 1, 3 & 5).

Passenger/Right Side Installation Pictured

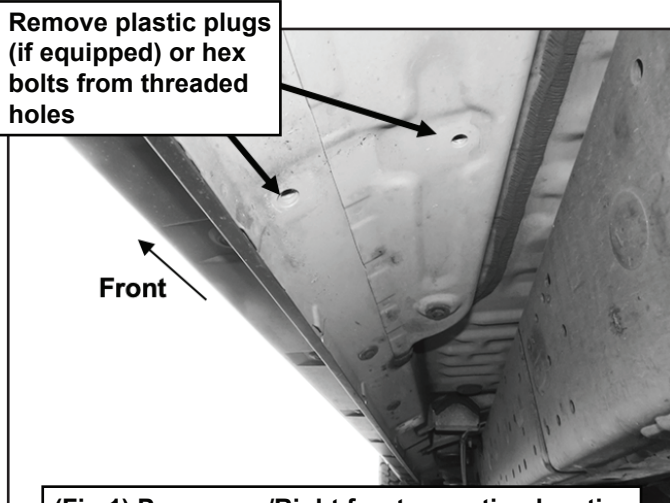

(Fig 1) Passenger/Right front mounting location

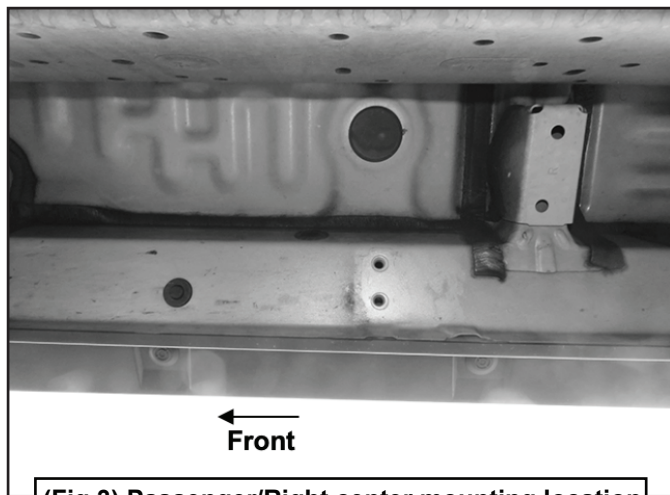

(Fig 3) Passenger/Right center mounting location

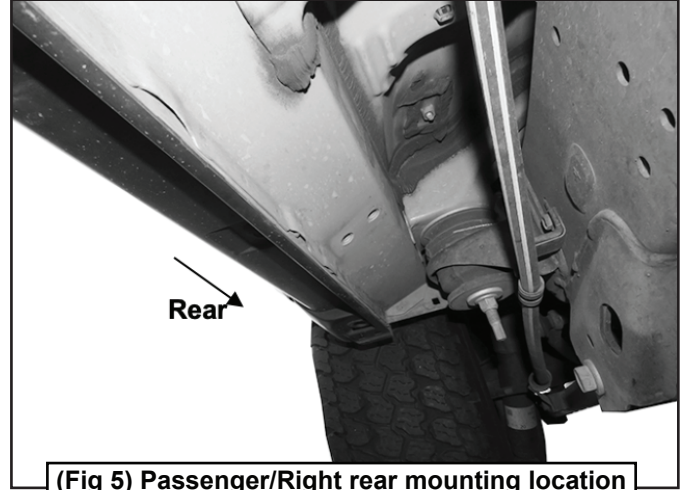

(Fig 5) Passenger/Right rear mounting location

STEP 3

Select the Passenger/Right Front Mounting Bracket. Attach the Bracket to the front mounting location with (2) 8mm Hex Bolts, (2) 8mm Lock Washers and (2) 8mm Flat Washers (Figs 1 & 2). DO NOT tighten hardware at this time.

Passenger/Right Side Installation Pictured

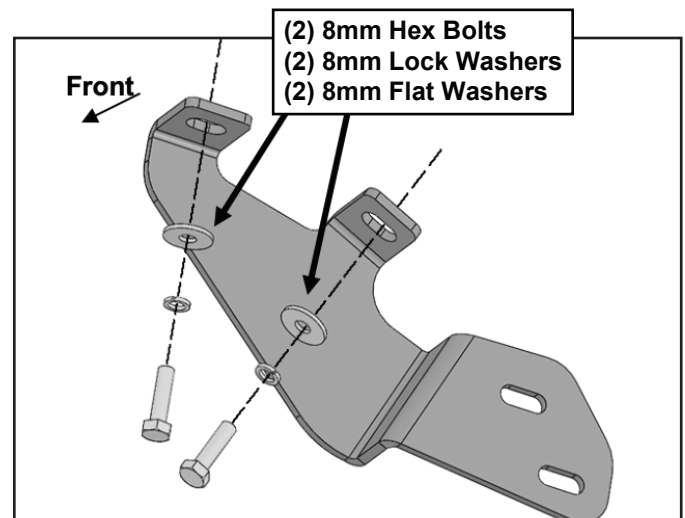

(Fig 2) Attach the Passenger/Right Front Mounting Bracket to the front location



STEP 4

Select (1) Passenger/Right Center Mounting Bracket. Attach the Bracket to the center location with (2) 8mm Hex Bolts, (2) 8mm Lock Washers and (2) 8mm Flat Washers (Figs 3 & 4). DO NOT tighten hardware at this time.

Passenger/Right Side Installation Pictured

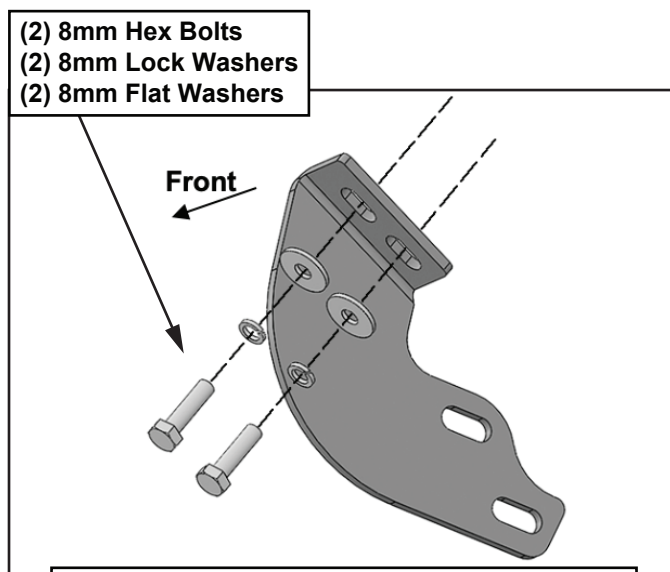

(Fig 4) Attach (1) Passenger/Right Center/Rear Mounting Bracket to the center location

STEP 5

Repeat **STEP 4** to attach the remaining the Passenger/Right Rear Mounting Bracket to the rear location (Fig 5). DO NOT tighten hardware at this time.

STEP 6

Select the Passenger/Right Tyger Lander. Attach the Tyger Lander to the rear faces of the Mounting Brackets with (6) 10mm Hex Bolts, (12) 10mm Flat Washers and (6) 10mm Nylon Lock Nuts, (Fig 6). DO NOT tighten hardware at this time.

Passenger/Right Side Installation Pictured

(2) 10mm Hex Bolts
(4) 10mm Flat Washers
(2) 10mm Nylon Lock Nuts

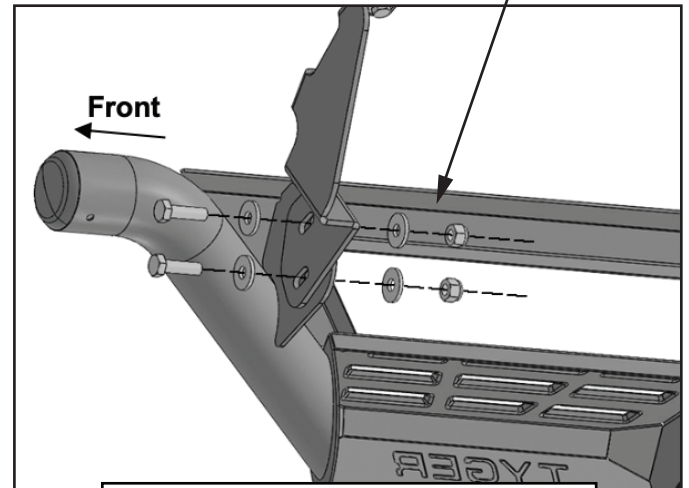

(Fig 6) Attach the Running Board to the front face of the Mounting Brackets

STEP 7

Level and adjust as necessary and tighten all hardware.

STEP 8

Repeat **STEPS 2-7** to attach the Driver/Left Tyger Lander.

STEP 9

Do periodic inspections to the installation to make sure that all hardware is secure and tight.

ATTENTIONS: To protect your investment, DO NOT use any type of polish or wax that may contain abrasives that could damage the finish. Mild soap may be used to clean the Tyger Lander.