



TYGER®

TYGER GUARD™

BEFORE INSTALLATION

READ INSTRUCTIONS CAREFULLY BEFORE STARTING INSTALLATION. REMOVE CONTENTS FROM BOX AND VERIFY ALL PARTS ARE PRESENT. ASSISTANCE IS RECOMMENDED. CUTTING IS REQUIRED. FAILURE TO IDENTIFY DAMAGE BEFORE INSTALLATION COULD LEAD TO A REJECTION OF ANY CLAIM. IF ANY DAMAGE FOUND, PLEASE TAKE A PICTURE FOR THE CLAIM PURPOSE.

WARNING

TEXTURED COATED FINISHES SHOULD BE CLEANED WITH A MILD SOAP ON A DAMP SPONGE. DO NOT APPLY POLISH OR WAX THAT REQUIRES TO BE REMOVED BY MEANS OF BUFFING. THIS TYPE OF WAX IS COMMONLY USED AT CAR WASH FACILITIES.

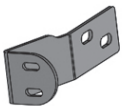

Passenger/right Side Tyger Bracket

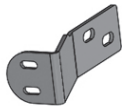

Driver/left Side Tyger Bracket

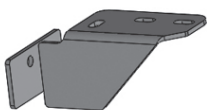

Passenger/right Side Mounting Bracket

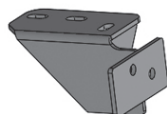

Driver/left Side Mounting Bracket

TG-GD6H60398

Parts List

- x1** Tyger Guard
- x1** Driver/left Side Tyger Bracket
- x1** Passenger/right Side Tyger Bracket
- x1** Driver/left Side Mounting Bracket
- x1** Passenger/right Side Mounting Bracket
- x4** 12-1.75mm x 35mm Hex Bolts
- x4** 12-1.25mm x 35mm "Fine Thread" Hex Bolts
- x12** 12mm x 24mm x 2.5mm Flat Washers
- x4** 12mm Lock Washers
- x4** 12-1.5mm Nylon Lock Nuts
- x1** 10-1.25mm x 35mm "Fine Thread" Hex Bolt
- x1** 10mm Lock Washer
- x1** 10mm Flat Washer
- x4** 8-1.25mm x 35mm Hex Bolts
- x4** 8mm Lock Washers
- x4** 8mm x 22mm x 2mm Flat Washers
- x2** 6mm Combo Bolts
- x1** Allen Wrench



STEP 1

Remove the plastic splash guard under the front bumper.

NOTE: There may be several two-piece plastic push-in clips holding the splash guard up to the vehicle. Pry the center pin up with a small flat blade screwdriver to release and remove the entire clip. Once all clips have been removed, place the splash guard on a clean and stable work surface.

STEP 2

Starting at the passenger side front of the vehicle, locate and remove the two 12mm factory bolts securing the factory passenger side frame bracket to the front cross member, (Fig 1). Next, remove the 10mm hex bolt in the crossmember.

If necessary, replace the (2) 12mm factory hex bolts (too short) with:
(2) 12-1.25mm x 35mm Fine Thread Hex Bolts
(2) 12mm Lock Washers
(2) 12mm Flat Washers

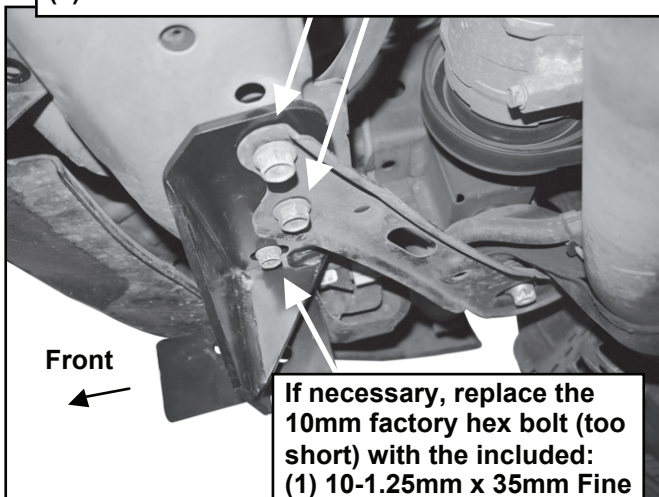

If necessary, replace the 10mm factory hex bolt (too short) with the included:
(1) 10-1.25mm x 35mm Fine Thread Hex Bolt
(1) 10mm Lock Washer
(1) 10mm Flat Washer

(Fig 1) Slide the Passenger side Mounting Bracket between the frame bracket and the frame

STEP 3

Gently pull down on the frame bracket just enough to slide the passenger side Mounting Bracket between the frame bracket and the crossmember, (Fig 2).

NOTE: Do not pull too hard or you may bend the frame bracket. If more room is required to insert the Mounting Bracket, loosen but **DO NOT REMOVE** the large hex bolt securing the frame bracket to the subframe mount, (Fig 2).

Loosen but DO NOT REMOVE the large factory hex bolt securing the frame bracket to the subframe mount

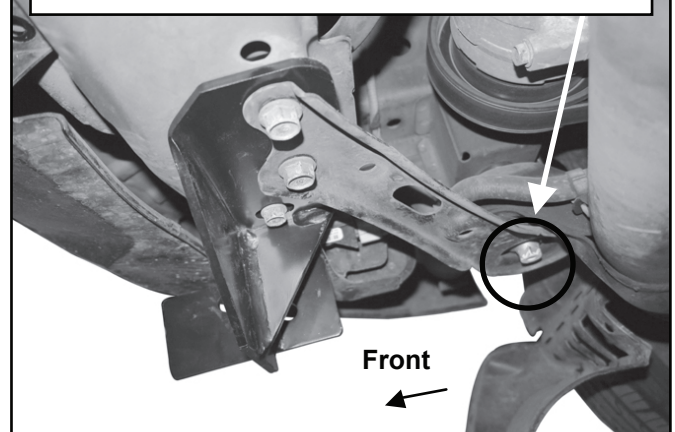

(Fig 2) Slide the Passenger side Mounting Bracket between the frame bracket and the frame

STEP 4

Align the holes in the Mounting Bracket with the holes in the frame bracket. Reuse the (2) 12mm factory hex bolts.

IMPORTANT: On some model years, the factory 12mm hex bolts in the frame bracket are too short to be reused for the Mounting Brackets. If necessary, use the provided (4) 12-1.25mm x 35mm Fine Thread Hex Bolts, (4) 12mm Lock Washers and (4) 12mm Flat Washers to install the driver and passenger side Mounting Brackets. **NOTE:** On some models, the factory 10mm hex bolt in the crossmember is too short to be reused for the Passenger side Mounting Bracket. Use the included (1) 10-1.25mm x 35mm Fine Thread Hex Bolt, (1) 10mm Lock Washer and (1) 10mm Flat Washer to secure the passenger side Bracket to the crossmember, (Fig 1). Do not tighten hardware.



STEP 5

Repeat Steps 2-4 for the driver side Mounting Bracket installation, (Figs 3-4).

IMPORTANT: Reinstall the (3) factory 12mm hex bolts. If necessary, replace the (2) factory hex bolts in the frame bracket with the included (2) 12-1.25mm x 35mm Fine Thread Hex Bolts, (2) 12mm Lock Washers and (2) 12mm Flat Washers as described in Step 4.

If necessary, replace the (2) 12mm factory hex bolts (too short) with:
(2) 12-1.25mm x 35mm Fine Thread Hex Bolts
(2) 12mm Lock Washers
(2) 12mm Flat Washers

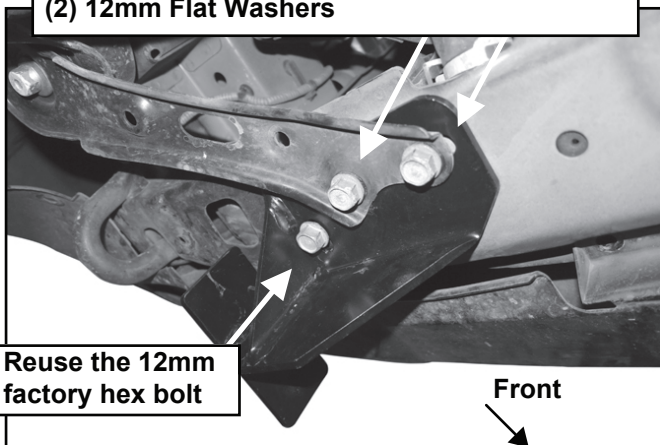

(Fig 3) Driver side Mounting Bracket installed

Loosen but **DO NOT REMOVE** the large factory hex bolt securing the frame bracket to the subframe mount

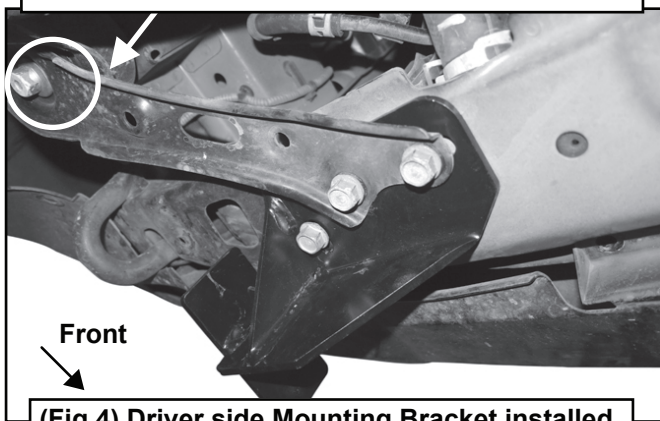

(Fig 4) Driver side Mounting Bracket installed

STEP 6

Attach the Passenger side Tyger Bracket to the Tyger Guard using (2) 8mm Hex Bolts, (2) 8mm Lock Washers and (2) 8mm Flat Washers, (Fig 5). Do not tighten hardware at this time. Repeat this Step for driver side Bracket installation.

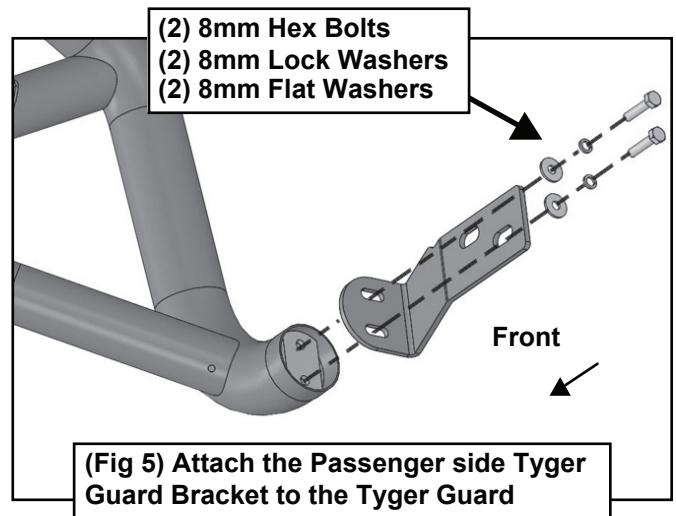

(Fig 5) Attach the Passenger side Tyger Guard Bracket to the Tyger Guard

STEP 7

With assistance, attach the Tyger Guard assembly to the outside of the Mounting Brackets using (4) 12-1.75mm x 35mm Hex Bolts, (8) 12mm Flat Washers and (4) 12mm Nylon Lock Nuts, (Fig 6).

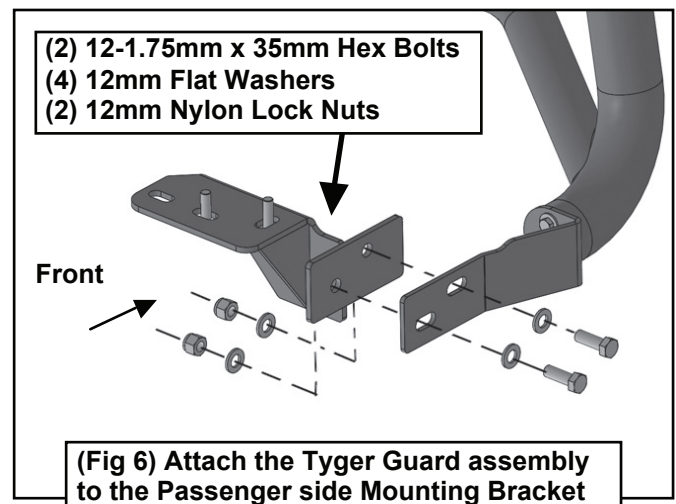

(Fig 6) Attach the Tyger Guard assembly to the Passenger side Mounting Bracket



TYGER®

STEP 8

Hold the splash guard up in position and mark the location of the Brackets onto the inside surface of the splash guard. Make several small cuts to clear Brackets, (Fig 7). Once trimmed, temporarily remove the Tyger Guard with the Tyger Brackets attached. Reinstall the splash guard using the factory hardware. Repeat Step 7 to reinstall the Tyger Guard assembly.

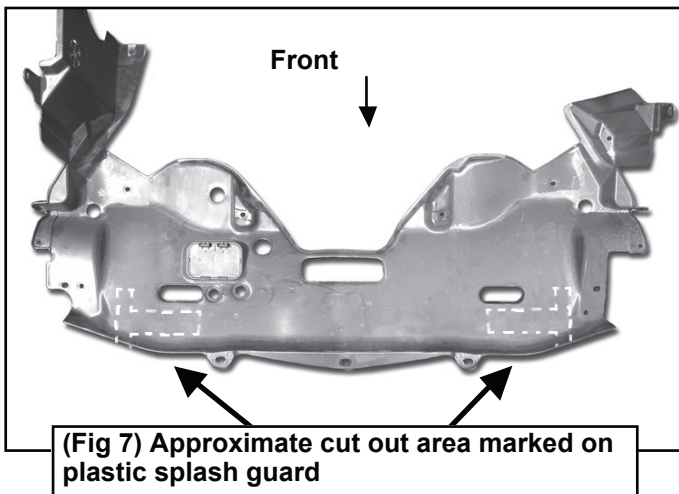

STEP 9

Once the Tyger Guard is fully mounted onto the vehicle, level, adjust and tighten all hardware.

STEP 10

Do periodic inspections to the installation to make sure that all hardware is secure and tight.