



## FENDER FLARE INSTALLATION

TG-FF8D4148: 2009 - UP Ram 1500 Fleetside. (Exclude R/T Models)

### Tools Required

1. #2 Phillips Driver
2. Socket Wrench
3. 8mm Socket
4. 1/2" Wrench
5. Utility Knife



### PRIOR TO INSTALLATION

- **WARNING:** Failure to install according to these instructions will invalidate the warranty. This includes, but is not limited to using alternative installation methods, hardware, or materials. **DO NOT USE:** Loctite, SuperGlue, or similar products on the hardware or the flares.
- **Fit:** Verify the fit of the flares to vehicle. (Some filing, sanding, or cutting may be necessary to ensure proper fit).
- **Painting:** (Optional) if paint is desired it must be done prior to installing flares on vehicle. Clean outer surface with a good grade degreaser. **DO NOT USE LACQUER THINNER OR ENAMEL REDUCER AS A DEGREASER.** Wipe outer surface thoroughly with a tack rag prior to paint. Application of plastic adhesion promoter for ABS plastic as per your paint system manufacturer's recommendations is required. Paint flares using a high quality enamel, or polyurethane automotive paint. If painting edge trim (not recommended), use a flex additive.
- **Performance:** Using larger Tires may increase the area required to turn the vehicle. Some Tire/Rim combinations may require lowering bump stops and or installing steering stops to prevent tire from contacting flare.
- **Exhaust System:** Modifications may be necessary to maintain a minimum 4" clearance between flares and exhaust pipes. (Exhaust gases should not vent directly onto flares)
- **Metal Protection:** All exposed fasteners and bare metal should be treated with rust resistant paint **BEFORE** installing flares. Spray inner fender wells with undercoating **AFTER** flare attachments have been completed.
- **Decals:** Flares may interfere with existing decals on vehicle. If you wish, remove decals prior to installation of flares.

### Hardware Kit Included

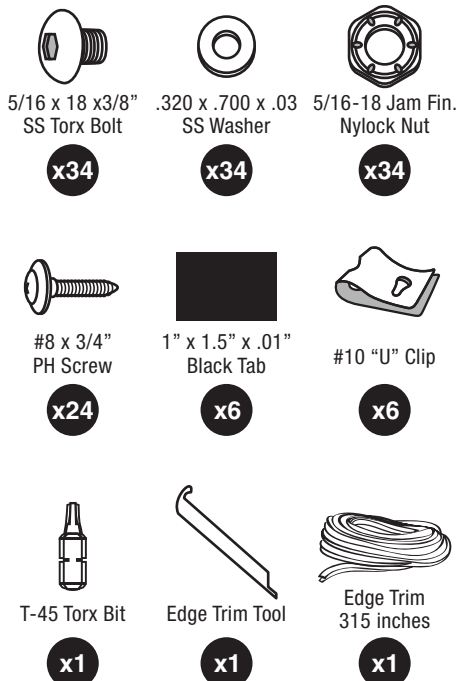



## FENDER FLARE INSTALLATION

TG-FF8D4148

### STEP 1 Edge Trim Installation

A) Peel 2 inches - 3 inches of red vinyl backing away from Edge Trim (  ) tape. Applying the adhesive side of the edge trim to the inner side of the flare, affix the edge trim to the top edge of the flare (the portion that comes in contact with the vehicle).

B) Press edge trim into place along the top edge of the flare in one-foot increments, pulling red vinyl backing free as you continue to work your way around the top edge of the flare.

C) FRONT FLARES ONLY: The edge trim must be cut to prevent bunching and stretching at the forward end of the part where the flare goes along the headlight. Refer to pictures A and B.

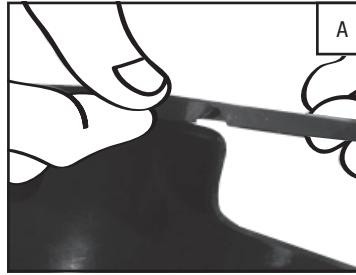

Start at the rearward end of the front flare and work toward the front. At the outward, right angle curve in the flare, cut a V out of the edge trim so when you wrap around the part, the edge trim doesn't bulge.

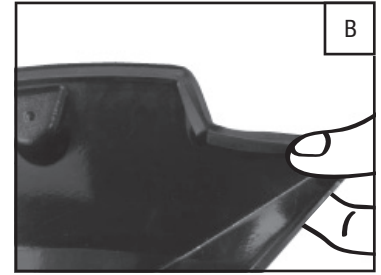

At the inward, right angle curve in the flare, cut a notch in the edge trim so when you along the part, the edge trim doesn't stretch.

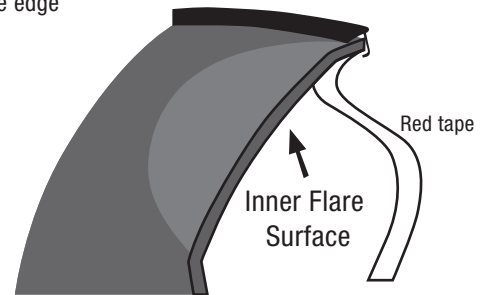

### STEP 2 Passenger Side Front Flare Installation

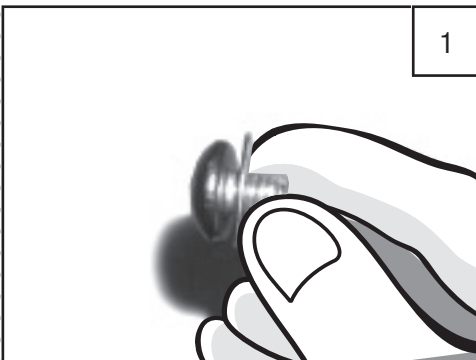

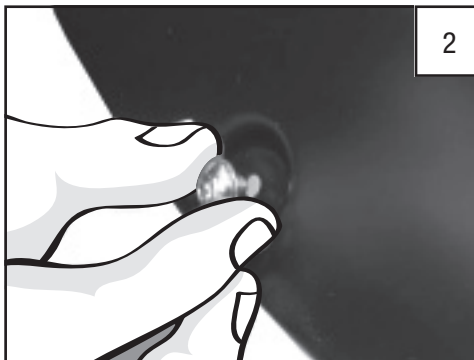

Put a Washer (  ) on each Bolt (  ).



Put them on the holes of the flare accordingly with the bolt and washer head on the outside of the flare.



Put the nuts (  ) on the other end of the bolts and tighten, using a 1/2" wrench for the Nut and the supplied Torx Bit (  ) for the Bolt. Repeat with all the remaining bolts.

**Note: This bolt is for looks only.**



## FENDER FLARE INSTALLATION

TG-FF8D4148



Vehicle may equip either plastic or metal front bumper. It will not affect the installation.



Start by removing three factory installed screws using a 8mm socket wrench.

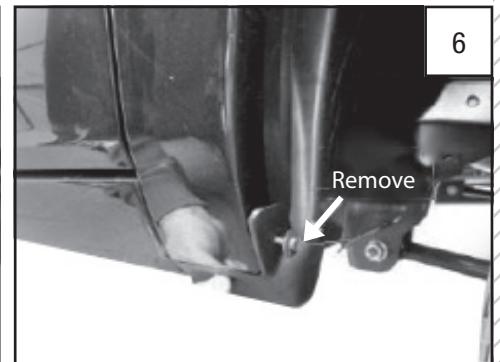

**For 2011-12 Models Only (Optional):** If there is a fitting problem, remove the inner piece located at the bottom rear of wheel well. Use an 8mm socket.



Install #10 "U" Clips (🔗) at these locations. See step 8.



Install two Black Tabs (■) over factory holes. There are two factory holes near the rearward arrow. The correct hole for install is the one on the top.



Install #10 "U" Clip (🔗) over existing factory holes. There are two holes at the top center location. The hole for proper installation is the one on the right. NOTE: The clip may fit over the lip loosely. This can be fixed by pinching the clip more tightly to the vehicle.



## FENDER FLARE INSTALLATION

TG-FF8D4148

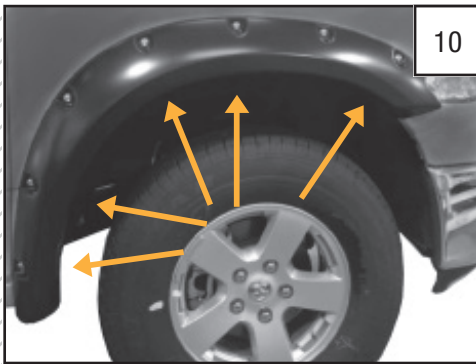

Hold flare to vehicle and install supplied #8 x 3/4" Screw (🔩) with a Phillips screwdriver. Do not tighten.

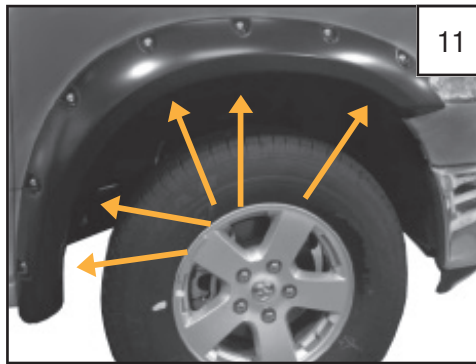

Press firmly on flare and tighten all screws.



Completed front flare installation.

### STEP 3

### Passenger Side Rear Flare Installation

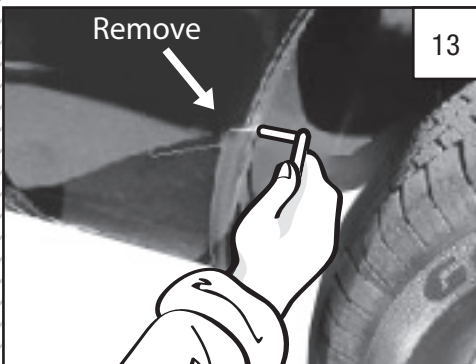

**For 2012 Models Only (Optional):** If there is a fitting problem, remove the inner piece at bottom rear and front of wheel well.

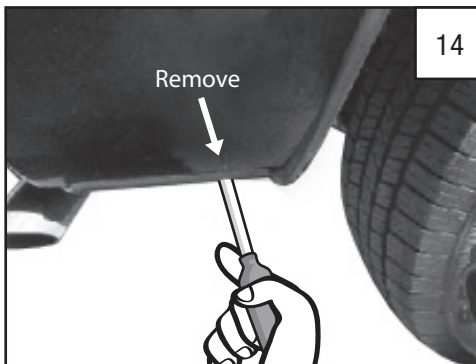

**2012 Models Only (Optional):** Remove inner piece at bottom rear of wheel well by using a pry tool.

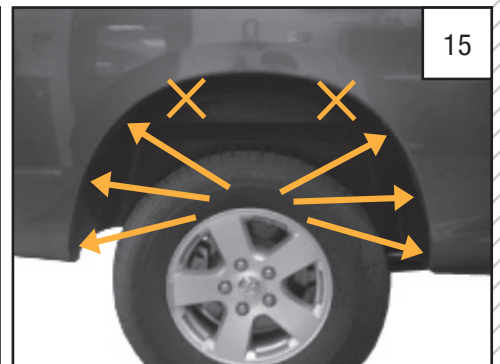

Remove these six factory installed screws by using an 8mm socket wrench. Do not remove the one marked with "X".



## FENDER FLARE INSTALLATION

TG-FF8D4148



16

Install #10 "U" Clip (🔗) in this location. See step 18.



17

Install plastic tab over existing factory hole. There is two holes and it's the one on the right.



18

Install #10 "U" Clip (🔗) over existing hole.

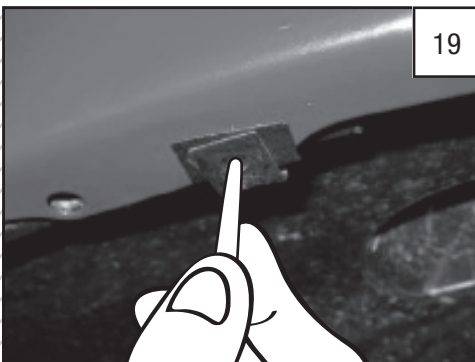

19

Using an awl or similar pointed tool, then poke a hole through plastic tab by using the speed clip hole as a guide.



20

Start #8 x 3/4" Screw (🔩) by using a Phillips Head Screwdriver. Do not tighten.



21

Hold flare in place start six supplied screws by using an Phillips Head Screwdriver. Do not tighten.



# TYGER®

## FENDER FLARE INSTALLATION

TG-FF8D4148

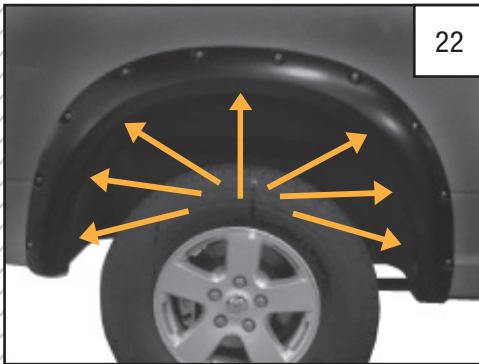

22  
Press firmly on flare and tighten all screws.



23  
Completed rear flare installation.

### STEP 4 Edge Trim Tool Procedures

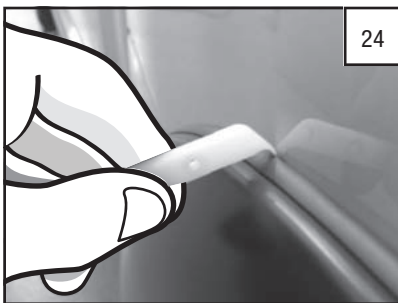

24  
Using the Edge Trim Tool (↘) to seat edge trim against vehicle by hooking curved end under edge trim at one end of flare. Next, slide around outer edge of flare to the other end.

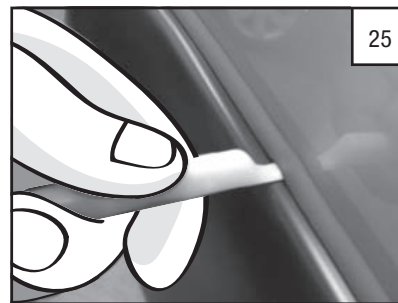

25  
Using flat end of Edge Trim Tool, seat edge trim against flare by inserting straight end between edge trim and flare at one end. Next, slide around entire edge to the other end.

### STEP 5 Driver Side Installation

Repeat Step 1-4 Passenger Side Installation.