



REAR BUMPER

TG-BP9J81198

BEFORE INSTALLATION

READ INSTRUCTIONS CAREFULLY BEFORE STARTING INSTALLATION. REMOVE CONTENTS FROM BOX AND VERIFY ALL PARTS ARE PRESENT. FAILURE TO IDENTIFY DAMAGE BEFORE INSTALLATION COULD LEAD TO A REJECTION OF ANY CLAIM. IF MISSING PARTS OR ANY DAMAGE FOUND, PLEASE TAKE A PICTURE FOR THE CLAIM PURPOSE.

TORQUE VALUES

Fastener Size	Class 8.8 Torque (ft-lbs)	Class 10.9 Torque (ft-lbs)
6mm	6-7	6-7
8mm	15-16	22-23
10mm	31-32	44-45
12mm	54-55	78-79
14mm	87-88	125-126

Parts List

- x1 Tyger Rear Bumper
- x1 License Plate Bracket
- x1 License Plate Bracket Base Seal
- x1 License Plate Light
- x2 Plastic Plugs
- x4 Sensor Retaining Clips
- x4 Sensor Foam Spacer
- x4 Sensor Sealing Washers
- x1 Sensor Cover Kit
- x1 14-1.50mm Fine Thread Double Nut Plate
- x2 14-1.50mm x 55mm Fine Thread Hex Bolts
- x2 14mm x 28mm x 3mm Flat Washers
- x2 14mm Lock Washers
- x2 8mm x 25mm Button Head Bolts
- x4 8mm x 16mm x 1.6mm Flat Washers
- x2 8mm Nylon Lock Nuts
- x8 4mm x 10mm Button Head Bolts
- x1 5mm Wrench
- x1 4mm Wrench
- x1 2.5mm Wrench

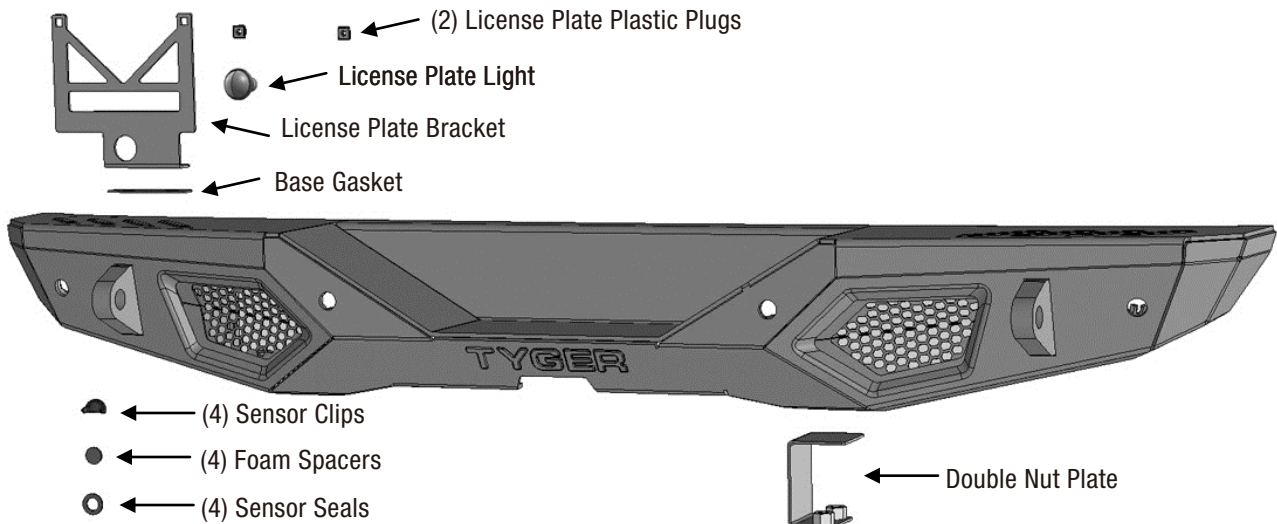



PROCEDURE:

REMOVE CONTENTS FROM BOX. VERIFY ALL PARTS ARE PRESENT. READ INSTRUCTIONS CAREFULLY BEFORE STARTING INSTALLATION. WARNING: ALLOW TIME FOR THE MUFFLER TO COMPLETELY COOL BEFORE REMOVING REAR BUMPER.

STEP 1

Start installation from under the driver/left side of the rear bumper. Remove the plastic cover from the back of the rear wheel opening, (Figure 1). Locate and remove the (2) hex bolts attaching the outer bracket running from the side of the frame to the outer end of the bumper, (Figure 2). Remove the (2) hex bolts attaching the bottom of the bumper to the rear crossmember if equipped, (Figure 3). Repeat this Step on the passenger/right side of the vehicle.

STEP 2

Unplug the wiring harness leading to the rear bumper.

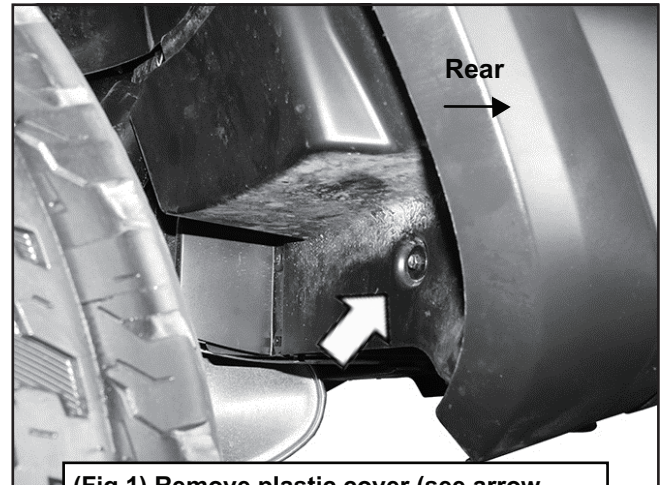

(Fig 1) Remove plastic cover (see arrow-driver/left side pictured)

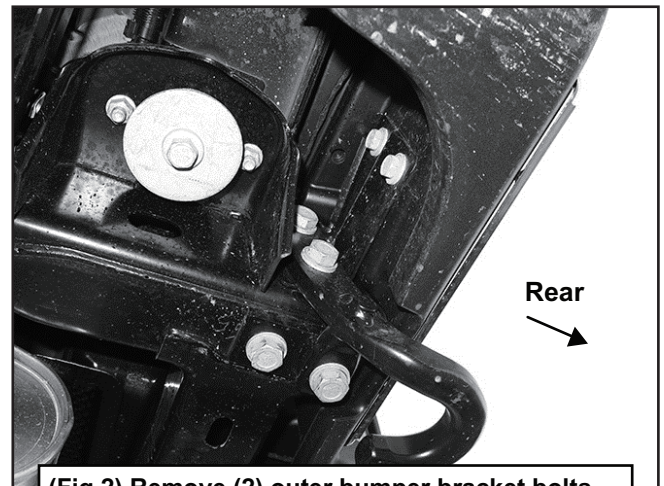

(Fig 2) Remove (2) outer bumper bracket bolts

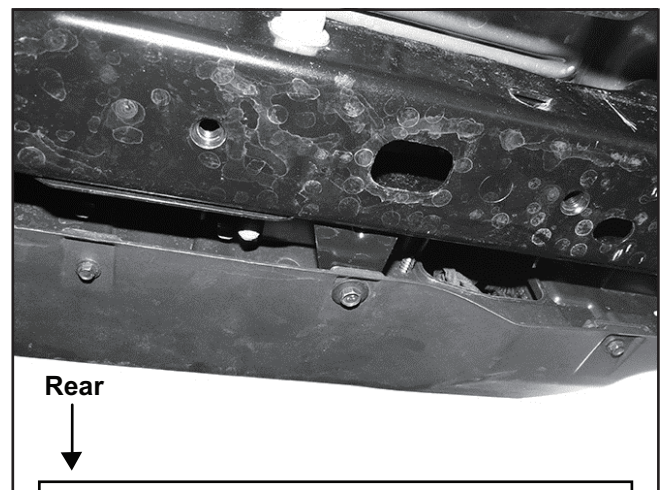

(Fig 3) Remove (2) hex bolts attaching bottom of bumper to frame cross member



STEP 3

With assistance, remove the (4) hex nuts attaching the bumper to the inner bumper brackets, (Figure 4). Slide bumper off of the inner and outer bumper brackets.

STEP 4

Remove the driver/left outer bumper bracket attached to the side of the frame, (Figure 4). Next, remove the (2) hex bolts attaching the tow hook to the side of the frame and remove the inner bumper bracket, (Figure 5). NOTE: It may be necessary to loosen the (2) bolts attaching the tow hook to the bottom of the frame to remove the bumper bracket.

STEP 5

Repeat Step 4 to remove the Passenger/right side bumper brackets.

STEP 6

Insert the Double Nut Plate into the open end of the frame. Line up the Nut Plate with the holes in the bottom of the frame, (Figure 6).

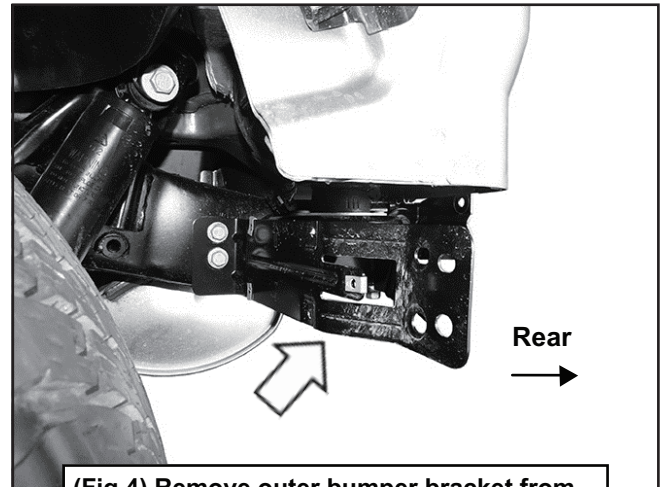

(Fig 4) Remove outer bumper bracket from side of frame



(Fig 5) Remove tow hook and inner bumper bracket from side of frame

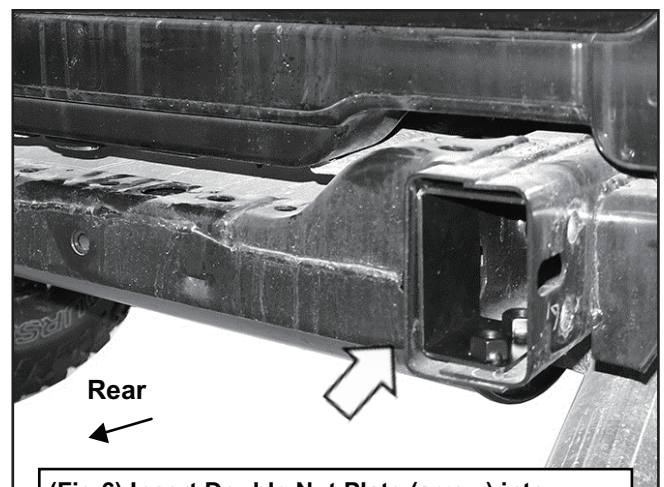

(Fig 6) Insert Double Nut Plate (arrow) into passenger/right end of frame



STEP 7

Determine if accessory lights will be installed. Remove screens covering light openings and install lights, (available separately), before installing Bumper, (Figure 7).

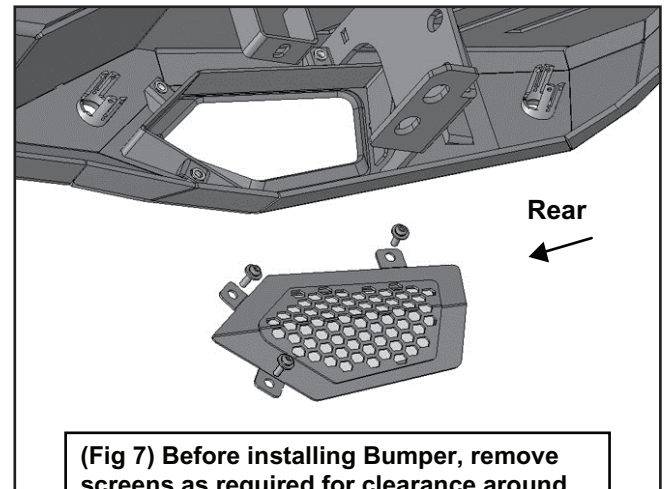

(Fig 7) Before installing Bumper, remove screens as required for clearance around lights (not included)

STEP 8

Determine if the vehicle is equipped with bumper mounted sensors. NOTE: Depending on tow package, it may be necessary or easier to install sensors, (if equipped), and harness before installing the Bumper.

Models with bumper mounted sensors:

- Disassemble the factory bumper to remove the wiring harness and sensors.
- Select (1) sensor. Remove the seal from the end of the sensor. Slide the included flat Sensor Seal Washer over front of the sensor, (Figure 8).
- Insert the sensor with Seal into sensor mount, (Figure 9).
- Place Foam Spacer over end of the sensor. Push Sensor Retaining Clip into sensor mount and lock into mounting holes, (Figure 9).
- Repeat previous Steps to install remaining sensors.
- Install wiring harness for sensors and plug harness into sensors.

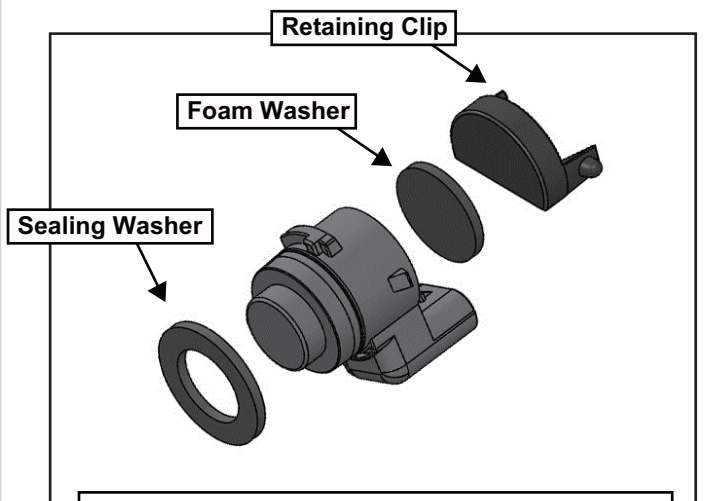

(Fig 8) Remove factory seal and push Flat Sealing Washer onto end of sensor

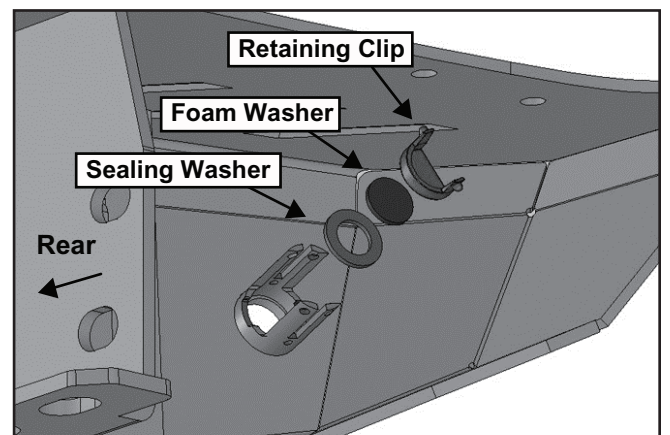

(Fig 9) Push sensor with Sealing Washer into sleeve



STEP 9

With assistance, carefully position the Rear Bumper up to the outside of the frame. Attach the Bumper to the Nut Plate in the passenger/right frame end with the included (2) 14mm Fine Thread Hex Bolts, (2) 14mm Lock Washers and (2) 14mm Flat Washers, (Figures 10 & 11). Reuse the (2) factory hex bolts to attach the Bumper to the threaded inserts in the side of the frame. Reuse (4) factory hex bolts to attach the driver/left side of the Bumper to the frame, (Figures 12 & 13). Do not tighten hardware.

STEP 10

Level and adjust the Rear Bumper and tighten all hardware.

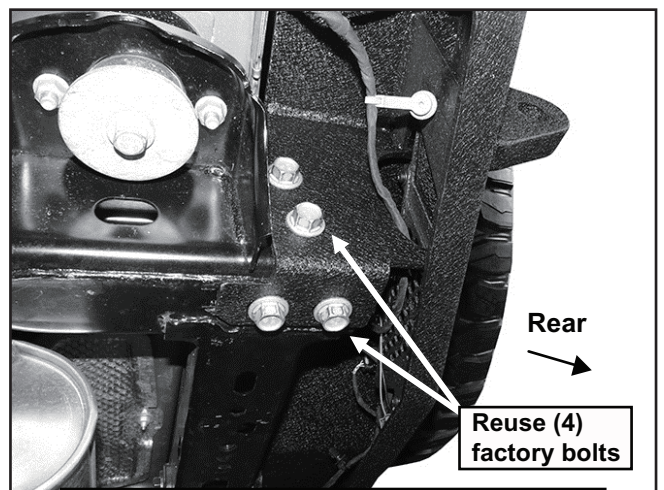
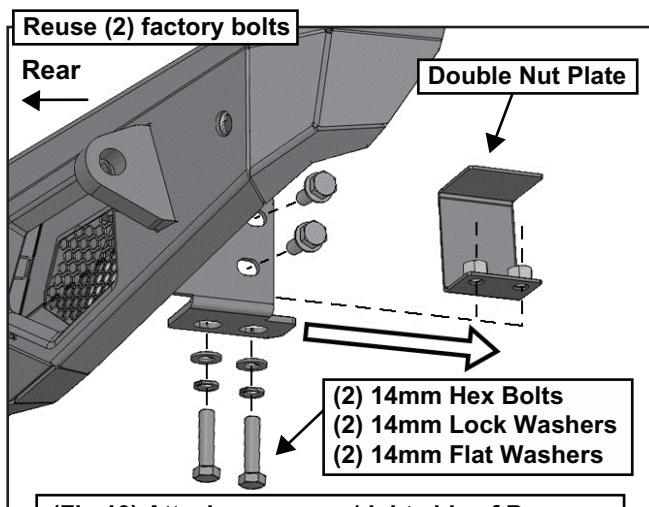
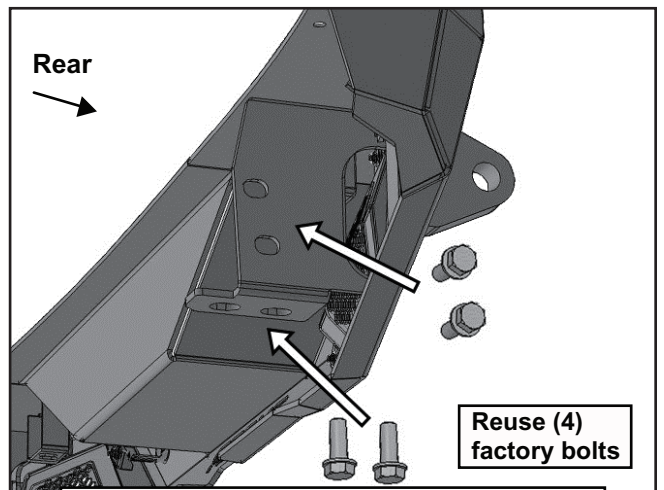
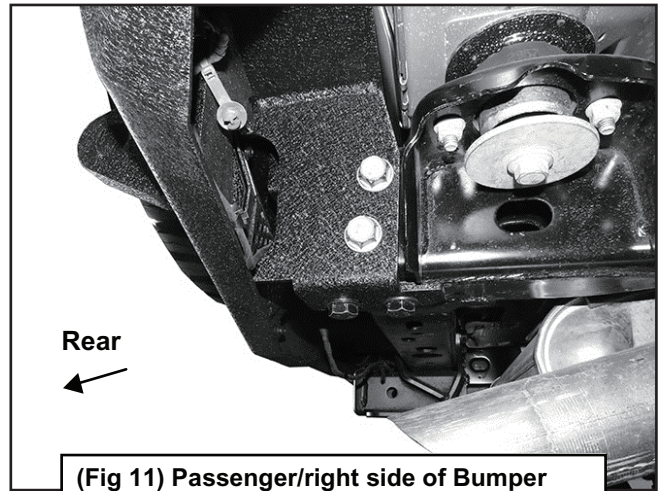

(Fig 10) Attach passenger/right side of Bumper to Double Nut Plate. Reuse (2) factory hex bolts to attach Bumper to side of frame (see Fig 11)

(Fig 13) Driver/left side of Bumper installed



TYGER[®]

STEP 11

Select the License Plate Bracket, (Figure 14). Attach the Bracket to the top of the Bumper with the included (2) 8mm x 25mm Button Head Bolts, (4) 8mm Flat Washers and (2) 8mm Nylon Lock Nuts. Attach the license plate to the top holes in the Bracket with the included (2) Plastic Plugs. Insert the License Plate Light into the hole in the Bracket and attach to the wiring harness, (Figure 14).

STEP 12

Plug-in the bumper wiring harness to the main harness.

STEP 13

Do periodic inspections to the installation to make sure that all hardware is secure and tight.

