



STAR ARMOR®

TG-AM2D21078

BEFORE INSTALLATION

READ INSTRUCTIONS CAREFULLY BEFORE STARTING INSTALLATION. REMOVE CONTENTS FROM BOX AND VERIFY ALL PARTS ARE PRESENT. FAILURE TO IDENTIFY DAMAGE BEFORE INSTALLATION COULD LEAD TO A REJECTION OF ANY CLAIM. IF MISSING PARTS OR ANY DAMAGE FOUND, PLEASE TAKE A PICTURE FOR THE CLAIM PURPOSE.

TORQUE VALUES

Fastener Size	Class 8.8 Torque (ft-lbs)	Class 10.9 Torque (ft-lbs)
6mm	6-7	6-7
8mm	15-16	22-23
10mm	31-32	44-45
12mm	54-55	78-79
14mm	87-88	125-126

Parts List

- x1 Driver/Left Side Armor
- x1 Passenger/Right Side Armor
- x2 Driver/Left Support Brackets
- x2 Passenger/Right Support Brackets
- x12 8-1.25mm x 30mm Hex Bolts
- x4 8mm Bolt/Nut Plates
- x16 8mm x 24mm x 2mm Flat Washers
- x8 8mm Lock Washers
- x4 8mm Hex Nuts
- x4 8mm Nylon Lock Nuts
- x4 8mm Plastic Retainers
- x8 6-1.0mm x 25mm Hex Bolts
- x16 6mm x 22mm x 2mm Flat Washers
- x8 6mm Nylon Lock Nuts

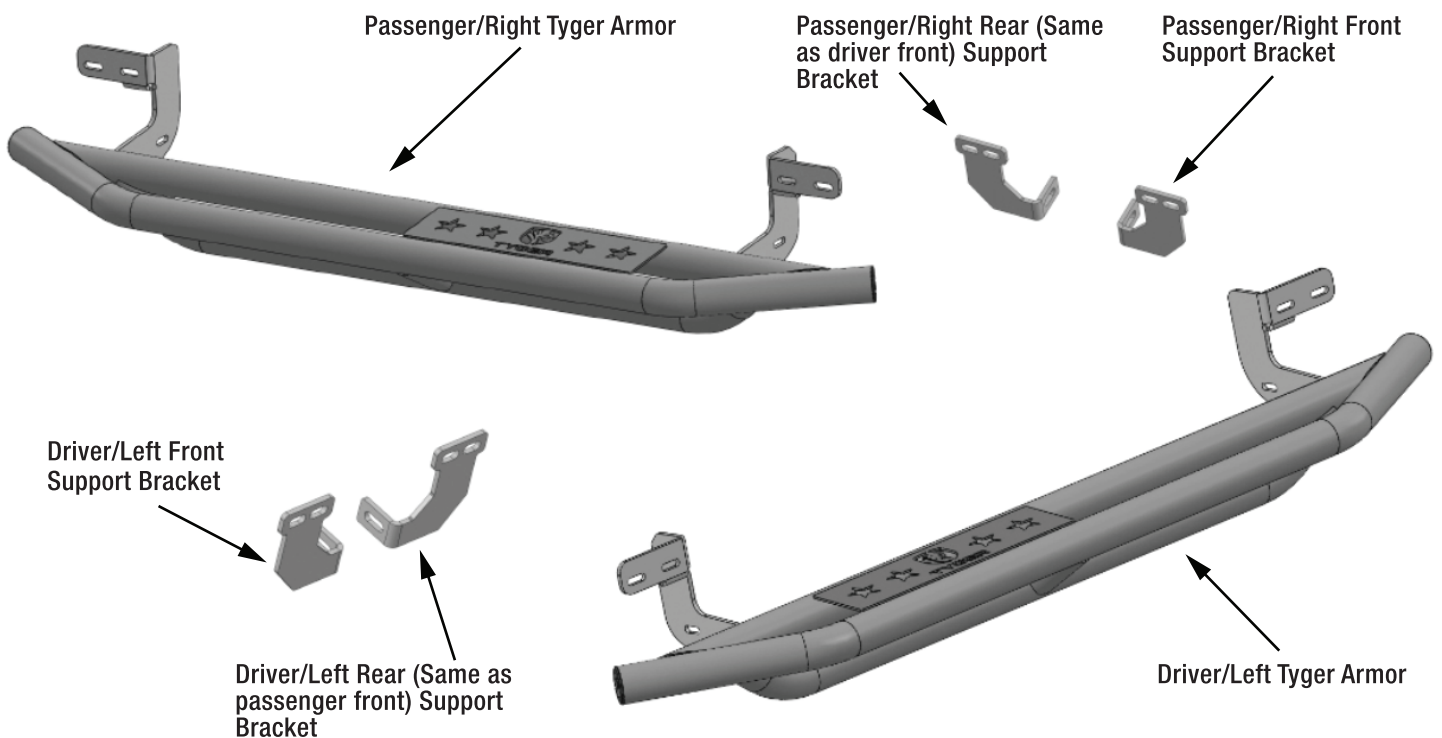



STEP 1

REMOVE CONTENTS FROM BOX. VERIFY ALL PARTS ARE PRESENT. READ INSTRUCTIONS CAREFULLY BEFORE STARTING INSTALLATION. DRILLING MAY BE REQUIRED.

STEP 2

Starting at the Passenger/Right front of the vehicle, remove the sealing tape covering the factory holes in the side of the inner panel, (Figure 1).

Passenger/Right Side Installation Pictured



(Fig 1) 2009-mid 2015 Passenger/Right front mounting location (No factory holes in pinch weld 2009-2012 models)

STEP 3

Determine the correct procedure to attach the Passenger/Right front Bracket for your model/year:

Models without factory threaded inserts in body panel:

a. Partially thread an 8mm Hex Bolt into the threaded end of an 8mm Bolt and Nut Plate. Thread the Hex Bolt in until it is flush with the welded nut, (Figures 3 & 4). Use the Hex Bolt as a handle and insert the Bolt and Nut Plate into the oval hole, (Figure 5). Feed the threaded bolt on the Bolt Plate through one of the hex shaped factory holes. Thread (1) 8mm Plastic Retainer onto the threaded end and down tight against the body panel, (Figure 6).

NOTE: The Plastic Retainer is designed to keep the Bolt/Nut Plate from falling into the body panel and to aid in Bracket installation.

Passenger/Right Side Installation Pictured

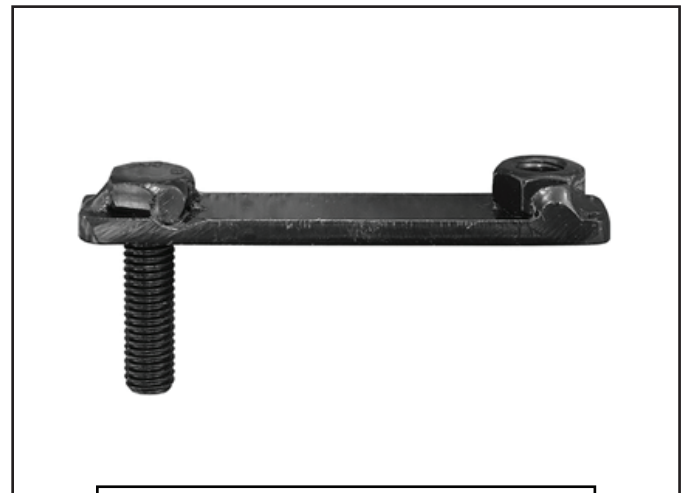

(Fig 3) 8mm Bolt-8mm Nut Plate, NOTE: 8mm Bolt-Nut Plate is not required on models with threaded inserts

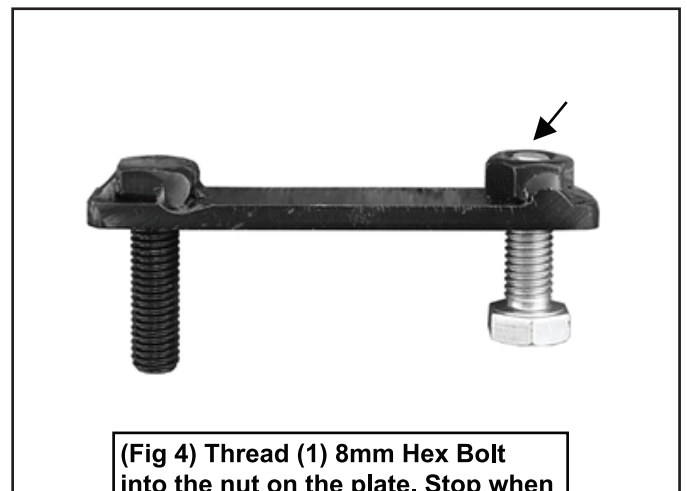

(Fig 4) Thread (1) 8mm Hex Bolt into the nut on the plate. Stop when bolt reaches end of nut as pictured



TYGER[®]

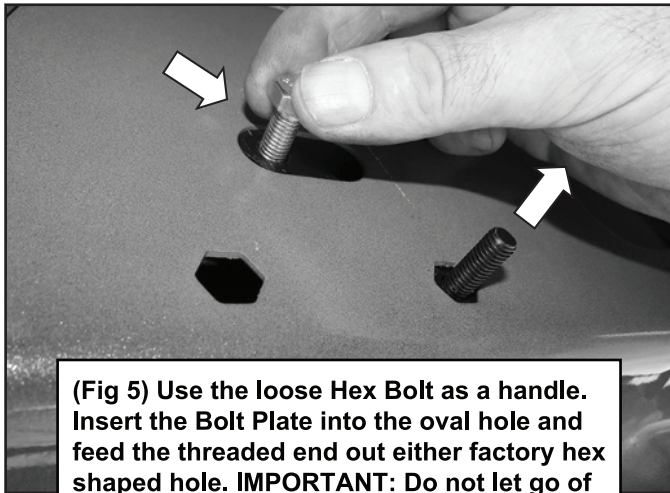

(Fig 5) Use the loose Hex Bolt as a handle. Insert the Bolt Plate into the oval hole and feed the threaded end out either factory hex shaped hole. **IMPORTANT:** Do not let go of the hex bolt until after Plastic Retainer has been threaded onto bolt Fig 6

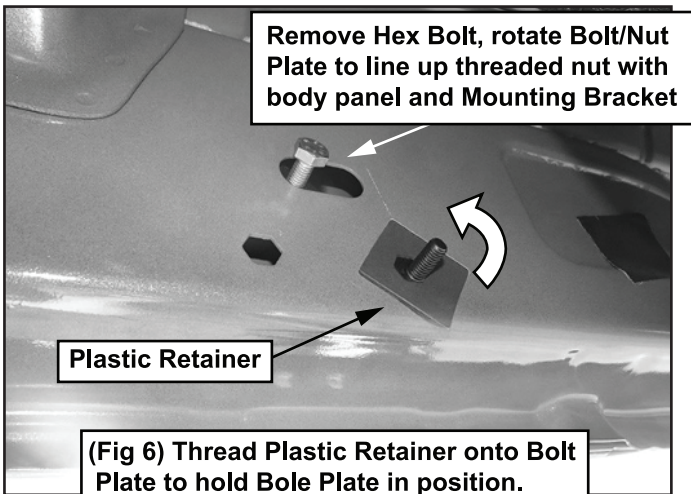

Remove Hex Bolt, rotate Bolt/Nut Plate to line up threaded nut with body panel and Mounting Bracket

Plastic Retainer

(Fig 6) Thread Plastic Retainer onto Bolt Plate to hold Bolt Plate in position.

b. Repeat **STEP 3a** to insert (1) Bolt Nut Plate into the Passenger/Right rear location, (Figure 2).

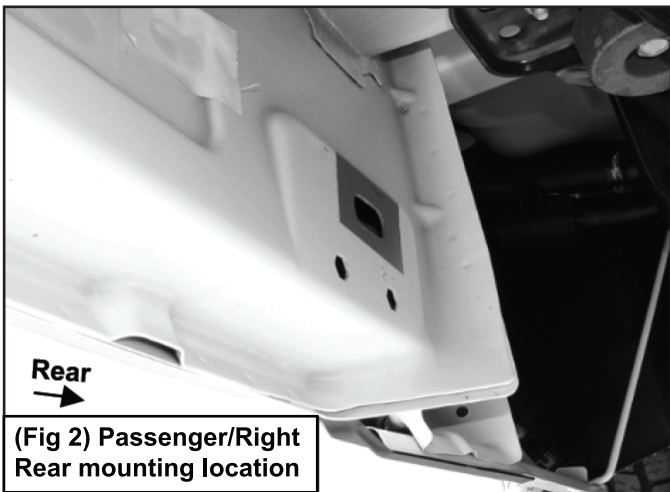

Rear

(Fig 2) Passenger/Right Rear mounting location

c. Select the Passenger/Right Tyger Armor. Attach the Tyger Armor to the threaded end of the Bolt Plates on the Passenger/Right Front and Rear mounting location with (2) 8mm Flat Washers, (2) 8mm Lock Washers and (2) 8mm Hex Nuts, (Figure 7). **DO NOT** tighten at this time.

Passenger/Right Side Installation Pictured

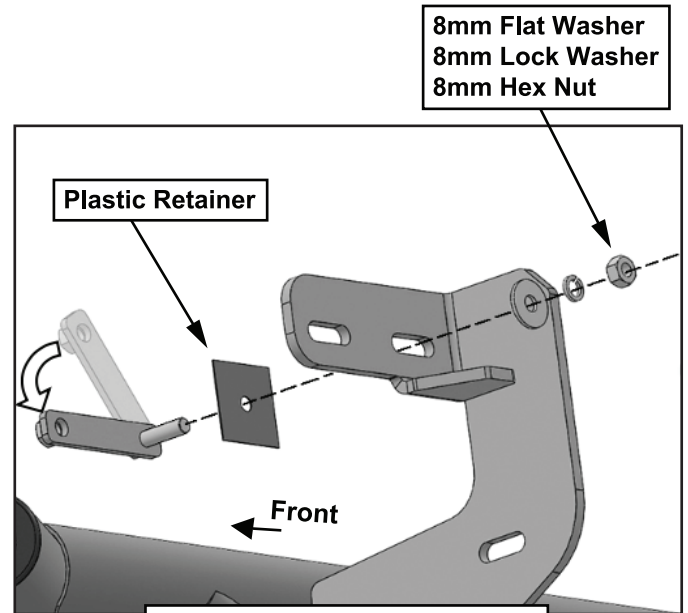

8mm Flat Washer
8mm Lock Washer
8mm Hex Nut

Plastic Retainer

Front

(Fig 7) Attach Passenger/Right Front Bracket to Bolt Plate (Passenger front pictured)

d. Move to front mounting location. Remove the 8mm Hex Bolt from the nut on the Bolt Plate from **STEP 3a**. Rotate the Bolt on the Bolt Plate until the threaded nut lines up with the remaining hole in the Mounting Bracket and body panel. Attach the Bracket to the threaded Nut Plate with (1) 8mm x 30mm Hex Bolt, (1) 8mm Lock Washer and (1) 8mm Flat Washer, (Figure 8). Repeat this Step for the Passenger/Right Rear location to attach the Passenger/Right Rear Mounting Bracket. **DO NOT** tighten.

Models with factory threaded inserts:

e. Attach the Passenger/Right Tyger Armor to the threaded inserts with (4) 8mm x 30mm Hex Bolts, (4) 8mm Lock Washers and (4) 8mm Flat Washers, (Figures 9 & 10). **DO NOT** tighten.



Passenger/Right Side Installation Pictured

8mm Hex Bolt
8mm Lock Washer
8mm Flat Washer

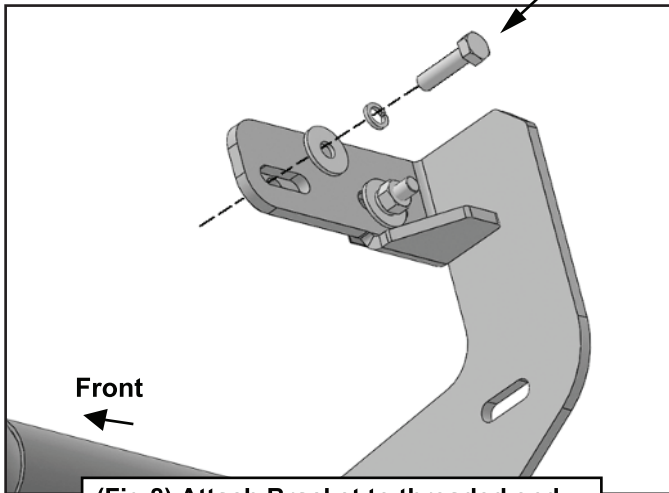

(Fig 8) Attach Bracket to threaded end of Bolt Plate first. Remove 8mm Hex Bolt (see Fig 3). Rotate Bolt Plate to line up with remaining factory hex shaped hole.

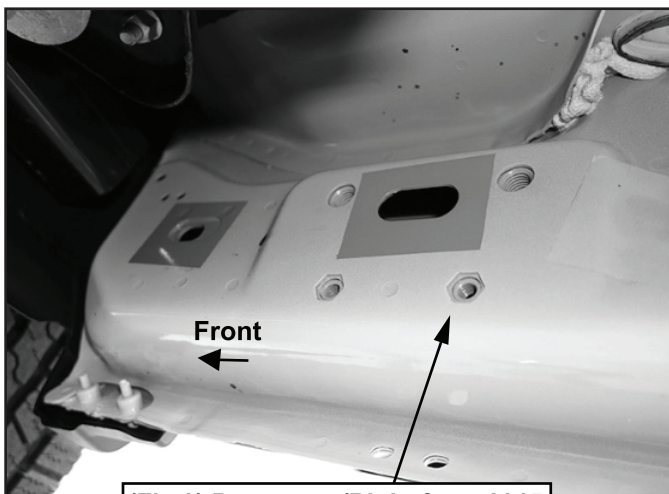

(Fig 9) Passenger/Right front 2015 -on, an example of models with factory installed threaded inserts

(2) 8mm Hex Bolts
(2) 8mm Lock Washers
(2) 8mm Flat Washers

Front
←

(Fig 10) Passenger/Right Front-models with factory installed threaded inserts. Bolt Plate not required

STEP 4

Select the Passenger/Right Front Support Bracket. Attach Bracket to the back of the pinch weld. Line up the slots in the top of the Support Bracket with the (2) factory holes in the pinch weld. Attach the Bracket to the back of the pinch weld with (2) 6mm x 25mm Hex Bolts, (4) 6mm Flat Washers and (2) 6mm Nylon Lock Nuts, (Figure 11).

IMPORTANT: 2009-12 models may not be equipped with factory holes and will require drilling through the pinch weld to attach the Support Bracket. DO NOT drill through pinch weld at this time, (see Step 8).

Passenger/Right Side Installation Pictured

(2) 6mm Hex Bolts
(4) 6mm Flat Washers
(2) 6mm Nylon Lock Nuts

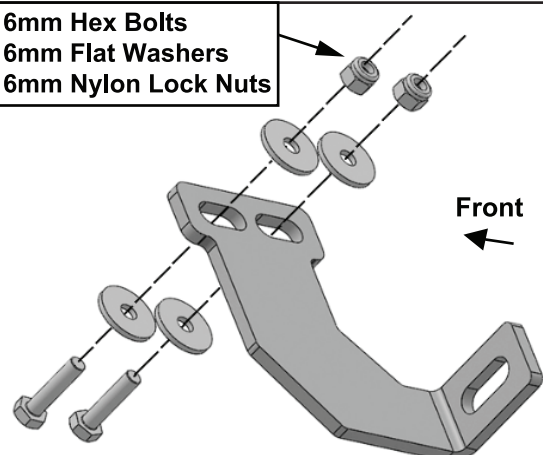

(Fig 11) Attach Support Bracket to back of pinch weld (models with factory holes in pinch weld only)



STEP 5

Attach the Support Bracket to the front facing side of the front Mounting Bracket on the Tyger Armor with (1) 8mm x 30mm Hex Bolt, (2) 8mm Flat Washers and (1) 8mm Nylon Lock Nut, (Figure 12). DO NOT tighten.

Passenger/Right Side Installation Pictured

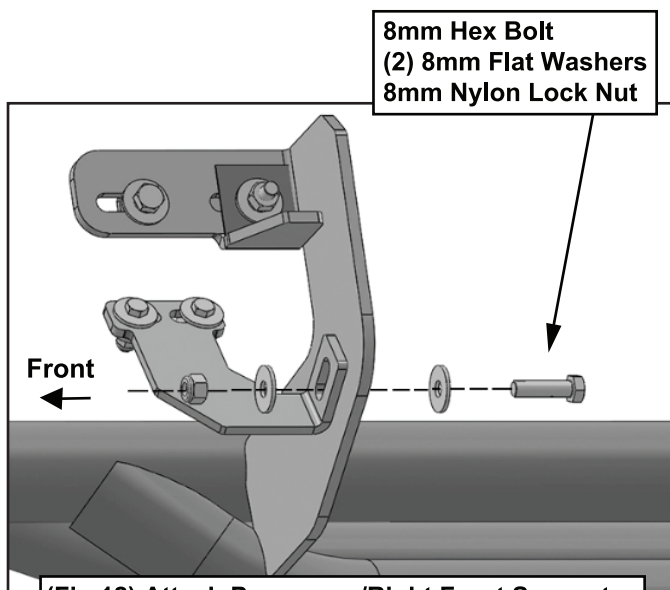

(Fig 12) Attach Passenger/Right Front Support Bracket to front facing side of Mounting Bracket

STEP 6

Repeat **STEPS 4 & 5** to attach the Passenger/Right Rear Support Bracket to the rear facing side of the Rear Mounting Bracket on the Tyger Armor, (Figure 13).

Passenger/Right Side Installation Pictured

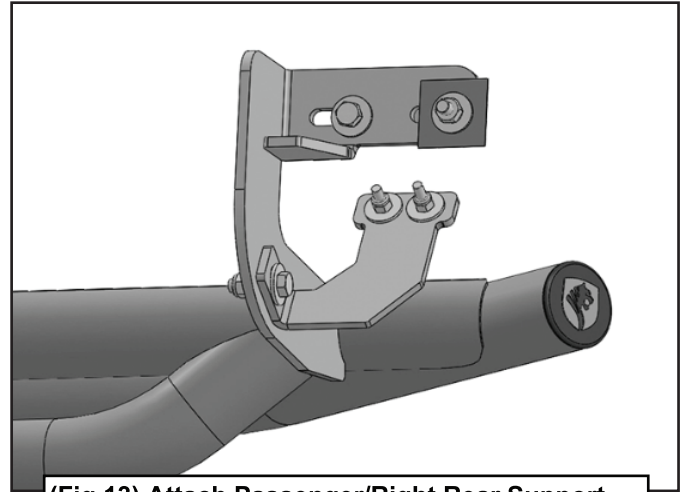

(Fig 13) Attach Passenger/Right Rear Support Bracket to rear facing side of Mounting Bracket (Installation complete in picture)

STEP 7

Properly level and adjust the Sidebar and fully tighten all hardware.

STEP 8

2009-12 models requiring drilling for driver side Support Brackets:

- Make sure the Sidebar is level to the vehicle. Adjust and tighten all mounting hardware.
- Line up the slots on the Support Brackets with the back of the pinch weld. Mark the location of the slots onto the pinch weld.
- Drill (2) 1/4" holes through the pinch weld for each Support Bracket.

IMPORTANT: DO NOT drill too close to the bottom edge of the pinch weld. Adjust the Brackets as necessary to move the slots up the body panel away from the edge. Drill the holes toward the outside of the marked slots.

- Attach each Support Bracket to the pinch weld with (2) 6mm Hex Bolts, (4) 6mm Flat Washers and (2) 6mm Nylon Lock Nuts, (Figure 11). Level and adjust then fully tighten all hardware.



STEP 9

Move to the Driver/Left side of the vehicle. Remove tape covering front and rear locations. Repeat **STEPS 2—8** for Driver/Left side installation.

NOTE: Refer to the illustration on **PAGE 1** to identify the correct Mounting Bracket for each of the remaining locations.

STEP 10

Do periodic inspections to the installation to make sure that all hardware is secure and tight.



Installation Complete