

WHY TYGER?

THE QUALITY YOU CAN TRUST.

To ensure the perfect finish of our black bars and for better rust resistance, we focus every procedure during production including the Pre-treatment and E-Coat before the Black Powder coating. Meanwhile, some similar products in the market reduce their costs by ignoring our first two key procedures.

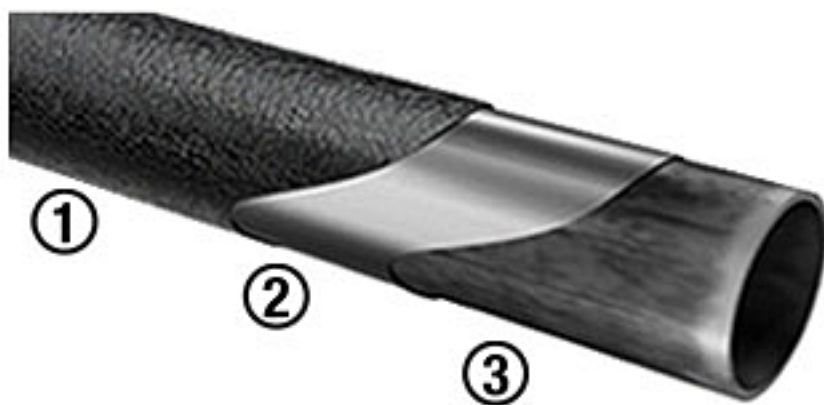

HOW WE DO IT

- ① Pre-treatment to remove impurities
- ② Special "E-Coat" Inside & Out
- ③ Dual-Stage Textured Black Powder

E-COAT

Consistency - uniform density
Durability - 1000Hrs+ of salt spray resistance
Electrodeposition - uses electrical current to deposit the paint

PRE-TREATMENT

Phosphate- a smoother & stable surface
Acid Washing - removes rust
Oil Degreasing - rust and corrosion resistance.

RESULTS WITHOUT PRE-TREATMENT AND E-COAT



Paint bubbles



Rust dust

Only fit on Crew Cab as the circled one!

Chevy/GMC truck Cab Details

Regular Cab



(2 Doors only)

Extended Cab
(On/Before 2013)



(2 Full-Size Front Doors & 2 Suicided Rear Doors)

Double Cab
(2014 - Up)



(2 Full-Size Front Doors & 2 Narrower Rear Doors)

Important: Before ordering, please check with your dealer to make sure your truck is with Crew Cab, Not Double Cab.

Crew Cab



(4 Full-Size Doors)

For 2017 Diesel Model w/ DEF Tank only

—TRIMMING REQUIRED—



1 Remove the DEF tank cover by taking out 4 of the Hex bolts.



2 Hold the DEF cover in place and mark the passenger side 2nd bracket mounting location onto the cover.

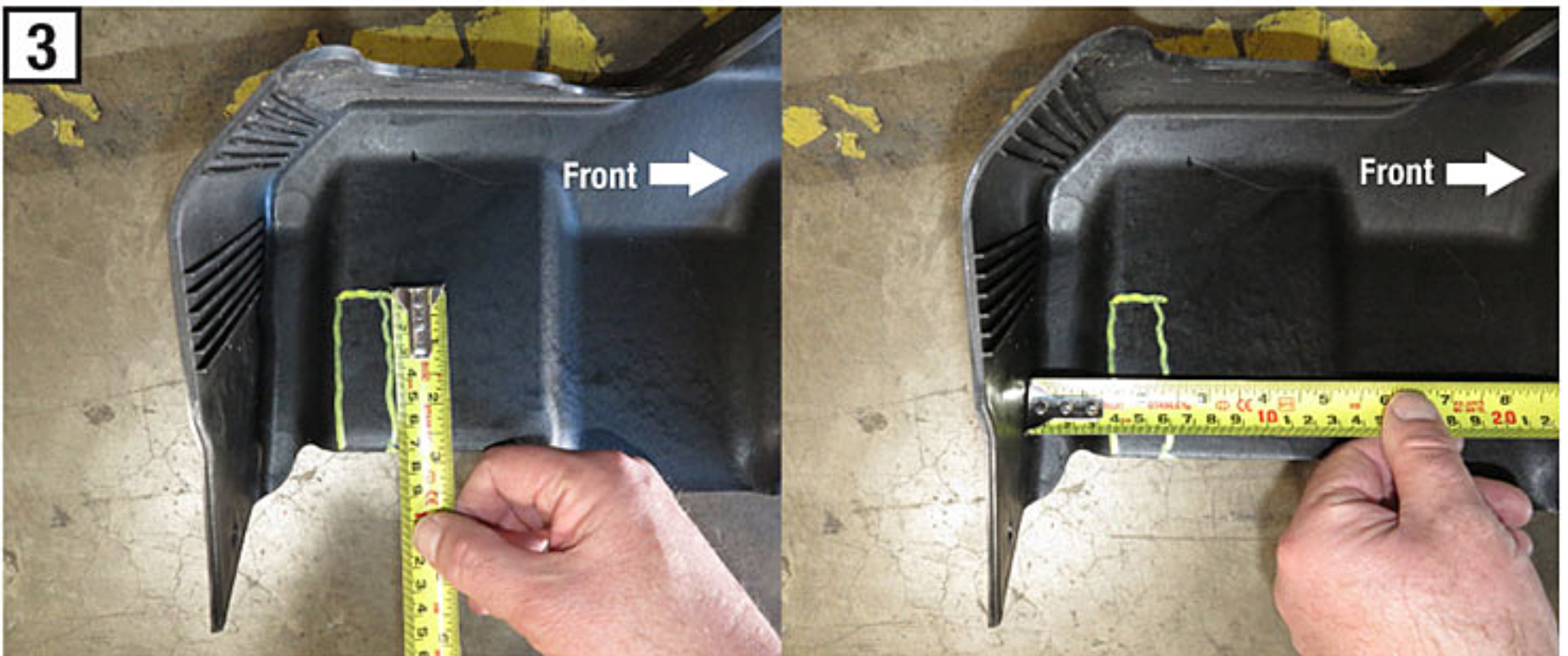

3 Use a sharp knife to trim a slot along the marking as little plastic as possible. Re-install the DEF tank cover and install the bracket.



Patented star armor step pad design
crafted by laser-cutting technology.



Heavy duty metal tubes with seamless
robotic welding for a sturdy structure.

Rust resistant E-Coating textured
black finish.

Sealed end caps for water & dirt
resistance.



Rely on premium running boards & step bars by Tyger if you're looking for quality and efficiency.