



TYGER®

TYGER ARMOR

BEFORE INSTALLATION

READ INSTRUCTIONS CAREFULLY BEFORE STARTING INSTALLATION. REMOVE CONTENTS FROM BOX AND VERIFY ALL PARTS ARE PRESENT. FAILURE TO IDENTIFY DAMAGE BEFORE INSTALLATION COULD LEAD TO A REJECTION OF ANY CLAIM. IF ANY DAMAGE FOUND, PLEASE TAKE PICTURE(S) OF THE ISSUE FOR THE CLAIM PURPOSE.

WARNING

To protect your investment, wax this product after installing. Regular waxing is recommended to add a protective layer over the finish. Do not use any type of polish or wax that may contain abrasives that could damage the finish. Please use only mild soap to clean the Side Armor.

TG-AM2C20028

Parts List

- x1 Driver Side Armor
- x1 Passenger Side Armor
- x1 Passenger/right Front Upper Bracket (all incl. DEF)
- x11 8-1.25mm Clip-On Nuts
- x1 8-1.25mm x 40mm Hex Bolt
- x1 8 mm Nylon Lock Nut
- x11 8-1.25mm x 25mm Hex Bolt
- x12 8mm x 24mm x 2mm Flat Washer
- x1 8mm x 28mm x 3mm Flat Washer
- x1 8mm x 35mm Bolt Plate
- x11 8mm Lock Washer





TYGER[®]

STEP 1

Start the installation under the driver side of the vehicle. Locate the 4 tabs along the bottom edge of the body, (pinch weld). Mounting Brackets will bolt to the 1st, 2nd and 4th mounting tabs, (Figure 1). Directly above each tab is a top mounting location on the side of the body panel. If necessary, line up the driver/left Side Armor with the mounting holes in the body panel to help determine correct locations.

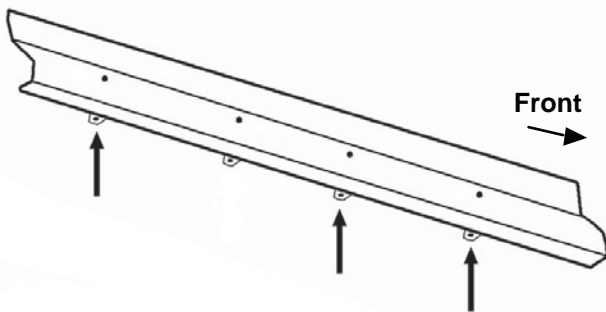

(Fig 1) Driver side (3) mounting locations

Flat tab on pinch weld with hole: Select (1) 8mm Clip Nut. Slide the Clip Nut over the tab with the nut facing up behind the tab, (Figures 3-5). Line up threaded nut with hole in the tab. Repeat for each mounting location.

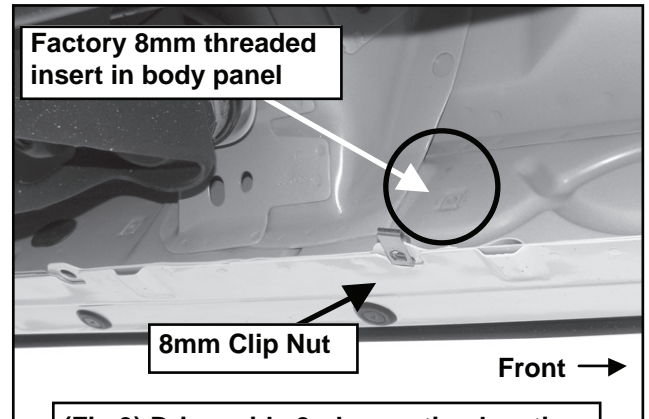

(Fig 3) Driver side 2nd mounting location

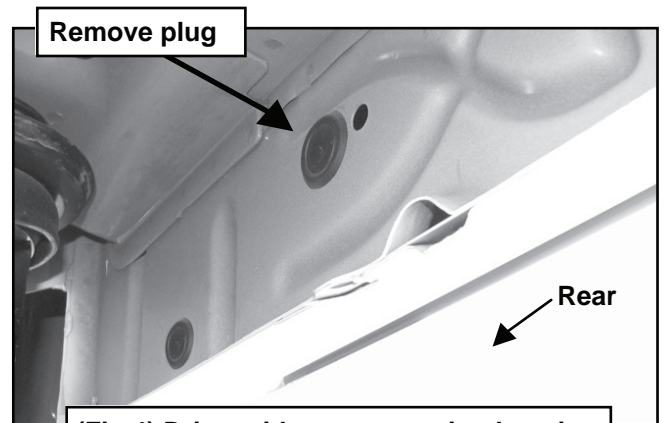

(Fig 4) Driver side rear mounting location

STEP 2

Determine the correct procedure for your model year and each Bracket location.

Bottom mounting location on the edge of the pinch weld.

Flat tab on pinch weld with factory installed weld nut: Thread hex bolt into weld nut from the backside-down to clear paint from threads, (Figure 2).

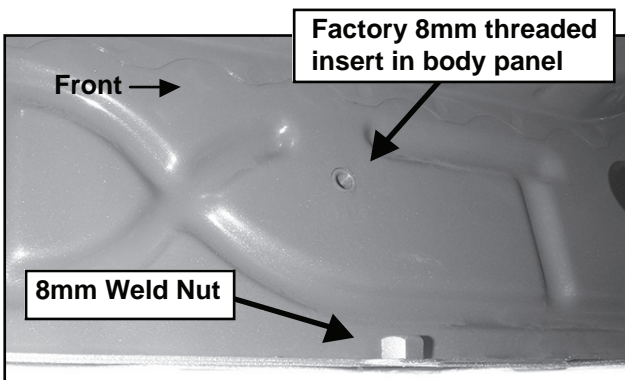

(Fig 2) Passenger side front mounting location

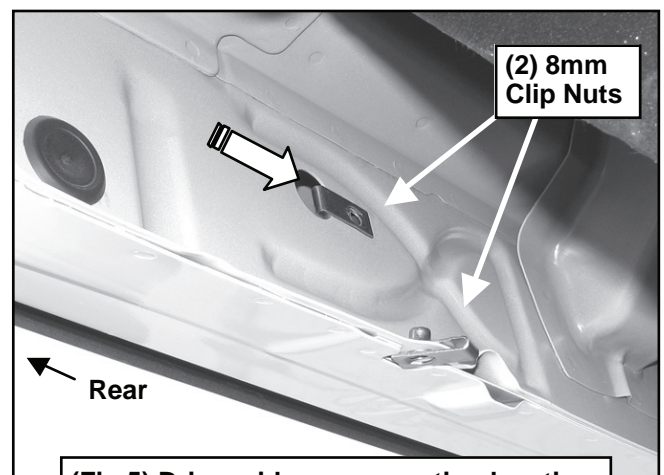

(Fig 5) Driver side rear mounting location



TYGER®

Locate top mounting location on the back side of the body panel.

Models with factory installed threaded insert in body panel: Thread 8mm Hex Bolt into threaded insert to clear paint as required, (Figures 2 & 3).

Large and small hole in side of body panel: Remove the rubber plug from the larger hole, (Figure 4). Select (1) 8mm Clip Nut. Slide the Clip Nut into the larger hole. Line up the threaded nut with the smaller hole, (Figure 5).

STEP 1

With assistance, hold the Side Armor up in position. Attach the mounting tabs on the Side Armor to the Clip Nuts and/or the factory threaded holes with (8) 8mm x 25mm Hex Bolts, (8) 8mm Lock Washers and (8) 8mm STD Flat Washers, (Figures 6 & 7).

(2) 8mm Hex Bolts
(2) 8mm Lock Washers
(2) 8mm Flat Washers

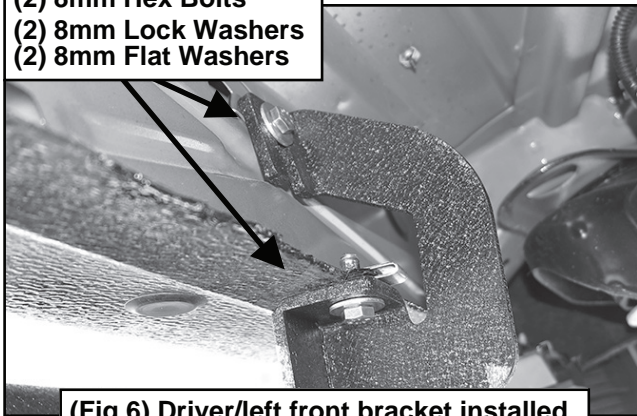

(Fig 6) Driver/left front bracket installed

(2) 8mm Hex Bolts
(2) 8mm Lock Washers
(2) 8mm Flat Washers

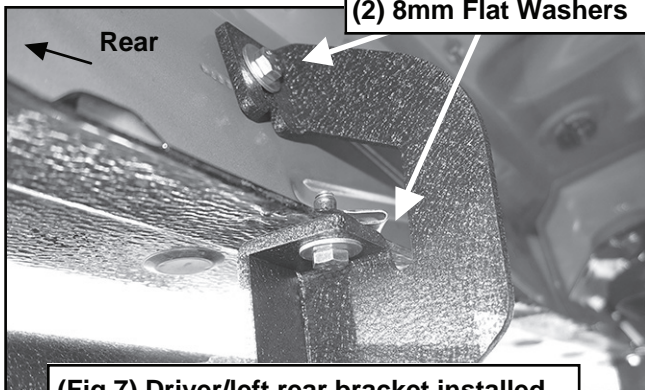

(Fig 7) Driver/left rear bracket installed