

# TYC™

## CABIN AIR FILTER

- ▶ Cleaner Air for Passengers
- ▶ Enhanced HVAC Performance
- ▶ Easy Installation, Perfect Fit

**TYC #: 800011P**

Estimated Time : 10 min.

Replacement for OEM  
MR500360

00-05 Mitsubishi Eclipse  
**99-03 Mitsubishi Galant**

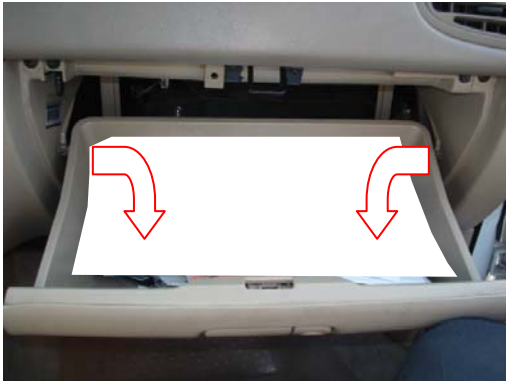

1. The filter is located behind the glove compartment. Open the glove compartment, push on the sides while pulling down to disengage the latches. Allow the glove box to swing down on its hinges.



3. Remove the old filter frame (if present) by sliding it out towards you. Remove old filter from its frame and install new filter, ensuring that Air Flow arrow is pointing down.

4. Reinstall in reverse order.

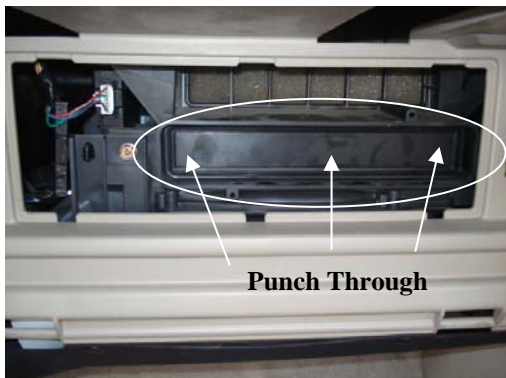

2. The filter is optional and may not be installed in all vehicles\*. If the filter compartment is sealed as shown, use a flat head screwdriver to punch through the perforated plastic cover.

\*Note: Some vehicles may not have the filter frame pre-installed in the compartment. If so, please purchase the filter frame from your local dealer before installing TYC's filter element.

Installation guide pictures are from the **BOLD** vehicle model.