

**TUXMAT**

The Ultimate Car Mat

Installation Instructions

# INSTALLATION GUIDE

## GUIDE D'INSTALLATION

---



**WARNING:** Please follow the steps prior to operating vehicle. Failure to follow these instructions could create an unsafe situation if the mats were to move and interfere with vehicle controls such as brake, accelerator or clutch pedal.

1. Remove existing floor mats from the vehicle prior to installing TuxMat.
  2. Install TuxMat carefully following the Installation Guide.
  3. Ensure TuxMat does not shift in any way after installation is complete.
- Do not use TuxMat if compliance with this warning cannot be obtained.**

---

### PART LIST

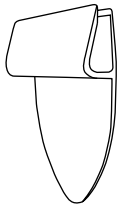

Clip x16

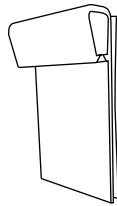

Hook and loop fastener clip x4

---

**Thank you for choosing TuxMat. We hope you enjoy The  
Ultimate Car Mat experience.**

# DRIVER SECTION

1. Move Driver Seat position as far back and upwards as much as possible.

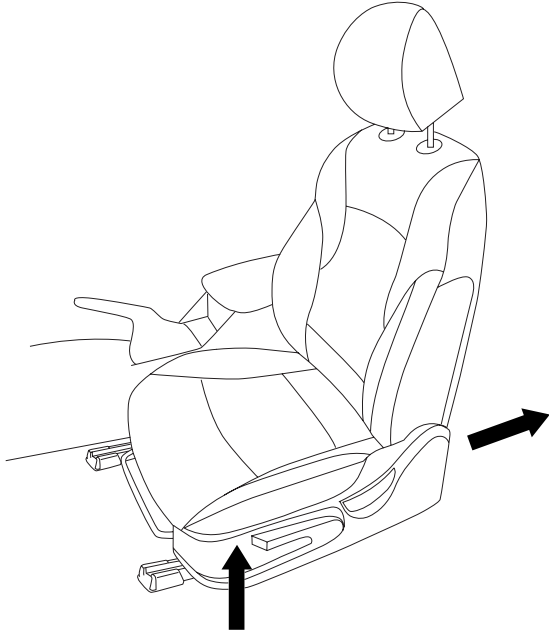

2. Align Driver Side mat in place and locate the existing retention anchors on the carpet if applicable, otherwise skip to step 4.

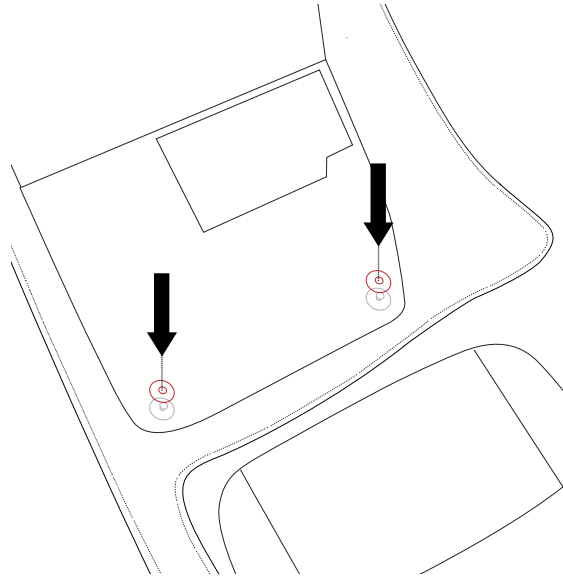

3. Once aligned, fasten the retention hardware on the mat to the existing anchor points in your vehicle (types may vary depending on your vehicle make/model: velcro, push, hook, twist locks).

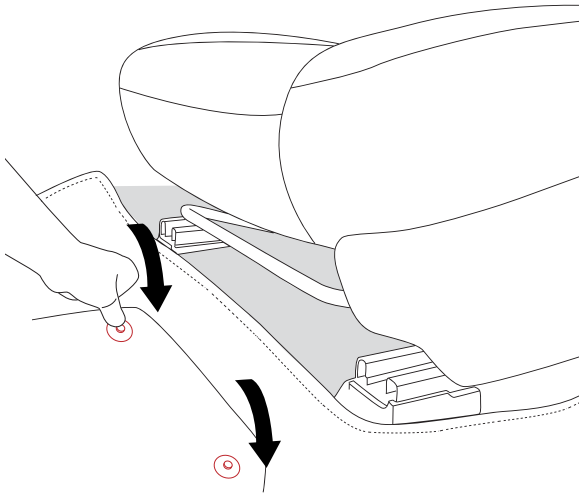

4. Flatten the mat to the contours of all footwell surfaces, tuck rear end of the mat beneath seat rails and ensure mat is obstruction-free (levers, rails, pedals etc).

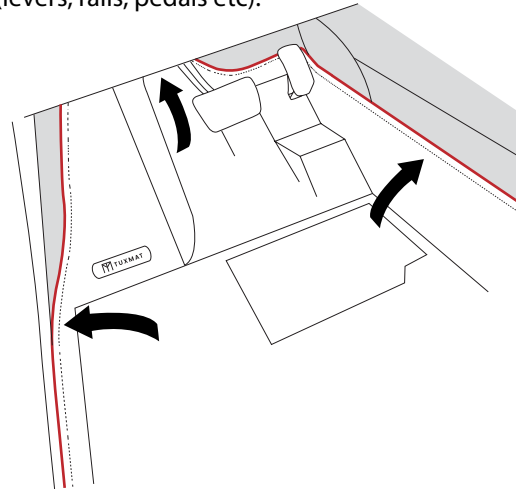

# DRIVER SECTION

5. Check full motion of all foot pedals (Brake, Accelerator and Clutch) to ensure mat does not interfere with vehicle operation.

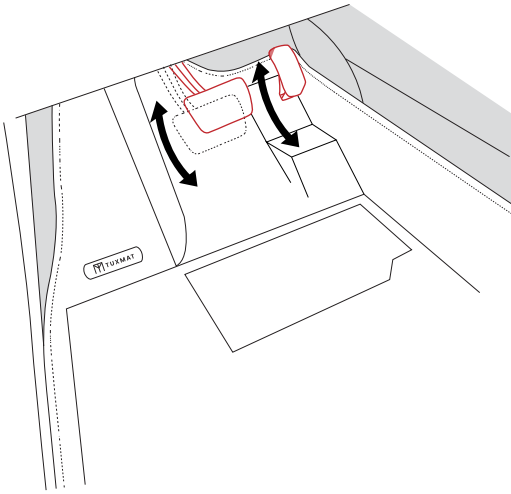

6. Add security side clips to the edge of the mat and slide underneath interior trim to hold mat in place as required.

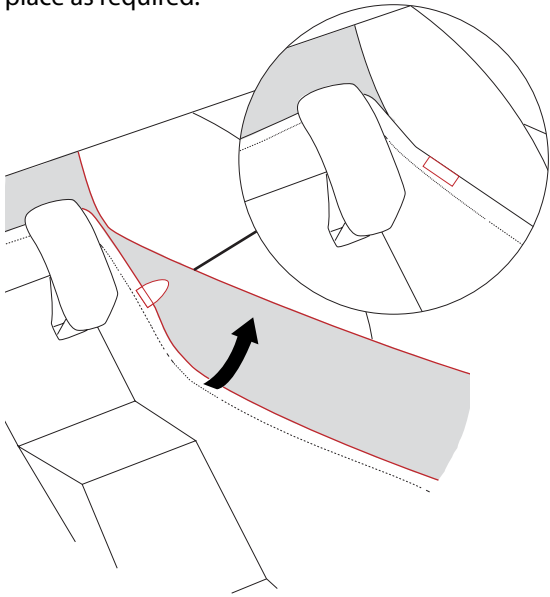

7. Optional: Where side clips cannot be applied, use velcro clips on the edge of the mat. Peel removable backing and stick to flat surface as required.

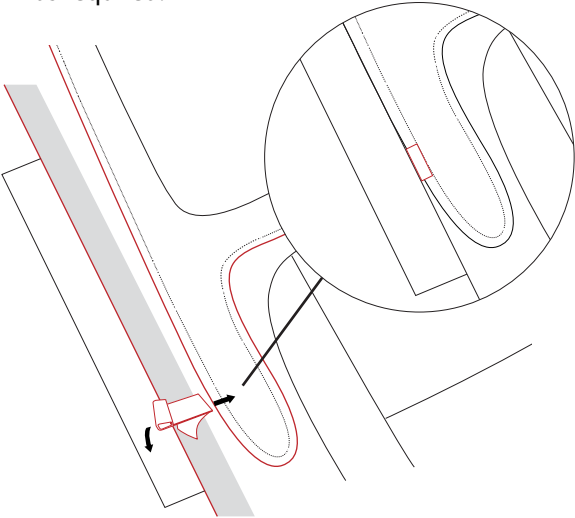

## FRONT PASSENGER SECTION

1. Move passenger seat up and backwards as much as possible.

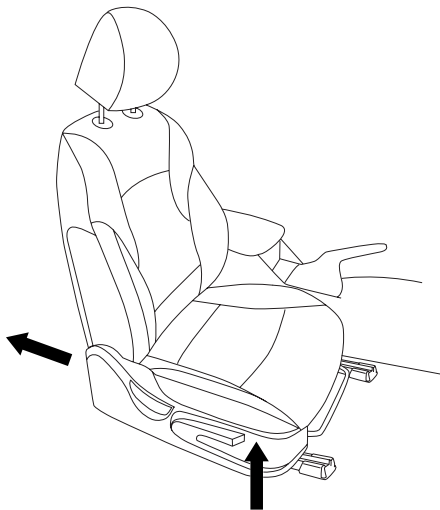

2. Align passenger mat in place and locate the existing retention anchors on the carpet if applicable, otherwise skip to step 4.

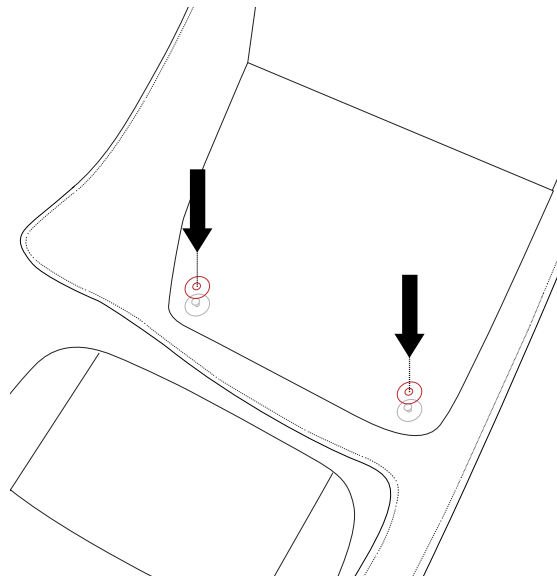

3. Once aligned, fasten the retention hardware on the mat to the existing anchor points in your vehicle (types may vary depending on your vehicle make/model: velcro, push, hook, twist locks).

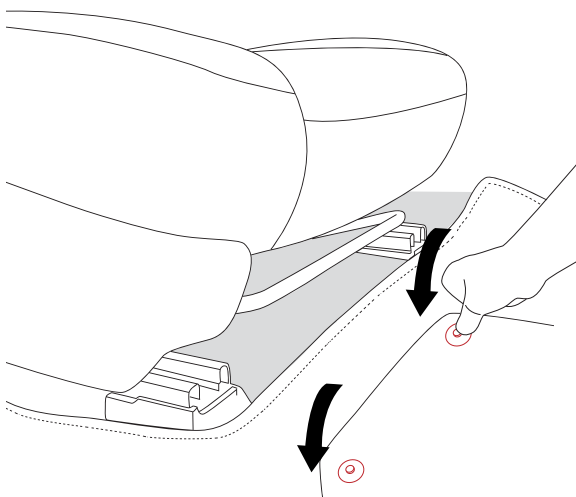

4. Flatten the mat to the contours of all footwell surfaces, tuck rear end of the mat beneath seat and ensure mat is obstruction-free (lever, rails).

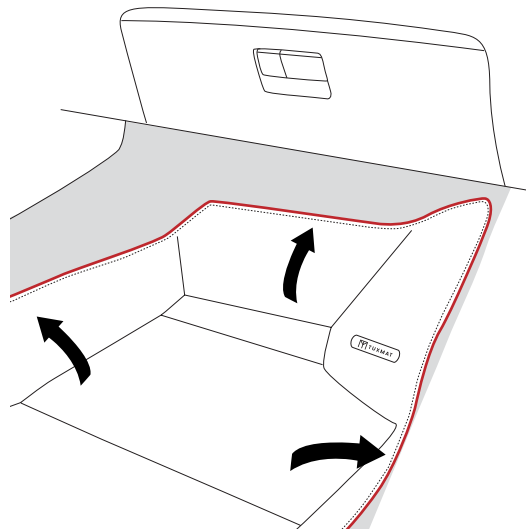

# FRONT PASSENGER SECTION

5. Add security side clips to the edge of the mat and slide underneath interior trim to hold mat in place as required.

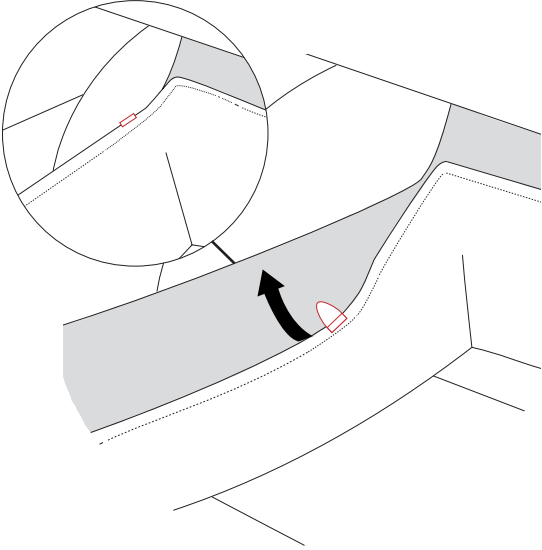

6. Optional: Where side clips cannot be applied, use velcro clips on the edge of the mat. Peel removable backing and stick to flat surfaces as required.

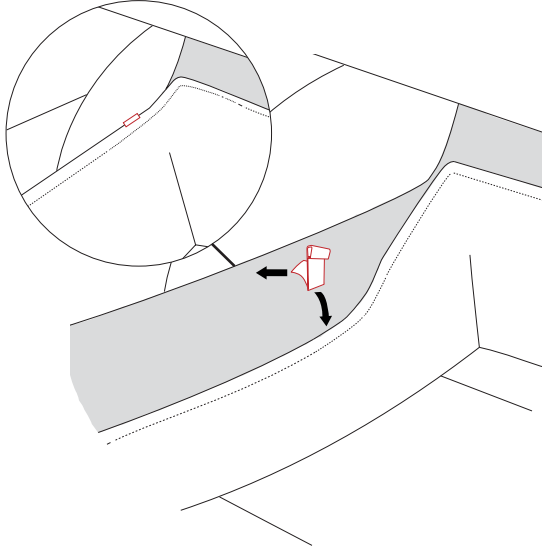

## REAR SECTION(S)

1. Move both front seats up and forward as much as possible.

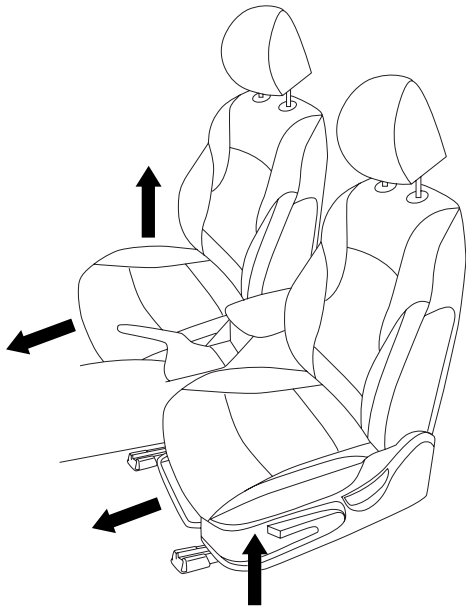

2. Align rear mat in place and locate the existing retention anchors on the carpet if applicable, otherwise skip to step 4.

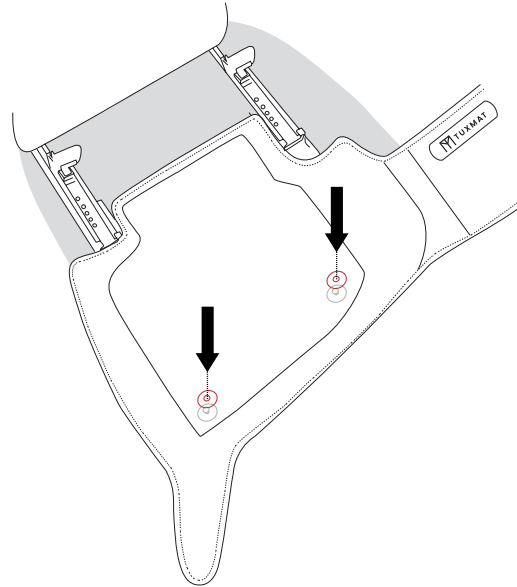

3. Once aligned, fasten the retention hardware on the mat to the existing anchor points in your vehicle (types may vary depending on your vehicle make/model: velcro, push, hook, twist locks).

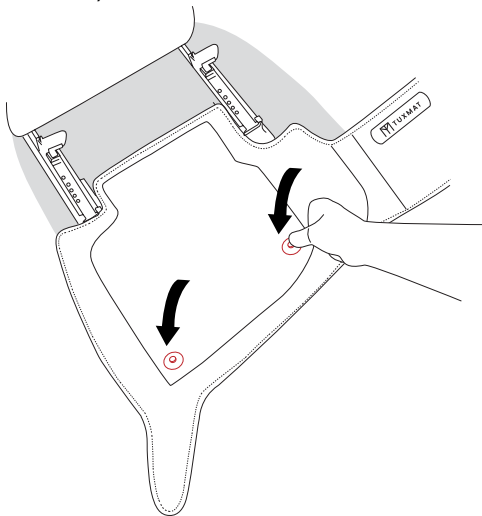

4. Flatten mat to footwell surfaces and tuck rear end of the mat beneath rear seat (some mats require rear seat to be lifted). Ensure mat is obstruction-free (levers, rails etc).

**Optional:** Insert side clips / velcro clips as required.

