



NEW!

High torque gear reduction starters

FASTER CRANKING



Tuff Torque starters are more reliable!

- 100 % copper band field coils (not just copper wire) allows for longer cranking time without overheating
- Thicker solenoid contacts do not wear prematurely giving you many more reliable starts
- 100% ball bearing construction for smooth and quiet cranking
- Solid one piece field housing provides water resistance and magnificent chrome luster and gold zinc finishes
- Billet machined drive end offers high strength, great looks and allows the starter motor to be indexed for additional header clearance
- Compact enough to fit almost any "CRAMMED" clearance situation
- Affordable compared to some expensive high tech starters that are just overkill



LIGHTWEIGHT HIGH TORQUE GEAR REDUCTION STARTERS



NEW!

QUALITY MADE IN USA

- Designed to crank up to 15:1 compression engines
- Applications include all popular V8's
- Copper band field coils allow for longer cranking time without over heating
- Billet aluminum drive end offers high strength, great looks and allows starter motor to be indexed for additional header clearance
- Rugged ball bearing construction provides for smooth, quiet cranking and long life
- Compact size fits virtually all chassis configurations



13310A

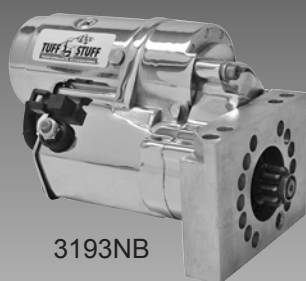

3193NB



13510A

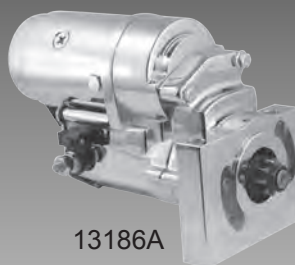

13186A

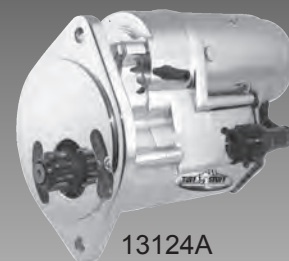

13124A



13131A



13132A

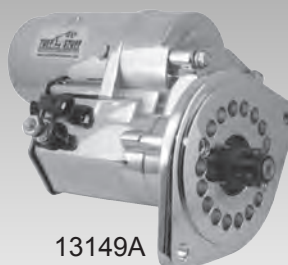

13149A



6084A

APPLICATION INFORMATION

MAKE	ENGINE	CHROME	GOLD ZINC
Chevy	Small and big block with offset mount, 168 tooth flywheels	13510A	13510
	Small and big block with straight mount, 153 or 168 tooth flywheels	3193NA	3193NB
	1998-2002 Camaro/Firebird, 1997-04 Corvette w/GM LS1, LS2 & LS6	13310A	13310
Pontiac/Olds	Pontiac/Olds 330-455 V8 w/stock ring gear and flex plate, except 6.6L	13186A	13186
Ford	1963-91 Small block w/auto or manual trans, 2 bolt	13124A	13124
	1965-74 289, 302, 351 w/manual trans, 2 bolt	13132A	13132
	1966-81 255, 352, 390, 427, 428 FE engines, auto or manual, 3 bolt	13131A	13131
	1969-77 351, 400, 429, auto or manual, 2 bolt holes, one is threaded	13149A	13149
Chrysler	1965-83 225, 273, 318, 340, 360, 361, 383, 400, 426 & 440 engines	6084A	6084B

"TUFF TESTED" FOR RELIABILITY LIKE ALL TUFF STUFF AMERICAN MADE PRODUCTS!

