

REINTRODUCING...

SAGINAW STYLE POWER STEERING PUMPS

**NEW and IMPROVED Reservoir design
IN STOCK and READY to SHIP!**

**Quality
made in
USA!**



- Reservoir is made from 20 gauge cold-rolled steel and furnace brazed for premium quality
- Pumps feature **all new components** including reservoir and pump assembly
- Press fit shafts are 3/4" diameter and requires a press fit pulley, 5/8" shafts have a keyway for use with a bolt-on pulley. Pulley not included
- 1200 PSI rated to work with most gearbox systems; 850 PSI available for Mustang II rack and pinion upon request



SAGINAW STYLE POWER STEERING PUMPS

- Saginaw style pumps feature **all new components** including reservoir and pump assembly
- Includes billet style chrome cap and dipstick
- Direct and universal fit applications covers most GM muscle cars and hot rod applications
- In stock and ready for immediate shipment



6174A / 6176A



6177A / 6178A



6179A



6180A



6181A



6182A



6183A



6184A



6188A

Applications	Mounting Threads	Shaft Diameter	Chrome	Black
1970-74 Camaro, Chevelle, El Camino, Malibu, Monte Carlo V8s	3/8"-16	5/8"	6183A	6183B
1979 Camaro, Firebird, TransAm, all V8's	3/8"-16	3/4"	6181A	6181B
1980-81 Camaro 267, 305 (VIN H), 350 (VIN L)	M10 x 1.5	3/4"	6179A	6179B
1982-87 Camaro, Firebird, TransAm, all V8's	M10 x 1.5	3/4"	6179A	6179B
1988-92 Camaro, Firebird, TransAm, all V8's	M10 x 1.5	3/4"	6184A	6184B
1978-79 Chevelle, El Camino, Malibu, Monte Carlo all V8's	3/8"-16	3/4"	6181A	6181B
1980-88 Chevelle, El Camino, Malibu, Monte Carlo	3/8"-16	3/4"	6182A	6182B
1980-88 Chevelle, El Camino, Malibu, Monte Carlo	M10 x 1.5	3/4"	6180A	6180B
1975-79 Corvette	3/8"-16	3/4"	6178A	6178B
1980-82 Corvette	M10 x 1.5	3/4"	6177A	6177B
1980-81 Firebird & TransAm 267 (VIN J), 305 (VIN H)	M10 x 1.5	3/4"	6179A	6179B
1978-79 Grand Prix, 305, 350 only	3/8"-16	3/4"	6181A	6181B
1980-81 Grand Prix all V8's (1980-81 305, 350 only)	3/8"-16	3/4"	6182A	6182B
1980-81 Grand Prix all V8s (1980-81 305, 350 only)	M10 x 1.5	3/4"	6180A	6180B
Universal fit pump, keyed shaft, 1200 PSI, 5/8"-18 SAE fittings	3/8"-16	5/8"	6176A	6176B
Universal fit pump, keyed shaft, 850 PSI, 5/8"-18 SAE fittings	3/8"-16	5/8"	6174A	6174B
Universal fit pump, press-fit, 1200 PSI, 5/8"-18 SAE fittings -NEW	3/8"-16	3/4"	6188A	6188B

6176 Pumps are also available in yellow, orange, red or blue powder coated finish

3/4" shafts require a press-fit pulley, 5/8" shafts have a keyway for a bolt-on pulley, pulley not included

**OUR CHROME WILL
GET YOU HOME!**



EARLY STYLE SAGINAW

POWER STEERING PUMPS

NEW old-style reservoir design

In stock and ready to ship!



**Quality
made in USA!**

- Direct fit applications include early GM muscle cars and hot rod applications
- Reservoir is made from 20 gauge cold-rolled steel and furnace brazed for premium quality
- Pumps feature all new components including reservoir and pump assembly
- 5/8" Shafts have a keyway for use with a bolt-on pulley - pulley not included
- 1200 PSI rated to work with most gearbox systems; 850 PSI available for Mustang II rack and pinion upon request



EARLY STYLE SAGINAW POWER STEERING PUMPS



6190A



6191A



6192A



6193A

- Direct fit applications cover early GM muscle cars and hot rod applications
- All new components including reservoir and pump assembly
- Pumps have a 5/8" keyed shaft for use with a bolt-on pulley - not included
- Factory 5/8"-18 pressure port - specific pumps include an AN-6 port adapter
- Includes a billet style chrome plated cap and dipstick



6194A



6195A

Applications	Chrome	Black
Chevrolet full size cars, 1961-66 V8	6190A	6190B
Chevrolet cars and light trucks 1961-69	6198A	6198B
Chevrolet 1969 V8	6194A	6194B
Chevrolet 1970 V8	6193A	6193B
Chevrolet Camaro 1967-68 V8, Chevy II 1968 V8	6197A	6197B
Chevrolet Camaro, Chevelle & Nova, 1969 V8	6195A	6195B
Chevrolet Camaro and Nova, 1969 V8	6191A	6191B
Chevrolet Corvette 1966-74, AMC 1968-74, Jeep 1972-74	6196A	6196B
Chevrolet Vega 1971-74 and Buick 1969-72	6192A	6192B



6196A



6197A



6198A

**OUR CHROME WILL
GET YOU HOME!**

Power Steering Pumps



DIRECT FIT SAGINAW STYLE POWER STEERING PUMPS

GM Saginaw style pump features all new components including reservoir and pump assembly. Includes billet chrome cap, new dipstick and hardware. Specific pumps include an AN-6 fitting. Press fit shafts are 3/4" diameter and requires a press fit pulley. 5/8" keyed shafts require a bolt-on pulley; pulley not included. A pulley installation kit is included with 3/4" press-fit pumps. 1200 PSI rated to work with most gearbox systems, 850 PSI available for Mustang II rack and pinion upon request.

Application	Shaft	Mounting	Chrome	S Black
1968-74 AMC, 1972-74 Jeep	<NEW 5/8" keyed	3/8"-16	6196A	6196B
1961-66 Chevrolet V8 full size cars	<NEW 5/8" keyed	3/8"-16	6190A	6190B
1961-69 Chevrolet cars and light trucks	<NEW 5/8" keyed	3/8"-16	6198A	6198B
1966-74 Chevrolet Corvette	<NEW 5/8" keyed	3/8"-16	6196A	6196B
1968 Camaro V8 & 1967-68 V8 Chevy II	<NEW 5/8" keyed	3/8"-16	6197A	6197B
1969 Camaro & Nova V8	<NEW 5/8" keyed	3/8"-16	6191A	6191B
1969 Camaro, Chevelle & Nova V8	<NEW 5/8" keyed	3/8"-16	6195A	6195B
1969 Chevrolet V8	<NEW 5/8" keyed	3/8"-16	6194A	6194B
1970 Chevrolet V8	<NEW 5/8" keyed	3/8"-16	6193A	6193B
1970-74 Camaro, Chevelle, El Camino V8	5/8" keyed	3/8"-16	6183A	6183B
1970-74 Malibu, Monte Carlo V8	5/8" keyed	3/8"-16	6183A	6183B
1971-74 Vega and 1969-72 Buick	<NEW 5/8" keyed	3/8"-16	6192A	6192B
1975-79 Corvette	3/4" press fit	3/8"-16	6178A	6178B
1978-79 Chevelle, El Camino	3/4" press fit	3/8"-16	6181A	6181B
1978-79 Malibu, Monte Carlo V8	3/4" press fit	3/8"-16	6181A	6181B
1978-79 Grand Prix, 305, 350 only	3/4" press fit	3/8"-16	6181A	6181B
1979 Camaro, Firebird, TransAm, all V8	3/4" press fit	3/8"-16	6181A	6181B
1980-81 Camaro 267, 305 (VIN H), 350 (VIN L)	3/4" press fit	M10 x 1.5	6179A	6179B
1980-81 Firebird & TransAm 267 (VIN J), 305 (VIN H)	3/4" press fit	M10 x 1.5	6179A	6179B
1980-81 Grand Prix all V8s (1980-81 305,350 only)	3/4" press fit	M10 x 1.5	6180A	6180B
1980-81 Grand Prix all V8's (1980-81 305, 350 only)	3/4" press fit	3/8"-16	6182A	6182B
1980-82 Corvette	3/4" press fit	M10 x 1.5	6177A	6177B
1980-88 Chevelle, El Camino, Malibu, Monte Carlo	3/4" press fit	3/8"-16	6182A	6182B
1980-88 Chevelle, El Camino, Malibu, Monte Carlo	3/4" press fit	M10 x 1.5	6180A	6180B
1982-87 Camaro, Firebird, TransAm, all V8	3/4" press fit	M10 x 1.5	6179A	6179B
1988-92 Camaro, Firebird, TransAm, all V8	3/4" press fit	M10 x 1.5	6184A	6184B

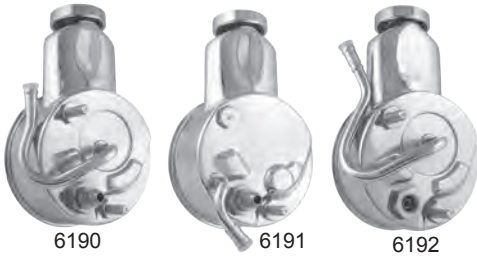

6190 6191 6192



6193 6194 6195

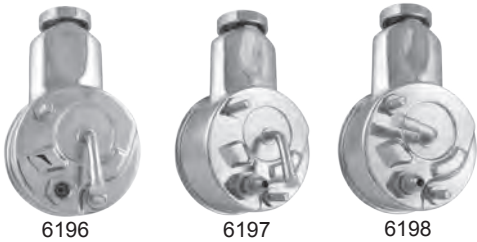

6196 6197 6198



6177 / 6178 6179 6180 6181 6182 6183 6184

UNIVERSAL FIT SAGINAW STYLE POWER STEERING PUMPS

Same features and benefits as the above pumps.

Pumps use 5/8-18 SAE pressure fittings and have 3/8"-16 mounting holes/studs. Pulley not included.

Pressure	1200 PSI	850 PSI	1200 PSI
Shaft	5/8" Keyed	5/8" Keyed	3/4" Press-fit
Chrome	6176A	6174A	6188A
Stealth black	6176B	6174B	6188B
Yellow	6176BYELLOW		
Orange	6176BORANGE		
Red	6176BRED		
Blue	6176BLUE		
Pump only, does not include reservoir			6188



6174 / 6176 / 6188

POWER STEERING PUMP CANS / RESERVOIRS

Replace your damaged Saginaw style Tuff Stuff reservoir instead of replacing the complete pump.

Fits Tuff Stuff 6174 & 6176 pumps w/tube on left, SAE

Chrome	6501A
Stealth black	6501B
Raw	6501C

Fits Tuff Stuff 6177 & 6178 pumps w/center tube

Chrome	6502A
Stealth black	6502B
Raw	6502C



6501 6502

**Premium
Quality**

Power Steering Parts

POWER STEERING PUMP BRACKETS

Bracket kits for Saginaw style pumps are laser cut from 1/4" plate steel. Eliminates the hassle of adapting stock mounting brackets. Chrome plated or 5 powder coated colors. Fits all Tuff Stuff Saginaw pumps except 6179, 6180 & 6181. Pump not included with bracket kit.

	Small Block Chevy		Big Block Chevy	
Water pump	Short	Long	Short	Long
Chrome	6504A	6508A	6503A	6507A
Stealth black	6504B	6508B	6503B	6507B
Yellow	6504BYELLOW	6508BYELLOW	6503BYELLOW	6507BYELLOW
Orange	6504BORANGE	6508BORANGE	6503BORANGE	6507BORANGE
Red	6504BRED	6508BRED	6503BRED	6507BRED
Blue	6504BBLUE	6508BBLUE	6503BBLUE	6507BBLUE

6504 Kits will NOT fit 1964-68 Chevelle, Malibu and El Camino due to steering linkage interference

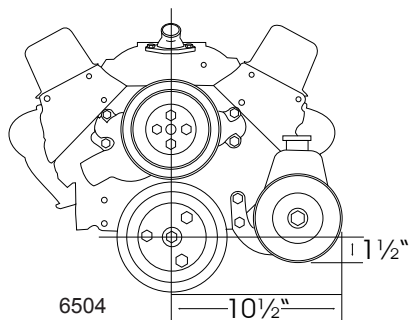

6504

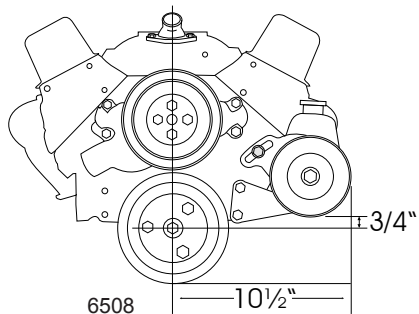

6508

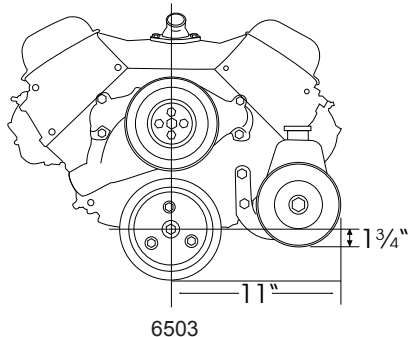

6503

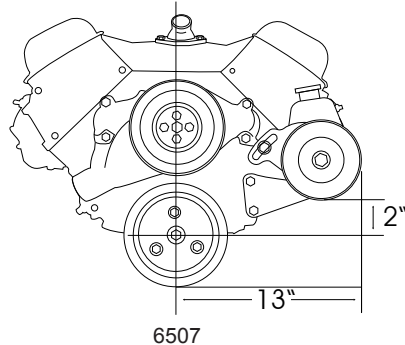

6507

**Top Quality
100% New
Built in
USA!**



6503A



6504A



6507A, 6508A

ADAPTER FITTING FOR SAGINAW STYLE PUMPS

Adapts 5/8"-18 inverted flare to 9/16"-18 AN-6. This is the same fitting that is included in certain Saginaw style power steering pumps.

Fitting sold individually.

Finish	Item
Chrome	5553A
Plain	5553

←NEW



LOW PRESSURE VALVE FOR SAGINAW PUMPS 850PSI

Low pressure valve for Saginaw pumps lowers the pressure to 850PSI for use with Mustang II style rack and pinion steering systems

Fits Saginaw style power steering pumps

850PSI VALVE



POWER STEERING PUMP PULLEY - BOLT-ON

Fits Tuff Stuff 6174, 6176 and 6183 power steering pumps with keyed shaft. Includes flat washer.

Finish	Item
Chrome	8488A
Polished	8488B
Plain	8488C



BILLET STYLE ALUMINUM POWER STEERING CAP & DIPSTICK

Fits all Tuff Stuff Saginaw style power steering pumps. Will not fit Type II pumps

Finish	Item
Chrome	6500A
Polished	6500B

