

TRUXPORT®

Another Fine Tonneau Cover by TruXedo

Owners & Installation Manual

READ INSTRUCTIONS - Failure to assemble cover properly will void warranty.



Specify length or make and model of vehicle to inquire about headers, cover, side rails, or bows.

Tools Required:
1/2" Socket

1 Install weather seal on cab end corner plugs:

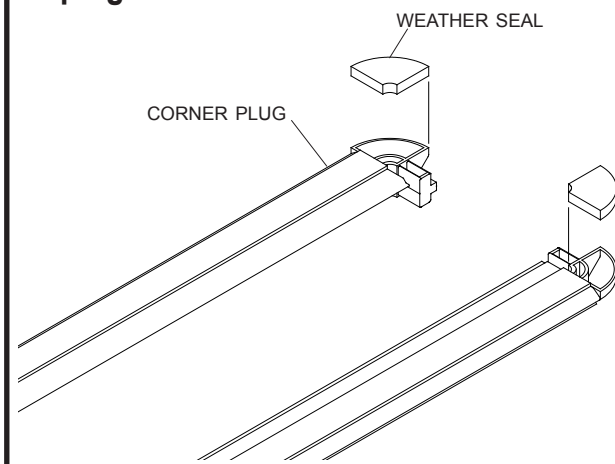

2 Set cover assembly on front bulkhead:

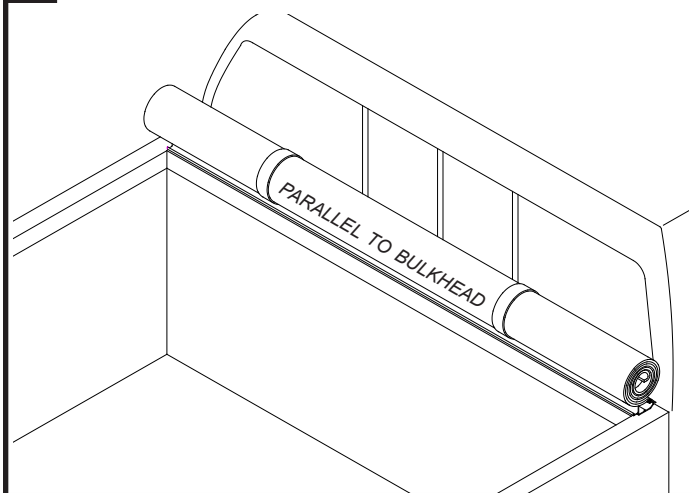

3 Place side rails on pickup bed rails. Assemble clamps. Place rear clamps loosely over side rails & pickup bed rails. Insert side rail corner plugs into header:

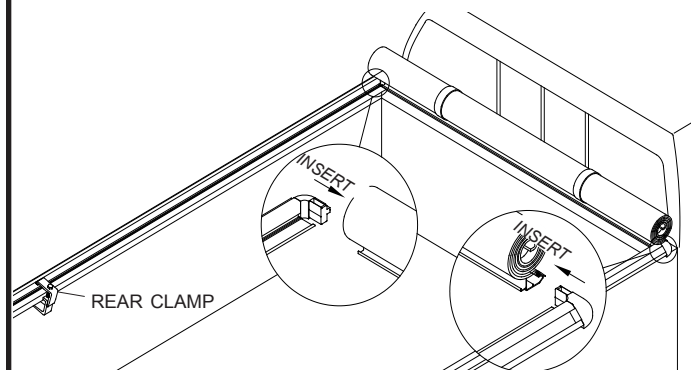

4

NOTE:

Additional weather seal may be required for pickups with bed caps, tailgate protectors, or liners. Add weather seal if needed to seal appropriately.

5 Place remaining clamps loosely over side rails & pickup bed rails:

PLACE THREE CLAMPS ON EACH SIDE RAIL TO KEEP RAILS IN PLACE

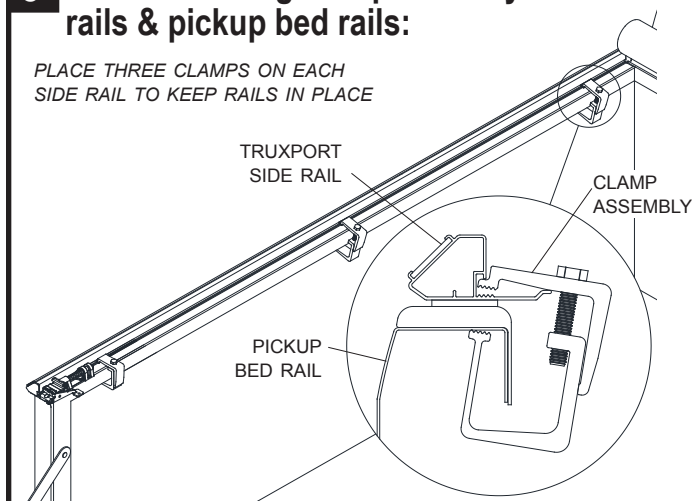

6 Align cover with pickup bed:

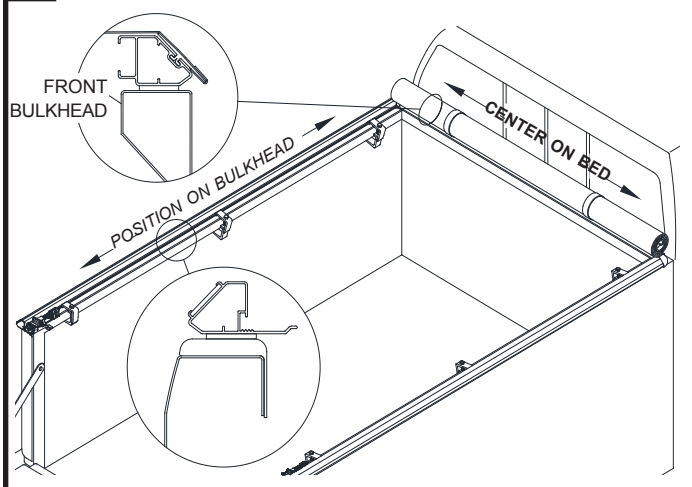

7 Tighten front clamps:

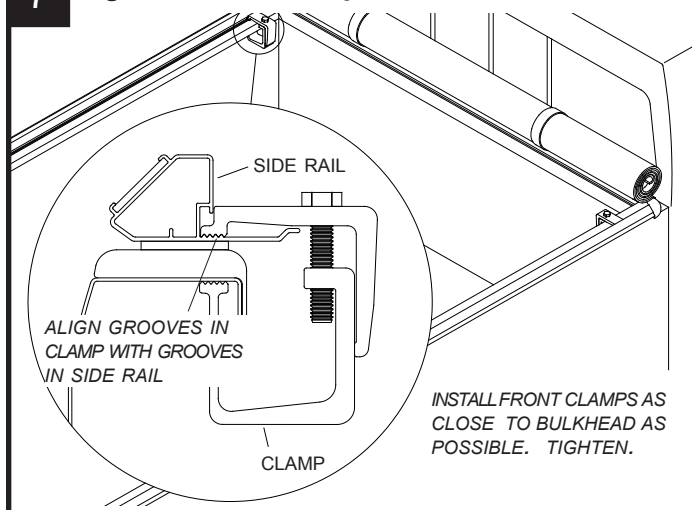

8 Center side rails on pickup bed:

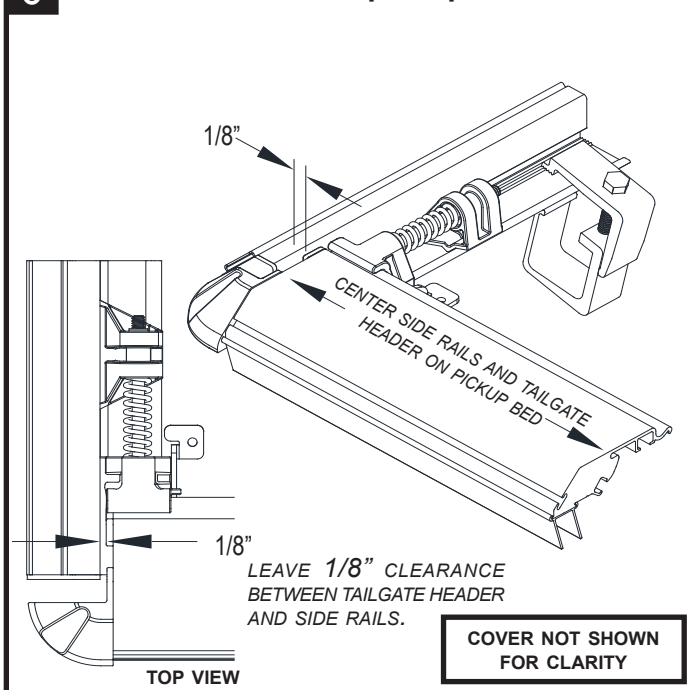

9 Tighten clamps at tailgate:

FOLD BACK HEADER AND COVER, WHILE HOLDING SIDE RAIL IN PLACE (SEE STEP 8). TIGHTEN CLAMP. REPEAT ON OPPOSITE SIDE RAIL.

CHECK AND ADJUST AS NEEDED.

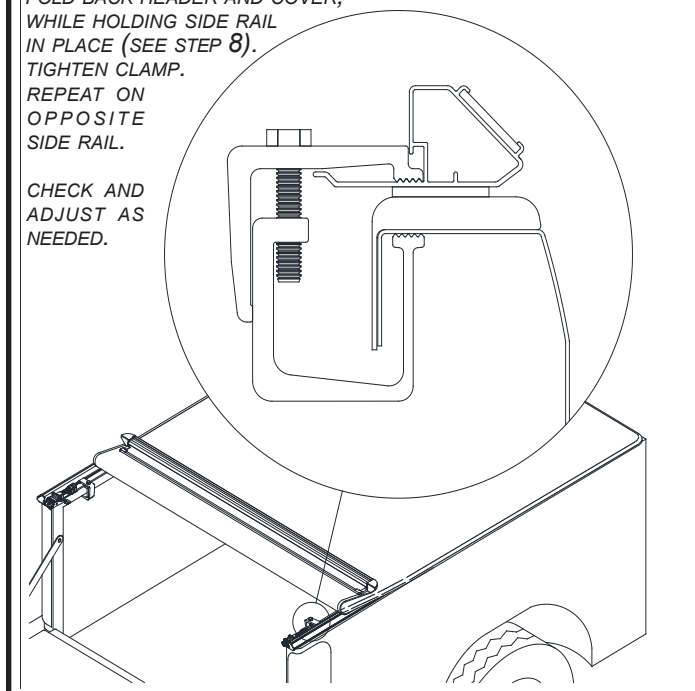

10 Tighten center clamps:

OPEN COVER PAST CENTER BOW. SLIDE CLAMPS TO TAILGATE SIDE OF BOW, THEN TIGHTEN CLAMPS.

DO NOT PLACE CLAMPS DIRECTLY UNDER CENTER BOW

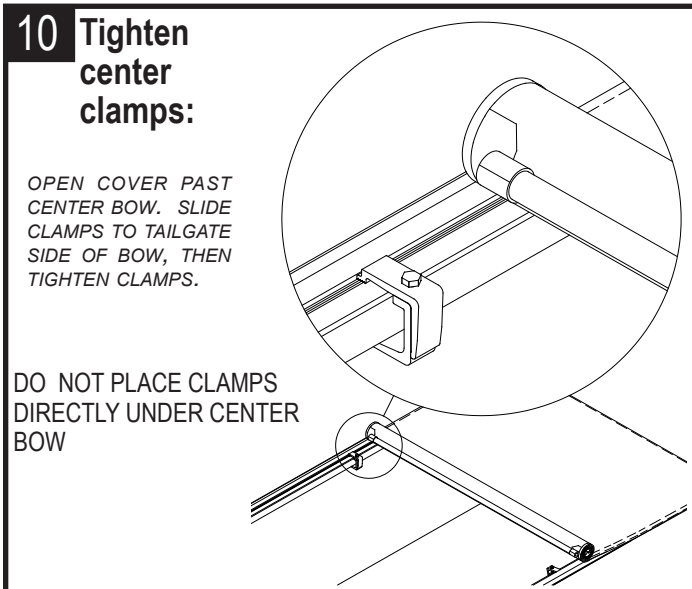

11 Install weather seal on tailgate corner plugs:

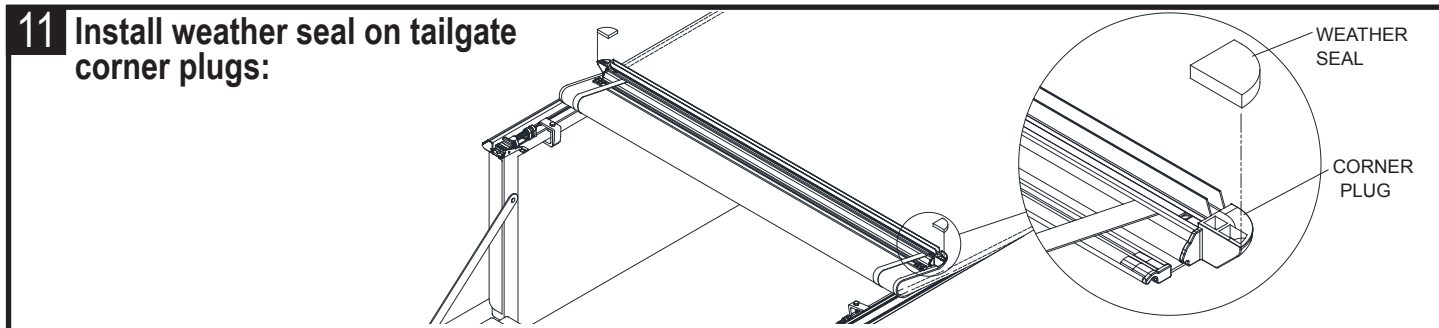

12 Close cover:

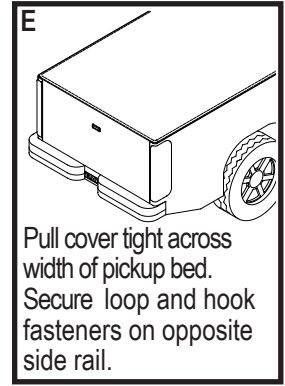
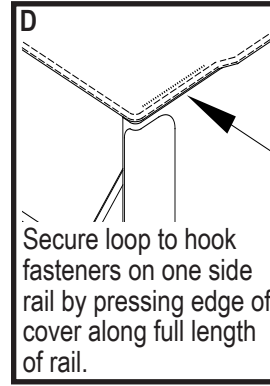
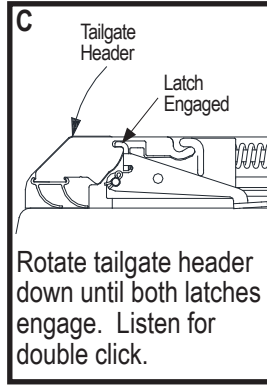
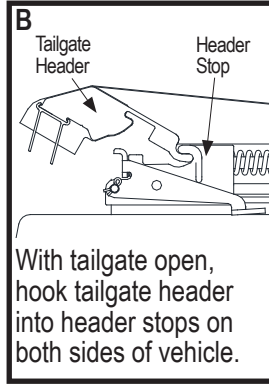

- To prevent accidental release of tailgate header, ensure header is securely latched to side rails on both sides of pickup bed before driving vehicle.
- To prevent wind lift, secure loop and hook fasteners along entire length of both side rails before driving vehicle.

13 Cover tension:

There is no need to adjust cover length tension. The Latch Assembly is set to the correct tension.
Any modification done to this will VOID warranty.

Keeping cover taut:

Periodically or as needed, pull cover tight across width of pickup bed, secure loop and hook on side rails.

For ease of operation, periodically clean with high pressure water to remove dirt and dust.

Cover may appear loose or relaxed in cooler or cold conditions.
 Cover may appear tight in warmer or hot conditions.

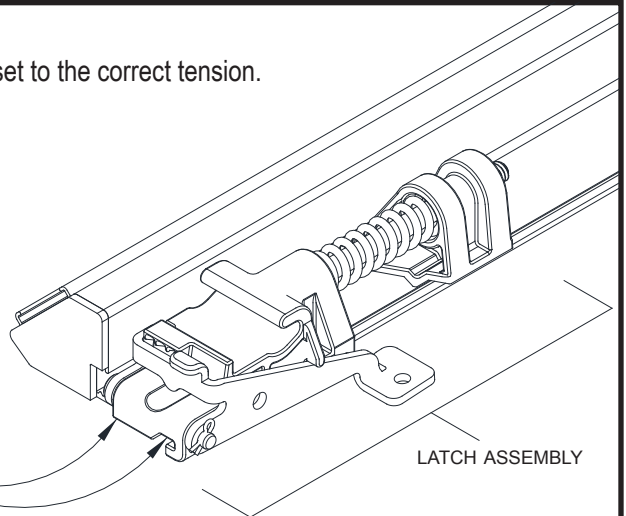

14 Open cover:

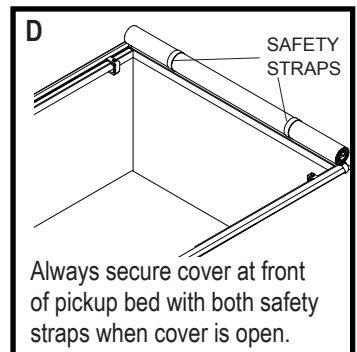
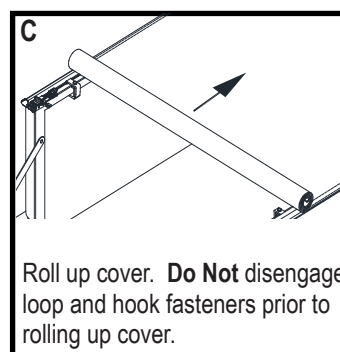
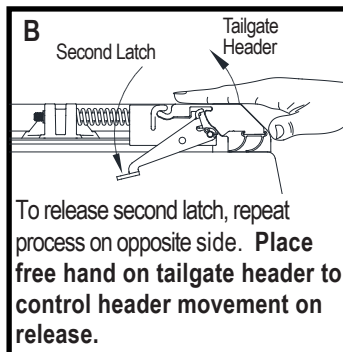
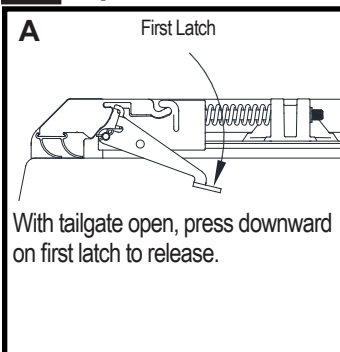

Replacement Parts

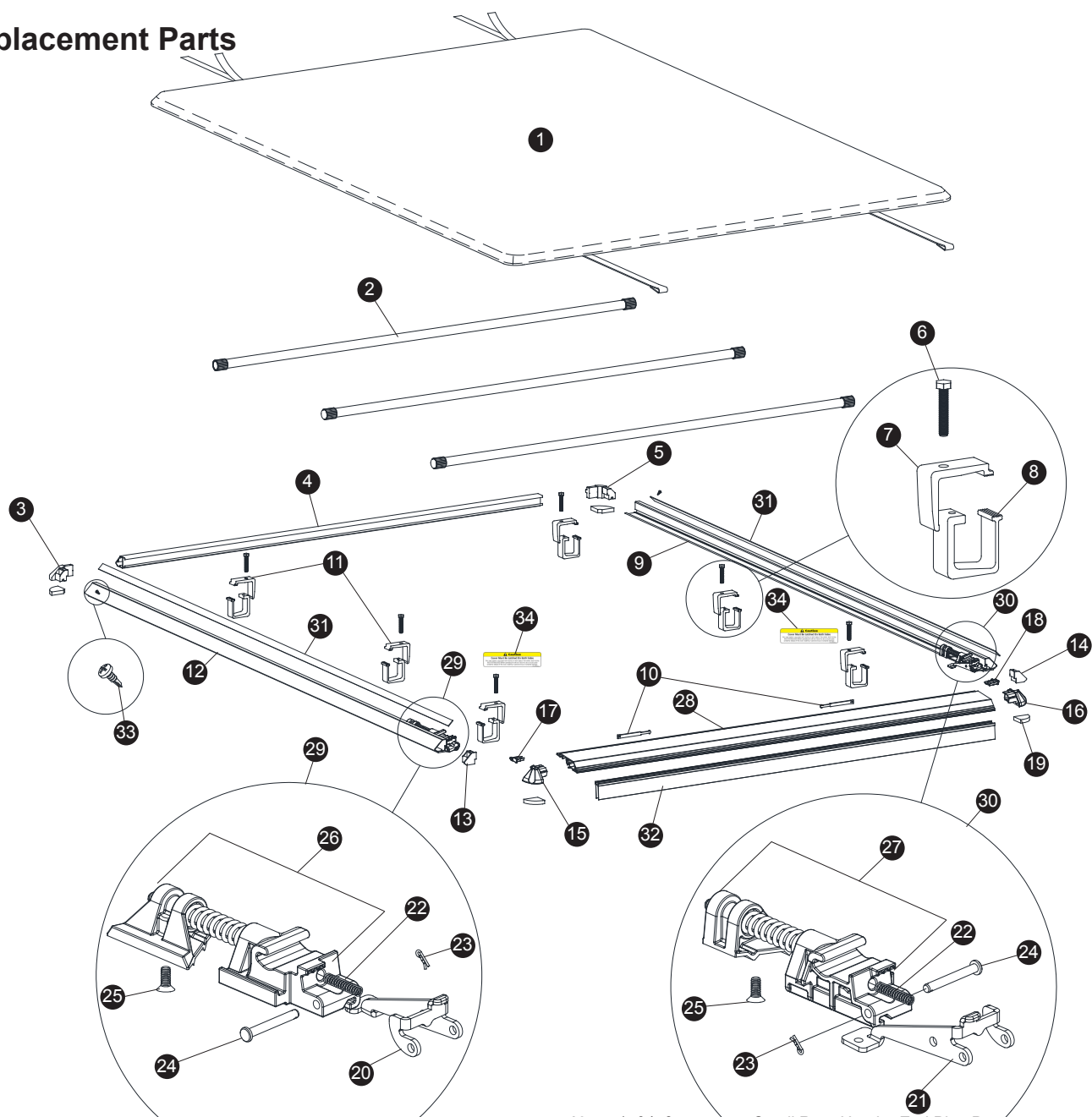

1	*	Truxport® Cover
2	*	Bow
3	1703558	Corner Plug
4	*	Cab End Header
5	1703557	Corner Plug
6	1704470	Cap Screw, 5/16" x 1 3/4"
7	1703530	Male Clamp
8	1703531	Female Clamp
9	*	Passenger's Side Rail
10	1116028	Safety Clips
11	1703561	Clamp Assembly
12	*	Driver's Side Rail
13	1703569	End Plug Driver's Side
14	1703570	End Plug Pass. Side
15	1704534	Large Rear Header End Plug Driver's
16	1704535	Large Rear Header End Plug Pass.
17	1704536	Small Rear Header End Plug Driver's

18	1704537	Small Rear Header End Plug Pass.
19	1703568	Four Corners Weather Seal
20	1704571	Latch Driver's Side
21	1704572	Latch Pass. Side
22	1704530	Compression Spring
23	1704533	Hitch Pin
24	1704532	Clevis Pin
25	1703560	Flat Head Cap Screw
26	1704562	Latch Plunger Pre-Assy Driver's Side
27	1704563	Latch Plunger Pre-Assy Pass. Side
28	*	Tailgate Header
29	1704573	Complete Latch Assy, Driver's Side
30	1704574	Complete Latch Assy, Passenger's Side
31	*	Hook Fastener
32	*	Rear Header Seal
33	1703690	Self-Drilling Screw, #6 X 3/8"
34	1703750	Decal Dual Latch

* Please specify length or make and model of vehicle.

FIVE YEAR WARRANTY

TruXedo, Inc. warrants that all new, unused products are free from defects in material and workmanship. This Five Year Limited Warranty is effective if the product is properly installed and used for the purpose intended. It applies to the original buyer only. TruXedo's obligation under this Warranty is limited to repairing, or at its option, replacing any part that is returned, transportation prepaid, to TruXedo, Inc., Yankton, South Dakota, if the product is, in our judgment, defective. All materials must be accompanied by an RMA (Returned Material Authorization) number requested by and authorized in advance of returning the materials. TruXedo, Inc. shall not be liable or responsible to supply or pay labor to replace any part found defective, nor shall it be liable for any damages of any kind or nature to person, product, or property.

There are no Warranties for used products or products that have been repaired, altered, modified, subjected to misuse, negligence, accident or ordinary wear and tear.



WARNING

Tighten clamps securely on side rails before driving vehicle, to prevent cover from blowing off.

1. Do not place objects on or against cover or framework.
2. Do not tie cargo to TruXport framework.
3. Never allow children or pets to occupy pickup box while cover is closed.
4. Cover is not airtight. Special care is required to keep cargo clean and dry.
5. Fabric cover won't prevent theft of contents inside truck box.
6. Cover must be rolled fully open and secured with safety straps when towing vehicle backwards.
7. Opened cover must be secured with both safety straps when driving vehicle.

OWNER/USER RESPONSIBILITIES

It is the responsibility of the owner/user to read this manual and comply with the operating procedures. The owner/user is also responsible for inspecting their TruXport® cover, and for having parts repaired or replaced when worn or damaged.

Failure to follow safety instructions and warning labels could result in failure of your cover system and/or personal injury.

MESSAGES TO INSTALLER

- Always wear safety glasses and/or other necessary protective equipment when installing your TruXport®.
- These instructions are complete for most pickup models. Additional instructions are included, if required for your pickup. Please read entire manual before installing your TruXport®.

COVER MAINTENANCE

Never use silicon, petroleum, or citrus based products on your tonneau cover.

Vinyl cover can be hand washed with mild soap and water or cleaned in a car wash. Thoroughly rinse cover to remove any soap residue. Cover can be treated with any vinyl protectant made for tonneau covers.

