



# Adjustable Hitch System

## Razor Hitch Installation

Slide ball mount tube into receiver box and lock securely with **TRIMAX™** receiver pin.

**A**

To unlock ball mount, insert and rotate key 1/4 turn, and pull back on lock core.

**B**

Slide ball mount onto drop bar and move to the desired height.

**C**

Once desired height is located push in locking pin and secure with key.

**D**

Secure rubber key cap tightly into place.

The key cap is used as a reminder to close lock correctly and for added safety.

**E**

## Tow Ball Installation

### Single Ball Installation:

1/2" Drive Ratchet (not included)

Single Ball, 2" & 2-5/16"

Lock Washer  
Hex Nut

### Dual Ball Installation:

1/2" Drive Ratchet (not included)

2" Ball

Lock Washer

2-5/16" Ball

Ball(s) should be installed and torqued to 250 foot pounds. Never overload your RAZOR Adjustable Towing System.

Weight tested to 10,000 Lbs. (Ball Limiting)

1/2" Drive Ratchet (not included)

**! Never Exceed Weight Limit Of Your Tow Ball !**



**DO NOT OPERATE RAZOR HITCH WITHOUT CORRECTLY AND SECURLY FASTENING PROTECTIVE RUBBER KEY COVER!**



# CAUTION! CAUTION! CAUTION! CAUTION! CAUTION! **SAFETY FIRST!!**



## Adjustable Hitch System

### Grease Reservoir

Ball(s) should be installed and **torqued to 250 foot pounds.**

After installation, fill 1/2" drive sockets with a quality bearing grease, which can be dipped out and used to grease ball surface during towing.



### Added Rise/Tow Ball Choice

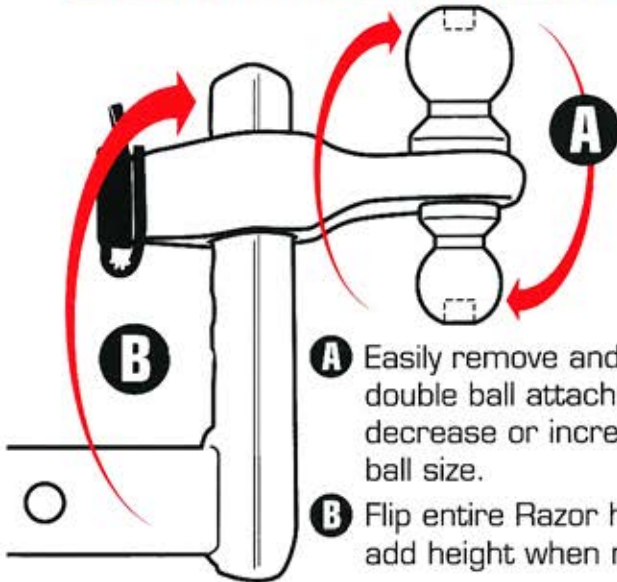

**A** Easily remove and flip double ball attachment to decrease or increase ball size.

**B** Flip entire Razor hitch to add height when needed.

### IMPORTANT CHECK LIST, Before You Drive

Make sure your vehicle and trailer maintenance are up to date before you drive. Review this easy to use check list to help ensure a safe trip every time.

- Properly secure safety chains and adjust hitch, coupler, draw bar and other equipment that connect the trailer and tow vehicle.**
- Tow ball/lug nuts/bolts on tow trailer and vehicle should be tightened to correct torque and **checked every 100 miles.**
- Check brakes on tow vehicle and trailer. These should be in good working order.
- Check tire pressure on tow trailer and vehicle before use. Correct if needed.
- Is wiring properly connected? Wiring should not touch the road but be loose enough to make turns without causing damage or plug to come disconnected.
- Are all running lights, brake lights, turn signals, and hazard lights in good working order?
- All items on and in trailer should be securely fastened.
- Trailer jack, tongue support, and any attached stabilizers should be raised and locked in place.
- Review load distribution. Make sure the tow vehicle and trailer load is properly distributed side to side and front to back.
- All mirrors should be set for good visibility.
- Review routes and restrictions on bridges and tunnels.
- Include wheel chocks and jack stands. **TRIMAX** Chock Locks #TCL65/75 are ideal for this application.

### CAUTION!!!

Never overload your RAZOR Adjustable Towing System. Weight tested to 10,000 Lbs. **NEVER EXCEED WT LIMIT OF YOUR TOW BALL.** Always use standard towing procedures and follow supplied check list.



**DO NOT USE/OPERATE RAZOR HITCH WITHOUT CORRECTLY AND SECURELY FASTENING PROTECTIVE RUBBER KEY COVER!**

