

# ENGINE SWAP KIT

**PART #4697**

B/RB into 67-72 A-Body Swap Kit W/ Slant 6

**PART #4698 B/RB A-Body Swap Kit**

B/RB into 67-72 A-Body Swap Kit W/ SB Mopar

## INSTALLATION INSTRUCTIONS

We strongly suggest that you purchase a Factory Service Manual for your car's year & model. This will be an invaluable tool for the success of your project.

**Note:** Brackets are off-set between the bracket and the insulator faces the front of the engine. The driver's side isolator may need to be trimmed to fit, refer to inset drawing below.

1. Install bracket and insulator assembly to the engine as shown. Finger-tight fasteners only, to allow greater adjustability in the leveling process, attaining the correct height, side-to-side clearance, etc. You will torque these fasteners to spec after final position has been achieved.
2. Lower engine and install (per service manual) onto K-member supports. Using a 4 ft. level across the valve covers, the engine can now be leveled in the engine compartment.  
**Note:** Please remember; your vehicle has to be on a flat and level surface to get an accurate reading. To ensure you have located the engine properly, it is helpful at this stage to bolt the transmission to the engine, and rear support cross member to the frame (per your service manual). Your new transmission will mount in the same position as the one you removed.
3. Check your engine level and install washers and nuts to the insulator stud at the K-member support. Tighten nuts to specified torque (65-75 lbs). Tighten bracket fasteners to specified torque (55 ft. Lbs).

**Note:** Every effort has been made to ensure that the engine can be installed to factory specs while allowing adjustability to level the engine in its compartment. Due to loose tolerances from the factory while building the K-member (no two K-members are exactly the same), there may be a few instances where it becomes difficult to level the engine or attain the correct height. You may need to make custom modifications for final fitment.

Your linkage, accessories and the rest of the drive train can now be installed according to your Factory Service Manual.

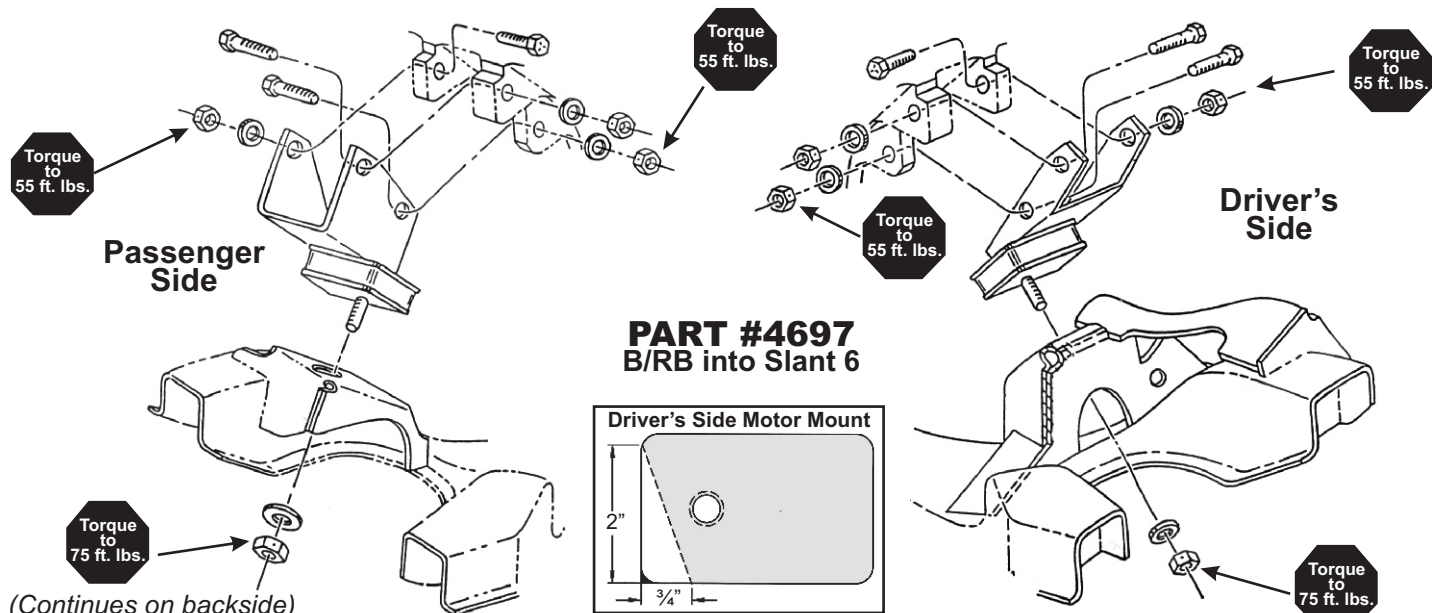
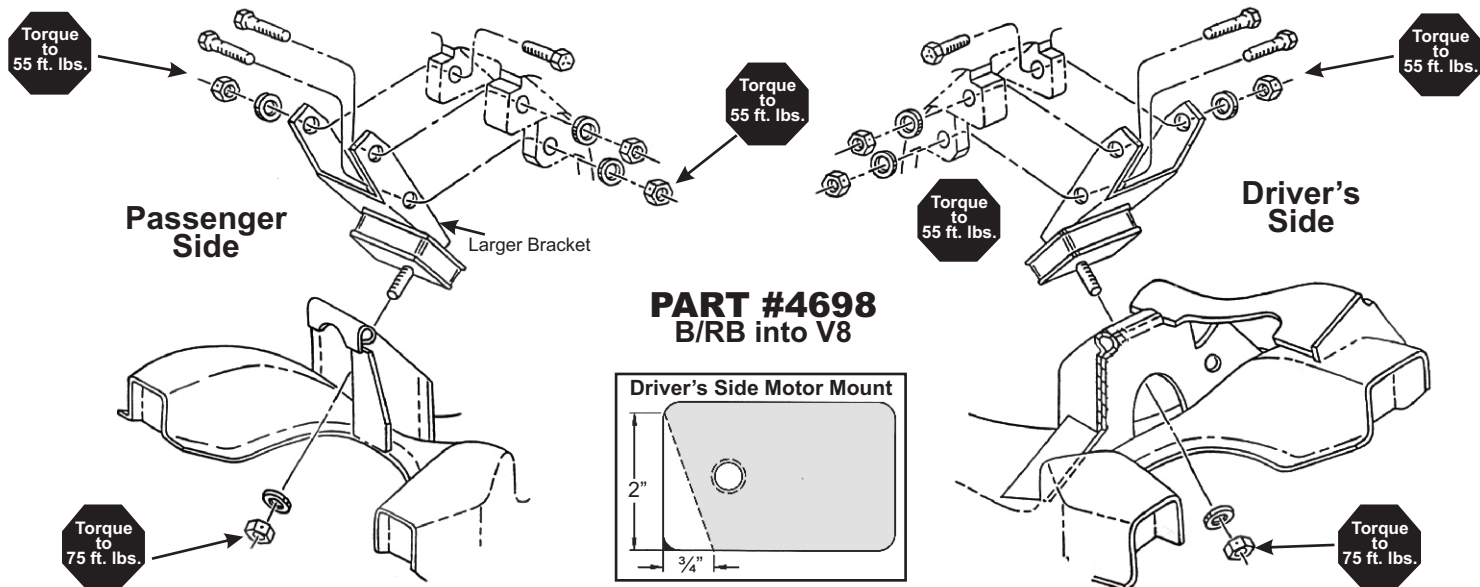

**4697 PARTS LIST**

- 1 - Pair of B/RB to V8 A-Body Mounts
- 2 - SB Mopar Rubber Mount Pads
- 6 - 7/16" flat washers
- 6 - 7/16"-14 x 2"

- 6 - 7/16"-14 Nylon Lock Nut
- 4 - 1/2" Lockwashers
- 4 - 1/2" flat washers
- 4 - 1/2" - 13 Nut

**4698 PARTS LIST**

- 1 - Pair of B/RB to Slant 6 A-Body Mounts
- 2 - SB Mopar Rubber Mount Pads
- 6 - 7/16" flat washers
- 6 - 7/16"-14 x 2"

- 6 - 7/16"-14 Nylon Lock Nut
- 4 - 1/2" Lockwashers
- 4 - 1/2" flat washers
- 4 - 1/2" - 13 Nut