



# Replacement Bumper

Part No. FX3013



Fits: 2009 - Current Ford F150



REMOVE CONTENTS FROM BOX. VERIFY ALL PARTS ARE PRESENT.



READ INSTRUCTIONS CAREFULLY BEFORE STARTING INSTALLATION.

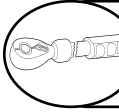

DO NOT OVER TORQUE. STANDARD OPERATING LOAD FOR TIGHTEN BODY MOUNT NUTS & BOLTS VARIES FROM 45 TO 65 FOOT POUND.



60-120 min

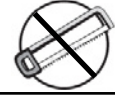

Cutting Not Required



Drilling Not Required

### PARTS LIST:

Qty	Part Description	Qty	Part Description
1	Replacement Bumper		Hardware Kit

### Tools Required

Metric and Standard socket set	Socket wrench and short extension
Various socket extensions	"Christmas tree" clip remover
3/4" box end wrench	Flat head screwdriver
Philips head screwdriver	

## INSTALLATION PROCEDURE:

### Vehicle Preparation

1. Remove the lower air dam by loosening the fastener (14mm socket) attaching it to each frame rail behind the tow hooks.
2. Remove the splash mat from the bumper by pulling out the plastic push clips.
3. If equipped, disconnect the fog lights and route the harness out of the way.
4. Open the hood and remove the lower safety latch bracket bolts that attach it to the steel portion of the OEM bumper with a 10mm socket.
5. Remove the (2) nuts from the main bumper mounting studs on each frame flange with a 21mm socket.

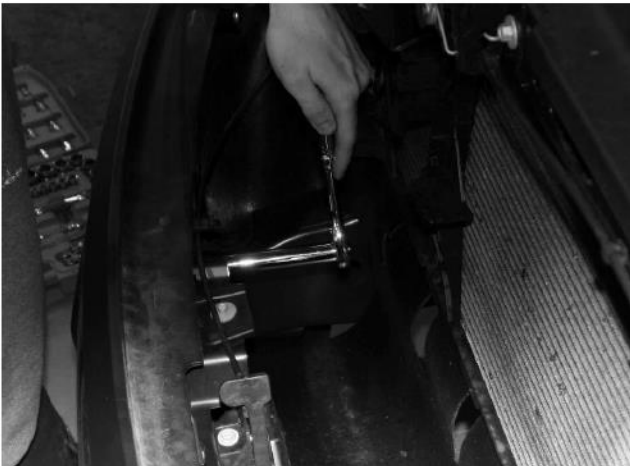

Figure 1 - HOOD LATCH BRACKET FASTENER LOCATION

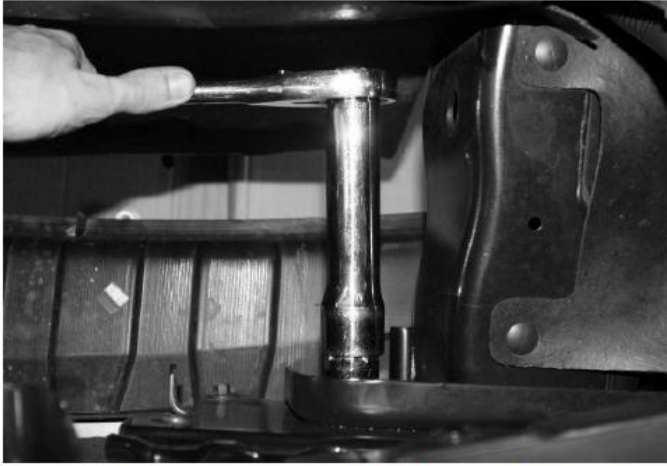
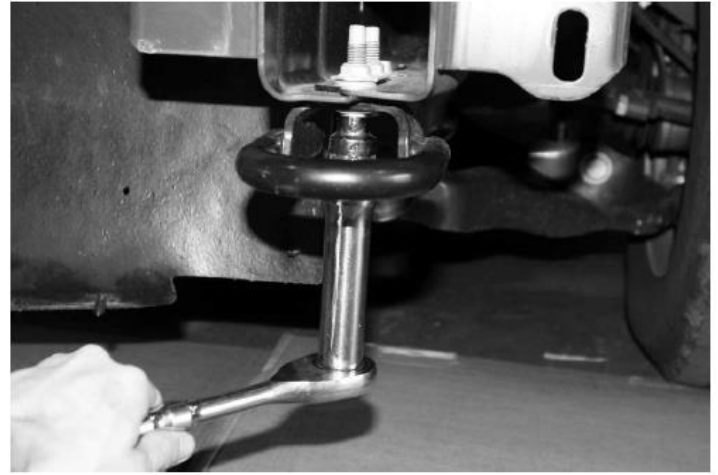

Figure 2 - BUMPER MOUNTING BOLTS (VIEW FROM TOP)



6. Using two people, pull the bumper forward away from the truck. Be careful not to scratch the paint on the plastic above the bumper.
7. If equipped, remove the factory tow hooks using a 15mm socket and set aside.

### Bumper Installation

1. If equipped, remove the fog light mounting brackets from the OEM bumper. Remove the adjuster screw and spring; save for reinstallation. Pop the fog light out of the mounting bracket by lifting the tabs at the pivot point on each side.
2. If equipped, reinstall the OEM fog light into the brackets in the TrailFX front bumper. Use the OEM adjuster screw and spring to set the position of the beam.

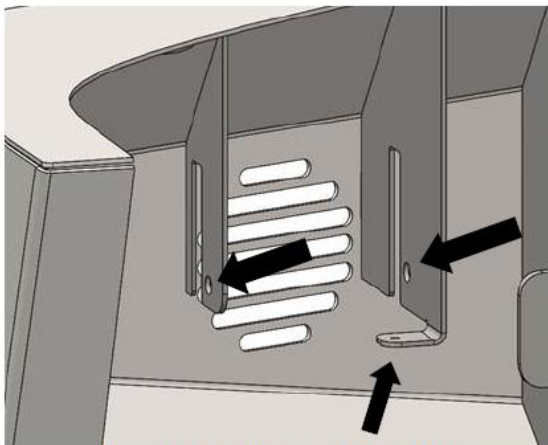
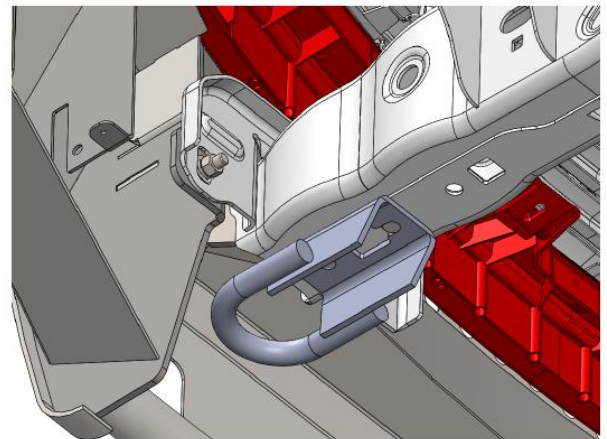

Figure 3 - FOG LIGHT INSTALLATION



3. With the assistance of a hoist or multiple assistants, lift the bumper and carefully ease the bumper mount tongues into the ends of the OEM frame rails.
4. Install the provided hardware through the two mounting ears on each side of the frame rail, making sure to use a washer under the head of each bolt, and a washer and lock washer under each nut. Do not fully tighten at this time.
5. Install the provided hardware through the two holes in the bottom of each frame rail and into the welded nuts on the tongues of the TrailFX bumper mounts. If your vehicle is equipped with tow hooks, be sure to mount them to the bottom of frame rails at this time.
6. Install the OEM hood release into the bracket on the bumper using the OEM hardware. The hood release is mounted upside-down to the bracket.
7. If equipped, reconnect the fog light wiring harness and check fog light aim.

### Maintenance/Care

- Periodically check and tighten all nuts.
- Stripped, fractured, or bent bolts or nuts need to be replaced.

## PRODUCT CARE

- Periodically check the product to ensure all fasteners are tight and components are intact.
- Regular waxing is recommended to protect the finish of the product.
- **Use ONLY Non-Abrasive automotive wax.** Use of any soap, polish or wax that contains an abrasive is detrimental and can scratch the finish leading to corrosion.
- Aluminum polish may be used to polish small scratches and scuffs for **Stainless Steel finish.**
- Mild soap may be used to clean the product for both **Stainless Steel and Black finish.**

## FAQ's

**1. Hardware's are not of correct size.**

*In GMC / Chevrolet truck model 2006 & up, customer needs to reuse the factory body bolts to install the bracket. If your vehicle is not GMC / Chevrolet 2006 & up, ensure that holes are not partially covered with any plastic grommet or rust? If it is, remove the plastic grommet & rust from the thread holes & re-try the installation.*

**2. Mounting Bracket are not getting Installed properly.**

*In some cases Illustration images shown in Installation manual may not be the exactly same as per actual vehicle images ,also if Driver / Passenger side mounting brackets are very identical in the design, suggest referring Parts Identification guide to avoid fitment issue.*

**3. Products are thumping / rattling after installation.**

*Ensure that all required mounting brackets / hardware's are installed & tighten correctly. Suggest using white lithium / regular grease between the metal to metal contact surfaces.*

**4. Side Bar is not aligning with vehicle / Step Pads are not aligning with vehicle doors.**

*Side bar may be interchanged or mounting brackets are not installed at the correct position in the vehicle. Refer Parts identification guide.*

**5. Missing / Excess Hardware.**

*Recheck hardware count as per the part list.*

**6. Product not installing properly.**

*Ensure make model year, cab length and bed size of your vehicle is listed in the application. All installation steps are followed correctly.*