



Replacement Bumper

Part No. FX3008



Fits: 2010 - Current Dodge Ram 2500 / 3500 HD



REMOVE CONTENTS FROM BOX. VERIFY ALL PARTS ARE PRESENT.



READ INSTRUCTIONS CAREFULLY BEFORE STARTING INSTALLATION.

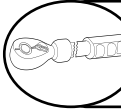

DO NOT OVER TORQUE. STANDARD OPERATING LOAD FOR TIGHTEN BODY MOUNT NUTS & BOLTS VARIES FROM 45 TO 65 FOOT POUND.



60-120 min

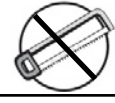

Cutting Not Required



Drilling Not Required

PARTS LIST:

Qty	Part Description	Qty	Part Description
1	Replacement Bumper		

Tools Required

10mm Wrench	24mm Socket
13mm Wrench	3/4"mm Socket
18mm Wrench	Socket wrench and short extension
3/4" Wrench	Test Light
18mm Socket	Assorted General Tools

INSTALLATION PROCEDURE:

Vehicle Preparation

1. Disconnect the Fog Light harness on the driver side of the OEM bumper.
2. Open Hood and Remove "Heavy Duty" Dust Shield.
3. Remove the OEM lower air Dam by popping out the plastic clips.

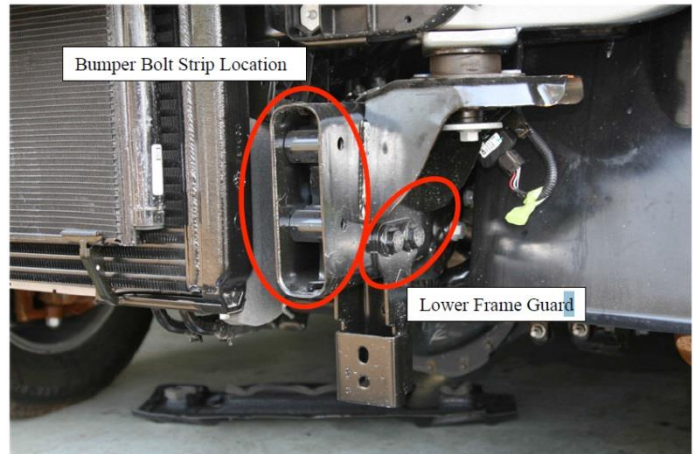

4. Diesel Models Only: Remove the 10mm bolts holding the top of the intercooler to the radiator support.
5. Remove four 18mm nuts and two bolt strip holding the OEM bumper to the frame rails. Diesel Only: Move on sid of the intercooler at a time to remove the bolt strips BE CAREFUL NOT TO DAMAGE THE INTERCOOLER FINS.

6. Remove the OEM Bumper and set aside.
7. Remove the OEM Tow Hooks from the bumper and keep hardware ready for reinstallation into the New Bumper.
8. Re-install the two bolts holding the top of the intercooler to the radiator supports.
9. Remove the Lower Frame Guards from using a 24mm socket and wrench.

Bumper Installation

1. Remove the Bumper from the shipping carton. Lay all items out on a blanket to prevent damage to the powder coating.
2. OPTIONAL: If you wish to retain the stock fog lamps, remove the lights from the stock bumper and reinstall using OEM hardware in the provided brackets behind the protective mesh. It may be necessary to remove the adjuster screw prior to installation. With the fog light clipped in the bracket, reinstall the adjuster screw to clamp the light in place.
3. Lift bumper and align mounting Holes with the mating on the side of the Frame. Install OEM Bolt Strip though the Bumper Mount and Into Frame. Do not install the nuts. It may be helpful to support bumper with a floor jack(s) during install. Repeat for other side

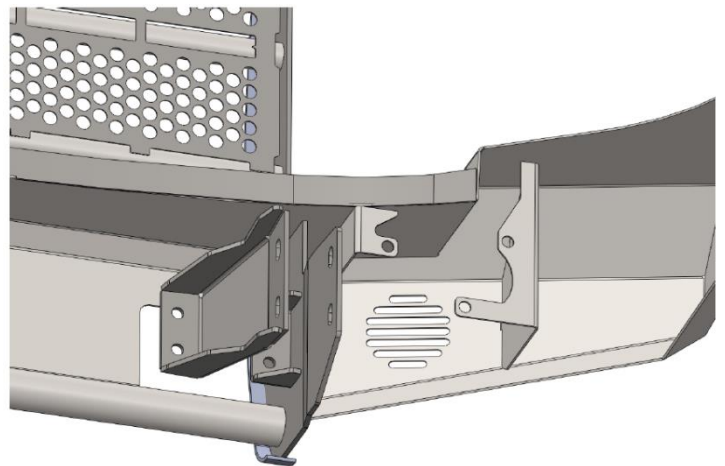
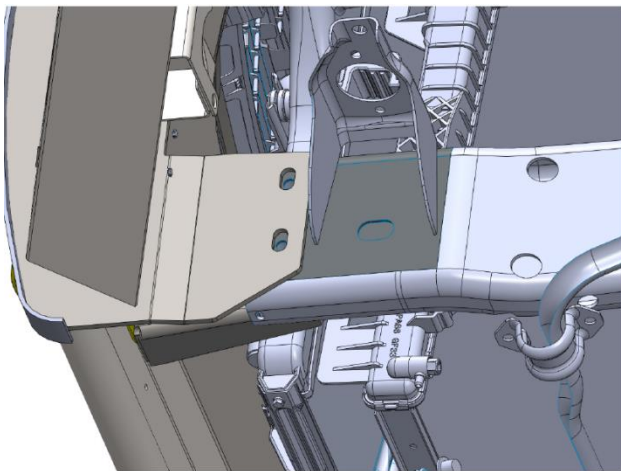

4. Install the Inside Tow Hook Brackets to the inside of the frame onto the OEM Bolt Strips inserted in the previous step, as Shown Below.
5. Install the OEM Two Hooks (Using the OEM Hardware) into the Brackets on the inside of the bumper and the brackets installed in the previous step.

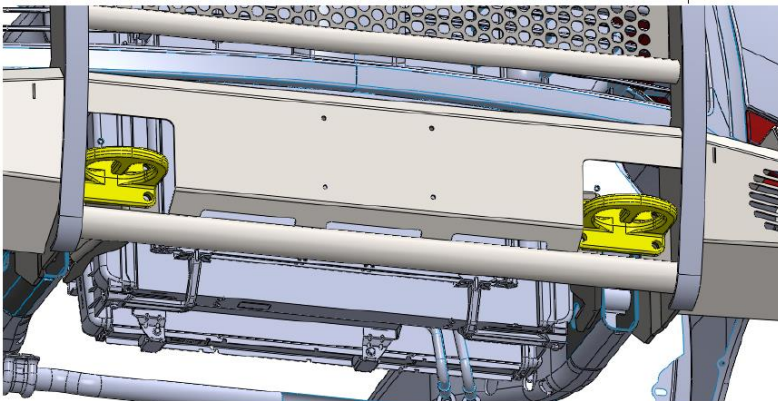

6. Tighten all fasteners; beginning at the frame. Then tighten all Tow Hook Fasteners.
7. Trim inner-fender liners to match bumper if desired.

PRODUCT CARE

- Periodically check the product to ensure all fasteners are tight and components are intact.
- Regular waxing is recommended to protect the finish of the product.
- **Use ONLY Non-Abrasive automotive wax.** Use of any soap, polish or wax that contains an abrasive is detrimental and can scratch the finish leading to corrosion.
- Aluminum polish may be used to polish small scratches and scuffs for **Stainless Steel finish.**
- Mild soap may be used to clean the product for both **Stainless Steel and Black finish.**

FAQ's

1. Hardware's are not of correct size.

In GMC / Chevrolet truck model 2006 & up, customer needs to reuse the factory body bolts to install the bracket. If your vehicle is not GMC / Chevrolet 2006 & up, ensure that holes are not partially covered with any plastic grommet or rust? If it is, remove the plastic grommet & rust from the thread holes & re-try the installation.

2. Mounting Bracket are not getting Installed properly.

In some cases Illustration images shown in Installation manual may not be the exactly same as per actual vehicle images ,also if Driver / Passenger side mounting brackets are very identical in the design, suggest referring Parts Identification guide to avoid fitment issue.

3. Products are thumping / rattling after installation.

Ensure that all required mounting brackets / hardware's are installed & tighten correctly. Suggest using white lithium / regular grease between the metal to metal contact surfaces.

4. Side Bar is not aligning with vehicle / Step Pads are not aligning with vehicle doors.

Side bar may be interchanged or mounting brackets are not installed at the correct position in the vehicle. Refer Parts identification guide.

5. Missing / Excess Hardware.

Recheck hardware count as per the part list.

6. Product not installing properly.

Ensure make model year, cab length and bed size of your vehicle is listed in the application. All installation steps are followed correctly.