

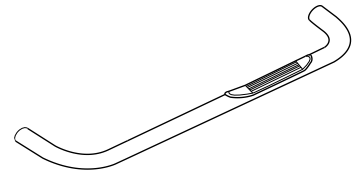

# 3" Side Bar

## Part No. 1160630971/3



Fits: 1997-2006

Jeep Wrangler



30-60 min

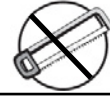

Cutting Not Required



Drilling Not Required



REMOVE CONTENTS FROM BOX. VERIFY ALL PARTS ARE PRESENT.



READ INSTRUCTIONS CAREFULLY BEFORE STARTING INSTALLATION.

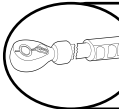

DO NOT OVER TORQUE. STANDARD OPERATING LOAD FOR TIGHTEN BODY MOUNT NUTS & BOLTS VARIES FROM 45 TO 65 FOOT POUND.

### PARTS LIST:

Qty	Part Description	Qty	Part Description
1 Set	Side Bar	10	1/2" Flat Washer
1 Set	Front Bracket	6	1/2" Lock Washer
1 Set	Rear Bracket (4pieces)	4	1/2"-13 Hex Nut
2	1/2"-13 x 1 1/2" Allen Head Bolt	6	1/2"-13 x 1 1/2" Hex Head Bolt

DRIVER FRONT (LEFT)	DRIVER REAR (LEFT)	PASSENGER REAR (RIGHT)	PASSENGER FRONT (RIGHT)

### INSTALLATION PROCEDURE

**⚠ IMPORTANT:** A magnetic pick up tool is recommended to assist with the installation.

1. Remove the end caps on the side bars before beginning installation.
2. Attach the front mounting bracket to the side bar using 1/2" x 1 1/2" hex head bolt. Do not tighten. (See Fig 1, 2, 3, 4).
3. Attach the assembly to the side bar using 1/2" x 1 1/2" flat head bolt. Position this bracket vertically to the side bar (see illustration) then fasten. Now attach the rear mounting bracket to the assembly bracket using the two 1/2" x 1 1/2" hex head bolts, 1/2" lock washers, 1/2" flat washers, and 1/2" hex nuts. Do not tighten. (See Fig5,6,7).
4. Locate and remove the two millimeter existing bolts under the chassis. Attach the front mounting bracket using these two existing bolts.
5. At the rear of the frame, There are two rear brackets on one side, please use two 1/2" x 1 1/2" hex bolts, two 1/2" hex nut and washers to connect the two brackets. Remove the body mount bolt, position the rear mounting bracket and reinstall the body mount bolt on the frame, and then attached the side bar to the brackets with 1/2" x 1 1/2" Allen Head Bolt.
6. Align the side bar and tighten all bolts. Recheck bolts periodically.

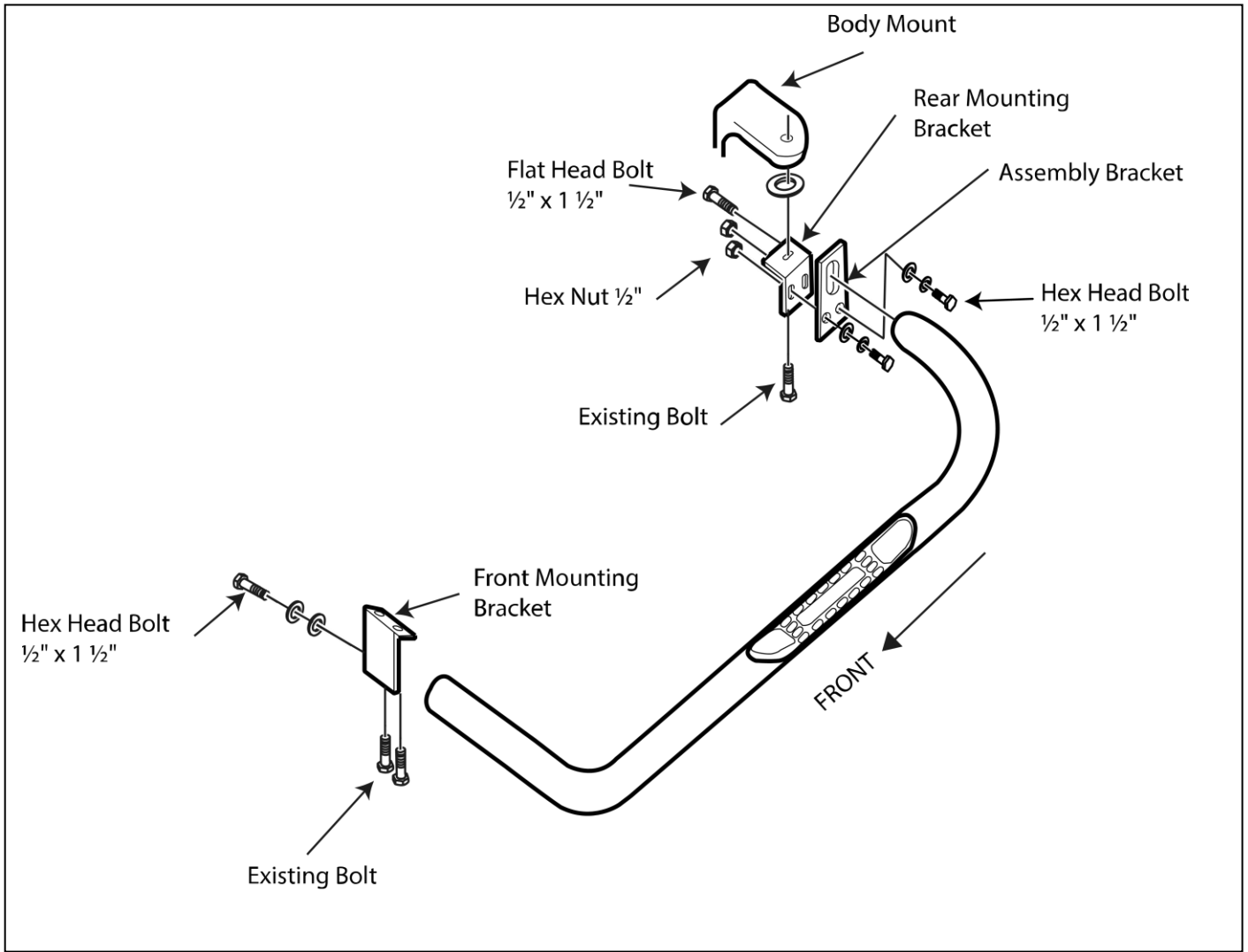

## PARTS IDENTIFICATION GUIDE

*Driver Side tube taped in "Red" Color. Passenger Side tube taped in "Blue" Color.*

No.	Parts Identification
1	Passenger / Right 'Rear' Bracket marked "RR"
2	Driver / Left 'Rear' Bracket marked "RL"
3	Passenger / Right 'Center' Bracket marked "CR"
4	Driver / Left 'Center' Bracket marked "CL"
5	Passenger / Right 'Front' Bracket marked "FR"
6	Driver / Left 'Front' Bracket marked "FL"
7	'Left' marked "L"
8	'Right' marked "R"

- Note:**
- This guide is to identify the parts and not a reference for part count.
  - Product / Bracket image is for representative purpose only.
  - Actual design may vary based on application.
  - Refer Parts List for Hardware.

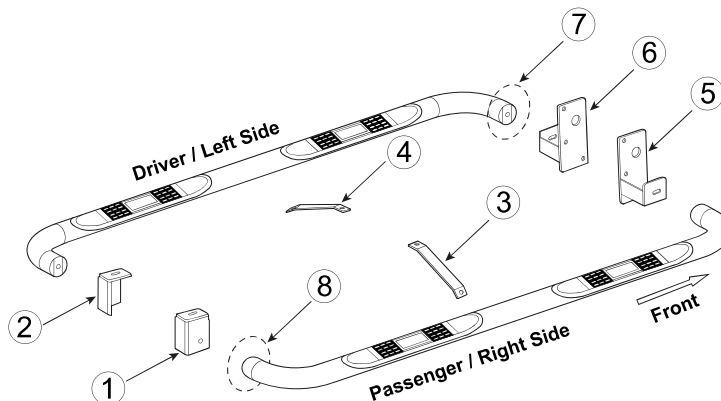

## PRODUCT CARE

- Periodically check the product to ensure all fasteners are tight and components are intact.
- Regular waxing is recommended to protect the finish of the product.
- **Use ONLY Non-Abrasive automotive wax.** Use of any soap, polish or wax that contains an abrasive is detrimental and can scratch the finish leading to corrosion.
- Aluminum polish may be used to polish small scratches and scuffs for **Stainless Steel finish.**
- Mild soap may be used to clean the product for both **Stainless Steel and Black finish.**

## FAQ's

### 1. Hardware's are not of correct size.

*In GMC / Chevrolet truck model 2006 & up, customer needs to reuse the factory body bolts to install the bracket. If your vehicle is not GMC / Chevrolet 2006 & up, ensure that holes are not partially covered with any plastic grommet or rust? If it is, remove the plastic grommet & rust from the thread holes & re-try the installation.*

### 2. Mounting Bracket are not getting Installed properly.

*In some cases Illustration images shown in Installation manual may not be the exactly same as per actual vehicle images ,also if Driver / Passenger side mounting brackets are very identical in the design, suggest referring Parts Identification guide to avoid fitment issue.*

### 3. Products are thumping / rattling after installation.

*Ensure that all required mounting brackets / hardware's are installed & tighten correctly. Suggest using white lithium / regular grease between the metal to metal contact surfaces.*

### 4. Side Bar is not aligning with vehicle / Step Pads are not aligning with vehicle doors.

*Side bar may be interchanged or mounting brackets are not installed at the correct position in the vehicle. Refer Parts identification guide.*

### 5. Missing / Excess Hardware.

*Recheck hardware count as per the part list.*

### 6. Product not installing properly.

*Ensure make model year, cab length and bed size of your vehicle is listed in the application. All installation steps are followed correctly.*