

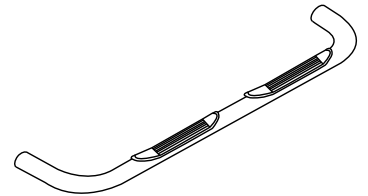

# 3" Side Bar

Part No.1160620011/3



Fits: 2001-2007

Jeep Liberty (without mudflaps)



CAN'T FIT IN JEEP LIBERTY (2005-2007) WITH BIG ROCKER MOLDING



REMOVE CONTENTS FROM BOX. VERIFY ALL PARTS ARE PRESENT.



READ INSTRUCTIONS CAREFULLY BEFORE STARTING INSTALLATION.

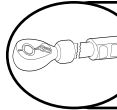

DO NOT OVER TORQUE. STANDARD OPERATING LOAD FOR TIGHTEN BODY MOUNT NUTS & BOLTS VARIES FROM 45 TO 65 FOOT POUND.



30-60 min



Cutting Not Required



Drilling Not Required

### PARTS LIST:

Qty	Part Description	Qty	Part Description
1 Set	Side Bar	8	3/8" Internal Tooth Lock Washer
1 Set	Front Bracket	8	1/2" Flat Washer
1 Set	Rear Bracket	8	1/2" Lock Washer
6	1/2"-13 x 1 1/2" "T" Bolt plate	6	1/2"-13 Hex Nut
8	3/8"-16 x 1" Button Head Bolt	2	5/8" Flat Washer
6	3/8" Plastic Washer	2	M12-1.75 Hex Nut

DRIVER (LEFT) FRONT	DRIVER (LEFT) REAR	PASSENGER (RIGHT) REAR	PASSENGER (RIGHT) FRONT

### INSTALLATION PROCEDURE

**⚠ IMPORTANT:** A magnetic pick up tool is recommended to assist with the installation.

1. Remove the end caps on the side bars before beginning installation.
2. Determine the driver's side front and rear brackets. Locate the mounting holes on the frame for the front and rear brackets (refer to Fig1, Fig2). For the rear mount location, insert (1) bolt plate through large hole on bottom of frame into the small hole on side of frame. For the front mount location, insert (2) bolt plates through large hole so that they protrude through smaller holes adjacent (refer to Fig3, Fig4).
3. Position driver rear bracket in place with 5/8" flat washer above bracket as a spacer. Fasten to 12mm stud with M12-1.75 hex nut, and to 1/2" bolt plate using 1/2" hex nut. Also, use 1/2" flat washer and 1/2" lock washer with each one. Leave assembly loose. (Refer to Fig5, Fig6, and Fig7).
4. Position driver front bracket in place and fasten to the bolt plates using 1/2" flat washers, 1/2" lock washers, and 1/2" hex nuts. Leave assembly loose. (refer to Fig8, Fig9)
5. Attach driver's side tube to the brackets with the bent leg on the front side of the vehicle and fasten to brackets using 3/8" button head cap screws and 3/8" internal tooth lock washers. Leave assembly loose. (Refer to illustration1).
6. Align the side bar and tighten all bolts. Torque 1/2" fasteners to 65 ft. lbs., 12mm fasteners to 60 ft. lbs., and 3/8" fasteners to 25 ft. lbs. Recheck bolts periodically.

7. Repeat process on passenger's side. **Note:** *Passenger's and driver's side rear brackets mount to frame differently*  
**Refer to illustration1.**



**Fig 1**

Driver Side Front Mounting Bracket



**Fig 2**

Driver Side Rear Mounting Bracket

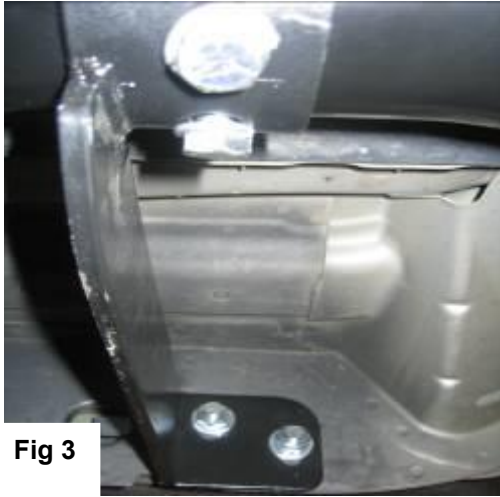

**Fig 3**

Passenger Side Front Mounting Bracket

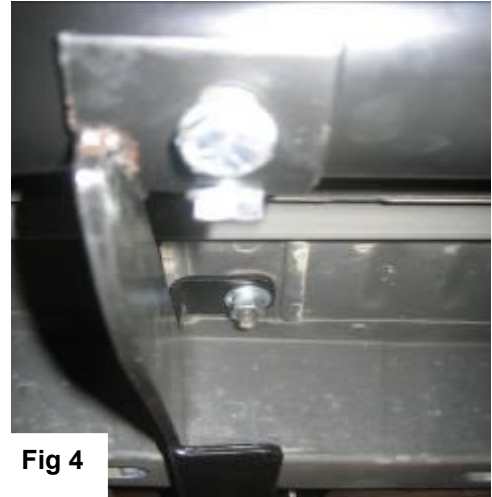

**Fig 4**

Passenger Side Rear Mounting Bracket



**Fig 5**

Driver's side rear bracket

Insert bolt plate through this hole on bottom of frame

**Notice:** Remove the plastic cap from the hole on passenger's side rear inside frame

Notice how passenger's side rear bracket bolts to inside of the frame and that the driver's side rear bracket bolts to outside of the frame

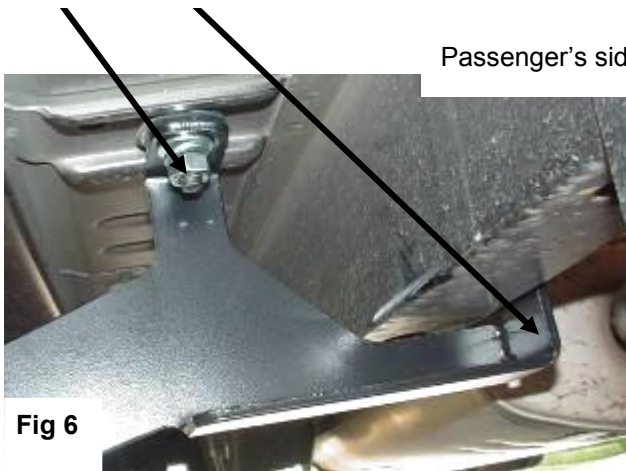

Driver's side front bracket attaches to bolt plates shown to the right.

For front brackets, install bolt plates here through large hole and back out small ones.

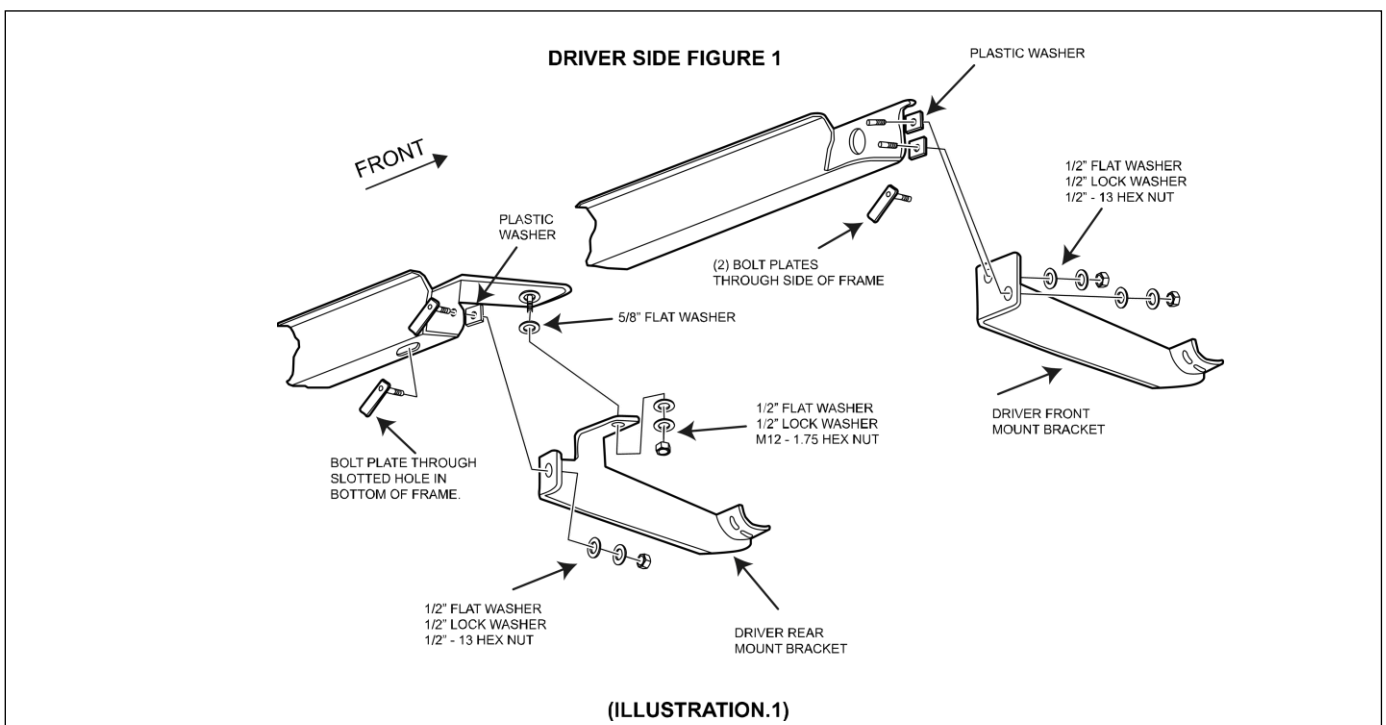

## PARTS IDENTIFICATION GUIDE

**Driver Side tube taped in "Red" Color. Passenger Side tube taped in "Blue" Color.**

No.	Parts Identification
1	Passenger / Right 'Rear' Bracket marked "RR"
2	Driver / Left 'Rear' Bracket marked "RL"
3	Passenger / Right 'Center' Bracket marked "CR"
4	Driver / Left 'Center' Bracket marked "CL"
5	Passenger / Right 'Front' Bracket marked "FR"
6	Driver / Left 'Front' Bracket marked "FL"
7	'Left' marked "L"
8	'Right' marked "R"

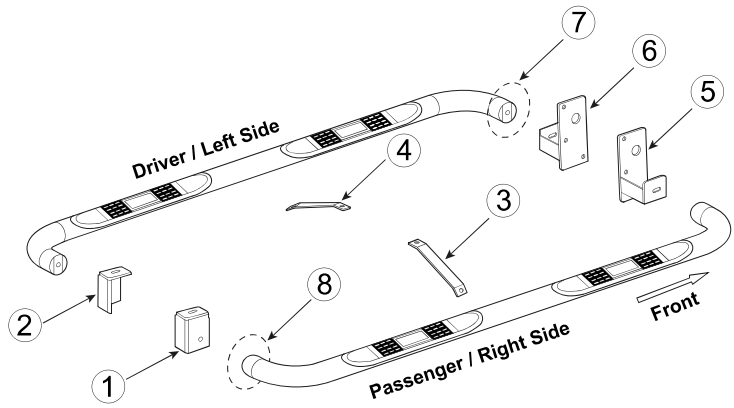

### Note:

- This guide is to identify the parts and not a reference for part count.
- Product / Bracket image is for representative purpose only.
- Actual design may vary based on application.
- Refer Parts List for Hardware.

## PRODUCT CARE

- Periodically check the product to ensure all fasteners are tight and components are intact.
- Regular waxing is recommended to protect the finish of the product.
- **Use ONLY Non-Abrasive automotive wax.** Use of any soap, polish or wax that contains an abrasive is detrimental and can scratch the finish leading to corrosion.
- Aluminum polish may be used to polish small scratches and scuffs for **Stainless Steel finish.**
- Mild soap may be used to clean the product for both **Stainless Steel and Black finish.**

## FAQ's

### 1. Hardware's are not of correct size.

*In GMC / Chevrolet truck model 2006 & up, customer needs to reuse the factory body bolts to install the bracket. If your vehicle is not GMC / Chevrolet 2006 & up, ensure that holes are not partially covered with any plastic grommet or rust? If it is, remove the plastic grommet & rust from the thread holes & re-try the installation.*

### 2. Mounting Bracket are not getting Installed properly.

*In some cases Illustration images shown in Installation manual may not be the exactly same as per actual vehicle images ,also if Driver / Passenger side mounting brackets are very identical in the design, suggest referring Parts Identification guide to avoid fitment issue.*

### 3. Products are thumping / rattling after installation.

*Ensure that all required mounting brackets / hardware's are installed & tighten correctly. Suggest using white lithium / regular grease between the metal to metal contact surfaces.*

### 4. Side Bar is not aligning with vehicle / Step Pads are not aligning with vehicle doors.

*Side bar may be interchanged or mounting brackets are not installed at the correct position in the vehicle. Refer Parts identification guide.*

### 5. Missing / Excess Hardware.

*Recheck hardware count as per the part list.*

### 6. Product not installing properly.

*Ensure make model year, cab length and bed size of your vehicle is listed in the application. All installation steps are followed correctly.*