

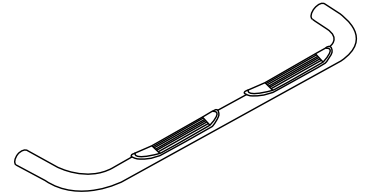

3" Side Bar

Part No. 1130370031/3



Fits: 2003-2006

Ford Expedition



EXCLUDES NBX MODELS



REMOVE CONTENTS FROM BOX. VERIFY ALL PARTS ARE PRESENT.



READ INSTRUCTIONS CAREFULLY BEFORE STARTING INSTALLATION.

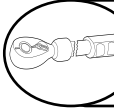

DO NOT OVER TORQUE. STANDARD OPERATING LOAD FOR TIGHTEN BODY MOUNT NUTS & BOLTS VARIES FROM 45 TO 65 FOOT POUND.



30-60 min

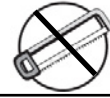

Cutting Not Required



Drilling Not Required

PARTS LIST:

Qty	Part Description	Qty	Part Description
1 Set	Side Bar	16	3/8" Flat Washer
1 Set	Front Bracket	8	3/8" Lock Washer
4	1/2"-13 x 2" Hex Head Bolt	8	3/8"-16 Hex Nut
4	1/2" Lock Washer	4	5/16" Flat Washer
4	1/2" Flat Washer	4	5/16"-18 x 1" Self Tapping
8	3/8"-16 x 1" Hex Head Bolt		

DRIVER (LEFT) FRONT	DRIVER (LEFT) REAR	PASSENGER (RIGHT) REAR	PASSENGER (RIGHT) FRONT

INSTALLATION PROCEDURE

▲ IMPORTANT: A magnetic pick up tool is recommended to assist with the installation.

1. Remove the end caps on the side bars before beginning installation.
2. Remove black tape on inside rocker panel that covers holes needed for front and rear bracket installation.
3. Install the front mounting bracket as shown in picture and diagram. Attach the front bracket to the existing holes in lip of the rocker panel as shown in diagram with (2) 3/8" hex bolts, (2) 3/8" lock washers, (4) 3/8" flat washers, and (2) 3/8" hex nuts. Attach bracket to existing hole inside rocker panel with (2) 8mm hex nuts, (2) 8mm flat washers, and (2) 8mm lock washers as shown in pictures and diagram. Assemble finger tight only.
4. Install the rear mounting bracket as shown in picture and diagram. Attach the rear bracket to the existing holes in lip of the rocker panel as shown in diagram with (2) 3/8" hex bolts, (2) 3/8" lock washers, (4) 3/8" flat washers, and (2) 3/8" hex nuts. Attach rear bracket to existing hole inside rocker panel with (1) 8mm hex nuts, (1) 8mm flat washers, and (1) 8mm lock washers as shown in pictures and diagram. Again, assemble finger tight only.
6. Place step bar tube up to front and rear brackets and fasten with 1/2" x 1 1/2" hex head bolts, 1/2" flat washers, and 1/2" lock washers. Finger tight only.

7. After all mounting points are aligned properly, tighten all bolts accordingly. Torque $\frac{1}{2}$ " fasteners to 65 ft. lbs, $\frac{3}{8}$ " fasteners to 35 ft. lbs, and 8mm fasteners to 20 ft. lbs. Recheck bolts periodically.



Fasten to existing hole in rocker panel with $\frac{5}{16}$ " self tapping screw and washer.

Attach to holes in lip of rocker panel here with $\frac{3}{8}$ " bolts, washers, lock washers, and hex nuts.

FIGURE 1

FRONT BRACKET CROSS SECTION

REAR BRACKET CROSS SECTION

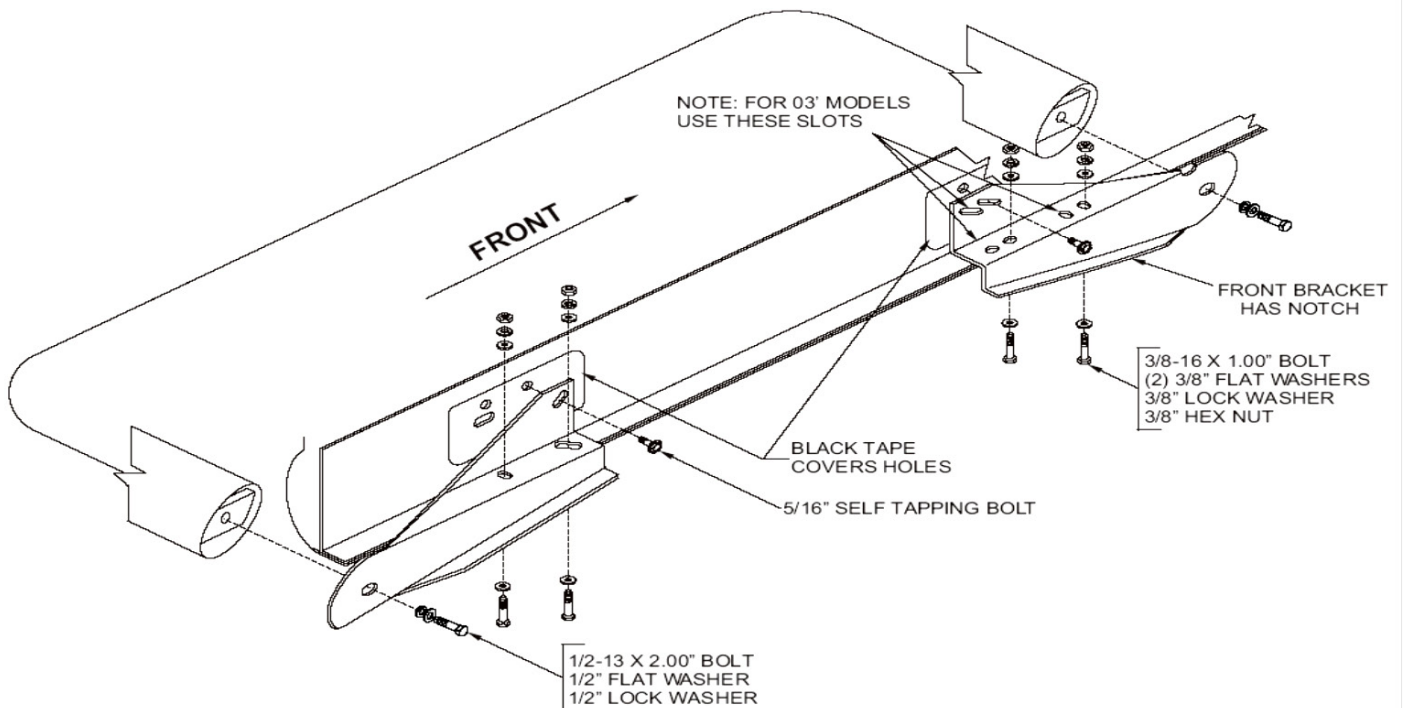

PARTS IDENTIFICATION GUIDE

Driver Side tube taped in "Red" Color. Passenger Side tube taped in "Blue" Color.

No.	Parts Identification
1	Passenger / Right 'Rear' Bracket marked "RR"
2	Driver / Left 'Rear' Bracket marked "RL"
3	Passenger / Right 'Center' Bracket marked "CR"
4	Driver / Left 'Center' Bracket marked "CL"
5	Passenger / Right 'Front' Bracket marked "FR"
6	Driver / Left 'Front' Bracket marked "FL"
7	'Left' marked "L"
8	'Right' marked "R"

Note:

- This guide is to identify the parts and not a reference for part count.
- Product / Bracket image is for representative purpose only.
- Actual design may vary based on application.
- Refer Parts List for Hardware.

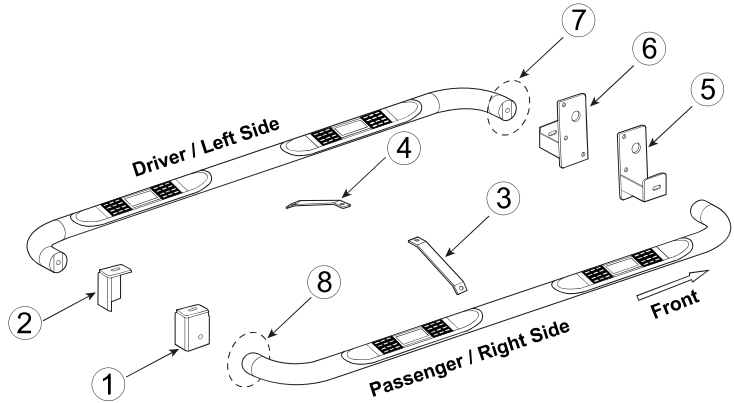

PRODUCT CARE

- Periodically check the product to ensure all fasteners are tight and components are intact.
- Regular waxing is recommended to protect the finish of the product.
- **Use ONLY Non-Abrasive automotive wax.** Use of any soap, polish or wax that contains an abrasive is detrimental and can scratch the finish leading to corrosion.
- Aluminum polish may be used to polish small scratches and scuffs for **Stainless Steel finish.**
- Mild soap may be used to clean the product for both **Stainless Steel and Black finish.**

FAQ's

- 1. Hardware's are not of correct size.**
In GMC / Chevrolet truck model 2006 & up, customer needs to reuse the factory body bolts to install the bracket. If your vehicle is not GMC / Chevrolet 2006 & up, ensure that holes are not partially covered with any plastic grommet or rust? If it is, remove the plastic grommet & rust from the thread holes & re-try the installation.
- 2. Mounting Bracket are not getting Installed properly.**
In some cases Illustration images shown in Installation manual may not be the exactly same as per actual vehicle images ,also if Driver / Passenger side mounting brackets are very identical in the design, suggest referring Parts Identification guide to avoid fitment issue.
- 3. Products are thumping / rattling after installation.**
Ensure that all required mounting brackets / hardware's are installed & tighten correctly. Suggest using white lithium / regular grease between the metal to metal contact surfaces.
- 4. Side Bar is not aligning with vehicle / Step Pads are not aligning with vehicle doors.**
Side bar may be interchanged or mounting brackets are not installed at the correct position in the vehicle. Refer Parts identification guide.
- 5. Missing / Excess Hardware.**
Recheck hardware count as per the part list.
- 6. Product not installing properly.**
Ensure make model year, cab length and bed size of your vehicle is listed in the application. All installation steps are followed correctly.