

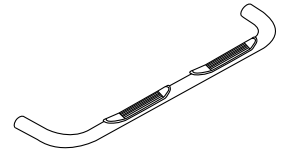

# 3" Side Bar

Part No. 1130343991/3



Fits: 1999 - Current

Ford F250/F350/F450/F550 Super Duty Regular Cab



30-60 min

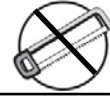

Cutting Not Required



Drilling Not Required



REMOVE CONTENTS FROM BOX. VERIFY ALL PARTS ARE PRESENT.



READ INSTRUCTIONS CAREFULLY BEFORE STARTING INSTALLATION.

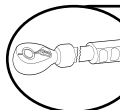

DO NOT OVER TORQUE. STANDARD OPERATING LOAD FOR TIGHTEN BODY MOUNT NUTS & BOLTS VARIES FROM 45 TO 65 FOOT POUND.

### PARTS LIST:

| Qty   | Part Description               | Qty | Part Description                |
|-------|--------------------------------|-----|---------------------------------|
| 1 Set | Side Bar                       | 4   | 3/8"-16 Clip Nut                |
| 1 Set | Front Bracket                  | 12  | 3/8"-16 x 1" Hex Head Bolt      |
| 1 Set | Rear Bracket                   | 12  | 3/8" Lock Washer                |
| 4     | 1/2"-13 x 1 1/2" Hex Head Bolt | 12  | 3/8" Flat Washer                |
| 4     | 1/2" Lock Washer               | 8   | 3/8"-16 Hex Nut                 |
| 4     | 1/2" Flat Washer               | 2   | 3/8"-16 x 1 1/2" "T" Bolt plate |

| DRIVER (LEFT)FRONT | DRIVER (LEFT)REAR | PASSENGER(RIGHT) REAR | PASSENGER(RIGHT) FRONT |
|--------------------|-------------------|-----------------------|------------------------|
|                    |                   |                       |                        |

### INSTALLATION PROCEDURE

**⚠ IMPORTANT:** A magnetic pick up tool is recommended to assist with the installation.

1. Remove the end caps on the side bars before beginning installation.
2. First, on the front mount install clip nut into the top hole on the interior wall of the rocker panel. The front top hole patterns will be used for this installation as follows. (DWG. 1)
3. Place and hold front mounting bracket onto the interior wall of the rocker panel (DWG. 2) with the first 3/8" x 1" (B) hex head bolt, stopping the bracket from turning.
4. Once you have placed the mounting bracket onto the rocker panel, screw the last two 3/8" x 1" (B) hex head bolts into the existing holes that are to the inside of the rocker panel with the 3/8" lock washer, 3/8" flat washer, and 3/8" nut. (DWG. 2). Assemble finger tight.
5. Install the rear mounting bracket by placing the bolt plate through holes on inside of rocker panel as shown. (DWG. 3). Position rear bracket with downward sloping end towards rear of Vehicle. Assemble with (2) 3/8" flat washers, lock washers, and hex nuts. Assemble only finger tight.

6. Position step bar assembly up to the mounting brackets (Front & Rear). Install using the 1/2" x 1 1/2" hex head bolts, lock washer, and flat washer.
7. After all mounting points are in place and Side Bars are aligned, tighten all bolts accordingly. Recheck bolts periodically.



**Fig 1**

Driver Side Front mounting Bracket.



**Fig 2**

Driver Side Rear mounting Bracket.



**Fig 3**

Passenger Side Front mounting Bracket.



**Fig 4**

Passenger Side Rear mounting Bracket.

DWG. 3.

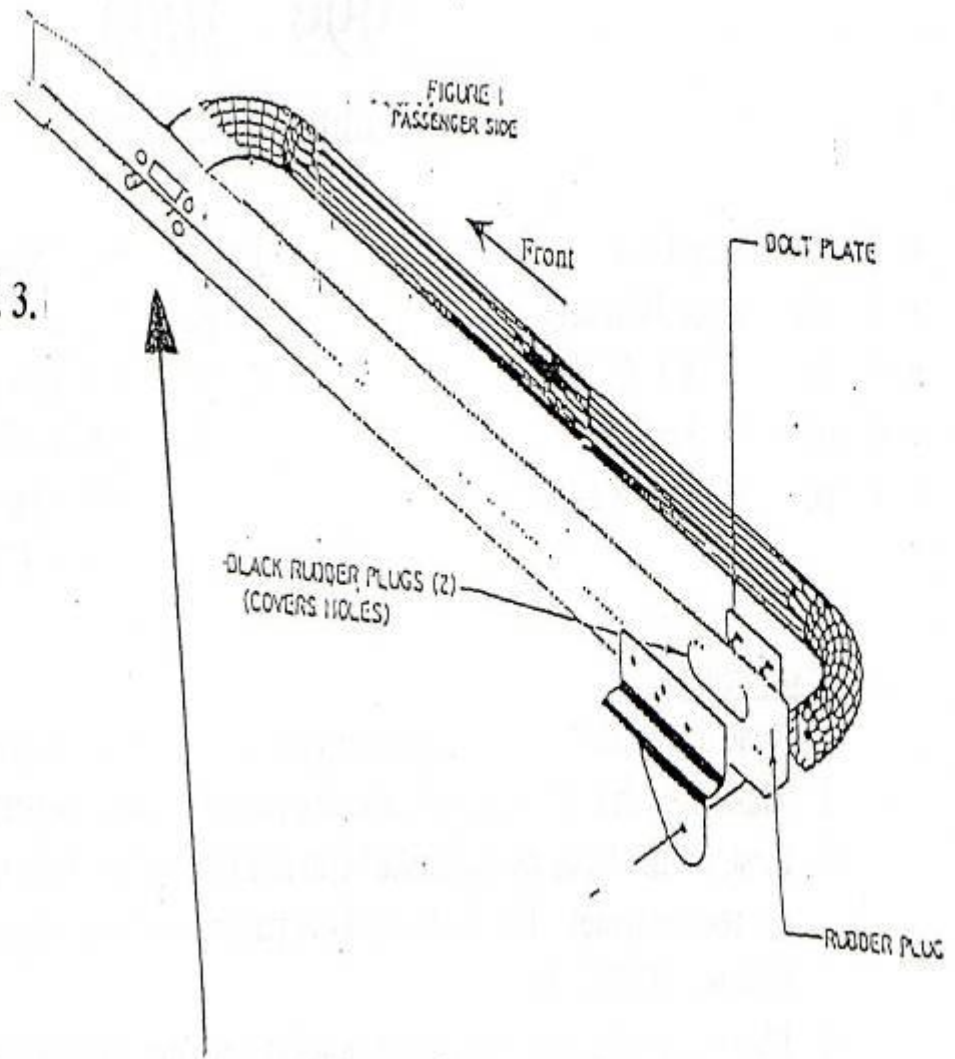

DWG. 1

Insert the small auxiliary plate into the top hole

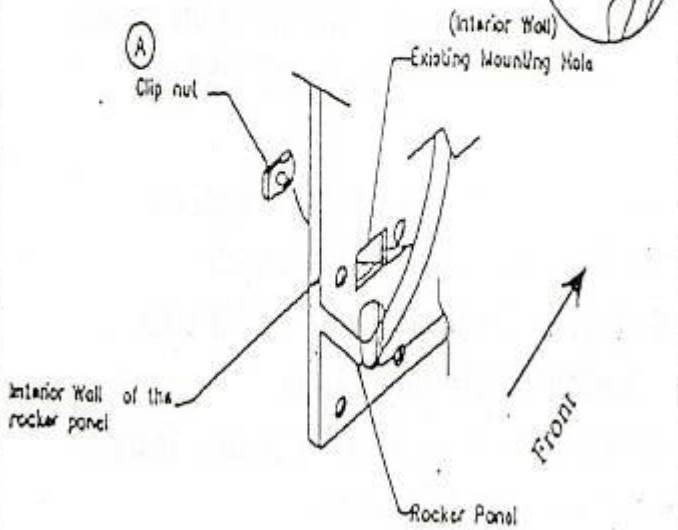

DWG. 2.

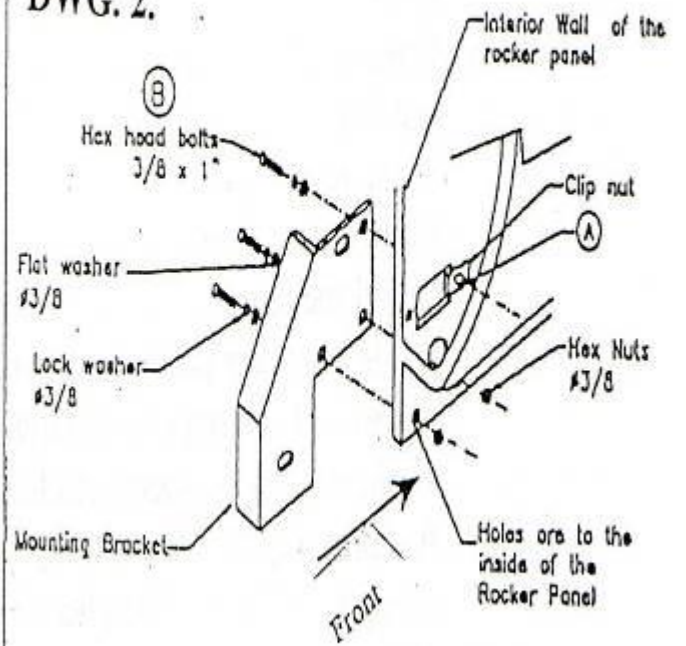

## PARTS IDENTIFICATION GUIDE

*Driver Side tube taped in "Red" Color. Passenger Side tube taped in "Blue" Color.*

| No. | Parts Identification                           |
|-----|------------------------------------------------|
| 1   | Passenger / Right 'Rear' Bracket marked "RR"   |
| 2   | Driver / Left 'Rear' Bracket marked "RL"       |
| 3   | Passenger / Right 'Center' Bracket marked "CR" |
| 4   | Driver / Left 'Center' Bracket marked "CL"     |
| 5   | Passenger / Right 'Front' Bracket marked "FR"  |
| 6   | Driver / Left 'Front' Bracket marked "FL"      |
| 7   | 'Left' marked "L"                              |
| 8   | 'Right' marked "R"                             |

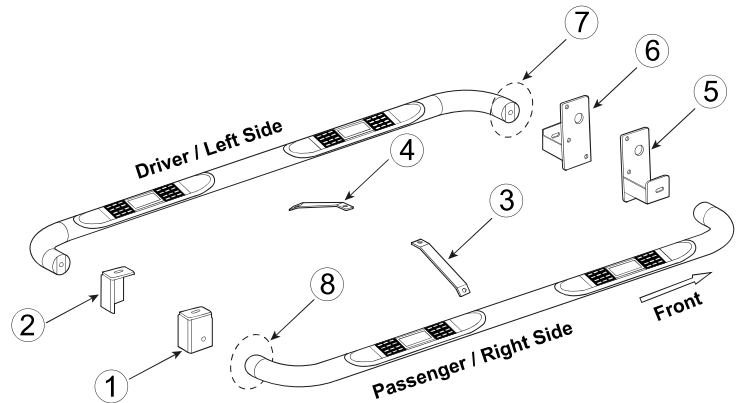

### Note:

- This guide is to identify the parts and not a reference for part count.
- Product / Bracket image is for representative purpose only.
- Actual design may vary based on application.
- Refer Parts List for Hardware.

## PRODUCT CARE

- Periodically check the product to ensure all fasteners are tight and components are intact.
- Regular waxing is recommended to protect the finish of the product.
- **Use ONLY Non-Abrasive automotive wax.** Use of any soap, polish or wax that contains an abrasive is detrimental and can scratch the finish leading to corrosion.
- Aluminum polish may be used to polish small scratches and scuffs for **Stainless Steel finish.**
- Mild soap may be used to clean the product for both **Stainless Steel and Black finish.**

## FAQ's

### 1. Hardware's are not of correct size.

*In GMC / Chevrolet truck model 2006 & up, customer needs to reuse the factory body bolts to install the bracket. If your vehicle is not GMC / Chevrolet 2006 & up, ensure that holes are not partially covered with any plastic grommet or rust? If it is, remove the plastic grommet & rust from the thread holes & re-try the installation.*

### 2. Mounting Bracket are not getting Installed properly.

*In some cases Illustration images shown in Installation manual may not be the exactly same as per actual vehicle images ,also if Driver / Passenger side mounting brackets are very identical in the design, suggest referring Parts Identification guide to avoid fitment issue.*

### 3. Products are thumping / rattling after installation.

*Ensure that all required mounting brackets / hardware's are installed & tighten correctly. Suggest using white lithium / regular grease between the metal to metal contact surfaces.*

### 4. Side Bar is not aligning with vehicle / Step Pads are not aligning with vehicle doors.

*Side bar may be interchanged or mounting brackets are not installed at the correct position in the vehicle. Refer Parts identification guide.*

### 5. Missing / Excess Hardware.

*Recheck hardware count as per the part list.*

### 6. Product not installing properly.

*Ensure make model year, cab length and bed size of your vehicle is listed in the application. All installation steps are followed correctly.*