

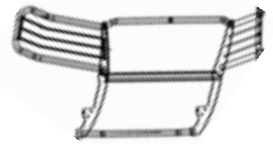

Grille Guard

Part No. 81010/1



Fits: 1988-1999 Chevrolet Silverado
 1988-1998 GMC Sierra
 1992-1999 Chevrolet K5 Blazer/Suburban/Yukon (Excl. Denali)
 1992-1994 Jimmy Full-size



NOT COMPATIBLE WITH THE FACTORY TOW HOOKS AND THEY WILL NOT BE REINSTALLED



60-180 min

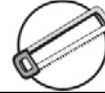

CUTTING
REQUIRED



DRILLING NOT
REQUIRED



REMOVE CONTENTS FROM BOX. VERIFY ALL PARTS ARE PRESENT.



READ INSTRUCTIONS CAREFULLY BEFORE STARTING INSTALLATION.

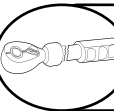

DO NOT OVER TORQUE. STANDARD OPERATING LOAD FOR TIGHTEN BODY MOUNT NUTS & BOLTS VARIES FROM 45 TO 65 FOOT POUND.

PARTS LIST:

Qty	Part Description	Qty	Part Description
1	Grille Guard	6	10-1.5mm x 30mm Hex Bolts
1	Driver/Left Frame Bracket	12	10mm x 20mm OD x 2mm Flat Washers
1	Passenger/Right Frame Bracket	6	10mm Nylon Lock Nuts
2	Top "L" Brackets	6	6-1.0mm x 25mm Hex Bolts
2	"Z" Top Mounting Brackets	10	6mm x 18mm OD x 1.6mm Flat Washers
4	12-1.75mm x 30mm Hex Bolts	2	6mm x 12mm OD x 1.6mm Flat Washers
8	12mm x 24mm OD x 2.5mm Flat Washers	6	6mm Nylon Lock Nuts
4	12mm Nylon Lock Nuts		

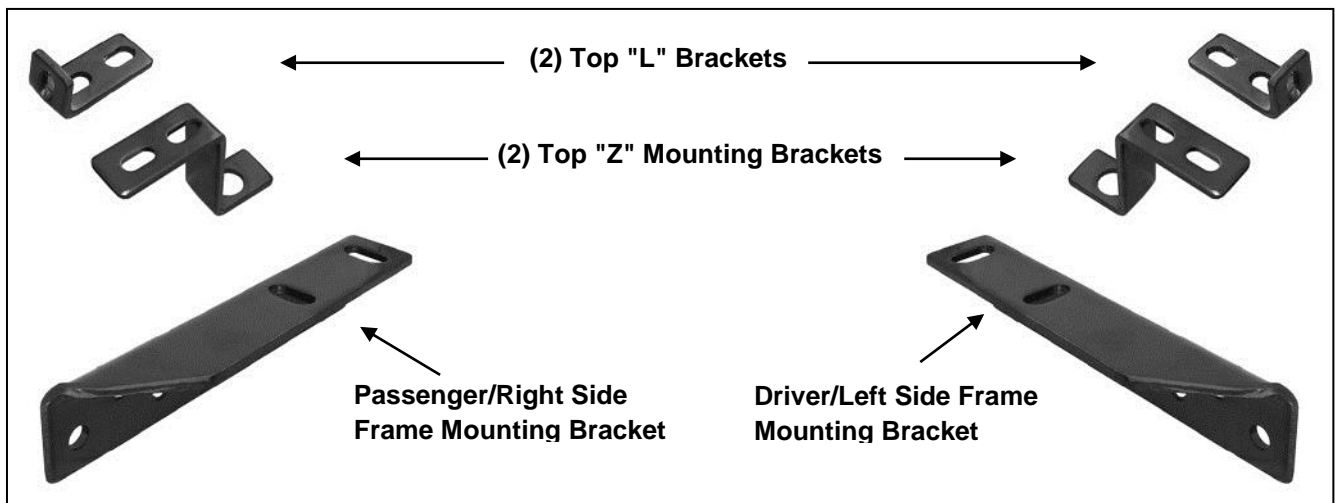

INSTALLATION PROCEDURE

1. Starting on the driver side-front of the vehicle, locate the mounting area on the front bottom of the frame channel, **(Figure 1)**. Remove the factory tow hook if equipped. Select the driver side Frame Mounting Bracket. **NOTE:** This Grille Guard is not compatible with the factory tow hooks and they will not be reinstalled. Bolt the Bracket to the bottom of the frame with (2) 12mm x 30mm Hex Bolts, (2) 12mm Lock Washers and (2) 12mm Flat Washers, **(Figure 1)**. Do not tighten hardware at this time.
2. Repeat Step 2 for passenger side Frame Bracket installation.
IMPORTANT: On some vehicles, it may be necessary to cut the lower plastic portion of the bumper/air dam to clear the mounting Brackets. Cut as little as possible from the air dam to maintain strength.
3. Next, select (1) "L" Top Bracket and (1) "Z" Top Bracket. Bolt the two Brackets together with (2) 6mm x 25mm Hex Bolts, (4) 6mm Large Flat Washers and (2) 6mm Nylon Lock Nuts, **(Figure 2)**. Leave hardware loose at this time.
4. Open the hood on the vehicle and locate the bumper bracket behind the bumper and grille, **(Figure 3)**. **NOTE:** Remove the plastic grille if necessary to access the top of the bumper bracket. Locate and remove the factory hex bolt on the top of the bumper bracket, **(Figure 3)**. Attach the driver side Top Bracket assembly to the bumper bracket with the factory hex bolt, **(Figure 1)**. Leave loose at this time.
5. Repeat **Steps 4 - 5** for passenger side Top Bracket installation.
6. With assistance, place the Grille Guard up to the outside of the Frame Mounting Brackets. Secure the Grille Guard to the Brackets with (6) 10mm x 30mm Hex Bolts, (12) 10mm Flat Washers and (6) 10mm Nylon Lock Nuts. Do not tighten hardware at this time.
7. Next, line up the driver side Top Bracket with the hole in the back of the light bar on the Grille Guard. Insert (1) 6mm Hex Bolt with (1) 6mm x 18mm Flat Washer through the Top "L" Bracket and grille guard. Secure with (1) 6mm x 12mm Small Flat Washer and (1) 6mm Nylon Lock Nut, **(Figure 2)**. Repeat this Step for passenger side Top Bracket installation. Do not tighten hardware at this time.
8. With the hood open, align, center and adjust the Grille Guard properly. Carefully close the hood and check for clearance. Adjust the Brackets for fit as necessary and tighten all Mounting Bracket and Top hardware. Reinstall the plastic grille removed in **Step 5**.
9. Do periodic inspections to the installation to make sure that all hardware is secure and tight.

Driver Side Installation Illustrated

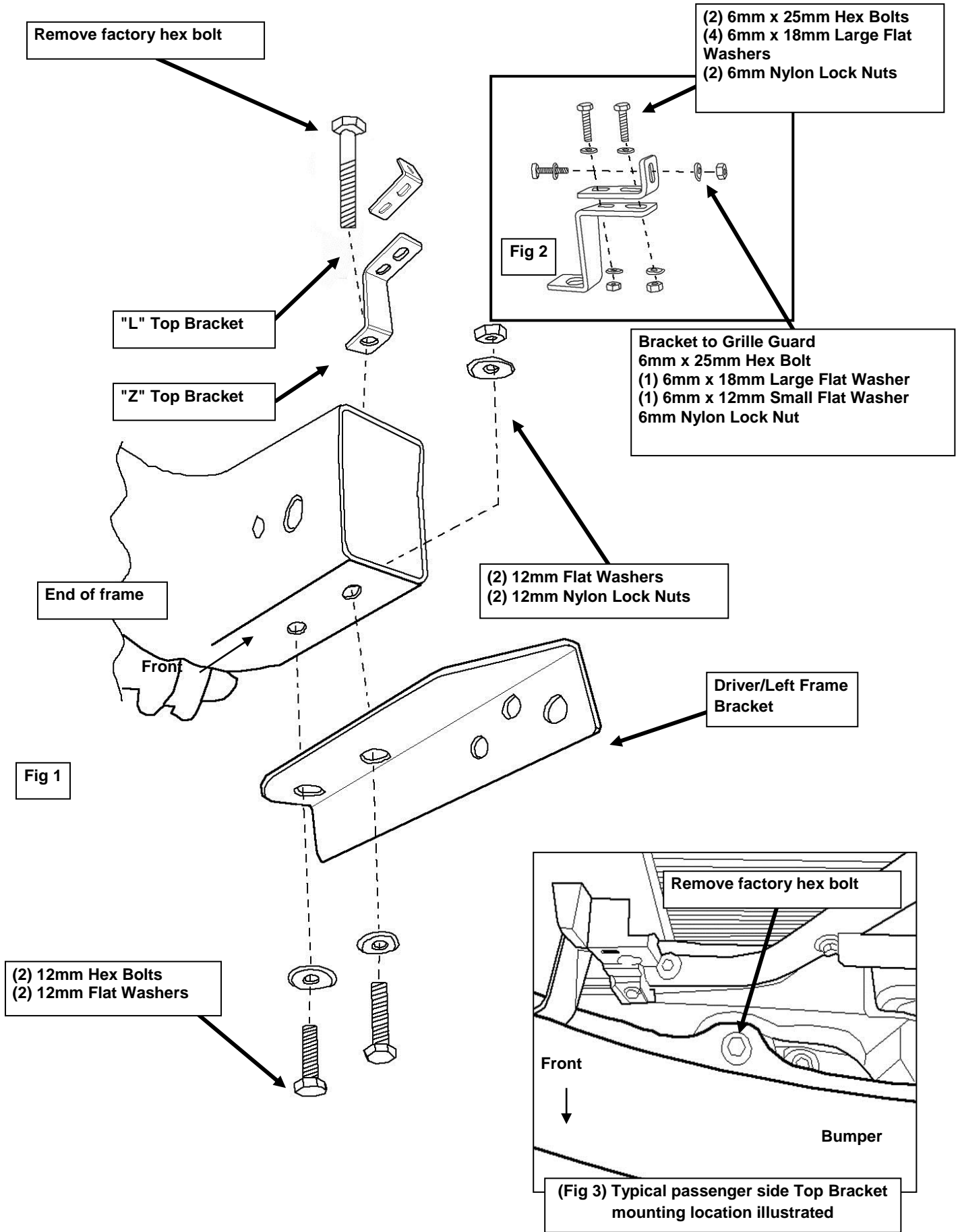

PRODUCT CARE

- Periodically check the product to ensure all fasteners are tight and components are intact.
- Regular waxing is recommended to protect the finish of the product.
- **Use ONLY Non-Abrasive automotive wax.** Use of any soap, polish or wax that contains an abrasive is detrimental and can scratch the finish leading to corrosion.
- Aluminum polish may be used to polish small scratches and scuffs for **Stainless Steel finish.**
- Mild soap may be used to clean the product for both **Stainless Steel and Black finish.**

FAQ's

1. Hardware's are not of correct size.

In GMC / Chevrolet truck model 2006 & up, customer needs to reuse the factory body bolts to install the bracket. If your vehicle is not GMC / Chevrolet 2006 & up, please ensure that holes are not partially covered with any plastic grommet or rust? If it is, please remove the plastic grommet & rust from the thread holes & re-try the installation.

2. Mounting Bracket are not getting Installed properly.

In some cases Illustration images shown in Installation manual may not be the exactly same as per actual vehicle images ,also if Driver / Passenger side mounting brackets are very identical in the design, suggest referring Parts Identification guide to avoid fitment issue.

3. Products are thumping / rattling after installation.

Please ensure that all required mounting brackets / hardware's are installed & tighten correctly. Suggest using white lithium / regular grease between the metal to metal contact surfaces.

4. Side Bar is not aligning with vehicle / Step Pads are not aligning with vehicle doors.

Side bar may be interchanged or mounting brackets are not installed at the correct position in the vehicle. Please refer Parts identification guide.

5. Missing / Excess Hardware.

Recheck hardware count as per the part list.

6. Product not installing properly.

Ensure make model year, cab length and bed size of your vehicle is listed in the application. All installation steps are followed correctly.