

For Installation on Driver's Side Only

Instruction Manual

Tailgate Assist
Dodge Ram
1500 2009-Current
2500/3500 2010-Current

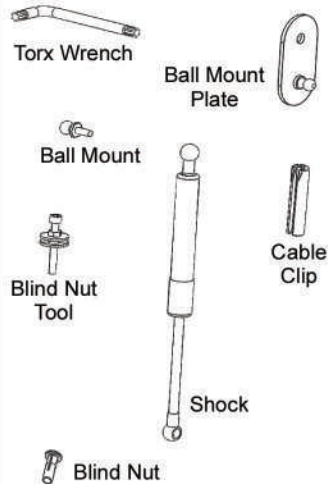

Parts Included:

1 Thread Lock Tube
1 Shock
1 Ball Mount Plate
1 Blind Nut Tool
1 Ball Mount
1 Blind Nut/NJutsert
1 Torx Wrench
1 Cable Clip
1 Mylar

Tools Required:

T-45 Torx
M5 Allen Wrench
Tape Measure
10mm Wrench
13mm Wrench/Socket

Note: This tailgate assist is for installation on the driver's side only.

Step 1: Adjust the nutsert tool so there is 3/4" from the washer to the head of the bolt.



Step 2: Using an M5 Allen wrench and a 10mm wrench, install the blind nut in the opening by the tailgate pivot point. The nutsert should be tightened at least 9 360 degree turns. Mark one side of the nut and count the number of revolutions to ensure the correct number of turns. After the 9 turns, if the blind nut can still be moved or rotated, continue tightening an additional 1 to 2 turns. Re-check the blind nut and repeat as needed.

Remove the nutsert tool when installation is complete.



Warning: Overtightening the nutsert can strip the threads and cause the nutsert to be nonfunctional.



For Installation on Driver's Side Only

Step 3: Apply the thread lock to the threads of the ball mount.



Step 4: Use a T-45 torx socket or the wrench included to remove the cable bolt. Remove the tailgate cable from the bolt.



Step 5: Install the bolt removed in the previous step through the hole in the ball mount plate back into the hole.



Tighten the bolt with the T-45 Torx.

Step 6: Install the cable back onto the cable bolt.



Step 7: Remove the other end of the tailgate cable with the T-45 Torx and remove the motion limiter. The flat retaining nut must be taken off to remove the limiter. To remove the limiter, pry up one edge of the flat nut with a screwdriver. Hold this edge with a pair of pliers and spin the bolt out of it.



Once the limiter is removed, reinstall the cable mount to the tailgate.

Step 8: Measure down from the top of the cable 3 1/2". This is where the cable clip needs to start. Press the clip onto the cable with a pair of pliers.



Failure to remove the limiter and to install the cable clip will cause the cable to bind or become caught between the shock and the truck bed. This may lead to vehicle damage, so these steps *must* be done.

For Installation on Driver's Side Only

Step 9: A Mylar sheet has been included to help prevent the components from rubbing against the truck bed and tailgate in the event that any part becomes loose. Using scissors, cut the mylar to the size needed. Apply the mylar to the truck bed and tailgate where the tailgate assist parts will be in close proximity during opening and closing.

Step 10: Install the larger part of the shock on the ball mount plate.



Install the narrow end of the shock on the ball mount.



Periodically check the upper and lower mounting locations to ensure that the parts have not loosened through repeated use. If either mounting location is found to be loose, re-tighten the hardware as needed.