

### Complete Side Rail and Cover Installation

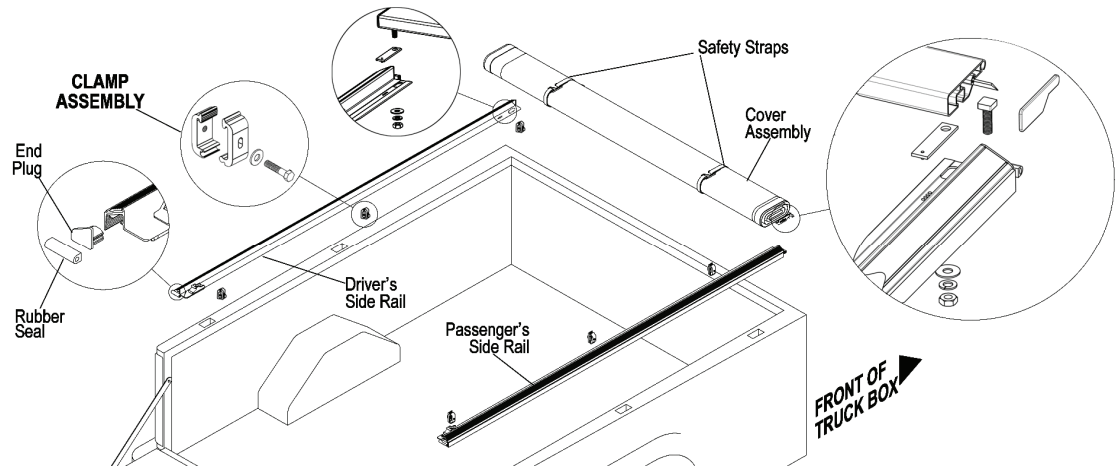

#### IMPORTANT - Please read BEFORE starting.

1. The adjustable tension plates are secured in the bulkhead rail of the vinyl cover. Remove the tension plates and lock nuts and keep for use in a later step of the installation.
2. If your truck is equipped with plastic bed caps, **remove** our factory foam filler gasket prior to installation of the aluminum bed rail extrusion.

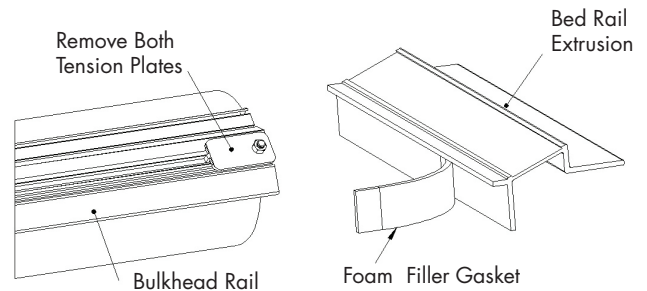

3. Place the front of the side rail and round gasket tight against the front of the truck box. Starting at the tailgate evenly space the 3 clamps along each side rail leaving approximately 6 to 8 inches on each end. To insure optimum performance and cover fit, the **side rails must be level**. To adjust the rails, loosen the screws and reposition the clamp higher or lower on the truck bed rail lip. **Make sure to tighten all clamps!**

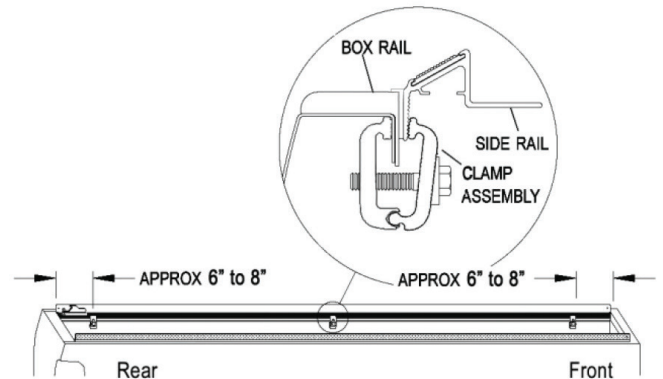

4. Place the tension control plate on the top of the side rail and place the pin in the first hole. This is the factory setting and will locate the T-Bolt in the front of the slotted hole in the side rail. Next, set the cover assembly behind the cab and feed the T-Bolt down through the tension plate and side rail. The header seal should be on the top of the bulkhead of the truck. **Use supplied flat, lock washer and nut and tighten front bulkhead assembly.**

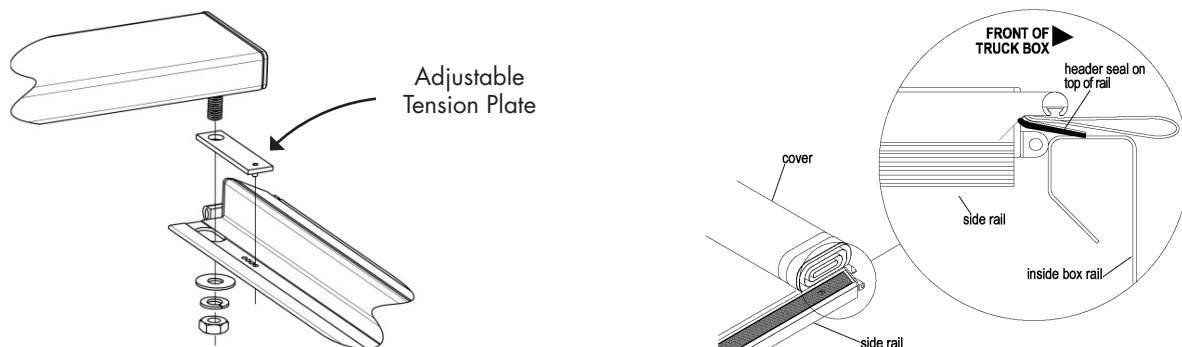

5. With your tailgate open, unroll cover toward tailgate and rest bows on side rails. Rotate the tailgate header into the plastic header stops and press down to engage the catch into the latching mechanism located on the underside of the passenger side rail in the rear. Finally, Secure the hook and loop fastener strips on the side rails by pulling out the slack and then pressing along the length of the rail.

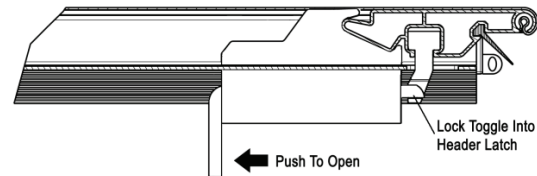
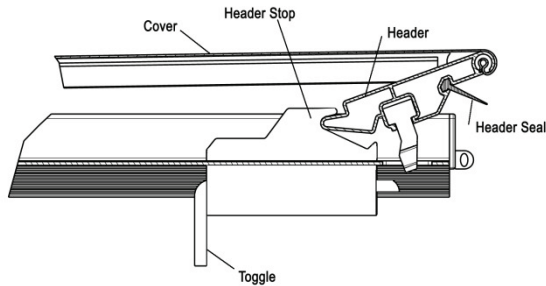

6. Secure the hook and loop fastener strips on one side of the rail by pressing along the length of the rail. On the opposite side, pull the cover across the pickup bed and secure the Velcro fastener.

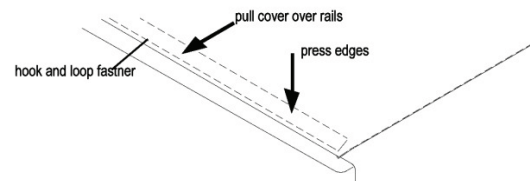

7. To release the cover, push the lever on the latch towards the cab of the truck to release the catch mechanism. Start to roll the cover toward the cab making sure both sides of cover roll evenly. Secure the cover open by hooking the safety straps to the front loops.

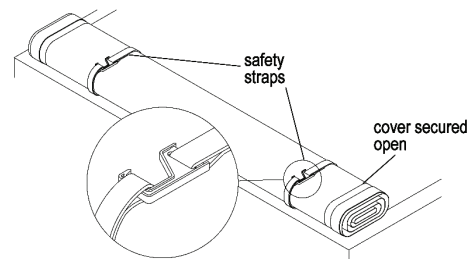

8. Your Tonno Pro Low Roll cover has been set at the factory for moderate tension to keep your cover free of wrinkles. Dependent on weather conditions it may be necessary for you to adjust the tension control on your cover. To adjust your tension control, simply loosen the fasteners on the front bulkhead and lift up the bulkhead. Once the bulkhead is loose, simply slide the tension control plate towards the cab of the truck.

**Only move up one adjustment hole at a time and always make your adjustments during the warmest time of the day!** Each hole location will give you 3/16" of tension adjustment.

Example of  
Factory Settings

