

# TRA1702

Suspension package for trailer

## INSTALLATION INSTRUCTIONS

- a) Raise vehicle allowing the axle to hang freely.
- b) Assemble Aeon rubber spring and bracket as shown in the adjacent diagram.
- c) Position Timbren bracket above leaf spring or axle (see Diagram).
- d) Using holes in bracket as a template, drill through side of chassis frame rail making sure that Aeon rubber spring is centered over axle.
- e) Bolt Timbren assembly to the frame using existing holes where possible.
- f) Lower vehicle.

### SAFETY CAUTIONS

Always refer to and follow the vehicle manufacturer's guidelines when welding or drilling during installation of this kit.

*Do not exceed vehicle manufacturer's recommended axle weight rating. Check for AEON® interference with vehicle components - Under load AEON® will "expand" in diameter.*

**Ref.** = Reference  
**Part** = Part #.  
**Qty.** = Quantity

Ref	Part	Qty
1	F31003-150	4
2	F12064-253	2
3	F11063-150	4
4	K51270-003	2
5	F40031-020	4
6	A00170-55P20	2
7	F31003-250	2

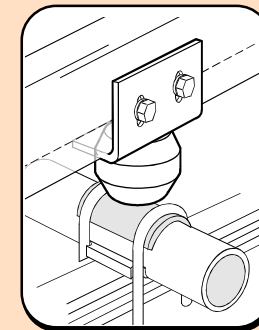
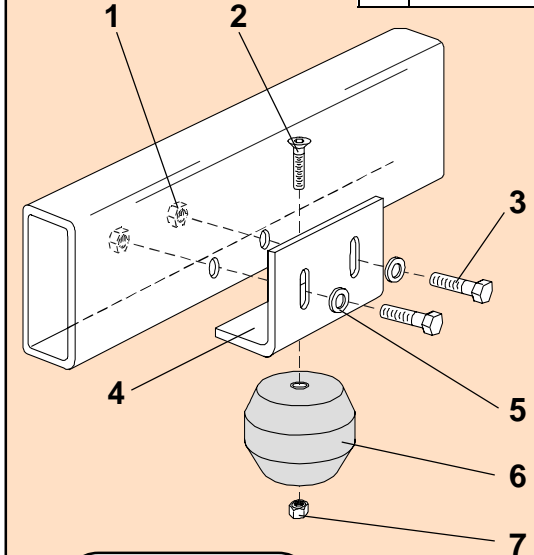

TRA1702



## TRA1702

PART NUMBER	DESCRIPTION	QTY	LOCATION
F31003-150	NYLOCK LOCKNUT 3/8 UNF GR 5 Z	4	G1C
F40031-020	WASHER FLAT USS 3/8 x 1 GR 2 Z	4	G1C
F11063-150	HCS 3/8 x 1-1/2 UNF GR 5 Z	4	G1C
F31003-250	NYLOCK LOCKNUT 3/8 UNC GR 5 Z	2	G1B
F12064-253	FHSCS 3/8 X 1-3/4 UNC GR 5 B	2	J2E
A00170-55P20	Hollow Rubber Spring	2	C2B
K51270-003	FORMED ANGLE 1/4 x 3 x 5-1/2" (PAINTED)	2	D6D
B90200-CR	SMALL REAR BOX - 9.5 x 7 x 5.5	1	A--E
B10000	8" x 12" BUBBLE FOR KITS	1	
B00029-010	BARCODE LABEL FOR KIT	1	

### Clearance Instructions:

Rear SES Kits for Pick-Ups and Vans should have a 1/2" to 1-1/2" gap between the rubber spring and contact point when empty.

A partial load, or vehicle accessories will reduce or eliminate the gap.

Front SES kits are usually in full contact.

Medium and Heavy-Duty Trucks, Trailers and Motorhomes will be in constant contact, and have no gap.