

# TRA15252A

Suspension package for trailer

## INSTALLATION INSTRUCTIONS

- a) Insert bolt #1 into countersunk hole of Timbren top plate #3 and tack weld into place.
- b) Create frame bracket assembly by welding bracket #2 to plate #3. Ensure that bolt #1 is centered over U-bolt pad.
- c) Position upper bracket assembly above center line of leaf spring & drill three 1/2" holes through bracket assembly & frame.
- d) After weldment has cooled, mount Aeon rubber spring onto frame bracket assembly using Timbren fasteners supplied.
- e) Configure items #6, #7, #8, welding them together to obtain a 4" space (unloaded) between lower plate (item #6) and upper frame bracket. (Use diagrams on page 2 as a guide)
- f) Weld lower disc assembly to U-bolt pad.

### NOTES

Use zinc based paint or galvanized sheet metal between aluminum frame and steel components to minimize galvanic reactions.

### SAFETY CAUTIONS

Always refer to and follow the vehicle manufacturer's guidelines when welding or drilling during installation of this kit.

*Do not exceed vehicle manufacturer's recommended axle weight rating. Check for AEON® interference with vehicle components - Under load AEON® will "expand" in diameter.*

Ref. = Reference  
Part = Part #.  
Qty. = Quantity

Ref	Part	Qty
1	F12106-253	2
2	K51104-005	2
3	K52139-005	2
4	A01525-75G70	2
5	F31005-250	2
6	K52195-005	2
7	K51129-005	2
8	K52154-005	4

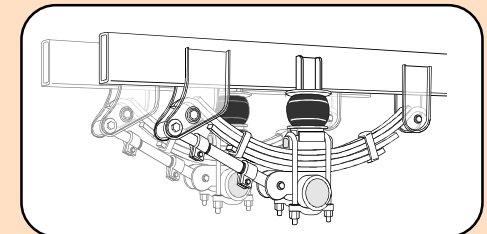
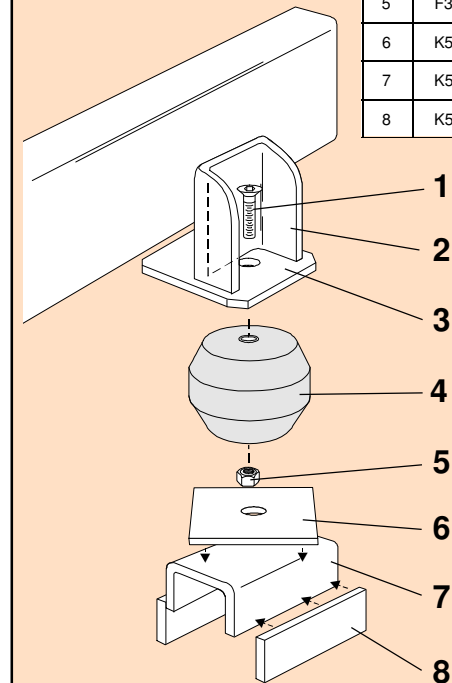

TRA15252A



# TRA15252A

Suspension package for trailer

Note:

Chassis frames and suspension mounting can be mixed and match.

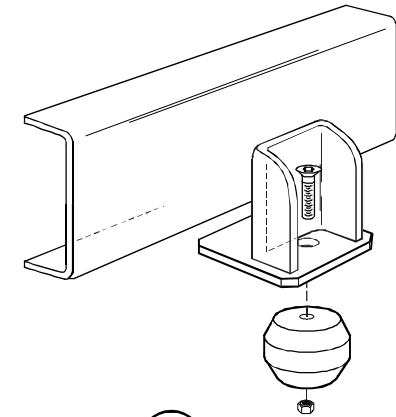
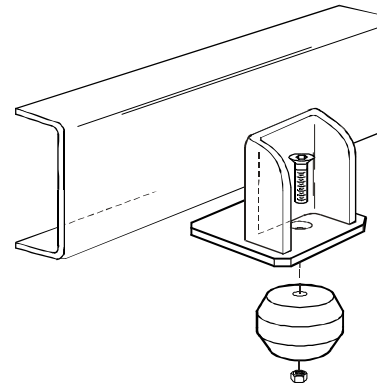
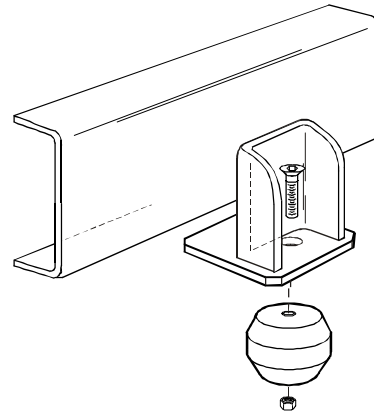

**A**

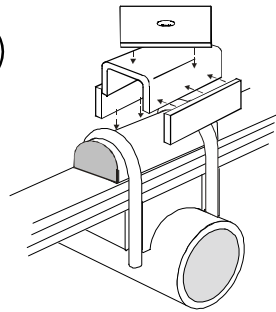

**B**

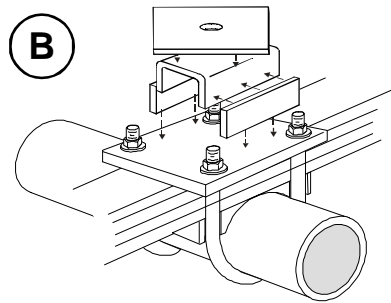

**C**

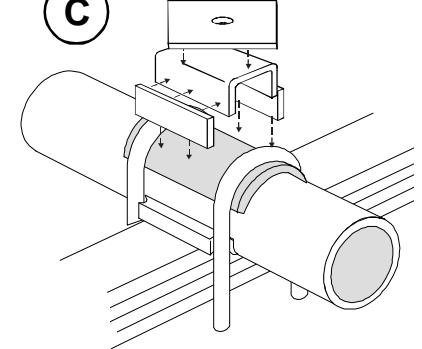

**Chassis**

**Weld**

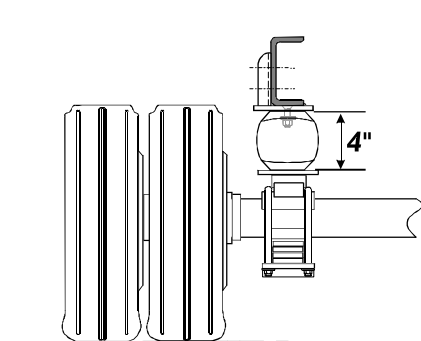
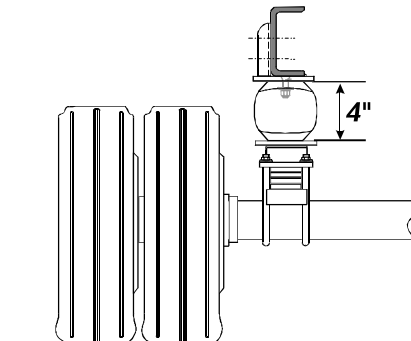
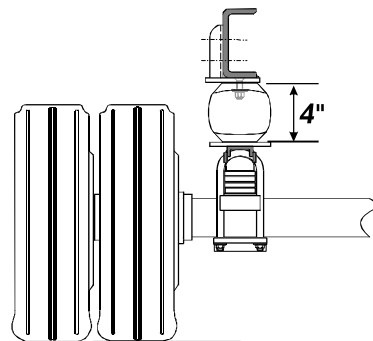
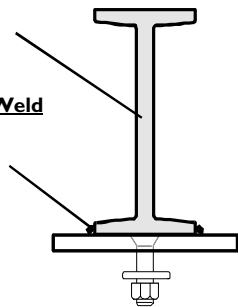

TRA15252A



