

MRBT50

Rear suspension package

INSTALLATION INSTRUCTIONS

- Partially raise vehicle not allowing the axle to hang freely.
- Loosen axle U-bolts and remove existing bump stop.
- Remove U-bolt pad from leaf springs & remove rubber bump stop from pad.
- Assemble Aeon rubber spring and bracket as shown in the adjacent diagram.
- Re-install U-bolt pad & Timbren spring assembly.
- Lower vehicle.

NOTES

Use bolt #5 at offset holes where required to position Aeon under frame. Disc 3 may be reversed as required.

When removing OEM fasteners, use penetrating fluid.

These instructions are not intended to replace OEM guidelines for safe removal and replacement of the OEM fasteners.

Do not exceed vehicle manufacturer's recommended axle weight rating. Check for AEON® interference with vehicle components - Under load AEON® will "expand" in diameter.

Ref. = Reference
Part = Part #.
Qty. = Quantity

Ref	Part	Qty
1	F11538-380	2
2	A00550-55P30	2
3	A16305-003	2
4	K10526-003	2
5	F12534-783	2

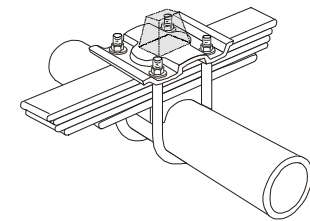
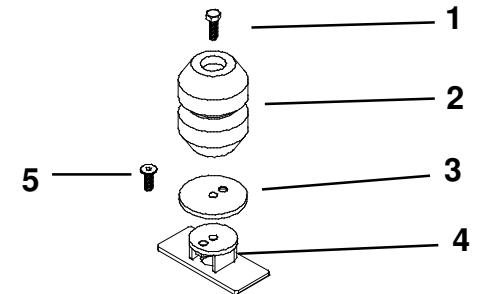
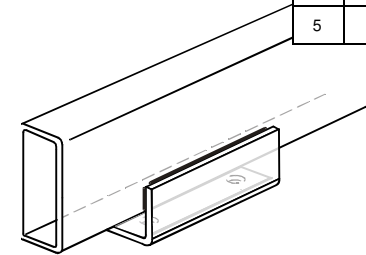

MRBT50

PART NUMBER	DESCRIPTION	QTY	LOCATION
F11538-380	HCS M10 x 40 x 1.5 GR 10.9 Z	2	G6F
F12534-783	FHSCS M10 x 25 x 1.5 FT GR 10.9 B	2	J2B
A00550-55P30	Hollow Rubber Spring	2	C11B
K10526-003	MRBT50 WELDMENT PAINTED	2	D19D
A16305-003	DISC 1/4 x 3-1/4 x 13/32 PAINTED	2	D19D
B90200-CR	SMALL REAR BOX - 9.5 x 7 x 5.5	1	A--E
B10000	8" x 12" BUBBLE FOR KITS	1	
B00029-010	BARCODE LABEL FOR KIT	1	

Issued: 4/30/2015

Clearance Instructions:

Rear SES Kits for Pick-Ups and Vans should have a 1/2" to 1-1/2" gap between the rubber spring and contact point when empty.

A partial load, or vehicle accessories will reduce or eliminate the gap.

Front SES kits are usually in full contact.

Medium and Heavy-Duty Trucks, Trailers and Motorhomes will be in constant contact, and have no gap.