

GMRG45MH

Rear suspension package

INSTALLATION INSTRUCTIONS

- Raise vehicle allowing the axle to hang freely.
- Remove existing bump stop.
- Ensure area around OEM slot is clear of undercoating, dirt & debris.
- Assemble Aeon rubber spring and bracket as shown in the adjacent diagram.
- Mount Timbren assembly using existing holes & Timbren supplied fasteners.
- Lower vehicle.

NOTES:

Check that brake line or brake cable locations do not interfere with Aeon spring.
Position assembly to ensure that Aeon spring is centered over the axle.

Do not exceed vehicle manufacturer's recommended axle weight rating. Check for AEON® interference with vehicle components - Under load AEON® will "expand" in diameter.

Ref. = Reference
Part = Part #.
Qty. = Quantity

Ref	Part	Qty
1	F16576-320	2
2	A16302-003	2
3	A25722-90F00	2
4	A00540-55E60	2
5	F31052-350	2

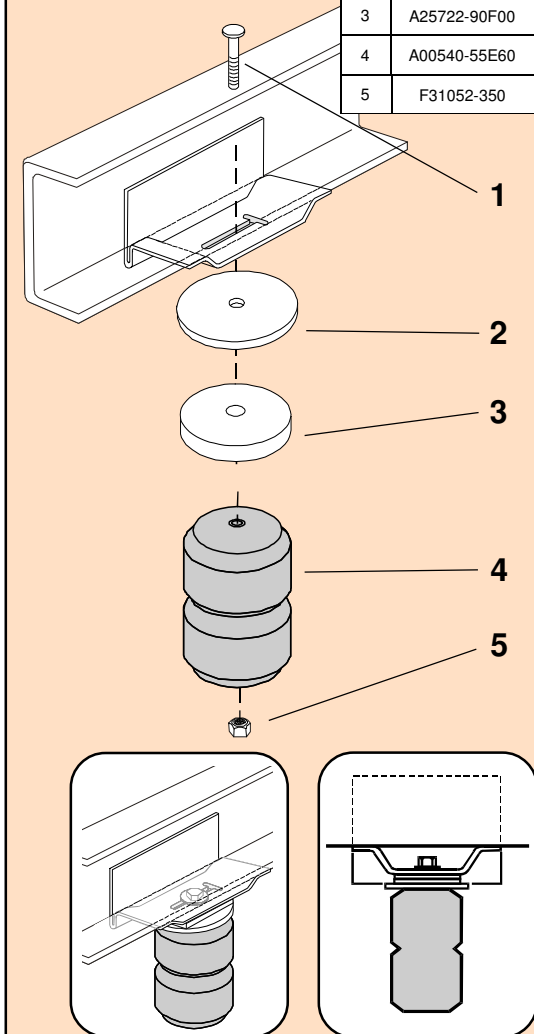

GMRG45MH

PART NUMBER	DESCRIPTION	QTY	LOCATION
F31052-350	NYLOCK LOCKNUT M12 x 1.75 Gr 8.0 Z	2	H3E
F16576-320	BOLT T M12 x 80 x 1.75 GR 5.8 Z	2	I3C
A00540-55E60	Hollow Rubber Spring	2	C9A
A25722-90F00	RUBBER SPACER 4"od x 1/2" thk w/ F Bushing	2	
A16302-003	DISC 3/16 x 4 x 21/32 PAINTED	2	D20A
B90200-CR	SMALL REAR BOX - 9.5 x 7 x 5.5	1	A--E
B10000	8" x 12" BUBBLE FOR KITS	1	
B00029-010	BARCODE LABEL FOR KIT	1	

Issued: 10/24/2014

Clearance Instructions:

Rear SES Kits for Pick-Ups and Vans should have a 1/2" to 1-1/2" gap between the rubber spring and contact point when empty.

A partial load, or vehicle accessories will reduce or eliminate the gap.

Front SES kits are usually in full contact.

Medium and Heavy-Duty Trucks, Trailers and Motorhomes will be in constant contact, and have no gap.