



IHROA1

INTERNATIONAL

Rear suspension package

INSTALLATION INSTRUCTIONS

- Raise vehicle allowing the axle to hang freely.
- Remove existing bump stop assembly.
- Assemble Aeon rubber spring and bracket as shown in the adjacent diagram.
- Mount Timbren assembly using existing holes & Timbren supplied fasteners.
- Lower vehicle.

NOTES:

The Aeon rubber spring should be preloaded approx. $\frac{1}{2}$ ".

Do not exceed vehicle manufacturer's recommended axle weight rating. Check for AEON[®] interference with vehicle components - Under load AEON[®] will "expand" in diameter.

Ref. = Reference
Part = Part #.
Qty. = Quantity

Ref	Part	Qty
1	K10122-003	2
2	A16040-003	2
3	A00560-55C70	2
4	F11106-150	2

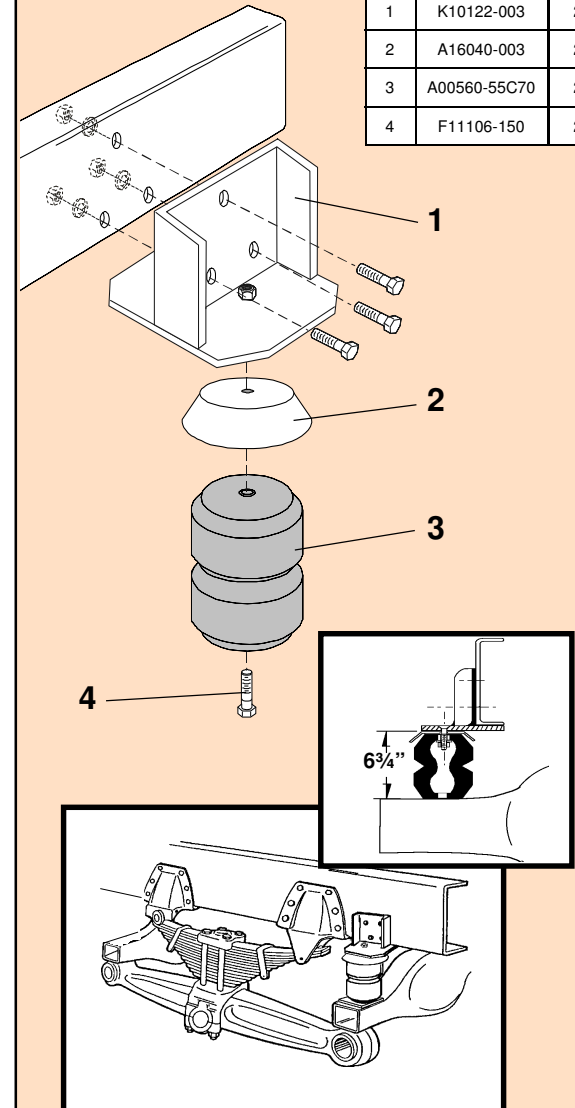

IHROA1

IHROA1

PART NUMBER	DESCRIPTION	QTY	LOCATION
F11106-150	HCS 1/2 x 2-1/2 UNF GR 5 Z	2	G1D
A00560-55C70	Hollow Rubber Spring	2	C13A
K10122-003	IHROA1 / IHROA2 WELDMENT PAINTED	2	E2A
A16040-003	STEEL CUP 6-15/16 x 17/32 x 1-5/8 PAINTED	2	D21B
B90224	12 x 11 x 8-1/2" DW Carton	1	A1A
B10100	NEWSPRINT 18" ROLL	1	
B00029-010	BARCODE LABEL FOR KIT	1	

Clearance Instructions:

Rear SES Kits for Pick-Ups and Vans should have a 1/2" to 1-1/2" gap between the rubber spring and contact point when empty.

A partial load, or vehicle accessories will reduce or eliminate the gap.

Front SES kits are usually in full contact.

Medium and Heavy-Duty Trucks, Trailers and Motorhomes will be in constant contact, and have no gap.