



GMFG45

GM

Front suspension package

INSTALLATION INSTRUCTIONS

- Raise vehicle allowing the axle to hang freely.
- Remove existing bump stop by prying out of bump stop cup
- If necessary, loosen and retighten upper shock bolts to allow additional control arm separation during Timbren kit installation.
- Position Aeon spring assembly into bump stop cup. Push and twist simultaneously. (See diagrams A & B.) Ensure the assembly is fully seated in cup.
- Lower vehicle.

Do not exceed vehicle manufacturer's recommended axle weight rating. Check for AEON® interference with vehicle components - Under load AEON® will "expand" in diameter.

Ref. = Reference
Part = Part #.
Qty. = Quantity

KIT PRE-ASSEMBLED

Ref	Part	Qty
1	A25620-55AG00	2
2	F42032-020	4
3	A1610A-003	2
4	A00140-75AG00	2
5	F13537-753	2

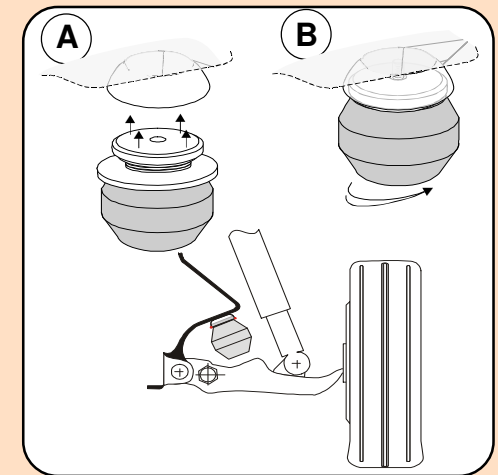
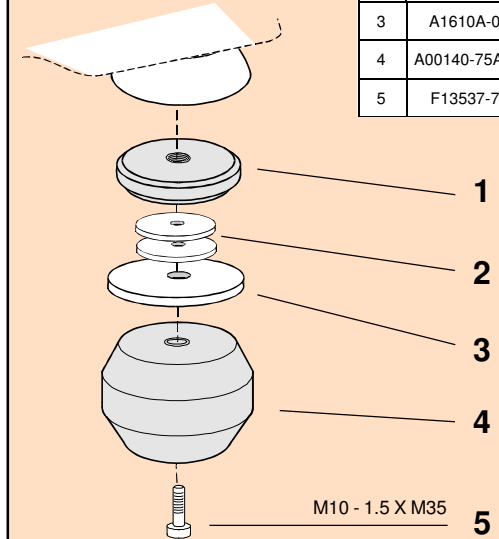

GMFG45

GMFG45

PART NUMBER	DESCRIPTION	QTY	LOCATION
F13537-753	SHCS M10 x 35 x1.5 F/T Gr 8.8 B	2	J1C
F42032-020	WASHER FENDER 3/8 x 1-1/4 x 1/8 THK GR 2 Z	4	H2D
A00140-75AG00	HOLLOW RUBBER SPRING	2	C7D
A25620-55AG00	GMFK15A AEON LOCATOR	2	F2B
A1610A-003	DISC 3 OD x 13/32 ID x 3/16 THK PAINTED	2	D20A
B90264-CF	MINI FRONT BOX - 7 x 5.25 x 4.75	1	A--D
B10000	8" x 12" BUBBLE FOR KITS	1	
B00029-010	BARCODE LABEL FOR KIT	1	

Clearance Instructions:

Rear SES Kits for Pick-Ups and Vans should have a 1/2" to 1-1/2" gap between the rubber spring and contact point when empty.

A partial load, or vehicle accessories will reduce or eliminate the gap.

Front SES kits are usually in full contact.

Medium and Heavy-Duty Trucks, Trailers and Motorhomes will be in constant contact, and have no gap.