

DFRM15

Front suspension package

DODGE

Ref. = Reference
Part = Part #.
Qty. = Quantity

INSTALLATION INSTRUCTIONS

- Partially raise vehicle allowing access to control arm.
- Insert item #1 to upper side of pivot joint of control arm. Choose pivot joint of control arm that is located to rear side of strut. Ensure that bolt from item #1 will protrude out the frame.
- Install item #2. Ensure that brackets will be installed on correct side of vehicle.
- Secure brackets using supplied hardware.
- Install Aeon rubber spring.
- Lower vehicle.

NOTES:

Install steel disc #3 in between Aeon rubber spring and Timbren bracket, if necessary, to ensure rubber spring is in full contact when vehicle on ground.

Turn wheel full lock left and right to check for interference.

Do not exceed vehicle manufacturer's recommended axle weight rating. Check for Aeon® interference with vehicle components. Under load Aeon® will "expand" in diameter.

Ref	Part	Qty
1	K11032-003	2
2	K11029-003	1L-1R
3	A16250-003	2
4	A00180-65AG00	2
5	F13536-753	4
6	F30051-350	2
7	F40310-020	6

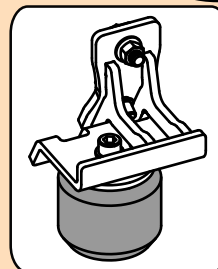
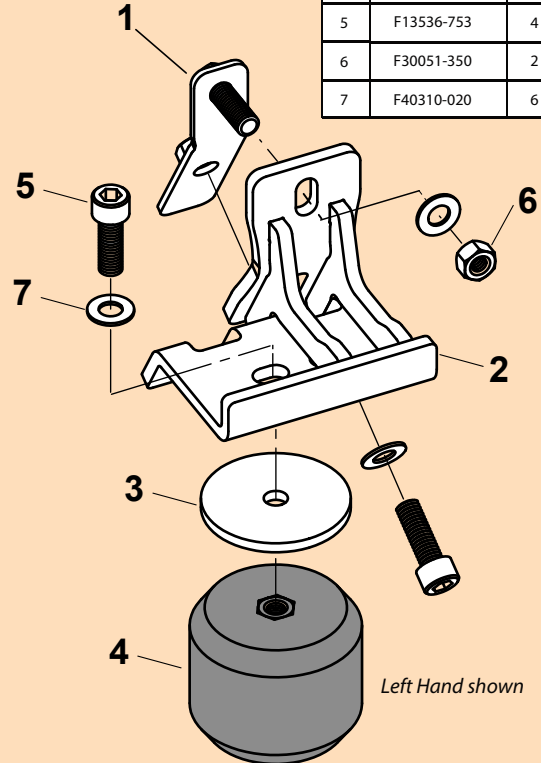

DFRM15

APPLY 'LEFT' LABEL TO L/H BRACKET

PART NUMBER	DESCRIPTION	QTY	LOCATION
F30051-350	HEX NUT STD M10 x 1.50 PC 8.0 Z DIN 934	2	I1D
F40310-020	WASHER FLT M10 GR 4.6 Z DIN 125	6	I1D
F13536-753	SHCS M10-1.5 x M30 F/T PC8.8 B DIN 912	4	J1C

A00180-65AG00	HOLLOW RUBBER SPRING	2	C4A
----------------------	----------------------	----------	------------

K11029LH-003	WELDMENT LH	1	TBD
K11029RH-003	WELDMENT RH	1	TBD
K11032-003	NUT LOCATOR WELDMENT	2	TBD
A16250-003	DISC 2-1/2 OD x 13/32 ID x 3/16 THK	2	E(END)A

B90264-CF	MINI FRONT BOX - 7 x 5.25 x 4.75	1	A--D
B10000	8" x 12" BUBBLE FOR KITS	1	
B00029-010	BARCODE LABEL FOR KIT	1	

Clearance Instructions:

Rear SES Kits for Pick-Ups and Vans should have a 1/2" to 1-1/2" gap between the rubber spring and contact point when empty.

A partial load, or vehicle accessories will reduce or eliminate the gap.

Front SES kits are usually in full contact.

Medium and Heavy-Duty Trucks, Trailers and Motorhomes will be in constant contact, and have no gap.