

ABSJFTJ

JEEP

Front or rear suspension package

INSTALLATION INSTRUCTIONS

- a) Raise vehicle allowing the axle to hang freely.
- b) Remove coil springs.
- c) Remove existing bump stop assembly.
- d) Assemble Aeon rubber spring and bracket as shown in the adjacent diagram.
- e) Mount Timbren assembly using existing holes, OEM cup & Timbren supplied fasteners.
- f) Re-install coil springs as per manufacturers instructions.
- g) Lower vehicle.

NOTES

2012 - Onwards (FRONT ONLY)

Use nut #6, rotate bracket #2 as shown.

SAFETY CAUTIONS

Professional installation required.

Do not exceed vehicle manufacturer's recommended axle weight rating. Check for AEON[®] interference with vehicle components - Under load AEON[®] will "expand" in diameter.

Ref. = Reference

Part = Part #.

Qty. = Quantity

FRONT

Ref	Part	Qty
1	OEM CUP	
2	K10044-003	2
3	A16060	2
4	A00525-65AG00	2
5	F13548-783	2
6	F31051-350	2

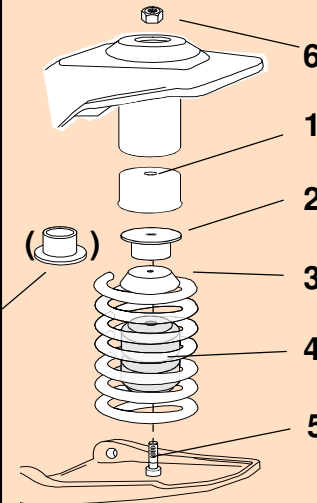

REAR

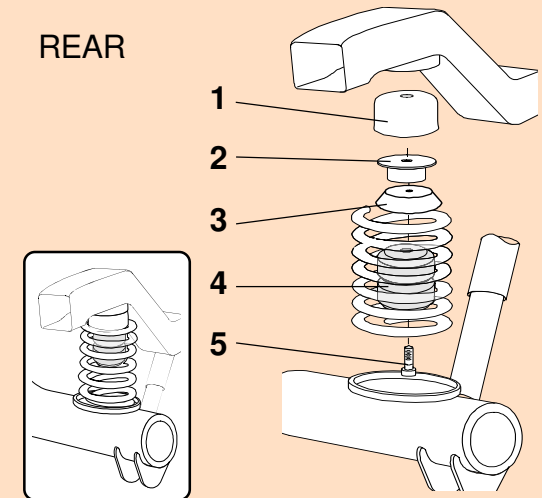

ABSJFTJ



PART NUMBER	DESCRIPTION	QTY	LOCATION
F31051-350	NYLOCK LOCKNUT M10 x 1.5 GR 8.0 Z	2	I1D
F13548-783	SHCS M10 x 90 x 1.5 F/T GR 10.9 B	2	J1B

A00525-65AG00	HOLLOW RUBBER SPRING	2	C4D
----------------------	----------------------	----------	------------

K10044-003	JFTJ/MBFSP35/TORSEN WELDMENT	2	E1A
A16060	STEEL CUP 3 od x 13/32 id x 7/8" deep	2	D21B

B90215	Carton 8.5 x 6.5 x 5	1	A5A
B10000	8" x 12" BUBBLE FOR KITS	1	
B00029-010	BARCODE LABEL FOR KIT	1	
B90121-010	OFFROAD KIT BOX LABEL	1	

Clearance Instructions:

Rear SES Kits for Pick-Ups and Vans should have a 1/2" to 1-1/2" gap between the rubber spring and contact point when empty.

A partial load, or vehicle accessories will reduce or eliminate the gap.

Front SES kits are usually in full contact.

Medium and Heavy-Duty Trucks, Trailers and Motorhomes will be in constant contact, and have no gap.