

2-Pedal Firewall-Mount

600
series



Pedal Material: **Aluminum**
 Ratio: **Varies**
 Weight: **4.8 lbs (2.2 kg)**
 P/N: **72-607**

Typical Applications

- > Road Racing
- > Endurance
- > Off Road
- > High Performance Street/Strip
- > Circle Track
- > Rally
- > Drifting



Forged aluminum pedals are engineered for high rigidity and low weight.



Lightweight aluminum frame features guide "ramps" to reduce balance bar tipping. By decreasing balance bar tipping, friction is decreased and brake repeatability is improved.



Large diameter 7/16"-20 balance bar, allowing front/rear brake bias adjustments, minimizes flex to provide a solid pedal feel/response. PTFE coated aluminum clevises for increased durability and reduced friction.

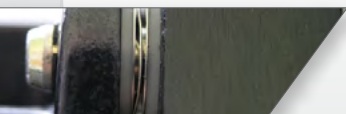

Pedal pivots feature wave washers to reduce lateral pedal movement and oil impregnated bronze bushings decrease stiction.

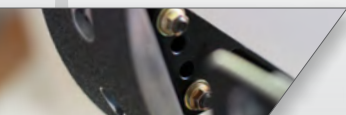

Foot pads can be adjusted vertically, horizontally and in angle to suit individual driver preferences. With two different pad sizes the customization is virtually endless.



Detailed Pedal Information

Pedal assemblies do not include master cylinders

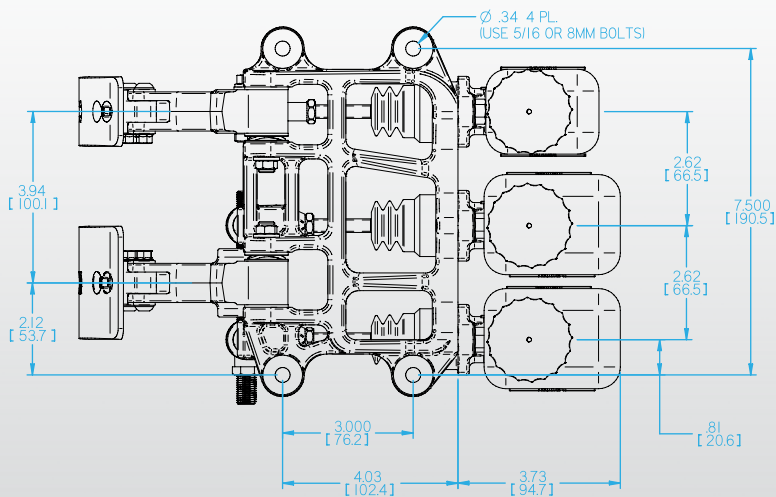
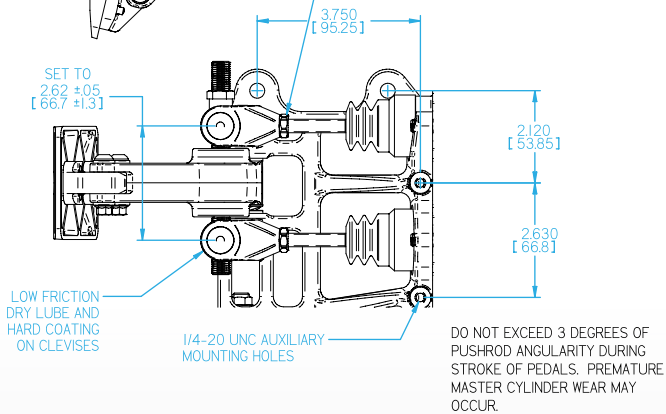
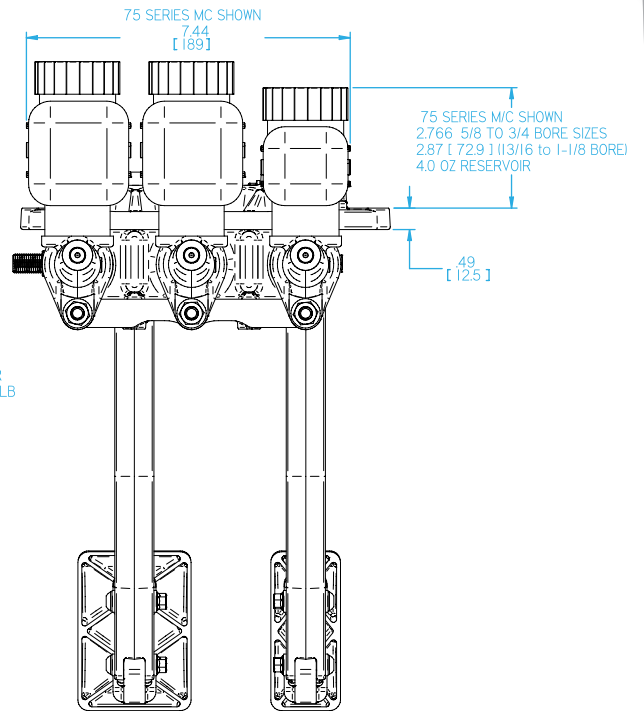
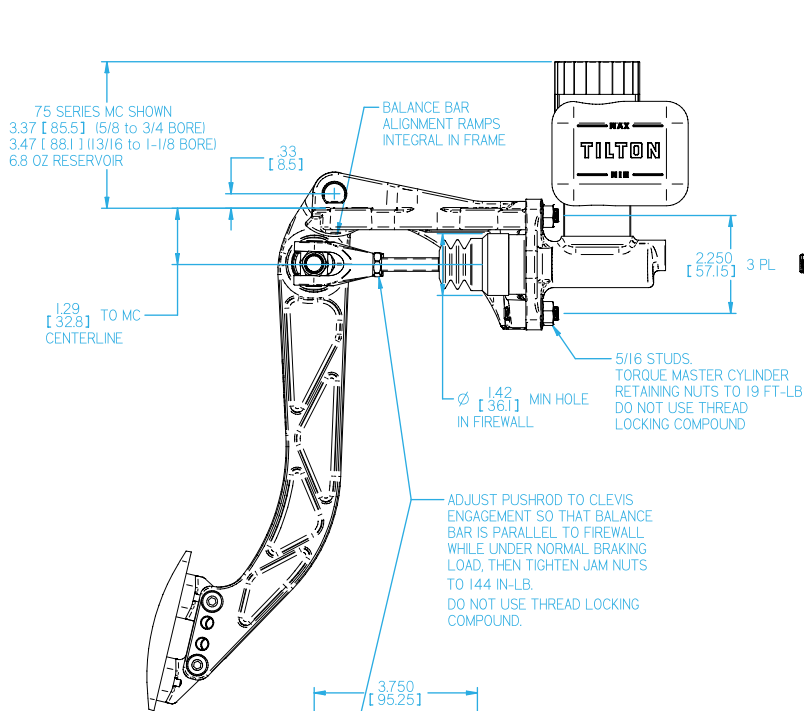

PEDAL RATIO WILL VARY FROM 5.0:1 TO 6.2:1 BASED ON PEDAL PAD POSITION.

