

Heavy Duty Drive Shaft Service Kit

20175

**TIGER
TOOL**

Have What It Takes

Safety Warning

Read all instructions and safety warnings prior to operation. Failure to do so could result in equipment damage, personal injury or even death.

CAUTION: FAILURE TO CHECK THE SPHERICAL THRUST WASHER AND REPLACE AS NECESSARY MAY RESULT IN UNREPAIRABLE DAMAGE TO YOUR U-JOINT PULLER GLOVE CASTING. PREVENTATIVE MAINTENANCE AS OUTLINED BELOW WILL ENSURE MANY YEARS OF USE FROM YOUR TIGER TOOL PULLER. FAILURE TO PERFORM PREVENTATIVE MAINTENANCE WILL VOID YOUR WARRANTY.

- **Stay Alert!** Watch what you are doing and use common sense when operating this tool.
- Inspect product for damage prior to using; do not use if product is in unsafe condition.
- Do not operate tool while under the influence of drugs, alcohol or medication.
- Always use safety equipment to prevent injuries. Approved face and eye protection must always be worn by the operator, as well as others in the work area.
- Do not overreach. Keep proper footing and balance at all times.
- Dress properly. Do not wear loose clothing or jewelry. Keep your hair, clothing and gloves away from moving parts.
- Keep your work area clean and well lit.



Heavy Duty Drive Shaft Service Kit

20175

**TIGER
TOOL**

Have What It Takes

Operating Instructions

U-Joint Puller: 10102

CAUTION: Failure to check the spherical thrust washer and replace as necessary may result in unrepairable damage to your U-Joint Puller glove casting. Preventative maintenance as outlined above will ensure many years of use from your Tiger Tool puller. Failure to perform preventative maintenance will void your warranty.

- 1 Remove all fasteners from bearing cups.
- 2 Slip the U-Joint Puller over the yoke of the drive line.
- 3 Turn the tool's forcing screw clockwise with either an air or hand wrench. (Note: reverse thread)
- 4 Once bearing cup has been removed, repeat the process on the remaining bearing cups.

The 10102 U-Joint Puller may be used with up to a 1" impact wrench without voiding warranty.

Preventative Maintenance

Keep forcing screw clean and lubricated at all times. Failure to maintain the spherical thrust washer located inside the glove will result in excessive wear to the part. Check and lubricate this part (lubricate load bearing surface in glove, under cap, on both sides of spherical washer) periodically and replace as necessary. Contact your Dealer or Tiger Tool for replacement washers. (We recommend SAE 30 lube for the threads and EP 'with molly grease').

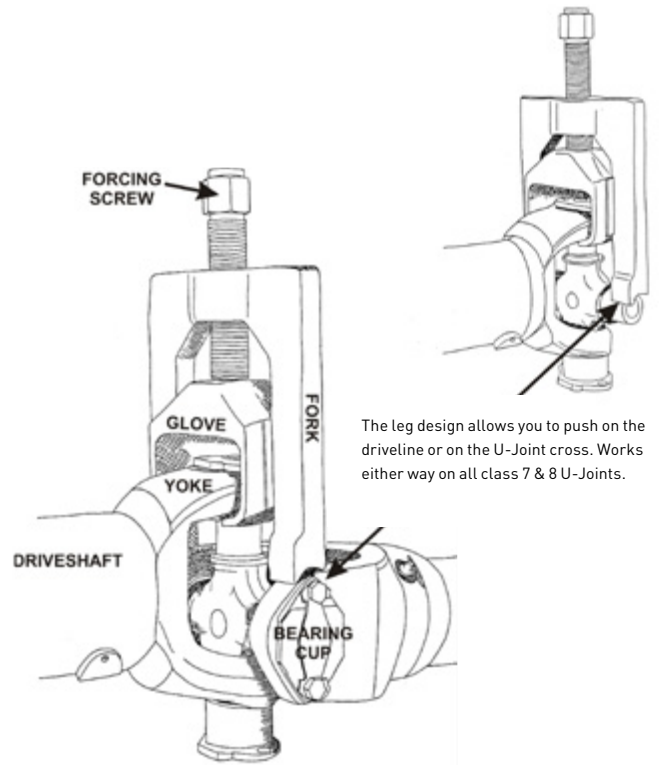

Heavy Duty Drive Shaft Service Kit

20175

**TIGER
TOOL**

Have What It Takes

Yoke Puller: 10803

Use any quality oil on forcing screw.

Half Round Yoke

- 1 Remove the large nut and washer that retains yoke to shaft.
- 2 Apply penetrating lubricant to splines of the shaft, wing cap bolt holes, and forcing screw of tool.
- 3 Thread the forcing screw into the pull bar until threads begin to show through the other side.
- 4 Hold pull bar assembly by the forcing screw and position the tool onto the yoke. **Note:** pull bar end reliefs should face yoke.
- 5 Attach the adaptor cap by four bolts and then tighten down both caps.
- 6 Hand tighten the forcing screw until the center point aligns with the shaft center.
- 7 Using up to a $\frac{3}{4}$ " impact wrench, begin applying power to the forcing screw.
- 8 Continue turning the forcing screw until yoke is completely removed.

Full Round Yoke

- 1 Remove the large nut and washer retaining yoke to shaft.
- 2 Apply penetrating lubricant to splines of the shaft and forcing screw of the tool.
- 3 With the pull bar separated from the forcing screw, slide the bar through bearing cup bores until centered.
- 4 Thread the forcing screw into pull bar until it contacts the shaft.
- 5 Using up to a $\frac{3}{4}$ " impact wrench, begin applying power to the forcing screw.
- 6 Continue turning the forcing screw until the yoke is completely removed.

Heavy Duty U-Joint Puller

10102

**TIGER
TOOL**

Have What It Takes

Parts Breakdown

Part #10101

10102 Maintenance Pack
Contains each of the following items:



Also available separately.

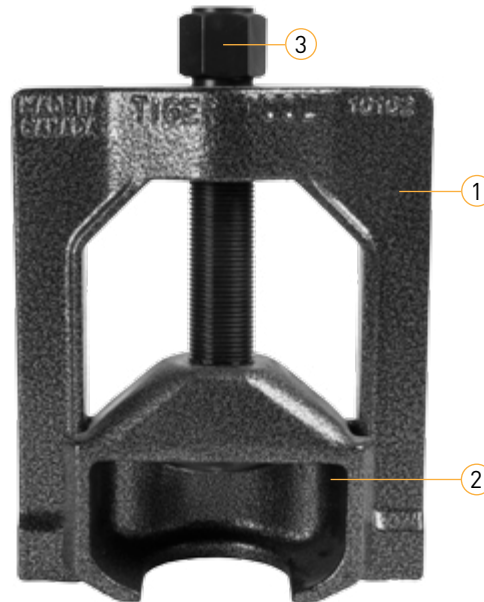

Item No.	Part Number	Description	Qty.
1	10102-1	Fork	1
2	10102-2	Glove	1
3	10102-3	Forcing Screw	1
4	10102-4	Retaining Bolt	1
5	10102-5	Washer	1
6	10102-6	Dome Plug	1

Yoke Puller

10803



Have What It Takes

Fits full and half round yokes on Spicer 1610,1710, 1760, 1810 series, Spicer SPL 140, 170, 250 series and Meritor (Rockwell) RPL 20 and 25 series.

Parts Breakdown

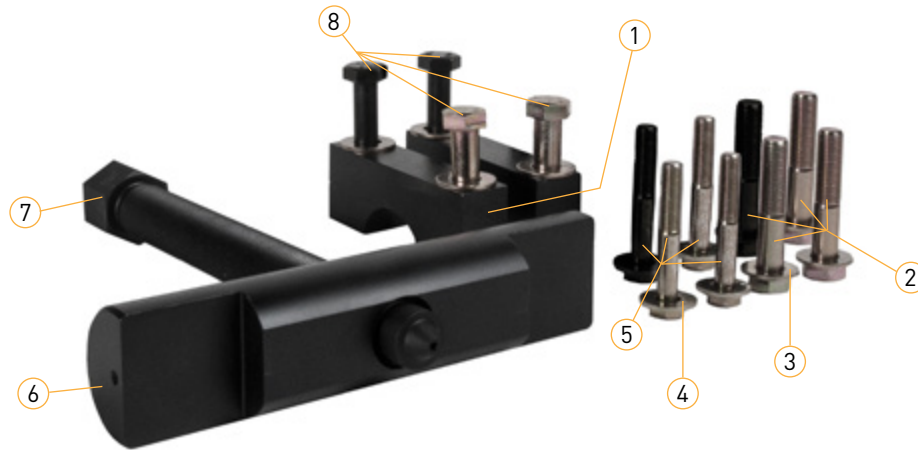

Item No.	Part Number	Description	Qty.
1	10803-12	Combined Cap	2
2	10803-4	1/2" - 20 x 2 1/2" Bolt	4
3	10407-4	1/2" Washer	8
4	10803-5	3/8" Washer	4
5	10201-2	3/8" - 24 x 2 1/2" Bolt	4
6	10803-1	Pull Bar	1
7	10803-11	Forcing Screw	1
8	10803-7	12mm x 1.25 x 70 Bolt	4

Check out the collection of pullers and installers we offer.