

PARTS INCLUDED

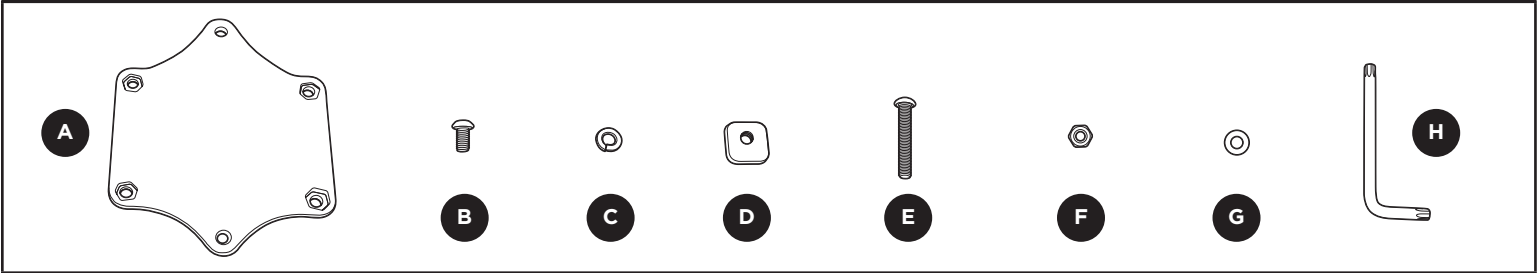

part	description	part number	qty.
A	adapter plate /	8527486001	2
B	M6 x 12 tamperproof button head screw	853526903	4
C	spring locking washer /	956061259	4
D	M6 sliding square nut 20 x 20 /	8537557	4
E	M6 X 40 tamperproof bolt, 690 SP /	853526905	8
F	M6 locking nut /	938060054	8
G	flat washer 6mm I.D. /	951061254	8
H	tamperproof wrench T-27 /	8535270	1

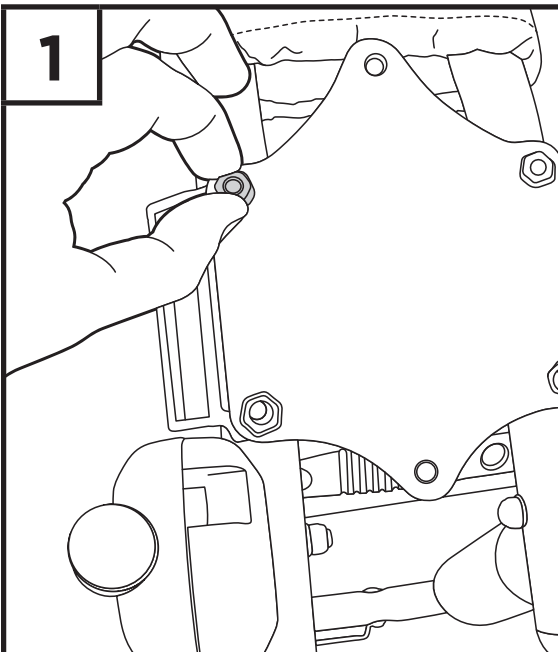

- To attach adapter plate to bottom of Hull-a-Port base, first turn Hull-a-Port upside down and align plate shape with bottom of Hull-a-Port base. The longer (pointier) end should point toward the back handle and hubs.
 - Hex nut insets should be visible.
 - Place an M6 locking nut into inset on one of the four corners on the bottom of the plate.

2

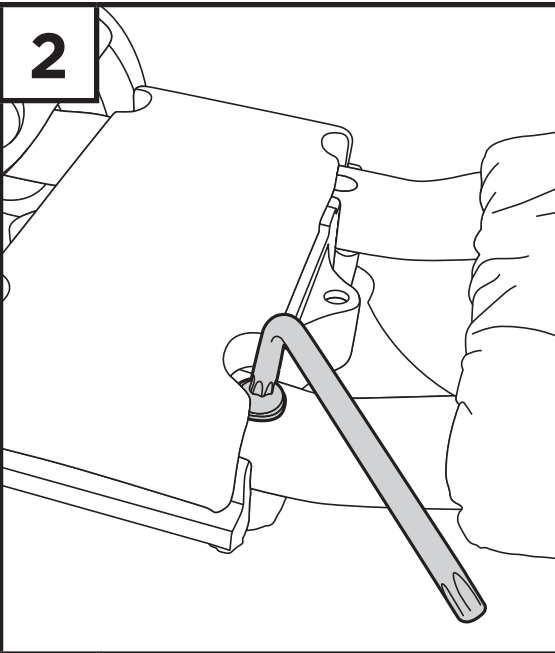

- Place flat washer on M6 x 40 tamperproof bolt.
- Insert bolt from top side through Hull-a-Port tube and plate into M6 locking nut.
- Tighten firmly using tamperproof wrench.
- Repeat these steps for the other three attachment points.

3

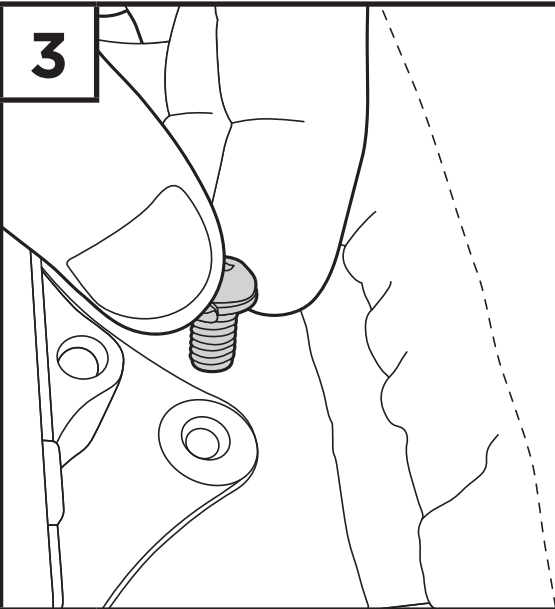

- Place spring locking washer onto M6 x 12 tamperproof button head screw.
- Insert button head screw into hole at one end of the plate.

4

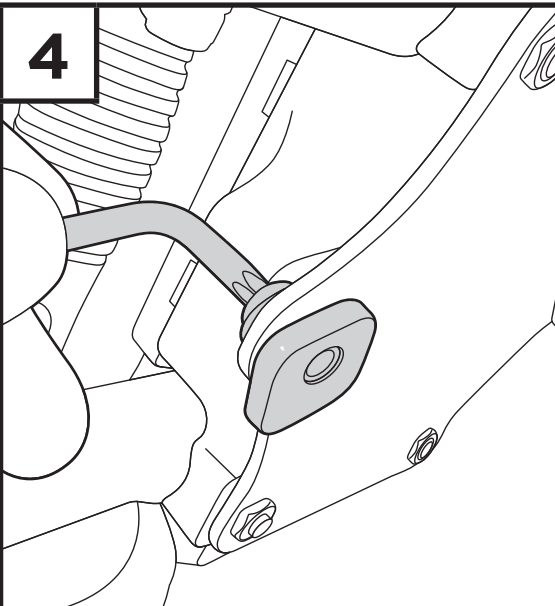

- Thread sliding square nut onto button head screw on bottom side of plate.
- Do NOT tighten firmly yet.

5

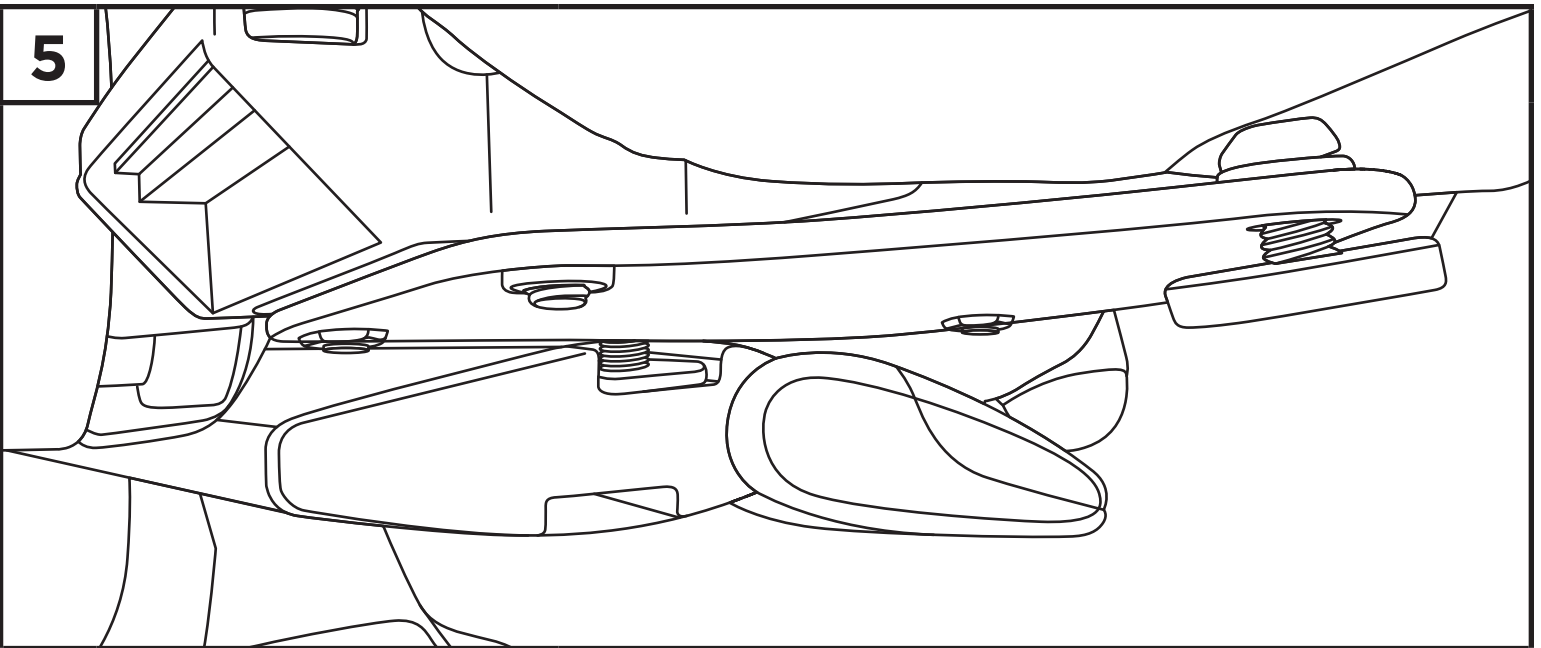

- To attach Hull-a-Port onto AeroBlade bar, swing open the end cap door.
- Cut and remove section of black rubber wind diffuser strip where Hull-a-Port will be.
- Slide square nuts (attached to bottom of Hull-a-Port and plate) into T-track on AeroBlade bar.
- Refill diffuser strip into gaps in AeroBlade track slot.
- Swing end cap door closed.

6

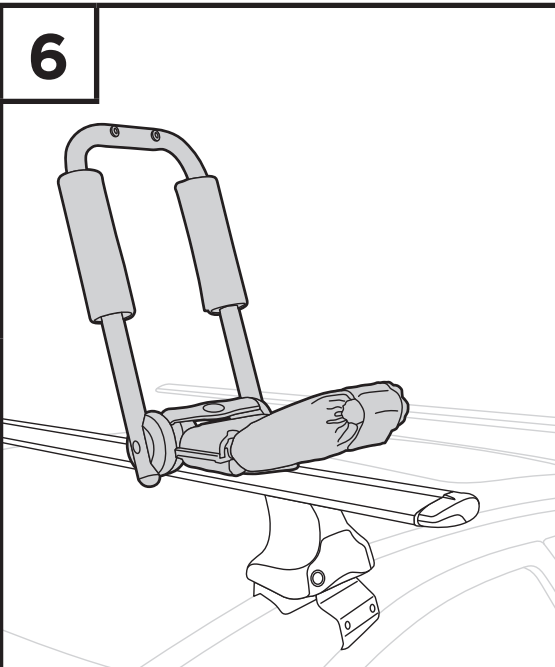

- Firmly tighten tamperproof button head screws using provided tamperproof wrench.

NOTE: This may require sliding Hull-a-Port nylon pad forward on tubing slightly in order to reach button head screw.