

**PARTS INCLUDED**

part	description	part number	qty.
A	cargo bag /	—	1
B	1.5" attachment strap	8535494	4

**WARNINGS / LIMITATIONS**

- If your vehicle does not have raised crossbars or side rails, **DO NOT USE** this product.

**CAUTION:** When mounting bag to raised side rails, front attachment straps must be forward of rail's center support post, otherwise bag may slide off back of roof.

**CAUTION:** NOT recommended for use on glass roof surfaces like sun/moonroofs and panoramic roofs. Bag contents can damage or shatter glass roofs.

- Do not overload cargo bag.
- Do not exceed 100 lbs. weight capacity or the weight capacity of your roof as stated by vehicle manufacturer.
- This bag is **WEATHER RESISTANT, NOT WATERPROOF**. Cargo must be packed in plastic bags if raining.
- Be sure to check all straps for tightness at regular intervals during travel.
- Do **NOT** leave mounted on vehicle without cargo.
- This product will **NOT** prevent dents resulting from improper loading, securing, or driving.
- **ZIPPER IS NOT TO FACE THE FRONT OF THE VEHICLE.**
- Avoid removing bag from roof while fully loaded.
- For cleaning, a damp sponge works best using only water with a mild detergent which contains no additives (such as alcohol, chlorine or ammonia) as these could discolor the surface. Allow to air dry completely.

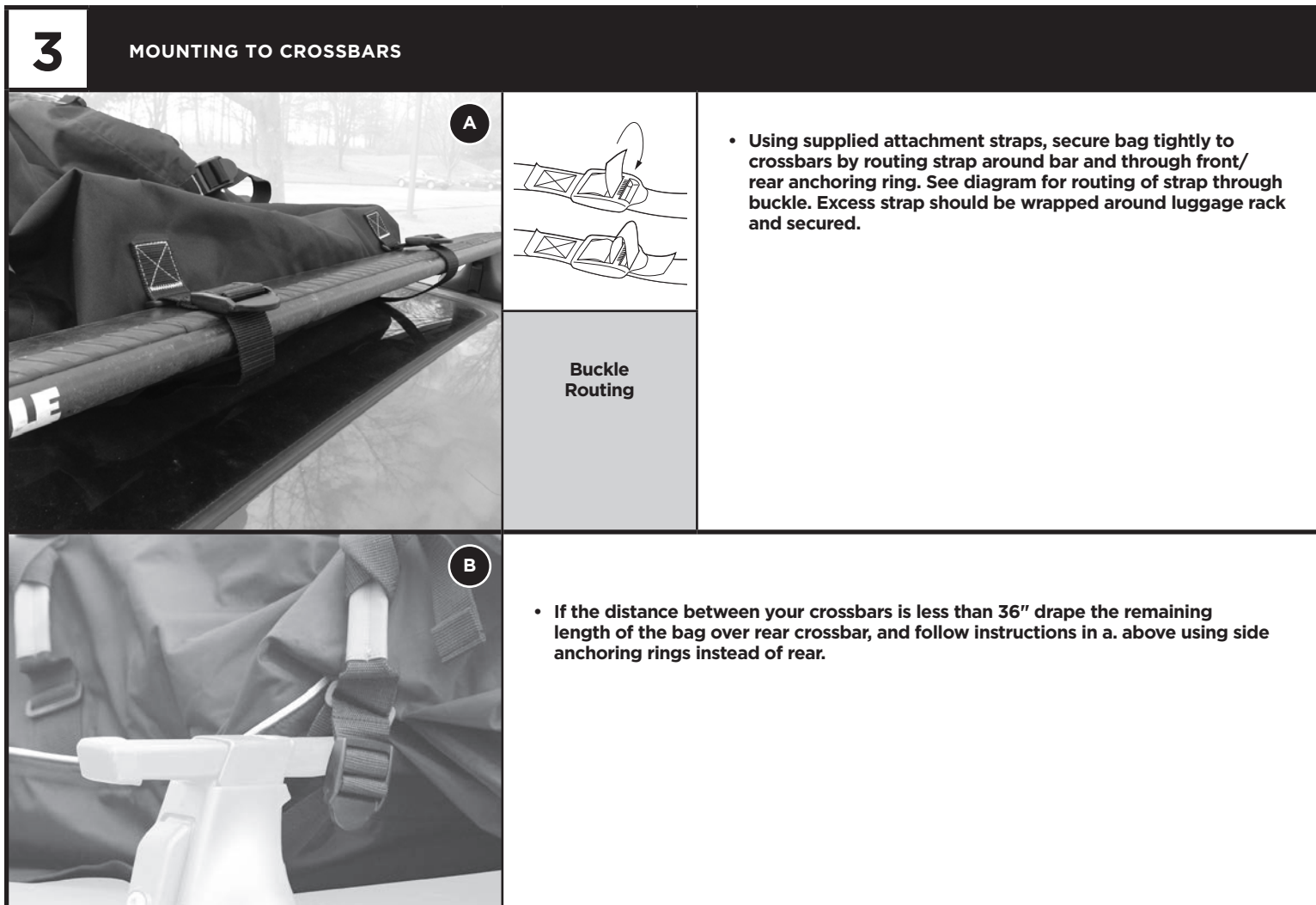
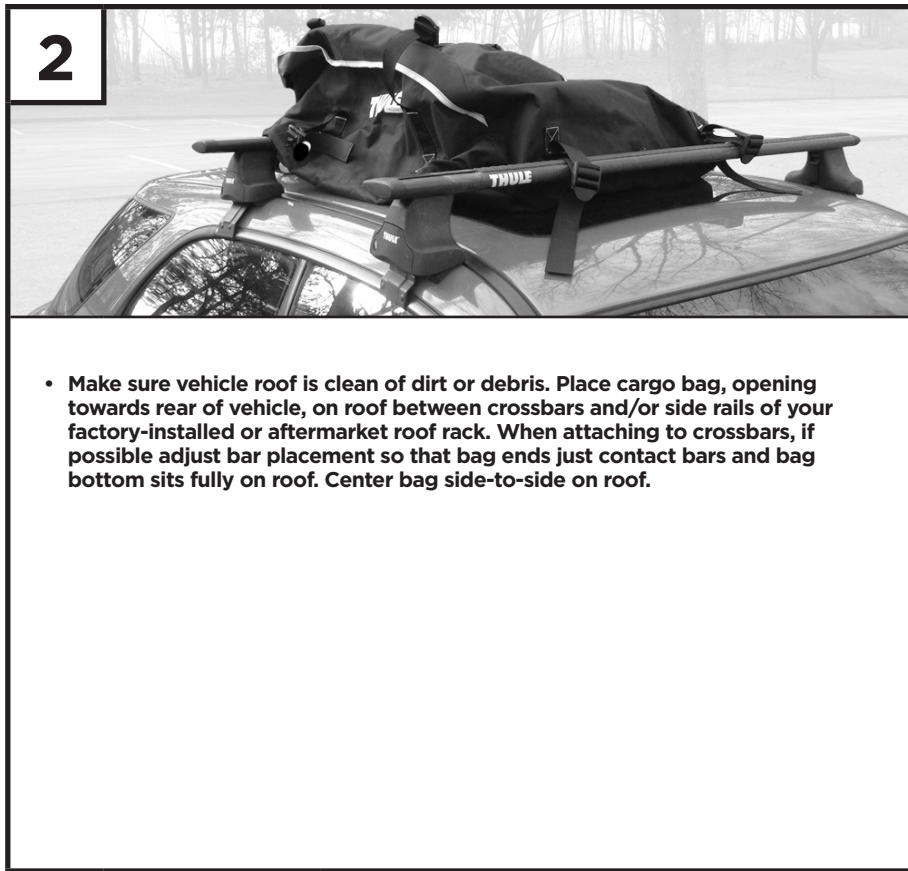

# 4

## MOUNTING TO SIDE RAILS

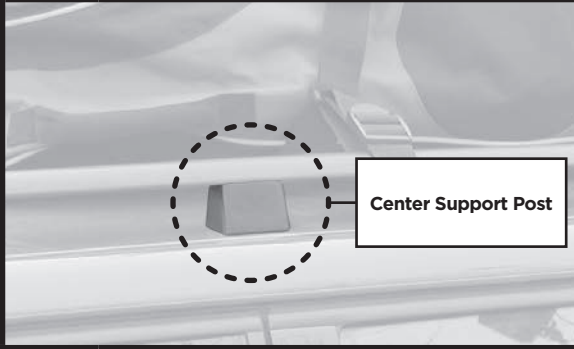

- When mounting to roof racks equipped with side rails only, use side anchoring rings and position bag so that at least one set of rings is forward of side rail center support post.

# 5



- Open the top of the cargo bag and gently rest on the roof and windshield.

# 6



- Load cargo bag evenly. Avoid overstuffing.

**CAUTION:** Before loading, consult vehicle owner's manual for any weight bearing limitations. Placing hard point items directly on roof may cause vehicle damage.

7



- Close bag completely with zipper.

8



- Place narrow hook+loop zipper pull inside wide hook+loop pull and press together to join securely.

9



- Secure zipper storm flap to bag at all hook+loop closure points.
- Tighten compression straps to secure bag's contents.