

2

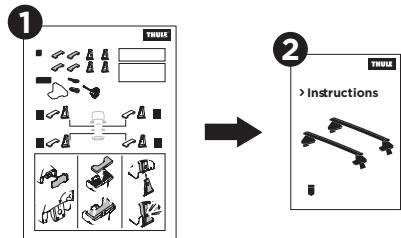

> Instructions

Thule Evo Clamp
710501

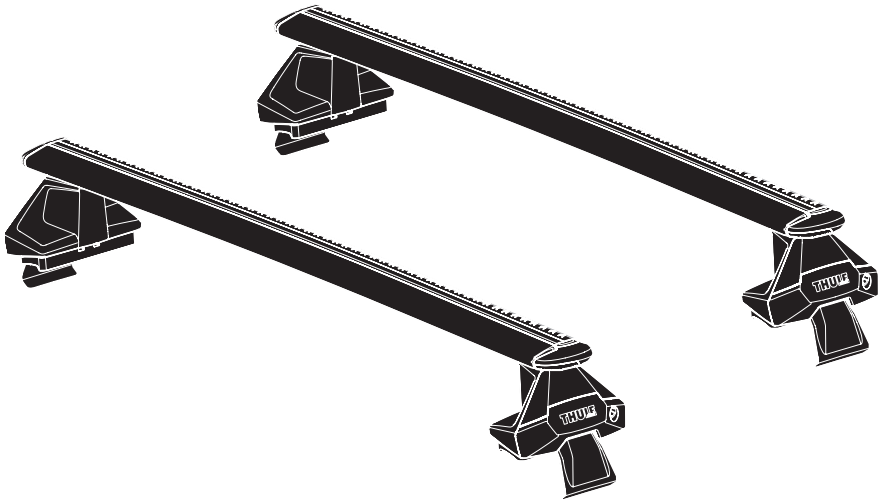

CITY CRASH
Complies with ISO norm

ISO 11154-E

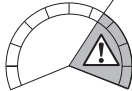
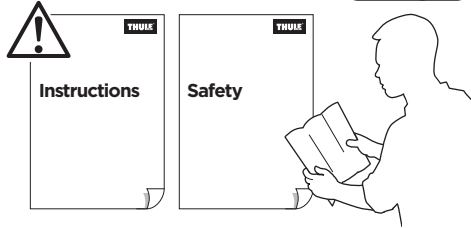

Max 130 km/h
80 Mph

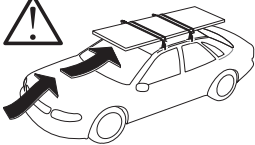

80 km/h
50 Mph

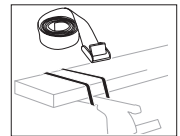
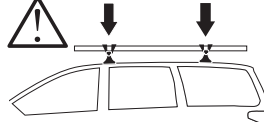
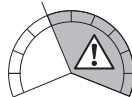

> Mounting Tutorial

Thule Evo Clamp



1
KIT

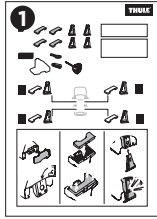

+

2
FOOT PACK

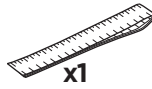
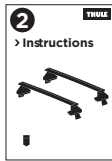

x1

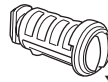

x4



3 Nm

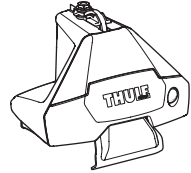
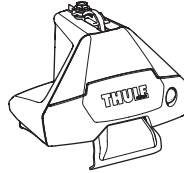
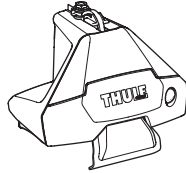
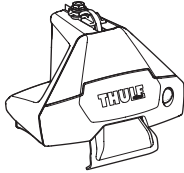

3
BAR



THULE
WingBar Evo

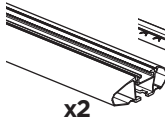

x2

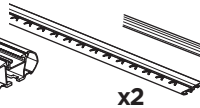

x2

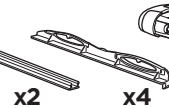

x2



x4



x2



THULE
AeroBlade

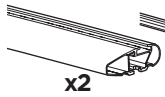

x2

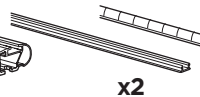

x2

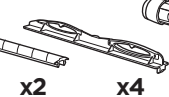

x2



x4



x2



THULE
ProBar

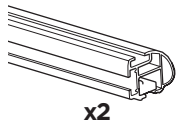

x2

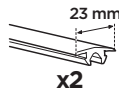

x2

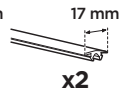

x2

x4

x4



x1



x2



x2



THULE
SquareBar

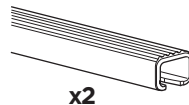

x2



x4

4

BAR

3



THULE
WingBar Evo

A

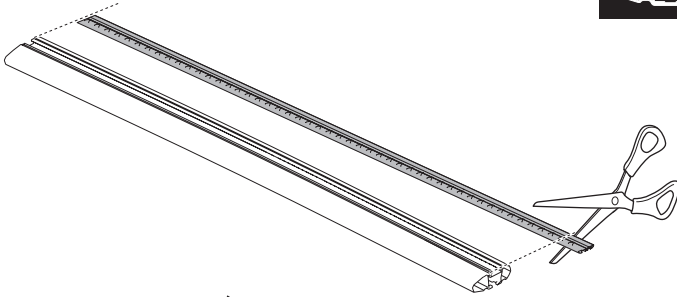

B

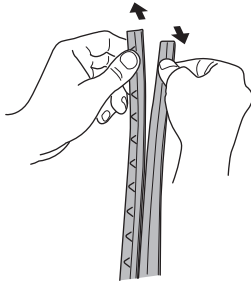

C

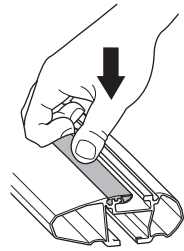
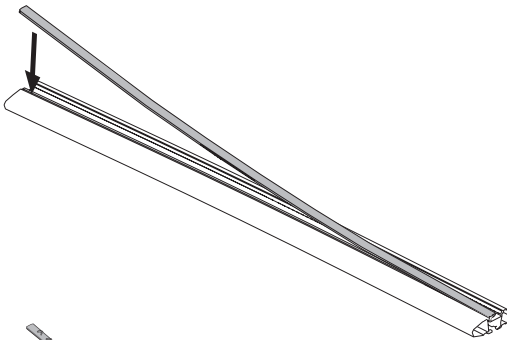

D

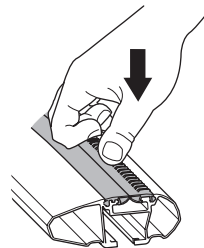
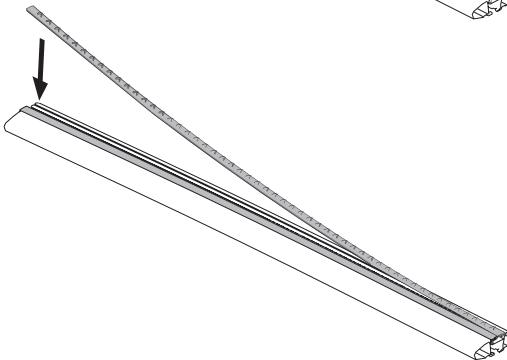

x2

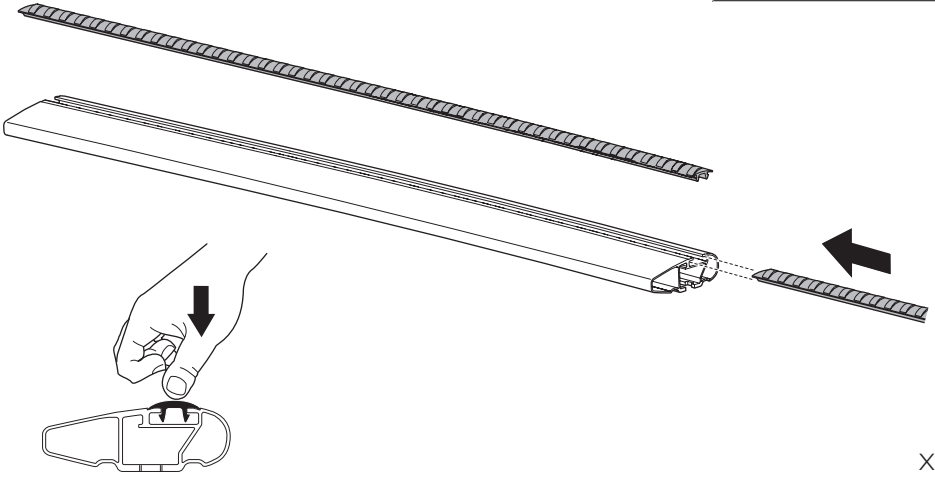

5

BAR 3

A



B



C

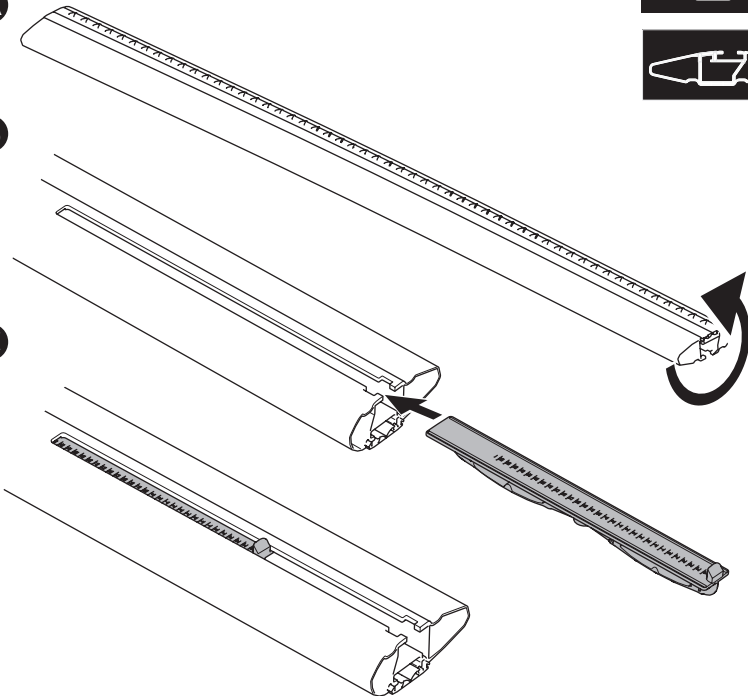

6

1 KIT + **2** FOOT PACK + BAR **3**

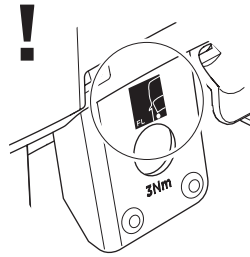
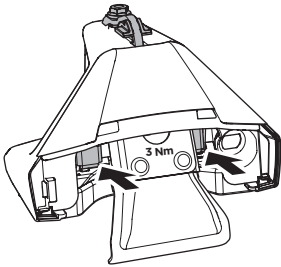

A

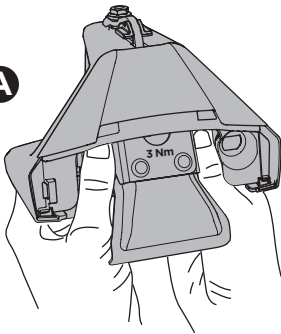

B

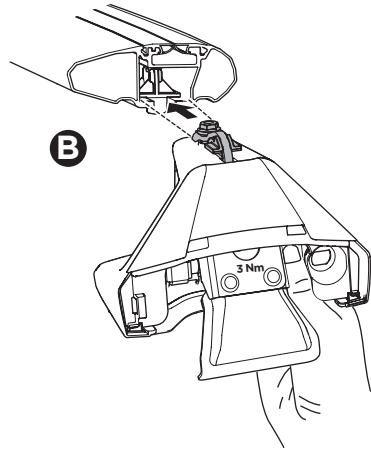

x4

7

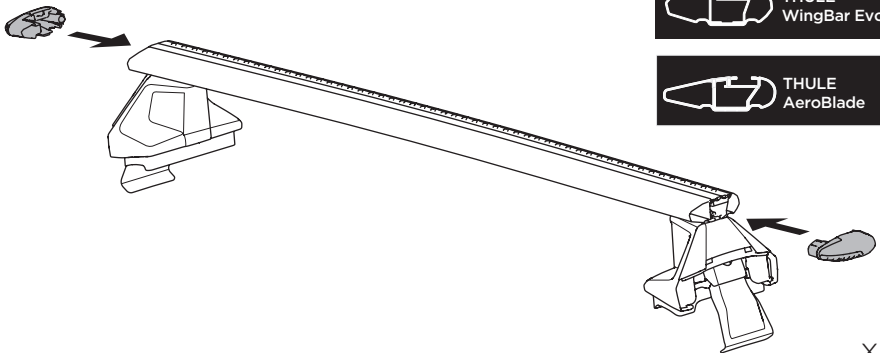

x2

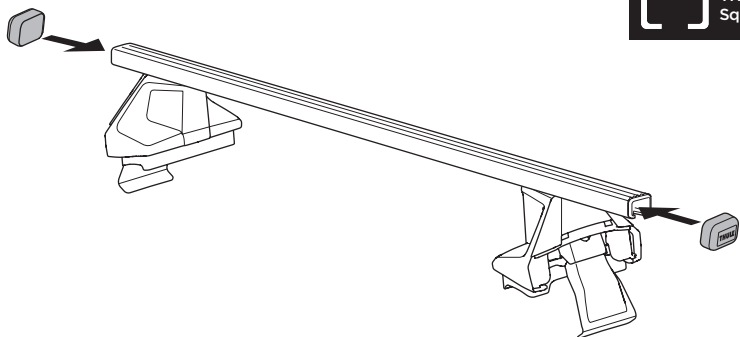

x2

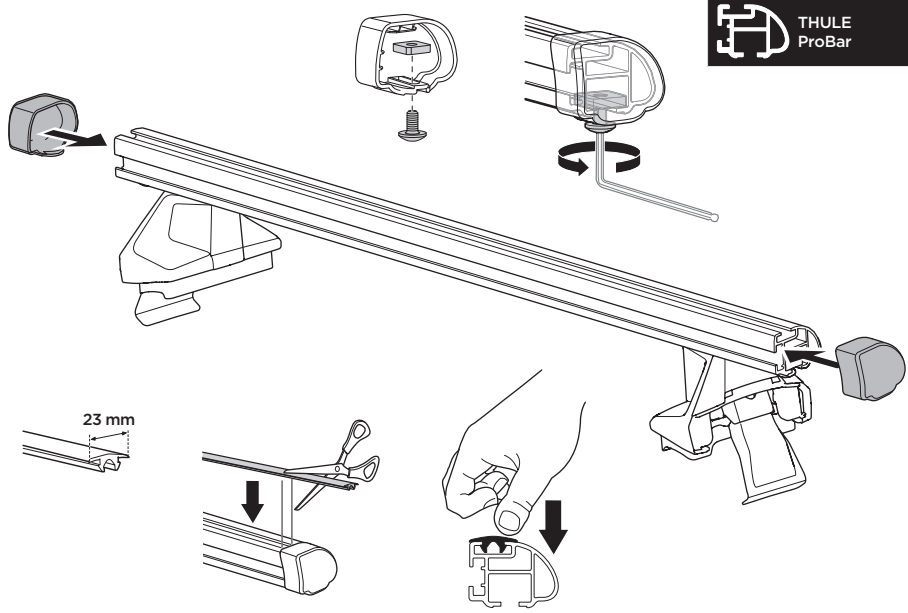

x2

8

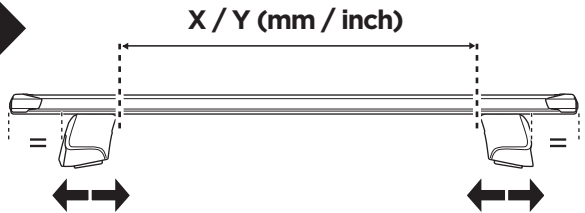
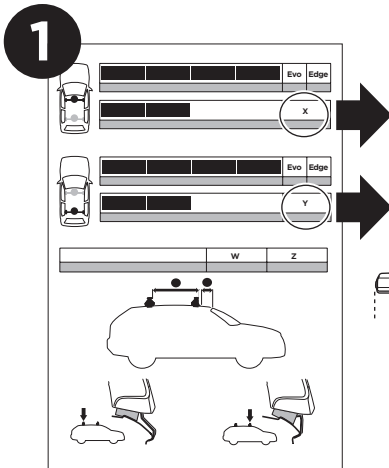
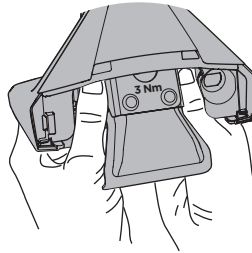
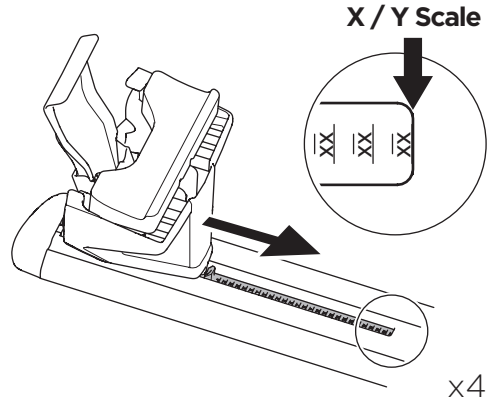
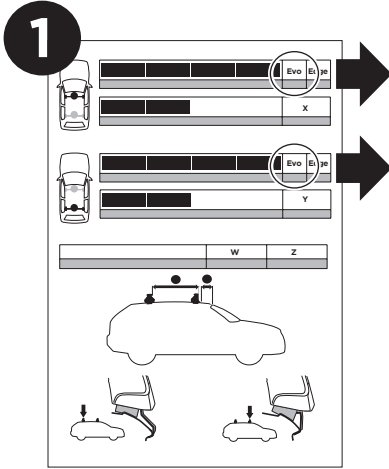
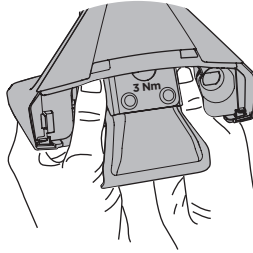

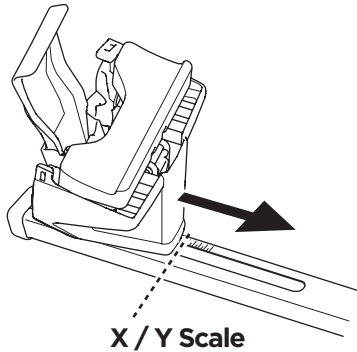
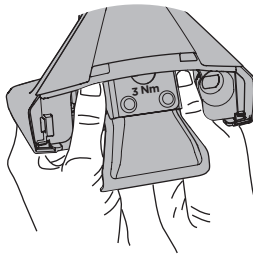
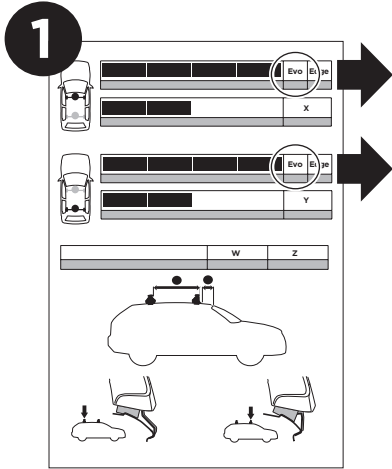

x4

9

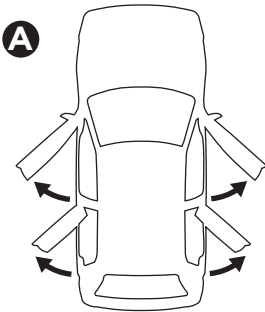

B

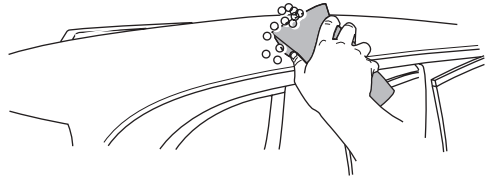

C

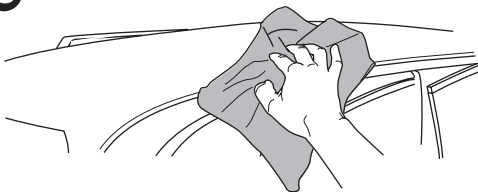

10

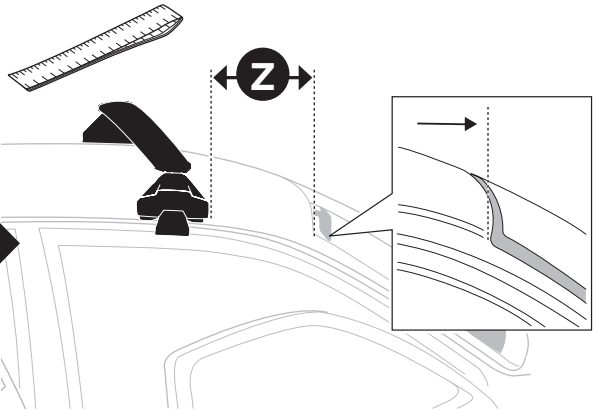
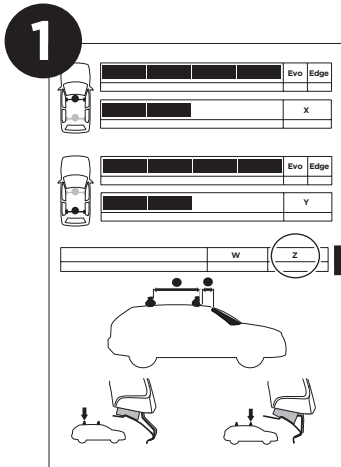
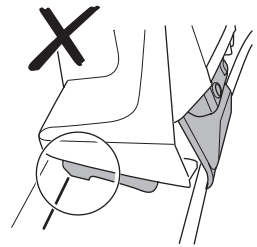
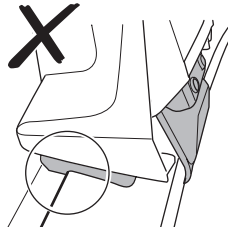
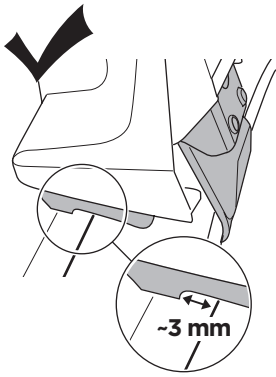
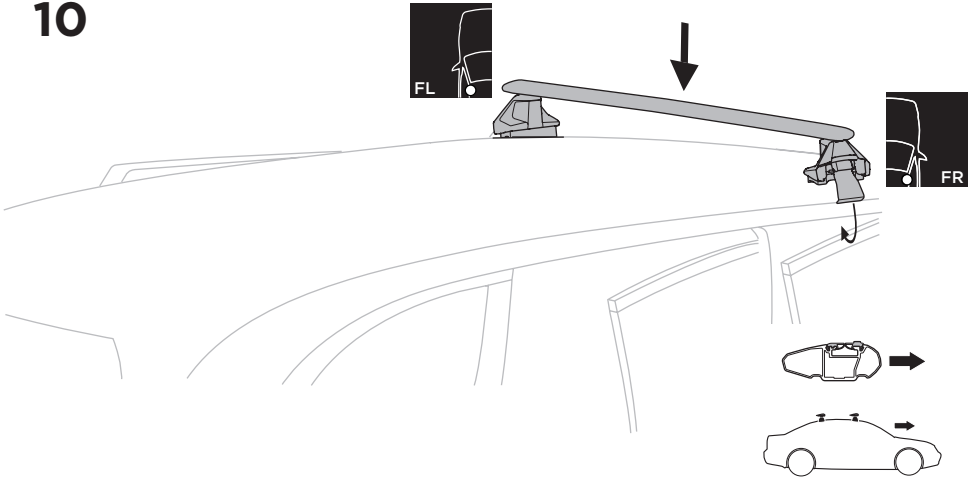

11

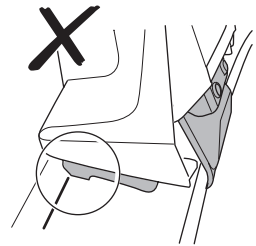
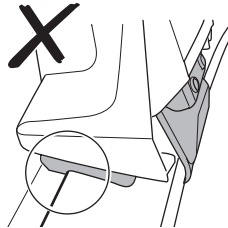
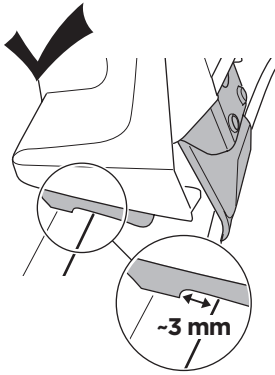
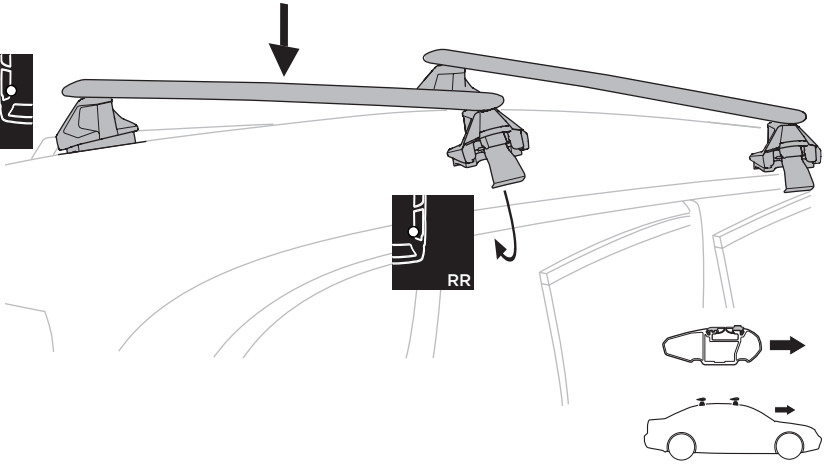

1

	Evo	Edge
	X	
	Evo	Edge
	Y	

W	Z
---	---

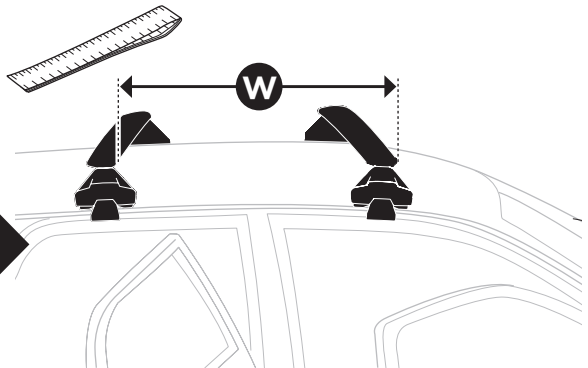

12

-50%

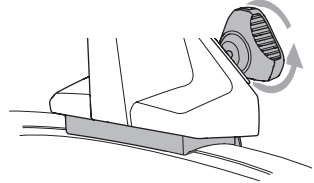
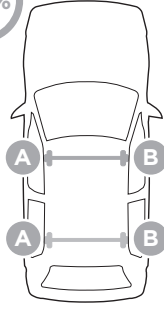
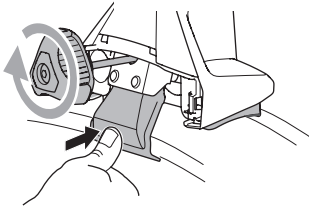

100%

Click
Click

3 Nm

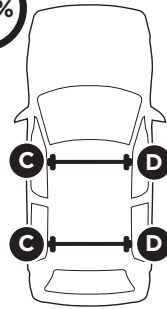
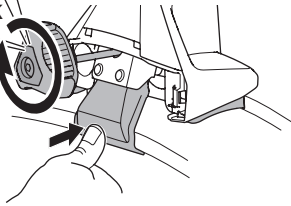

Click
Click

3 Nm

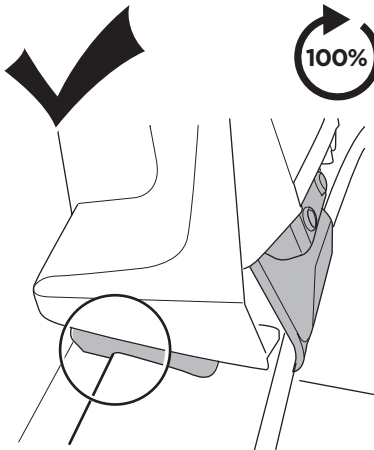
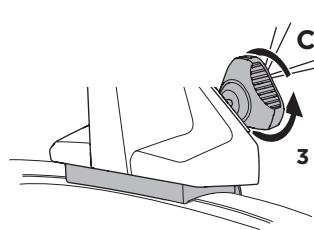

1

	Evo	Edge
		X
	Evo	Edge
		Y
	W	Z

Diagram 1 shows a table with car seat configurations. The table has three columns: a car icon with a seat highlighted, 'Evo', and 'Edge'. The first row shows seat A highlighted. The second row shows seat B highlighted. The third row shows seat C highlighted. The fourth row shows seat D highlighted. Below the table, there are two more columns labeled 'W' and 'Z'. A large checkmark is next to the diagram below the table.

13

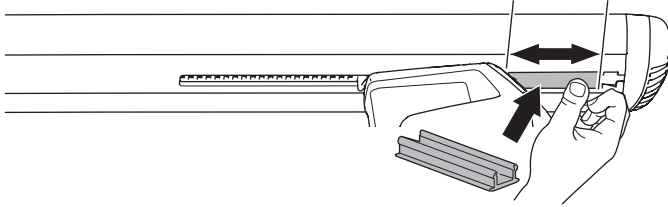
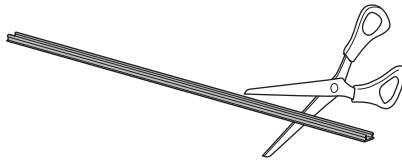

x4

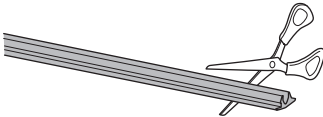
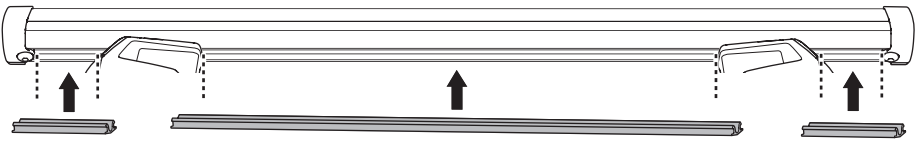
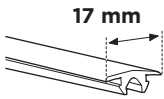

x2

14

A

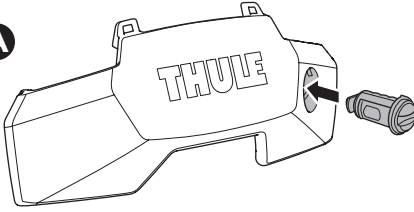

B

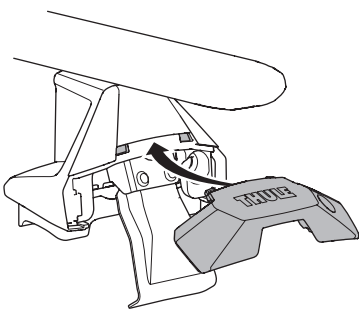

C

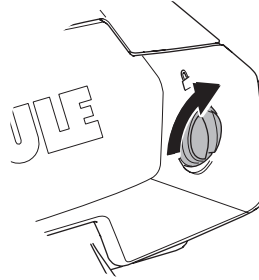

x4



Accessory



A

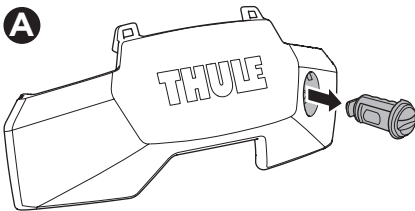

B

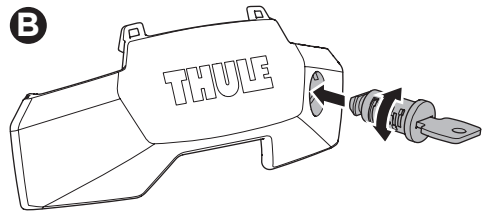

C

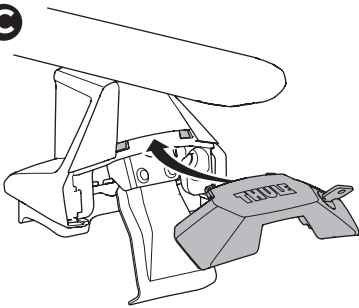

D

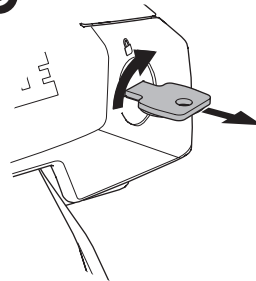

x4



Your Key-Number



15

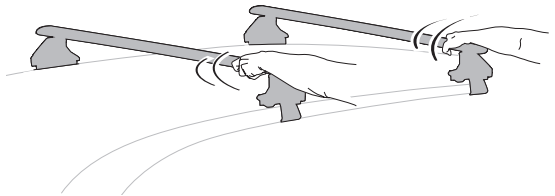
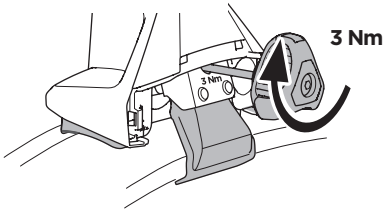
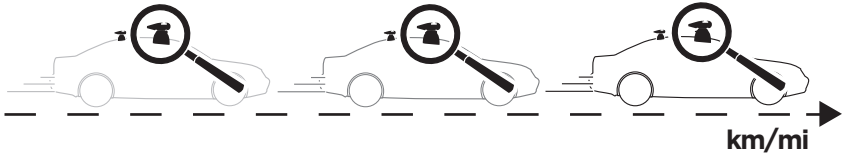
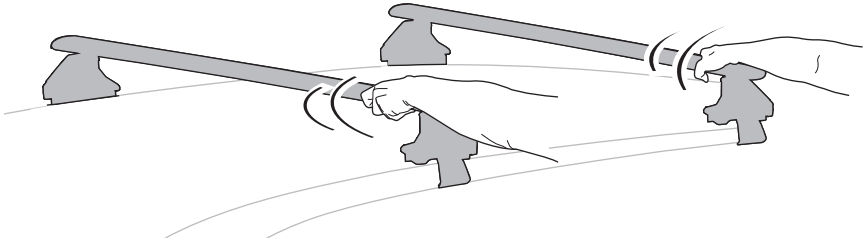

i

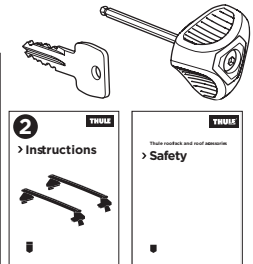
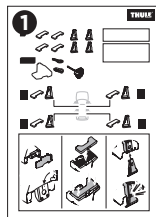
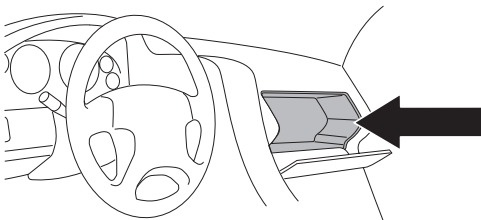
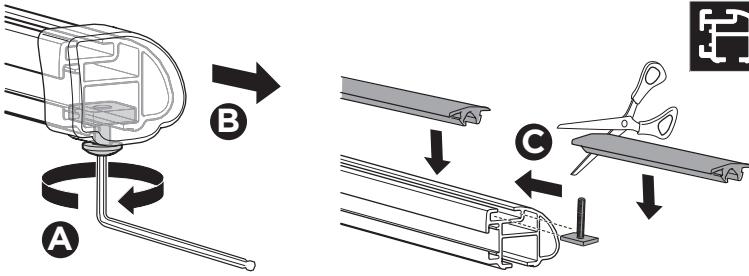
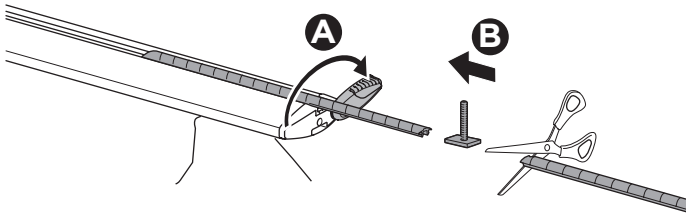
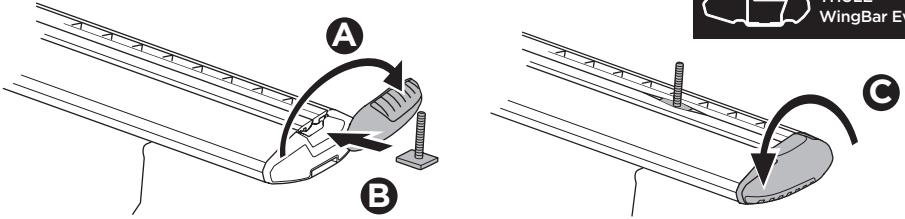

Discover other roof racks and cargo carriers on our website.